

3 - DISCONNECTS

MALE & FEMALE DISCONNECTS



|                       |                    |
|-----------------------|--------------------|
| Non-Insulated .....   | <a href="#">52</a> |
| Vinyl Insulated ..... | <a href="#">54</a> |
| PC Insulated .....    | <a href="#">57</a> |



|                          |                    |
|--------------------------|--------------------|
| NYLON COUPLAR SETS ..... | <a href="#">58</a> |
|--------------------------|--------------------|



|                             |                    |
|-----------------------------|--------------------|
| PIGGYBACK DISCONNECTS ..... | <a href="#">59</a> |
|-----------------------------|--------------------|



|                         |                    |
|-------------------------|--------------------|
| KNIFE DISCONNECTS ..... | <a href="#">60</a> |
|-------------------------|--------------------|



|                               |                    |
|-------------------------------|--------------------|
| FEMALE FLAG DISCONNECTS ..... | <a href="#">61</a> |
|-------------------------------|--------------------|



MALE BULLETS AND FEMALE RECEPTACLES

|                       |                    |
|-----------------------|--------------------|
| Vinyl Insulated ..... | <a href="#">62</a> |
| Nylon Insulated ..... | <a href="#">64</a> |



|   |                    |
|---|--------------------|
| OPEN BARREL MALE & FEMALE DISCONNECTS ..... | <a href="#">65</a> |
|---|--------------------|



SPECIALTY CONNECTORS

|                              |                    |
|------------------------------|--------------------|
| Double Male and Female ..... | <a href="#">66</a> |
| Quick Tap Splices .....      | <a href="#">66</a> |



|                          |                    |
|--------------------------|--------------------|
| INSULATING SLEEVES ..... | <a href="#">67</a> |
|--------------------------|--------------------|



## Disconnects

### Non-Insulated Female Disconnects

**Material:** Tin Plated Brass

**Temperature:** 300°F

**Maximum Electrical Rating:** 22-16: 10 Amps  
 16-14: 15 Amps  
 12-10: 24 Amps

**Barrel ID (d1):** .067  
**Barrel ID (d1):** .091  
**Barrel ID (d1):** .134

T= Material Thickness

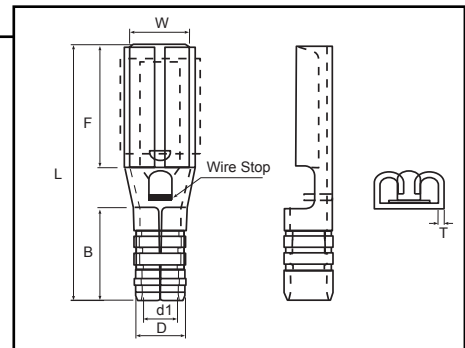

| HOFFMAN PART NO. | WIRE SIZE | TAB         | DIMENSIONS (INCHES) |       |       |       |       |       |   | UL   | TAPE MOUNTED REEL QTY | DIE FOR TAPE MOUNT | HAND TOOL |
|------------------|-----------|-------------|---------------------|-------|-------|-------|-------|-------|---|------|-----------------------|--------------------|-----------|
|                  |           |             | W                   | F     | L     | B     | D     | T     |   |      |                       |                    |           |
| DF2216T110A5     | 22-16     | .110 x .020 | 0.126               | 0.256 | 0.535 | 0.189 | 0.106 | 0.012 | N | 1000 | 3Q2216                | YHM228             |           |
| DF2216T110A8     | 22-16     | .110 x .032 | 0.126               | 0.256 | 0.535 | 0.189 | 0.106 | 0.012 | N | 1000 | 3Q2216                | YHM228             |           |
| DF2216T187A5     | 22-16     | .187 x .020 | 0.199               | 0.248 | 0.543 | 0.189 | 0.106 | 0.014 | N | 1000 | 3Q2216                | YHM228             |           |
| DF2216T187A5/J   | 22-16     | .187 x .020 | 0.197               | 0.236 | 0.560 | 0.195 | 0.106 | 0.014 | Y | 1000 | 3Q2216                | YHT2210            |           |
| DF2216T187A8     | 22-16     | .187 x .032 | 0.199               | 0.248 | 0.543 | 0.189 | 0.106 | 0.014 | N | 1000 | 3Q2216                | YHM228             |           |
| DF2216T187A8/J   | 22-16     | .187 x .032 | 0.197               | 0.236 | 0.560 | 0.195 | 0.106 | 0.014 | Y | 1000 | 3Q2216                | YHT2210            |           |
| DF2216T250A      | 22-16     | .250 x .032 | 0.260               | 0.287 | 0.598 | 0.189 | 0.106 | 0.016 | N | 1000 | 3Q2216                | YHM228             |           |
| DF2216T250A/J    | 22-16     | .250 x .032 | 0.260               | 0.307 | 0.630 | 0.195 | 0.106 | 0.016 | Y | 1000 | 3Q2216                | YHT2210            |           |
| DF1614T187A5     | 16-14     | .187 x .020 | 0.200               | 0.248 | 0.543 | 0.189 | 0.130 | 0.014 | N | 1000 | 3Q1614                | YHM228             |           |
| DF1614T187A5/J   | 16-14     | .187 x .020 | 0.197               | 0.236 | 0.560 | 0.195 | 0.130 | 0.014 | Y | 1000 | 3Q1614                | YHT2210            |           |
| DF1614T187A8     | 16-14     | .187 x .032 | 0.199               | 0.252 | 0.543 | 0.189 | 0.130 | 0.014 | N | 1000 | 3Q1614                | YHM228             |           |
| DF1614T250A      | 16-14     | .250 x .032 | 0.260               | 0.287 | 0.598 | 0.189 | 0.130 | 0.016 | N | 1000 | 3Q1614                | YHM228             |           |
| DF1614T250A/J    | 16-14     | .250 x .032 | 0.260               | 0.307 | 0.630 | 0.195 | 0.130 | 0.016 | Y | 1000 | 3Q1614                | YHT2210            |           |
| DF1210T250A      | 12-10     | .250 x .032 | 0.260               | 0.287 | 0.638 | 0.228 | 0.177 | 0.016 | N | 500  | 3Q1210                | YHM228             |           |
| DF1210T250A/J    | 12-10     | .250 x .032 | 0.260               | 0.307 | 0.670 | 0.135 | 0.177 | 0.016 | Y | 500  | 3Q1210                | YHT2210            |           |



### Non-Insulated Female Disconnect with Copper Support Sleeve

**Material:** Tin Plated Brass with Tin Plated Copper Support Sleeve  
**Temperature:** 300°F

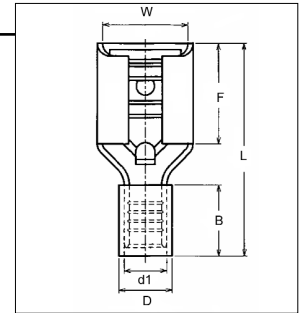

T = Material Thickness

| HOFFMAN PART NO.   | WIRE SIZE | TAB         | DIMENSIONS (INCHES) |       |       |       |       |       |   | UL | TAPE MOUNTED REEL QTY | DIE FOR TAPE MOUNT | HAND TOOL |
|--------------------|-----------|-------------|---------------------|-------|-------|-------|-------|-------|---|----|-----------------------|--------------------|-----------|
|                    |           |             | W                   | F     | L     | B     | D     | T     |   |    |                       |                    |           |
| DDF2216T110A5/J    | 22-16     | .110 x .020 | 0.126               | 0.252 | 0.577 | 0.232 | 0.114 | 0.016 | Y | NA | NA                    | YDT2216            |           |
| DDF2216T110A8/J    | 22-16     | .110 x .032 | 0.126               | 0.252 | 0.577 | 0.232 | 0.114 | 0.016 | Y | NA | NA                    | YDT2216            |           |
| DDF2216T187A5/J    | 22-16     | .187 x .020 | 0.197               | 0.236 | 0.597 | 0.232 | 0.114 | 0.016 | Y | NA | NA                    | YDT2216            |           |
| DDF2216T187A8/J    | 22-16     | .187 x .032 | 0.197               | 0.236 | 0.597 | 0.232 | 0.114 | 0.016 | Y | NA | NA                    | YDT2216            |           |
| DDF2216T250A/J     | 22-16     | .250 x .032 | 0.260               | 0.307 | 0.667 | 0.232 | 0.114 | 0.016 | Y | NA | NA                    | YDT2216            |           |
| DDF1614T187A55.9/J | 16-14     | .187 x .020 | 0.197               | 0.236 | 0.597 | 0.232 | 0.138 | 0.016 | Y | NA | NA                    | YDT1614            |           |
| DDF1614T187A85.9/J | 16-14     | .187 x .032 | 0.197               | 0.236 | 0.597 | 0.232 | 0.138 | 0.016 | Y | NA | NA                    | YDT1614            |           |
| DDF1614T250A5.9/J  | 16-14     | .250 x .032 | 0.260               | 0.307 | 0.667 | 0.232 | 0.138 | 0.016 | Y | NA | NA                    | YDT1614            |           |
| DDF1210T250A6.9/J  | 12-10     | .250 x .032 | 0.260               | 0.307 | 0.707 | 0.272 | 0.185 | 0.016 | Y | NA | NA                    | YDT1210            |           |

### Non-Insulated Male Disconnects

**Material:** Tin Plated Brass  
**Temperature:** 300°F  
**Maximum Electrical Rating:** 22-16: 10 Amps  
 16-14: 15 Amps  
 12-10: 24 Amps

**Barrel ID (d1):** .067  
**Barrel ID (d1):** .091  
**Barrel ID (d1):** .134

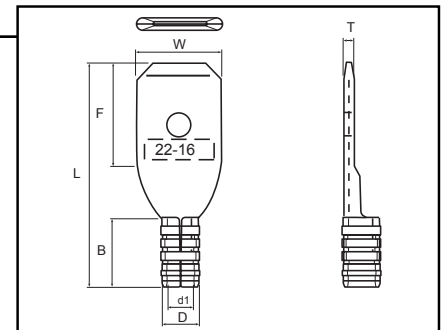

T = Material Thickness

| HOFFMAN PART NO. | WIRE SIZE | TAB         | DIMENSIONS (INCHES) |       |       |       |       |       |   | UL   | TAPE MOUNT REEL QTY | DIE FOR TAPE MOUNT | HAND TOOL |
|------------------|-----------|-------------|---------------------|-------|-------|-------|-------|-------|---|------|---------------------|--------------------|-----------|
|                  |           |             | W                   | F     | L     | B     | D     | T     |   |      |                     |                    |           |
| DM2216T187A5     | 22-16     | .187 X .020 | 0.189               | 0.256 | 0.551 | 0.189 | 0.106 | 0.020 | N | 1000 | 3Q2216              | YHM228             |           |
| DM2216T187A8     | 22-16     | .187 X .032 | 0.189               | 0.264 | 0.551 | 0.189 | 0.106 | 0.016 | N | 1000 | 3Q2216              | YHM228             |           |
| DM2216T250       | 22-16     | .250 x .032 | 0.248               | 0.299 | 0.646 | 0.189 | 0.106 | 0.016 | N | 1000 | 3Q2216              | YHM228             |           |
| DM1614T187A5     | 16-14     | .187 X .020 | 0.189               | 0.256 | 0.551 | 0.189 | 0.130 | 0.020 | N | 1000 | 3Q1614              | YHM228             |           |
| DM1614T187A8     | 16-14     | .187 X .032 | 0.189               | 0.256 | 0.551 | 0.189 | 0.130 | 0.016 | N | 1000 | 3Q1614              | YHM228             |           |
| DM1614T250       | 16-14     | .250 x .032 | 0.248               | 0.299 | 0.646 | 0.189 | 0.130 | 0.016 | N | 1000 | 3Q1614              | YHM228             |           |
| DM1210T250       | 12-10     | .250 x .032 | 0.248               | 0.303 | 0.748 | 0.189 | 0.177 | 0.016 | N | 1000 | 3Q1210              | YHM228             |           |



## Non-Insulated Male Disconnect with Copper Support Sleeve

**Material:** Tin Plated Brass with Tin Plated Copper Support Sleeve

**Temperature:** 300°F

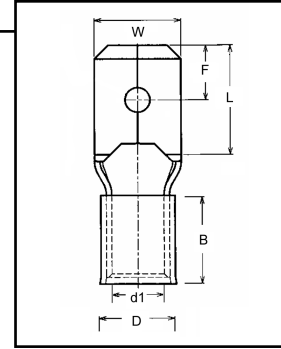

T= Material Thickness

| HOFFMAN PART NO. | WIRE SIZE | TAB         | DIMENSIONS (INCHES) |       |       |       |       |       |   | UL | TAPE MOUNT REEL QTY | DIE FOR TAPE MOUNT | HAND TOOL |
|------------------|-----------|-------------|---------------------|-------|-------|-------|-------|-------|---|----|---------------------|--------------------|-----------|
|                  |           |             | W                   | F     | L     | B     | D     | T     |   |    |                     |                    |           |
| DDM2216T2505.9/J | 22-16     | .250 x .032 | 0.248               | 0.315 | 0.650 | 0.195 | 0.114 | 0.016 | Y | NA | NA                  | YDT2216            |           |
| DDM1614T2505.9/J | 16-14     | .250 x .032 | 0.248               | 0.315 | 0.650 | 0.195 | 0.138 | 0.016 | Y | NA | NA                  | YDT1614            |           |
| DDM1210T2506.9/J | 12-10     | .250 x .032 | 0.248               | 0.315 | 0.748 | 0.235 | 0.185 | 0.016 | Y | NA | NA                  | YDT1210            |           |

## Vinyl Insulated Disconnects

### Vinyl Insulated Female Disconnect

**Material:** Tin Plated Brass

**Insulation Material:** Vinyl

**Maximum Electrical Rating:** 75°C, 300V

**Maximum Electrical Current:** 22-16: 10 Amps  
16-14: 15 Amps  
12-10: 24 Amps

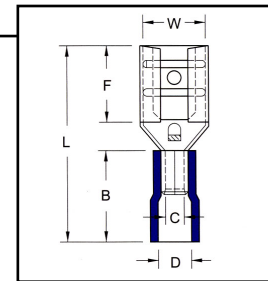

T= Material Thickness

| HOFFMAN PART NO. | WIRE SIZE | TAB         | DIMENSIONS (INCHES) |       |       |       |       |       |   | UL   | TAPE MOUNT REEL QTY | DIE FOR TAPE MOUNT | HAND TOOL |
|------------------|-----------|-------------|---------------------|-------|-------|-------|-------|-------|---|------|---------------------|--------------------|-----------|
|                  |           |             | W                   | F     | L     | B     | D     | T     |   |      |                     |                    |           |
| FVDF2216T110A5   | 22-16     | .110 x .020 | 0.126               | 0.256 | 0.732 | 0.394 | 0.157 | 0.012 | Y | 1000 | 3F2216              | YNM2210C           |           |
| FVDF2216T110A8   | 22-16     | .110 x .032 | 0.125               | 0.256 | 0.732 | 0.394 | 0.157 | 0.012 | Y | 1000 | 3F2216              | YNM2210C           |           |
| FVDF2216T187A5   | 22-16     | .187 x .020 | 0.197               | 0.252 | 0.748 | 0.394 | 0.157 | 0.014 | Y | 1000 | 3F2216              | YNM2210C           |           |
| FVDF2216T187A8   | 22-16     | .187 x .032 | 0.197               | 0.252 | 0.748 | 0.394 | 0.157 | 0.014 | Y | 1000 | 3F2216              | YNM2210C           |           |
| FVDF2216T250A    | 22-16     | .250 x .032 | 0.260               | 0.295 | 0.807 | 0.394 | 0.157 | 0.016 | Y | 1000 | 3F2216              | YNM2210C           |           |
| FVDF1614T187A5   | 16-14     | .187 x .020 | 0.197               | 0.252 | 0.748 | 0.394 | 0.177 | 0.014 | Y | 1000 | 3F1614              | YNM2210C           |           |
| FVDF1614T187A8   | 16-14     | .187 x .032 | 0.197               | 0.252 | 0.748 | 0.394 | 0.177 | 0.014 | Y | 1000 | 3F1614              | YNM2210C           |           |
| FVDF1614T250A    | 16-14     | .250 x .032 | 0.260               | 0.295 | 0.807 | 0.394 | 0.177 | 0.016 | Y | 1000 | 3F1614              | YNM2210C           |           |
| FVDF1614T250A/J  | 16-14     | .250 x .032 | 0.260               | 0.307 | 0.807 | 0.374 | 0.169 | 0.016 | Y | 1000 | 3F1614              | YNT1614            |           |
| FVDF1210T250A    | 12-10     | .250 x .032 | 0.260               | 0.295 | 0.925 | 0.512 | 0.512 | 0.016 | Y | 500  | 3F1210              | YNM2210C           |           |
| FVDF1210T250A/J  | 12-10     | .250 x .032 | 0.260               | 0.307 | 0.965 | 0.532 | 0.244 | 0.016 | Y | 500  | 3F1210              | YNT1210S           |           |

### Vinyl Insulated Male Disconnect

**Material:** Tin Plated Brass

**Insulation Material:** Vinyl

**Maximum Electrical Rating:** 75°C, 300V

**Maximum Electrical Current:** 22-16: 10 Amps  
 16-14: 15 Amps  
 12-10: 24 Amps

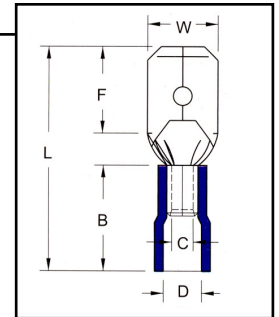

T= Material Thickness

| HOFFMAN PART NO. | WIRE SIZE | TAB         | DIMENSIONS (INCHES) |       |       |       |       |       |    | T    | UL     | TAPE MOUNT REEL QTY | DIE FOR TAPE MOUNT | HAND TOOL |
|------------------|-----------|-------------|---------------------|-------|-------|-------|-------|-------|----|------|--------|---------------------|--------------------|-----------|
|                  |           |             | W                   | F     | L     | B     | D     | T     | UL |      |        |                     |                    |           |
| FVDM2216T110A5   | 22-16     | .110 x .020 | 0.110               | 0.256 | 0.728 | 0.394 | 0.157 | 0.020 | Y  | 1000 | 3F2216 | YNM2210C            |                    |           |
| FVDM2216T110A8   | 22-16     | .110 x .032 | 0.110               | 0.256 | 0.728 | 0.394 | 0.157 | 0.016 | Y  | 1000 | 3F2216 | YNM2210C            |                    |           |
| FVDM2216T187A5   | 22-16     | .187 x .020 | 0.189               | 0.256 | 0.748 | 0.394 | 0.157 | 0.020 | Y  | 1000 | 3F2216 | YNM2210C            |                    |           |
| FVDM2216T187A8   | 22-16     | .187 x .032 | 0.189               | 0.264 | 0.748 | 0.394 | 0.157 | 0.016 | Y  | 1000 | 3F2216 | YNM2210C            |                    |           |
| FVDM2216T250     | 22-16     | .250 x .032 | 0.250               | 0.303 | 0.827 | 0.394 | 0.157 | 0.016 | Y  | 1000 | 3F2216 | YNM2210C            |                    |           |
| FVDM1614T187A5   | 16-14     | .187 x .020 | 0.189               | 0.256 | 0.748 | 0.394 | 0.177 | 0.020 | Y  | 1000 | 3F1614 | YNM2210C            |                    |           |
| FVDM1614T187A8   | 16-14     | .187 x .032 | 0.189               | 0.264 | 0.748 | 0.394 | 0.177 | 0.016 | Y  | 1000 | 3F1614 | YNM2210C            |                    |           |
| FVDM1614T250     | 16-14     | .250 x .032 | 0.250               | 0.303 | 0.827 | 0.394 | 0.177 | 0.016 | Y  | 1000 | 3F1614 | YNM2210C            |                    |           |
| FVDM1210T250     | 12-10     | .250 x .032 | 0.250               | 0.303 | 0.945 | 0.512 | 0.217 | 0.016 | Y  | 500  | 3F1210 | YNM2210C            |                    |           |
| FVDM1210T250/J   | 12-10     | .250 x .032 | 0.248               | 0.335 | 0.965 | 0.531 | 0.244 | 0.016 | Y  | 500  | 3F1210 | YNT1210S            |                    |           |

### Vinyl Insulated Female Disconnect with Support Sleeve

**Material:** Tin Plated Brass

**Insulation Material:** Vinyl

**Maximum Electrical Rating:** 75°C, 300V

**Maximum Electrical Current:** 22-16: 10 Amps  
 16-14: 15 Amps  
 12-10: 24 Amps

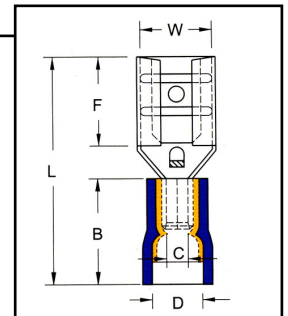

T= Material Thickness

| HOFFMAN PART NO. | WIRE SIZE | TAB         | DIMENSIONS (INCHES) |       |       |       |       |       |    | T    | UL     | TAPE MOUNT REEL QTY | DIE FOR TAPE MOUNT | HAND TOOL |
|------------------|-----------|-------------|---------------------|-------|-------|-------|-------|-------|----|------|--------|---------------------|--------------------|-----------|
|                  |           |             | W                   | F     | L     | B     | D     | T     | UL |      |        |                     |                    |           |
| FVHDF2216T110A5  | 22-16     | .110 x .020 | 0.126               | 0.256 | 0.748 | 0.413 | 0.150 | 0.012 | Y  | 1000 | 3V2216 | YNM2210D            |                    |           |
| FVHDF2216T110A8  | 22-16     | .110 x .032 | 0.126               | 0.256 | 0.748 | 0.413 | 0.150 | 0.012 | Y  | 1000 | 3V2216 | YNM2210D            |                    |           |
| FVHDF2216T187A5  | 22-16     | .187 x .020 | 0.197               | 0.252 | 0.764 | 0.413 | 0.150 | 0.014 | Y  | 1000 | 3V2216 | YNM2210D            |                    |           |
| FVHDF2216T187A8  | 22-16     | .187 x .032 | 0.197               | 0.252 | 0.764 | 0.413 | 0.150 | 0.014 | Y  | 1000 | 3V2216 | YNM2210D            |                    |           |
| FVHDF2216T250A   | 22-16     | .250 x .032 | 0.260               | 0.295 | 0.819 | 0.413 | 0.150 | 0.016 | Y  | 1000 | 3V2216 | YNM2210D            |                    |           |
| FVHDF1614T110A5  | 16-14     | .110 x .020 | 0.126               | 0.256 | 0.748 | 0.413 | 0.185 | 0.012 | Y  | 1000 | 3V1614 | YNM2210D            |                    |           |
| FVHDF1614T110A8  | 16-14     | .110 x .032 | 0.126               | 0.256 | 0.748 | 0.413 | 0.185 | 0.012 | Y  | 1000 | 3V1614 | YNM2210D            |                    |           |
| FVHDF1614T187A5  | 16-14     | .187 x .020 | 0.197               | 0.252 | 0.764 | 0.413 | 0.185 | 0.014 | Y  | 1000 | 3V1614 | YNM2210D            |                    |           |
| FVHDF1614T187A8  | 16-14     | .187 x .032 | 0.197               | 0.252 | 0.764 | 0.413 | 0.185 | 0.014 | Y  | 1000 | 3V1614 | YNM2210D            |                    |           |
| FVHDF1614T250A   | 16-14     | .250 x .032 | 0.260               | 0.297 | 0.819 | 0.413 | 0.185 | 0.016 | Y  | 1000 | 3V1614 | YNM2210D            |                    |           |
| FVDDF1210T250A   | 12-10     | .250 x .032 | 0.260               | 0.295 | 0.917 | 0.512 | 0.244 | 0.016 | Y  | 500  | 3V1210 | YNM2210D            |                    |           |
| FVDDF1210T250A/J | 12-10     | .250 x .032 | 0.291               | 0.307 | 0.965 | 0.531 | 0.244 | 0.016 | Y  | 500  | 3V1210 | YNT1210S            |                    |           |



## Vinyl Insulated Male Disconnect with Support Sleeve

**Material:** Tin Plated Brass

**Insulation Material:** Vinyl

**Maximum Electrical Rating:** 75°C, 300V

**Maximum Electrical Current:** 22-16: 10 Amps  
 16-14: 15 Amps  
 12-10: 24 Amps

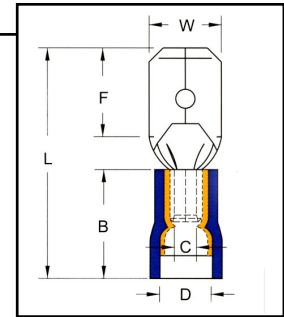

T = Material Thickness

| HOFFMAN PART NO. | WIRE SIZE | TAB         | DIMENSIONS (INCHES) |       |       |       |       |       |   | UL   | TAPE MOUNT REEL QTY | DIE FOR TAPE MOUNT | HAND TOOL |
|------------------|-----------|-------------|---------------------|-------|-------|-------|-------|-------|---|------|---------------------|--------------------|-----------|
|                  |           |             | W                   | F     | L     | B     | D     | T     |   |      |                     |                    |           |
| FVDDM2216T250    | 22-16     | .250 x .032 | 0.250               | 0.303 | 0.858 | 0.413 | 0.150 | 0.016 | Y | 1000 | 3V2216              | YNM2210D           |           |
| FVDDM1614T250    | 16-14     | .250 x .032 | 0.250               | 0.303 | 0.858 | 0.413 | 0.185 | 0.016 | Y | 1000 | 3V1614              | YNM2210D           |           |
| FVDDM1614T250/J  | 16-14     | .250 x .032 | 0.248               | 0.315 | 0.807 | 0.374 | 0.169 | 0.016 | Y | 1000 | 3V1614              | YNT1614            |           |
| FVDDM1210T250    | 12-10     | .250 x .032 | 0.250               | 0.303 | 0.945 | 0.512 | 0.244 | 0.016 | Y | 500  | 3V1210              | YNM2210D           |           |

## Fully Vinyl Insulated Female Disconnect with Support Sleeve

**Material:** Tin Plated Brass

**Insulation Material:** Vinyl

**Maximum Electrical Rating:** 75°C, 300V

**Maximum Electrical Current:** 22-16: 10 Amps  
 16-14: 15 Amps  
 12-10: 24 Amps

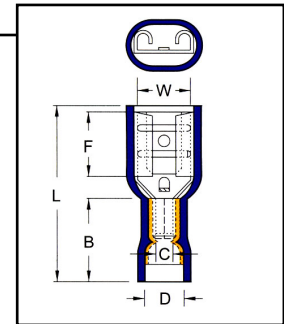

T = Material Thickness

| HOFFMAN PART NO.  | WIRE SIZE | TAB         | DIMENSIONS (INCHES) |       |       |       |       |       |   | UL  | TAPE MOUNT REEL QTY | DIE FOR TAPE MOUNT | HAND TOOL |
|-------------------|-----------|-------------|---------------------|-------|-------|-------|-------|-------|---|-----|---------------------|--------------------|-----------|
|                   |           |             | W                   | F     | L     | B     | D     | T     |   |     |                     |                    |           |
| LVDHF2216T110A5   | 22-16     | .110 X .020 | 0.126               | 0.256 | 0.748 | 0.413 | 0.150 | 0.012 | Y | 500 | 3V2216              | YNM2210D           |           |
| LVDHF2216T110A8   | 22-16     | .110 X .032 | 0.126               | 0.256 | 0.748 | 0.413 | 0.150 | 0.012 | Y | 500 | 3V2216              | YNM2210D           |           |
| LVDHF2216T187A5   | 22-16     | .187 x .020 | 0.197               | 0.252 | 0.807 | 0.413 | 0.150 | 0.014 | Y | 500 | 3V2216              | YNM2210D           |           |
| LVDHF2216T187A8   | 22-16     | .187 x .032 | 0.197               | 0.252 | 0.807 | 0.413 | 0.150 | 0.014 | Y | 500 | 3V2216              | YNM2210D           |           |
| LVDHF2216T187A8/J | 22-16     | .187 x .032 | 0.224               | 0.236 | 0.807 | 0.433 | 0.142 | 0.014 | Y | 500 | 3V2216              | YNT2216            |           |
| LVDHF2216T250A    | 22-16     | .250 x .032 | 0.260               | 0.295 | 0.858 | 0.413 | 0.150 | 0.016 | Y | 500 | 3V2216              | YNM2210D           |           |
| LVDHF1614T110A5   | 16-14     | .110 X .020 | 0.126               | 0.256 | 0.748 | 0.413 | 0.185 | 0.012 | Y | 500 | 3V1614              | YNM2210D           |           |
| LVDHF1614T110A8   | 16-14     | .110 X .032 | 0.126               | 0.256 | 0.748 | 0.413 | 0.185 | 0.012 | Y | 500 | 3V1614              | YNM2210D           |           |
| LVDHF1614T187A5   | 16-14     | .187 x .020 | 0.197               | 0.252 | 0.795 | 0.413 | 0.185 | 0.014 | Y | 500 | 3V1614              | YNM2210D           |           |
| LVDHF1614T187A8   | 16-14     | .187 x .032 | 0.197               | 0.252 | 0.795 | 0.413 | 0.185 | 0.014 | Y | 500 | 3V1614              | YNM2210D           |           |
| LVDHF1614T250A    | 16-14     | .250 x .032 | 0.260               | 0.295 | 0.874 | 0.413 | 0.185 | 0.016 | Y | 500 | 3V1614              | YNM2210D           |           |
| LVDDF1210T250A    | 12-10     | .250 x .032 | 0.260               | 0.295 | 0.953 | 0.492 | 0.244 | 0.016 | Y | 500 | 3V1210              | YNM2210D           |           |
| LVDDF1210T250A/J  | 12-10     | .250 x .032 | 0.291               | 0.307 | 0.984 | 0.551 | 0.177 | 0.016 | Y | 500 | 3V1210              | YNT1210S           |           |



# PC Insulated Disconnects

## PC Insulated Female Disconnect with Support Sleeve

**Material:** Tin Plated Brass with Copper Support Sleeve

**Insulation Material:** PC Insulated

**Maximum Electrical Rating:** 125°C, 600V

**Maximum Electrical Current:** 22-16: 10 Amps  
 16-14: 15 Amps  
 12-10: 24 Amps

**Barrel ID (d1):** 0.067  
**Barrel ID (d1):** 0.091  
**Barrel ID (d1):** 0.134

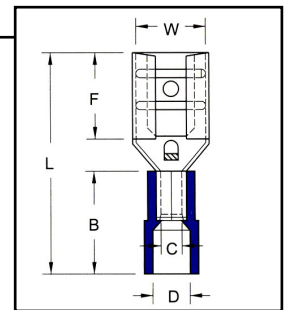

T= Material Thickness

| HOFFMAN PART NO. | WIRE SIZE | TAB         | DIMENSIONS (INCHES) |       |       |       |       |       |   | UL   | TAPE MOUNT REEL QTY | DIE FOR TAPE MOUNT | HAND TOOL |
|------------------|-----------|-------------|---------------------|-------|-------|-------|-------|-------|---|------|---------------------|--------------------|-----------|
|                  |           |             | W                   | F     | L     | B     | D     | T     |   |      |                     |                    |           |
| FNDDF2216T110A5  | 22-16     | .110 x .020 | 0.126               | 0.256 | 0.772 | 0.433 | 0.157 | 0.012 | Y | 1000 | 3V2216              | YNM2210D           |           |
| FNDDF2216T110A8  | 22-16     | .110 x .032 | 0.126               | 0.256 | 0.772 | 0.433 | 0.157 | 0.012 | Y | 1000 | 3V2216              | YNM2210D           |           |
| FNDDF2216T187A5  | 22-16     | .187 x .020 | 0.197               | 0.252 | 0.787 | 0.433 | 0.157 | 0.014 | Y | 1000 | 3V2216              | YNM2210D           |           |
| FNDDF2216T187A8  | 22-16     | .187 x .032 | 0.197               | 0.252 | 0.787 | 0.433 | 0.157 | 0.014 | Y | 1000 | 3V2216              | YNM2210D           |           |
| FNDDF2216T250A   | 22-16     | .250 x .032 | 0.260               | 0.295 | 0.846 | 0.433 | 0.157 | 0.016 | Y | 1000 | 3V2216              | YNM2210D           |           |
| FNDDF1614T110A5  | 16-14     | .110 x .020 | 0.126               | 0.256 | 0.772 | 0.433 | 0.197 | 0.012 | Y | 1000 | 3V1614              | YNM2210D           |           |
| FNDDF1614T110A8  | 16-14     | .110 x .032 | 0.126               | 0.256 | 0.772 | 0.433 | 0.197 | 0.012 | Y | 1000 | 3V1614              | YNM2210D           |           |
| FNDDF1614T187A5  | 16-14     | .187 x .020 | 0.197               | 0.252 | 0.787 | 0.433 | 0.197 | 0.014 | Y | 1000 | 3V1614              | YNM2210D           |           |
| FNDDF1614T187A8  | 16-14     | .187 x .032 | 0.197               | 0.252 | 0.787 | 0.433 | 0.197 | 0.014 | Y | 1000 | 3V1614              | YNM2210D           |           |
| FNDDF1614T250A   | 16-14     | .250 x .032 | 0.260               | 0.295 | 0.846 | 0.433 | 0.197 | 0.016 | Y | 1000 | 3V1614              | YNM2210D           |           |
| FNDDF1210T187A5  | 12-10     | .187 x .020 | 0.197               | 0.256 | 0.866 | 0.512 | 0.256 | 0.014 | Y | 500  | 3V1210              | YNM2210D           |           |
| FNDDF1210T187A8  | 12-10     | .187 x .032 | 0.197               | 0.256 | 0.866 | 0.512 | 0.256 | 0.014 | Y | 500  | 3V1210              | YNM2210D           |           |
| FNDDF1210T250A   | 12-10     | .250 x .032 | 0.260               | 0.295 | 0.925 | 0.512 | 0.256 | 0.016 | Y | 500  | 3V1210              | YNM2210D           |           |

## PC Insulated Male Disconnect with Support Sleeve

**Material:** Tin Plated Brass with Copper Support Sleeve

**Insulation Material:** PC Insulated

**Maximum Electrical Rating:** 125°C, 600V

**Maximum Electrical Current:** 22-16: 10 Amps  
 16-14: 15 Amps  
 12-10: 24 Amps

**Barrel ID (d1):** 0.067  
**Barrel ID (d1):** 0.091  
**Barrel ID (d1):** 0.134

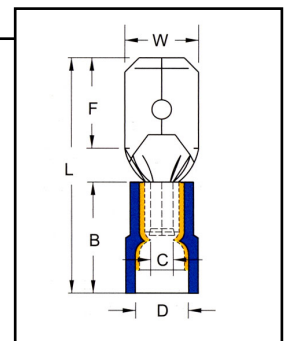

T= Material Thickness

| HOFFMAN PART NO. | WIRE SIZE | TAB         | DIMENSIONS (INCHES) |       |       |       |       |       |   | UL   | TAPE MOUNT REEL QTY | DIE FOR TAPE MOUNT | HAND TOOL |
|------------------|-----------|-------------|---------------------|-------|-------|-------|-------|-------|---|------|---------------------|--------------------|-----------|
|                  |           |             | W                   | F     | L     | B     | D     | T     |   |      |                     |                    |           |
| FNDDM2216T110A5  | 22-16     | .110 x .020 | 0.110               | 0.256 | 0.768 | 0.433 | 0.157 | 0.020 | Y | 1000 | 3V2216              | YNM2210D           |           |
| FNDDM2216T110A8  | 22-16     | .110 x .032 | 0.110               | 0.256 | 0.768 | 0.433 | 0.157 | 0.016 | Y | 1000 | 3V2216              | YNM2210D           |           |
| FNDDM2216T187A5  | 22-16     | .187 x .020 | 0.189               | 0.256 | 0.787 | 0.433 | 0.157 | 0.020 | Y | 1000 | 3V2216              | YNM2210D           |           |
| FNDDM2216T187A8  | 22-16     | .187 x .032 | 0.189               | 0.264 | 0.787 | 0.433 | 0.157 | 0.016 | Y | 1000 | 3V2216              | YNM2210D           |           |
| FNDDM2216T250    | 22-16     | .250 x .032 | 0.250               | 0.303 | 0.866 | 0.433 | 0.157 | 0.016 | Y | 1000 | 3V2216              | YNM2210D           |           |
| FNDDM1614T187A5  | 16-14     | .187 x .020 | 0.189               | 0.256 | 0.787 | 0.433 | 0.197 | 0.020 | Y | 1000 | 3V1614              | YNM2210D           |           |
| FNDDM1614T187A8  | 16-14     | .187 x .032 | 0.189               | 0.264 | 0.787 | 0.433 | 0.197 | 0.016 | Y | 1000 | 3V1614              | YNM2210D           |           |
| FNDDM1614T250    | 16-14     | .250 x .032 | 0.250               | 0.303 | 0.866 | 0.433 | 0.197 | 0.016 | Y | 1000 | 3V1614              | YNM2210D           |           |
| FNDDM1210T250    | 12-10     | .250 x .032 | 0.250               | 0.303 | 0.945 | 0.512 | 0.256 | 0.016 | Y | 500  | 3V1210              | YNM2210D           |           |



## PC Fully Insulated Female Disconnect with Support Sleeve

**Material:** Tin Plated Brass with Copper Support Sleeve

**Insulation Material:** PC Insulated

**Maximum Electrical Rating:** 125°C, 600V

**Maximum Electrical Current:** 22-16: 10 Amps  
 16-14: 15 Amps  
 12-10: 24 Amps

**Barrel ID (d1):** 0.067  
**Barrel ID (d1):** 0.091  
**Barrel ID (d1):** 0.134

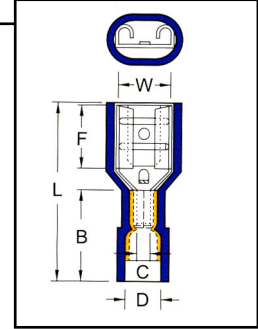

T= Material Thickness

| HOFFMAN PART NO. | WIRE SIZE | TAB         | DIMENSIONS (INCHES) |       |       |       |       |       |   | UL  | TAPE MOUNT REEL QTY | DIE FOR TAPE MOUNT | HAND TOOL |
|------------------|-----------|-------------|---------------------|-------|-------|-------|-------|-------|---|-----|---------------------|--------------------|-----------|
|                  |           |             | W                   | F     | L     | B     | D     | T     |   |     |                     |                    |           |
| LNDDF2216T110A5  | 22-16     | .110 x .020 | 0.126               | 0.256 | 0.768 | 0.433 | 0.157 | 0.012 | Y | 500 | 3V2216              | YNM2210D           |           |
| LNDDF2216T110A8  | 22-16     | .110 x .032 | 0.126               | 0.256 | 0.768 | 0.433 | 0.157 | 0.012 | Y | 500 | 3V2216              | YNM2210D           |           |
| LNDDF2216T187A5  | 22-16     | .187 x .020 | 0.197               | 0.252 | 0.795 | 0.433 | 0.157 | 0.014 | Y | 500 | 3V2216              | YNM2210D           |           |
| LNDDF2216T187A8  | 22-16     | .187 x .032 | 0.197               | 0.252 | 0.795 | 0.433 | 0.157 | 0.014 | Y | 500 | 3V2216              | YNM2210D           |           |
| LNDDF2216T250A   | 22-16     | .250 x .032 | 0.260               | 0.295 | 0.846 | 0.433 | 0.157 | 0.016 | Y | 500 | 3V2216              | YNM2210D           |           |
| LNDDF1614T187A5  | 16-14     | .187 x .020 | 0.197               | 0.252 | 0.795 | 0.433 | 0.197 | 0.016 | Y | 500 | 3V1614              | YNM2210D           |           |
| LNDDF1614T187A8  | 16-14     | .187 x .032 | 0.197               | 0.252 | 0.795 | 0.433 | 0.197 | 0.016 | Y | 500 | 3V1614              | YNM2210D           |           |
| LNDDF1614T250A   | 16-14     | .250 x .032 | 0.260               | 0.295 | 0.846 | 0.433 | 0.197 | 0.016 | Y | 500 | 3V1614              | YNM2210D           |           |
| LNDDF1210T250A   | 12-10     | .250 x .032 | 0.260               | 0.295 | 0.953 | 0.512 | 0.256 | 0.016 | Y | 500 | 3V1210              | YNM2210D           |           |

## Nylon Couplars Sets

### Nylon Fully Insulated Couplars

**Material:** Tin Plated Brass

**Insulation Material:** UL94V2 6/6 Nylon

**Maximum Electrical Rating:** 105°C, 300V

**Maximum Electrical Current:** 22-16: 10 Amps  
 16-14: 15 Amps  
 12-10: 24 Amps

**Barrel ID (d1):** 0.067  
**Barrel ID (d1):** 0.091  
**Barrel ID (d1):** 0.134

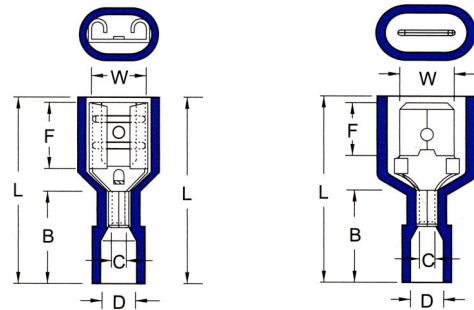

T= Material Thickness

| HOFFMAN PART NO. | WIRE SIZE | TAB         | DIMENSIONS (INCHES) |       |       |       |       |       |   | UL  | TAPE MOUNT REEL QTY | DIE FOR TAPE MOUNT | HAND TOOL |
|------------------|-----------|-------------|---------------------|-------|-------|-------|-------|-------|---|-----|---------------------|--------------------|-----------|
|                  |           |             | W                   | F     | L     | B     | D     | T     |   |     |                     |                    |           |
| <b>FEMALE</b>    |           |             |                     |       |       |       |       |       |   |     |                     |                    |           |
| LNDF2216250H     | 22-16     | .250 x .032 | 0.260               | 0.295 | 0.866 | 0.433 | 0.157 | 0.016 | Y | 500 | 3F2216              | YNM2210C           |           |
| LNDF1614250H     | 16-14     | .250 x .032 | 0.260               | 0.295 | 0.866 | 0.433 | 0.177 | 0.016 | Y | 500 | 3F1614              | YNM2210C           |           |
| LNDF1210250H     | 12-10     | .250 x .032 | 0.260               | 0.295 | 0.945 | 0.512 | 0.248 | 0.016 | Y | 500 | 3F1210              | YNM2210C           |           |
| <b>MALE</b>      |           |             |                     |       |       |       |       |       |   |     |                     |                    |           |
| LNDM2216250H     | 22-16     | .250 x .032 | 0.250               | 0.303 | 0.945 | 0.433 | 0.157 | 0.016 | Y | 500 | 3F2216              | YNM2210C           |           |
| LNDM1614250H     | 16-14     | .250 x .032 | 0.250               | 0.303 | 0.906 | 0.433 | 0.177 | 0.016 | Y | 500 | 3F1614              | YNM2210C           |           |
| LNDM1210250H     | 12-10     | .250 x .032 | 0.250               | 0.303 | 0.984 | 0.512 | 0.248 | 0.016 | Y | 500 | 3F1210              | YNM2210C           |           |





# Piggyback Connectors

## Non-Insulated Piggyback Connectors

**Material:** Tin Plated Brass

**Temperature:** 300°F

**Maximum Electrical Current:** 22-16: 10 Amps  
 16-14: 15 Amps  
 12-10: 24 Amps

**Barrel ID (d1):** 0.067  
**Barrel ID (d1):** 0.091  
**Barrel ID (d1):** 0.134

T= Material Thickness

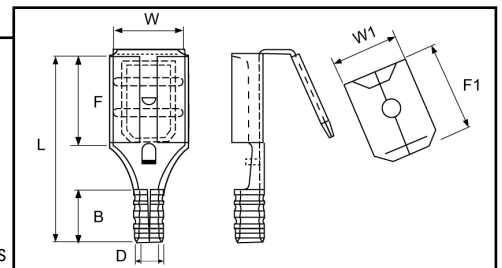

| HOFFMAN PART NO. | WIRE SIZE | TAB         | DIMENSIONS (INCHES) |      |      |      |      |      |      |      |   | UL | TAPE MOUNT REEL QTY | DIE FOR TAPE MOUNT | HAND TOOL |
|------------------|-----------|-------------|---------------------|------|------|------|------|------|------|------|---|----|---------------------|--------------------|-----------|
|                  |           |             | W                   | W1   | F    | F1   | L    | B    | D    | T    |   |    |                     |                    |           |
| DFM2216T250A     | 22-16     | .250 x .032 | .260                | .250 | .315 | .232 | .630 | .189 | .106 | .031 | N | NA | NA                  | YHM228             |           |
| DFM1614T250A     | 16-14     | .250 x .032 | .260                | .250 | .315 | .323 | .598 | .189 | .130 | .031 | N | NA | NA                  | YHM228             |           |

## Vinyl Insulated Piggyback Connectors

**Material:** Tin Plated Brass

**Insulation Material:** Vinyl

**Maximum Electrical Rating:** 75°C, 300V

**Maximum Electrical Current:** 22-16: 10 Amps  
 16-14: 15 Amps  
 12-10: 24 Amps

**Barrel ID (d1):** 0.067  
**Barrel ID (d1):** 0.091  
**Barrel ID (d1):** 0.134

T= Material Thickness

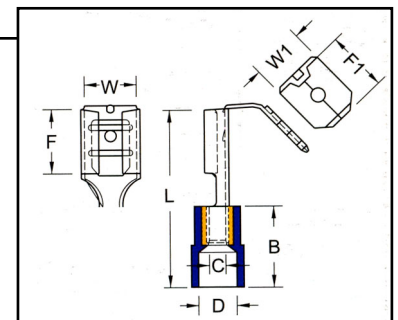

| HOFFMAN PART NO. | WIRE SIZE | TAB         | DIMENSIONS (INCHES) |      |       |       |       |       |       |       |   | UL | TAPE MOUNT REEL QTY | DIE FOR TAPE MOUNT | HAND TOOL |
|------------------|-----------|-------------|---------------------|------|-------|-------|-------|-------|-------|-------|---|----|---------------------|--------------------|-----------|
|                  |           |             | W                   | W1   | F     | F1    | L     | B     | D     | T     |   |    |                     |                    |           |
| FVDFM2216T250A   | 22-16     | .250 x .032 | .260                | .250 | 0.315 | 0.323 | 0.866 | 0.394 | 0.157 | 0.016 | N | NA | NA                  | YNM2210C           |           |
| FVDFM1614T250A   | 16-14     | .250 x .032 | .260                | .250 | 0.315 | 0.323 | 0.866 | 0.394 | 0.177 | 0.016 | N | NA | NA                  | YNT1614            |           |
| FVDFM1614T250A/J | 16-14     | .250 x .032 | .268                | .248 | 0.307 | 0.315 | 0.875 | 0.374 | 0.169 | 0.016 | Y | NA | NA                  | YNM2210C           |           |
| FVDFM1210T250A   | 12-10     | .250 x .032 | .260                | .250 | 0.315 | 0.323 | 0.945 | 0.512 | 0.217 | 0.016 | N | NA | NA                  | YNM2210C           |           |

## Vinyl Insulated Piggyback with Support Sleeve

**Material:** Tin Plated Brass

**Insulation Material:** Vinyl

**Maximum Electrical Rating:** 75°C, 300V

**Maximum Electrical Current:** 22-16: 10 Amps  
 16-14: 15 Amps  
 12-10: 24 Amps

**Barrel ID (d1):** 0.067  
**Barrel ID (d1):** 0.091  
**Barrel ID (d1):** 0.134

T= Material Thickness

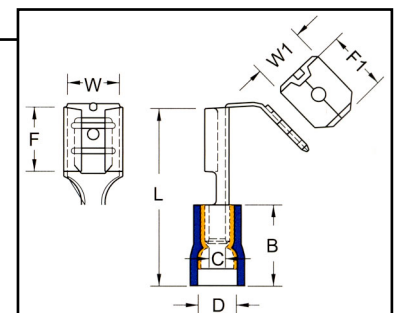

| HOFFMAN PART NO. | WIRE SIZE | TAB         | DIMENSIONS (INCHES) |      |       |       |       |       |       |       |   | UL | TAPE MOUNT REEL QTY | DIE FOR TAPE ON REEL | HAND TOOL |
|------------------|-----------|-------------|---------------------|------|-------|-------|-------|-------|-------|-------|---|----|---------------------|----------------------|-----------|
|                  |           |             | W                   | W1   | F     | F1    | L     | B     | D     | T     |   |    |                     |                      |           |
| FVDDFM2216T250A  | 22-16     | .250 x .032 | .260                | .250 | 0.315 | 0.323 | 0.886 | 0.413 | 0.150 | 0.016 | Y | NA | NA                  | YNM2210D             |           |
| FVDDFM1614T250A  | 16-14     | .250 x .032 | .260                | .250 | 0.315 | 0.323 | 0.886 | 0.413 | 0.185 | 0.016 | Y | NA | NA                  | YNM2210D             |           |
| FVDDFM1210T250A  | 12-10     | .250 x .032 | .260                | .250 | 0.315 | 0.323 | 0.945 | 0.512 | 0.244 | 0.016 | Y | NA | NA                  | YNM2210D             |           |



## Nylon Insulated Piggyback with Support Sleeve

**Material:** Tin Plated Brass

**Insulation Material:** 6/6 UL94V2 Nylon

**Maximum Electrical Rating:** 105°C, 300V

**Maximum Electrical Current:** 22-16: 10 Amps  
 16-14: 15 Amps  
 12-10: 24 Amps

**Barrel ID (d1):** 0.067

**Barrel ID (d1):** 0.091

**Barrel ID (d1):** 0.134

T= Material Thickness

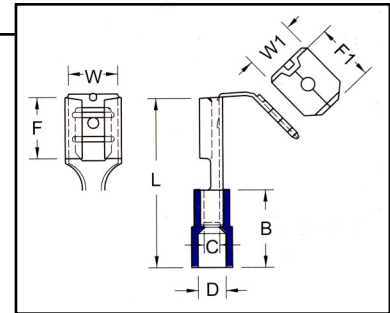

| HOFFMAN PART NO. | WIRE SIZE | TAB         | DIMENSIONS (INCHES) |       |       |       |       |       |       |       | T | TAPES | DIE FOR MOUNT REEL QTY | HAND TAPE MOUNT | TOOL |
|------------------|-----------|-------------|---------------------|-------|-------|-------|-------|-------|-------|-------|---|-------|------------------------|-----------------|------|
|                  |           |             | W                   | W1    | F     | F1    | L     | B     | D     | UL    |   |       |                        |                 |      |
| FNDDFM2216T250A  | 22-16     | .250 x .032 | 0.260               | 0.250 | 0.315 | 0.323 | 0.906 | 0.433 | 0.157 | 0.016 | Y | NA    | NA                     | YNM2210D        |      |
| FNDDFM1614T250A  | 16-14     | .250 x .032 | 0.260               | 0.250 | 0.315 | 0.323 | 0.906 | 0.433 | 0.197 | 0.016 | Y | NA    | NA                     | YNM2210D        |      |
| FNDDFM1210T250A  | 12-10     | .250 x .032 | 0.260               | 0.250 | 0.315 | 0.323 | 0.945 | 0.512 | 0.256 | 0.016 | Y | NA    | NA                     | YNM2210D        |      |

## Knife Disconnects

### Vinyl Insulated Knife Disconnects

**Material:** Tin Plated Brass

**Insulation Material:** Vinyl

**Maximum Electrical Rating:** 75°C, 300V

T= Material Thickness

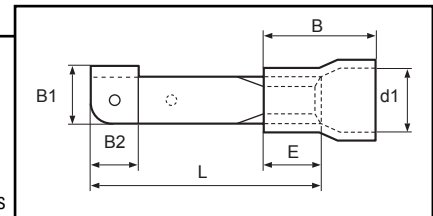

| HOFFMAN PART NO. | WIRE SIZE | TAB | DIMENSIONS (INCHES) |       |       |       |       |       |       | T  | UL | TAPES | DIE FOR TAPE MOUNT | HAND TOOL |
|------------------|-----------|-----|---------------------|-------|-------|-------|-------|-------|-------|----|----|-------|--------------------|-----------|
|                  |           |     | L                   | E     | B1    | B2    | B     | D     | UL    |    |    |       |                    |           |
| FV2216K/J        | 22-16     | NA  | 0.673               | 0.189 | 0.197 | 0.161 | 0.354 | 0.157 | 0.031 | NA | NA | NA    | YHM228             |           |
| FV1614K/J        | 16-14     | NA  | 0.717               | 0.173 | 0.197 | 0.154 | 0.354 | 0.177 | 0.031 | NA | NA | NA    | YHM228             |           |
| FV1210K/J        | 12-10     | NA  | 0.917               | 0.244 | 0.280 | 0.220 | 0.531 | 0.268 | 0.039 | NA | NA | NA    | YHM228             |           |



# Female Flag Disconnects

## Non-Insulated Female Flag Disconnects

**Material:** Tin Plated Brass

**Temperature:** 300°F

**Maximum Electrical Current:** 22-16: 10 Amps    **Barrel ID (d1):** 0.067  
 16-14: 15 Amps    **Barrel ID (d1):** 0.091  
 12-10: 24 Amps    **Barrel ID (d1):** 0.134

T = Material Thickness

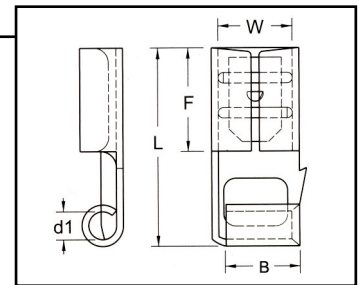

| HOFFMAN PART NO. | WIRE SIZE | TAB         | DIMENSIONS (INCHES) |       |       |       |       | UL | TAPE ON MOUNT REEL QTY | HAND TOOL |
|------------------|-----------|-------------|---------------------|-------|-------|-------|-------|----|------------------------|-----------|
|                  |           |             | W                   | F     | L     | B     | T     |    |                        |           |
| DF22181ST5       | 22-18     | .187 x .020 | .197                | 0.244 | 0.445 | 0.217 | 0.016 | NA | NA                     | FG6100    |
| DF22181ST8       | 22-18     | .187 x .032 | .197                | 0.244 | 0.445 | 0.217 | 0.016 | NA | NA                     | FG6100    |
| DF22181T         | 22-18     | .250 x .032 | .26                 | 0.299 | 0.551 | 0.291 | 0.016 | NA | NA                     | FG6100    |
| DF18141ST5       | 16-14     | .187 x .020 | .197                | 0.244 | 0.457 | 0.217 | 0.016 | NA | NA                     | FG6100    |
| DF18141ST8       | 16-14     | .187 x .032 | .197                | 0.244 | 0.457 | 0.217 | 0.016 | NA | NA                     | FG6100    |
| DF18141T         | 16-14     | .250 x .032 | .26                 | 0.299 | 0.551 | 0.291 | 0.016 | NA | NA                     | FG6100    |
| DF12101T         | 12-10     | .250 x .032 | .26                 | 0.299 | 0.571 | 0.295 | 0.016 | NA | NA                     | FG6100    |

## Nylon Insulated Female Flag Disconnects

**Material:** Tin Plated Brass

**Insulation Material:** 6/6 UL94V2 Nylon

**Maximum Electrical Rating:** 105°C, 300V

**Maximum Electrical Current:** 22-16: 10 Amps    **Barrel ID (d1):** 0.067  
 16-14: 15 Amps    **Barrel ID (d1):** 0.091  
 12-10: 24 Amps    **Barrel ID (d1):** 0.134

T = Material thickness

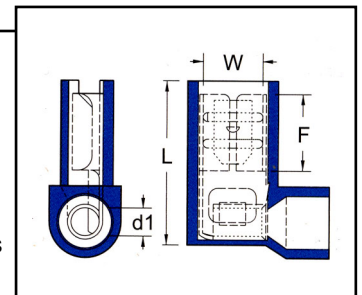

| HOFFMAN PART NO. | WIRE SIZE | TAB         | DIMENSIONS (INCHES) |       |       |       |    | UL   | TAPE MOUNT REEL QTY | DIE FOR SCT70MS MOUNT | HAND TOOL |
|------------------|-----------|-------------|---------------------|-------|-------|-------|----|------|---------------------|-----------------------|-----------|
|                  |           |             | W                   | F     | L     | T     | UL |      |                     |                       |           |
| FNDF22181ST5     | 22-18     | .187 x .020 | 0.197               | 0.276 | 0.591 | 0.016 | Y  | 1000 | AFNDF2DIE           | YNG2214               |           |
| FNDF22181ST8     | 22-18     | .187 x .032 | 0.197               | 0.276 | 0.591 | 0.016 | Y  | 1000 | AFNDF2DIE           | YNG2214               |           |
| FNDF22181T       | 22-18     | .250 x .032 | 0.260               | 0.299 | 0.598 | 0.016 | Y  | 1000 | AFNDF2DIE           | YNG2214               |           |
| FNDF18141ST5     | 16-14     | .187 x .020 | 0.197               | 0.276 | 0.598 | 0.016 | Y  | 1000 | BFNDF2DIE           | YNG2214               |           |
| FNDF18141ST8     | 16-14     | .187 x .032 | 0.197               | 0.276 | 0.598 | 0.016 | Y  | 1000 | BFNDF2DIE           | YNG2214               |           |
| FNDF18141T       | 16-14     | .250 x .032 | 0.260               | 0.299 | 0.598 | 0.016 | Y  | 1000 | BFNDF2DIE           | YNG2214               |           |



## Bullet Connectors

### Vinyl Insulated Bullet Connectors

#### Vinyl Fully Insulated Female Receptacle

**Material:** Tin Plated Brass with Butted Seam

**Insulation Material:** PVC Vinyl

**Maximum Electrical Rating:** 75°C, 300V

**Maximum Electrical Current:** 22-16: 10 Amps  
16-14: 15 Amps  
12-10: 24 Amps

**Barrel ID (d1):** 0.067

**Barrel ID (d1):** 0.091

**Barrel ID (d1):** 0.134

T = Material thickness

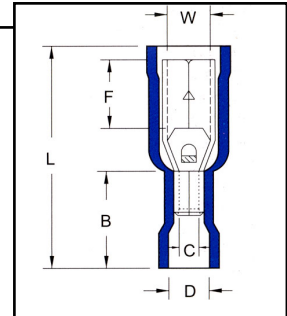

| HOFFMAN PART NO. | WIRE SIZE | DIAMETER | DIMENSIONS (INCHES) |       |       |       |       |       |    | UL  | TAPE MOUNT REEL QTY | DIE FOR TAPE MOUNT | HAND TOOL |
|------------------|-----------|----------|---------------------|-------|-------|-------|-------|-------|----|-----|---------------------|--------------------|-----------|
|                  |           |          | W                   | F     | L     | B     | D     | T     | UL |     |                     |                    |           |
| CVGF2216T5       | 22-16     | 0.156    | 0.154               | 0.276 | 0.906 | 0.413 | 0.157 | 0.016 | Y  | 500 | 3F2216              | YNM2210C           |           |
| CVGF1614T5       | 16-14     | 0.156    | 0.154               | 0.276 | 0.925 | 0.413 | 0.177 | 0.016 | Y  | 500 | 3F1614              | YNM2210C           |           |
| CVGF1210T7       | 12-10     | 0.195    | 0.193               | 0.276 | 0.945 | 0.492 | 0.217 | 0.018 | Y  | 500 | 3F1210              | YNM2210C           |           |

#### Vinyl Fully Insulated Female Receptacle with Support Sleeve

**Material:** Tin Plated Brass with Tin Plated Copper Support Sleeve

**Insulation Material:** PVC Vinyl

**Maximum Electrical Rating:** 75°C, 300V

**Maximum Electrical Current:** 22-16: 10 Amps  
16-14: 15 Amps  
12-10: 24 Amps

**Barrel ID (d1):** 0.067

**Barrel ID (d1):** 0.091

**Barrel ID (d1):** 0.134

T = Material thickness

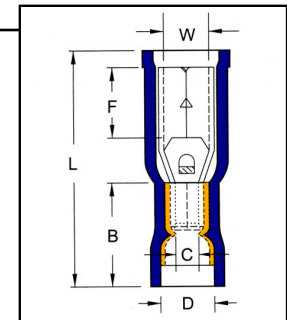

| HOFFMAN PART NO. | WIRE SIZE | DIAMETER | DIMENSIONS (INCHES) |       |       |       |       |       |    | UL  | TAPE MOUNT REEL QTY | DIE FOR TAPE MOUNT | HAND TOOL |
|------------------|-----------|----------|---------------------|-------|-------|-------|-------|-------|----|-----|---------------------|--------------------|-----------|
|                  |           |          | W                   | F     | L     | B     | D     | T     | UL |     |                     |                    |           |
| CVDGF2216T5      | 22-16     | 0.156    | 0.154               | 0.276 | 0.917 | 0.413 | 0.15  | 0.016 | Y  | 500 | 3V2216              | YNM2210            |           |
| CVDGF2216T5/J    | 22-16     | 0.156    | 0.156               | 0.335 | 0.945 | 0.394 | 0.106 | 0.016 | Y  | 500 | 3V2216              | YNT2216            |           |
| CVDGF1614T5      | 16-14     | 0.156    | 0.154               | 0.276 | 0.917 | 0.413 | 0.185 | 0.016 | Y  | 500 | 3V1614              | YNM2210            |           |
| CVDGF1614T7      | 16-14     | 0.195    | 0.193               | 0.276 | 0.917 | 0.413 | 0.185 | 0.016 | Y  | 500 | 3V1614              | YNM2210            |           |
| CVDGF1210T7      | 12-10     | 0.195    | 0.193               | 0.276 | 0.988 | 0.492 | 0.244 | 0.018 | Y  | 500 | 3V1210              | YNM2210            |           |

### Vinyl Insulated Male Bullet

**Material:** Tin Plated Brass with Butted Seam  
**Insulation Material:** PVC Vinyl  
**Maximum Electrical Rating:** 75°C, 300V  
**Maximum Electrical Current:** 22-16: 10 Amps  
 16-14: 15 Amps  
 12-10: 24 Amps

**Barrel ID (d1):** 0.067  
**Barrel ID (d1):** 0.091  
**Barrel ID (d1):** 0.134

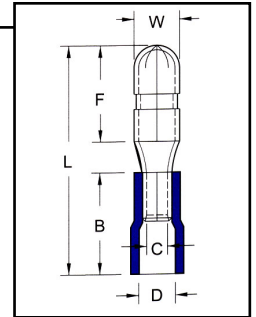

T = Material thickness

| HOFFMAN PART NO. | WIRE SIZE | DIMENSIONS (INCHES) |       |       |       |       |       |       |   | T    | UL     | TAPE MOUNT REEL QTY | DIE FOR TAPE MOUNT | HAND TOOL |
|------------------|-----------|---------------------|-------|-------|-------|-------|-------|-------|---|------|--------|---------------------|--------------------|-----------|
|                  |           | DIAMETER            | W     | F     | L     | B     | D     |       |   |      |        |                     |                    |           |
| FVGM2216T5       | 22-16     | 0.156               | 0.157 | 0.335 | 0.827 | 0.394 | 0.157 | 0.016 | Y | 1000 | 3F2216 | YNM2210C            |                    |           |
| FVGM1614T5       | 16-14     | 0.156               | 0.157 | 0.335 | 0.827 | 0.394 | 0.177 | 0.016 | Y | 1000 | 2F1614 | YNM2210C            |                    |           |
| FVGM1614T5/J     | 16-14     | 0.156               | 0.156 | 0.343 | 0.795 | 0.374 | 0.169 | 0.016 | Y | 1000 | 3F1614 | YNT1614             |                    |           |
| FVGM1210T7       | 12-10     | 0.195               | 0.197 | 0.335 | 0.925 | 0.512 | 0.217 | 0.016 | Y | 500  | 3F1210 | YNM2210C            |                    |           |

### Vinyl Insulated Male Bullet with Support Sleeve

**Material:** Tin Plated Brass with Tin Plated Copper Support Sleeve  
**Insulation Material:** PVC Vinyl  
**Maximum Electrical Rating:** 75°C, 300V  
**Maximum Electrical Current:** 22-16: 10 Amps  
 16-14: 15 Amps  
 12-10: 24 Amps

**Barrel ID (d1):** 0.067  
**Barrel ID (d1):** 0.091  
**Barrel ID (d1):** 0.134

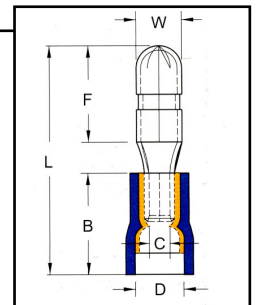

T = Material thickness

| HOFFMAN PART NO. | WIRE SIZE | DIMENSIONS (INCHES) |       |       |       |       |       |       |   | T    | UL     | TAPE MOUNT REEL QTY | DIE FOR TAPE MOUNT | HAND TOOL |
|------------------|-----------|---------------------|-------|-------|-------|-------|-------|-------|---|------|--------|---------------------|--------------------|-----------|
|                  |           | DIAMETER            | W     | F     | L     | B     | D     |       |   |      |        |                     |                    |           |
| FVDGM2216T5      | 22-16     | 0.156               | 0.157 | 0.335 | 0.846 | 0.413 | 0.15  | 0.016 | Y | 1000 | 3V2216 | YNM2210             |                    |           |
| FVDGM2216T5/J    | 22-16     | 0.156               | 0.156 | 0.343 | 0.795 | 0.374 | 0.138 | 0.016 | Y | 1000 | 3V2216 | YNT2216             |                    |           |
| FVDGM1614T5      | 16-14     | 0.156               | 0.157 | 0.335 | 0.854 | 0.413 | 0.185 | 0.016 | Y | 1000 | 3V1614 | YNM2210             |                    |           |
| FVDGM1614T7      | 16-14     | 0.195               | 0.197 | 0.335 | 0.835 | 0.413 | 0.185 | 0.016 | Y | 1000 | 3V1614 | YNM2210             |                    |           |
| FVDGM1614T7/J    | 16-14     | 0.195               | 0.156 | 0.343 | 0.795 | 0.374 | 0.169 | 0.016 | Y | 1000 | 3V1614 | YNT1614             |                    |           |
| FVDGM1210T7      | 12-10     | 0.195               | 0.197 | 0.335 | 0.945 | 0.512 | 0.244 | 0.016 | Y | 500  | 3V1210 | YNM2210             |                    |           |



## Nylon Insulated Bullets

### Nylon Fully Insulated Female Receptacle with Support Sleeve

**Material:** Tin Plated Brass with Tin Plated Copper Support Sleeve

**Insulation Material:** 6/6 Nylon

**Maximum Electrical Rating:** 105°C, 600 V

**Maximum Electrical Current:** 22-16: 10 Amps

16-14: 15 Amps

12-10: 24 Amps

**Barrel ID (d1):** 0.134

**Barrel ID (d1):** 0.091

**Barrel ID (d1):** 0.134

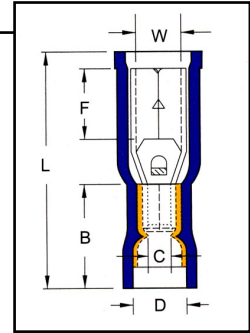

T = Material thickness

| HOFFMAN PART NO. | WIRE SIZE | DIAMETER | DIMENSIONS (INCHES) |       |       |       |       |       |   | UL  | TAPE MOUNT REEL QTY | DIE FOR TAPE MOUNT | HAND TOOL |
|------------------|-----------|----------|---------------------|-------|-------|-------|-------|-------|---|-----|---------------------|--------------------|-----------|
|                  |           |          | W                   | F     | L     | B     | D     | T     |   |     |                     |                    |           |
| CNDGF2216T5      | 22-16     | 156      | 0.154               | 0.276 | 0.992 | 0.433 | 0.157 | 0.016 | Y | 500 | 3V2216              | YNM2210            |           |
| CNDGF1614T5      | 16-14     | 156      | 0.154               | 0.276 | 0.992 | 0.433 | 0.197 | 0.016 | Y | 500 | 3V1614              | YNM2210            |           |
| CNDGF1614T7      | 16-14     | 195      | 0.193               | 0.276 | 0.992 | 0.433 | 0.197 | 0.016 | Y | 500 | 3V1614              | YNM2210            |           |
| *FNDGF1210T7     | 12-10     | 195      | 0.193               | 0.276 | 0.965 | 0.512 | 0.256 | 0.018 | Y | 500 | 3V1210              | YNM2210            |           |

\* This part is only partially insulated

### Nylon Fully Insulated Male Bullet with Support Sleeve

**Material:** Tin Plated Brass with Tin Plated Copper Support Sleeve

**Insulation Material:** 6/6 Nylon

**Maximum Electrical Rating:** 105°C, 600 V

**Maximum Electrical Current:** 22-16: 10 Amps

16-14: 15 Amps

12-10: 24 Amps

**Barrel ID (d1):** 0.067

**Barrel ID (d1):** 0.091

**Barrel ID (d1):** 0.134

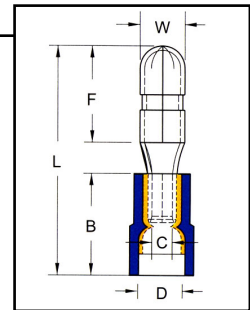

T = Material thickness

| HOFFMAN PART NO. | WIRE SIZE | DIAMETER | DIMENSIONS (INCHES) |       |       |       |       |       |   | UL   | TAPE MOUNT REEL QTY | DIE FOR TAPE MOUNT | HAND TOOL |
|------------------|-----------|----------|---------------------|-------|-------|-------|-------|-------|---|------|---------------------|--------------------|-----------|
|                  |           |          | W                   | F     | L     | B     | D     | T     |   |      |                     |                    |           |
| FNDGM2216T5      | 22-16     | 156      | 0.157               | 0.335 | 0.866 | 0.433 | 0.157 | 0.016 | Y | 1000 | 3V2216              | YNM2210            |           |
| FNDGM1614T5      | 16-14     | 156      | 0.157               | 0.335 | 0.866 | 0.433 | 0.197 | 0.016 | Y | 1000 | 3V1614              | YNM2210            |           |
| FNDGM1614T7      | 16-14     | 195      | 0.197               | 0.335 | 0.866 | 0.433 | 0.197 | 0.016 | Y | 1000 | 3V1614              | YNM2210            |           |
| FNDGM1210T7      | 12-10     | 195      | 0.197               | 0.335 | 0.925 | 0.512 | 0.256 | 0.016 | Y | 500  | 3V1210              | YNM2210            |           |

# Open Barrel Disconnects

## Female Open Barrel Disconnect

**Material:** Tin Plated Brass  
**Temperature:** 300°F  
**Maximum Electrical Current:** 22-16: 10 Amps  
 16-14: 15 Amps  
 12-10: 24 Amps

Female

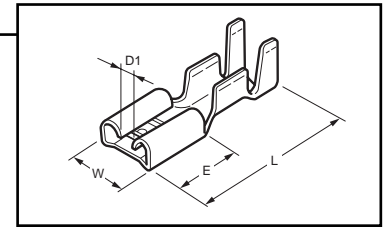

T = Material thickness

| HOFFMAN PART NO. | WIRE SIZE | TAB         | DIMENSIONS (INCHES) |       |       |       |       | MATING TAB THK. | UL | REEL QTY         | HAND TOOL |
|------------------|-----------|-------------|---------------------|-------|-------|-------|-------|-----------------|----|------------------|-----------|
|                  |           |             | W                   | L     | E     | D1    | T     |                 |    |                  |           |
| LTO01T110N       | 24-20     | .110 x .020 | 0.146               | 0.606 | 0.248 | 0.024 | 0.010 | 0.020           | Y  | *SEE METAL STRIP | YHF200    |
| LT041T110N       | 20-16     | .110 x .020 | 0.146               | 0.606 | 0.248 | 0.024 | 0.010 | 0.020           | Y  | *SEE METAL STRIP | YHF200    |
| LT041T187N/J     | 20-16     | .187 x .020 | 0.220               | 0.591 | 0.248 | 0.059 | 0.013 | 0.020           | Y  | *SEE METAL STRIP | YHF200    |
| LT021T250N       | 22-18     | .250 x .032 | 0.303               | 0.748 | 0.307 | 0.094 | 0.016 | 0.031           | Y  | *SEE METAL STRIP | YHF200    |
| LT061T250N       | 18-14     | .250 x .032 | 0.303               | 0.748 | 0.307 | 0.063 | 0.018 | 0.031           | Y  | *SEE METAL STRIP | YHF200    |
| LT081T250N/J     | 14-10     | .250 x .032 | 0.299               | 0.772 | 0.315 | 0.063 | 0.018 | 0.031           | Y  | *SEE METAL STRIP | YHF200    |

## Open Barrel Disconnect with Locking Tab

**Material:** Tin Plated Brass  
**Temperature:** 300°F  
**Maximum Electrical Current:** 22-16: 10 Amps  
 16-14: 15 Amps  
 12-10: 24 Amps

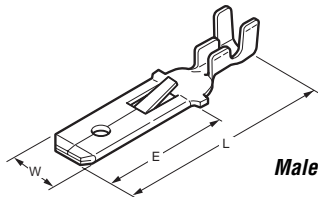

Male

Female

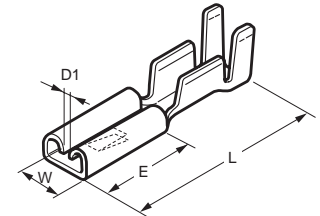

T = Material thickness

| FEMALE PART NO. | WIRE SIZE | TAB         | DIMENSIONS (INCHES) |       |       |       |       | MATING TAB THK. | UL | REEL QTY         | HAND TOOL |
|-----------------|-----------|-------------|---------------------|-------|-------|-------|-------|-----------------|----|------------------|-----------|
|                 |           |             | W                   | L     | E     | D1    | T     |                 |    |                  |           |
| <b>FEMALE</b>   |           |             |                     |       |       |       |       |                 |    |                  |           |
| LT101T110N/J    | 22-20     | .110 x .020 | 0.146               | 0.602 | 0.248 | 0.028 | 0.010 | 0.020           | N  | *SEE METAL STRIP | YHF200    |
| LT141T110N/J    | 20-16     | .110 x .020 | 0.146               | 0.602 | 0.248 | 0.028 | 0.010 | 0.020           | N  | *SEE METAL STRIP | YHF200    |
| LT151T250N/J    | 20-14     | .250 x .032 | 0.295               | 0.756 | 0.303 | 0.035 | 0.013 | 0.032           | Y  | *SEE METAL STRIP | YHF200    |
| LT161T250/J     | 18-14     | .250 x .032 | 0.300               | 0.748 | 0.307 | 0.090 | 0.018 | 0.032           | N  | *SEE METAL STRIP | YHF200    |

| MALE PART NO. | WIRE SIZE | TAB         | DIMENSIONS (INCHES) |       |       |    |       | TAB THICKNESS | UL | REEL QTY         | HAND TOOL |
|---------------|-----------|-------------|---------------------|-------|-------|----|-------|---------------|----|------------------|-----------|
|               |           |             | W                   | L     | E     | D1 | T     |               |    |                  |           |
| <b>MALE</b>   |           |             |                     |       |       |    |       |               |    |                  |           |
| LIM01T110A    | 22-20     | .110 x .020 | 0.110               | 0.811 | 0.472 | NA | 0.020 | 0.020         | Y  | *SEE METAL STRIP | YHF200    |
| LIM41T110B/J  | 20-16     | .110 x .020 | 0.110               | 0.811 | 0.472 | NA | 0.020 | 0.020         | Y  | *SEE METAL STRIP | YHF200    |
| LIM51T250N/J  | 20-14     | .250 x .032 | 0.236               | 0.965 | 0.512 | NA | 0.016 | 0.033         | Y  | *SEE METAL STRIP | YHF200    |
| LIM61T250/J   | 18-14     | .250 x .032 | 0.236               | 1.130 | 0.622 | NA | 0.016 | 0.033         | N  | *SEE METAL STRIP | YHF200    |

Housings for LTI and LIM - See Metal Strip Male and Female Disconnect Housings Section

***\*For Housing Click Here***  
 (Housings, page 76)



## Specialty Connectors

### Double Male Insulated Terminal

**Material:** Tin Plated Brass  
**Insulation Material:** 6/6 Nylon  
**Maximum Electrical Rating:** 105°C, 300V

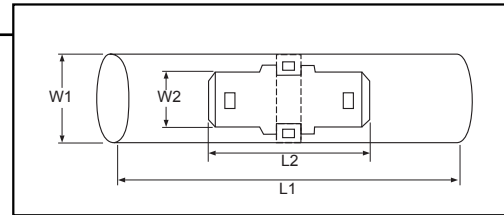

| HOFFMAN<br>PART NO. | TAB         | DIMENSIONS (INCHES) |       |       |       | UL |
|---------------------|-------------|---------------------|-------|-------|-------|----|
|                     |             | W1                  | W2    | L1    | L2    |    |
| VCDF181411RT        | .250 x .032 | 0.472               | 0.248 | 1.969 | 0.882 | N  |

### Non-Insulated Male / Female Disconnects

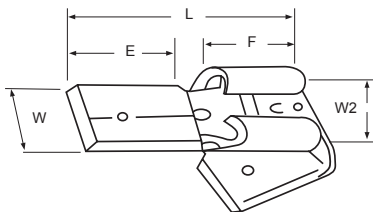

1DF2DM250

2DM1DF250

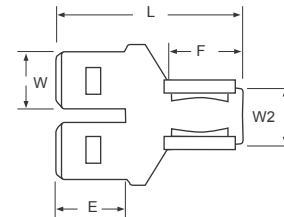

| HOFFMAN<br>PART NO. | TYPE              | TAB         | DIMENSIONS (INCHES) |       |        |       |       | UL |
|---------------------|-------------------|-------------|---------------------|-------|--------|-------|-------|----|
|                     |                   |             | W                   | W2    | L      | E     | F     |    |
| 2DM1DF250           | Male Disconnect   | .250 x .032 | 0.248               | 0.248 | 0.8295 | 0.346 | 0.320 | N  |
| 1DF2DM250           | Female Disconnect | .250 X .032 | 0.248               | 0.268 | 0.7320 | 0.325 | 0.317 | N  |

## Quick Tap Splice Connectors

### Non-Insulated Female Quick Tap Splice Disconnects

**Material Insulator:** Vinyl  
**Material Insert:** Tin Plated Brass  
**Maximum Electrical:** 75°C, 300V  
**Maximum Current:** 22 - 3 Amps, 20 - 4 Amps, 18 - 7 Amps, 16 - 10 Amps, 14 - 15 Amps, 12 - 20 Amps, 10 -24 amps

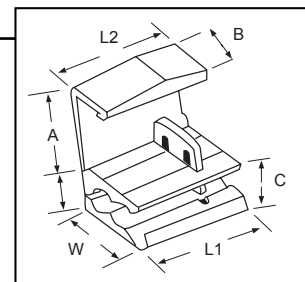

| HOFFMAN<br>PART NO. | TYPE     | COLOR  | FUN WIRE | TAP WIRE | DIMENSIONS (INCHES) |       |       |       |       |       | UL |
|---------------------|----------|--------|----------|----------|---------------------|-------|-------|-------|-------|-------|----|
|                     |          |        |          |          | A                   | B     | C     | W     | L1    | L2    |    |
| TP18                | Tap      | Red    | 18-14    | 22-18    | 0.524               | 0.348 | 0.329 | 0.461 | 0.787 | 0.422 | N  |
| TP14                | Tap      | Blue   | 18-14    | 18.14    | 0.532               | 0.343 | 0.323 | 0.465 | 0.792 | 0.422 | N  |
| TP10                | Tap      | Yellow | 10-12    | 12-10    | 0.709               | 0.484 | 0.413 | 0.590 | 0.831 | 0.831 | N  |
| TH14                | Thru Tap | White  | 18.14    | 18.14    | 0.532               | 0.343 | 0.323 | 0.465 | 0.792 | 0.422 | N  |



# Insulating Sleeves for Disconnects

## Straight PVC Insulating Sleeves

**Material:** Soft PVC  
**Temperature:** 75°C  
**Color:** Transparent

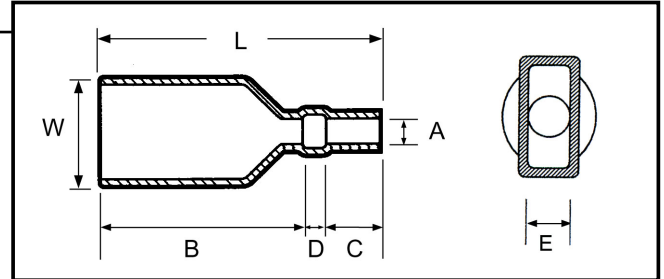

| HOFFMAN PART NO. | TYPE     | NEMA TAB WIDTH | DIMENSIONS (mm) |       |      |      |      |      |       |  |
|------------------|----------|----------------|-----------------|-------|------|------|------|------|-------|--|
|                  |          |                | A               | B     | C    | D    | E    | W    | L     |  |
| KF1825           | Straight | 0.187          | 2.50            | 15.50 | 5.00 | 2.50 | 2.30 | 5.70 | 23.00 |  |
| KF1830           | Straight | 0.187          | 3.00            | 15.50 | 5.00 | 2.50 | 2.30 | 5.70 | 23.00 |  |
| KF2032           | Straight | 0.205          | 3.00            | 15.50 | 5.00 | 2.50 | 3.00 | 6.50 | 23.00 |  |
| KF2525           | Straight | 0.250          | 2.50            | 16.75 | 5.25 | 2.50 | 3.50 | 8.00 | 24.50 |  |
| KF2528           | Straight | 0.250          | 2.80            | 16.75 | 5.25 | 2.50 | 3.50 | 8.00 | 24.50 |  |
| KF2532           | Straight | 0.250          | 3.20            | 16.75 | 5.25 | 2.50 | 3.50 | 8.00 | 24.50 |  |
| KF2538           | Straight | 0.250          | 3.80            | 17.75 | 5.25 | 2.50 | 3.50 | 8.00 | 25.50 |  |

## Flag Type PVC Insulating Sleeves

**Material:** Soft PVC  
**Temperature:** 75°C  
**Color:** Transparent

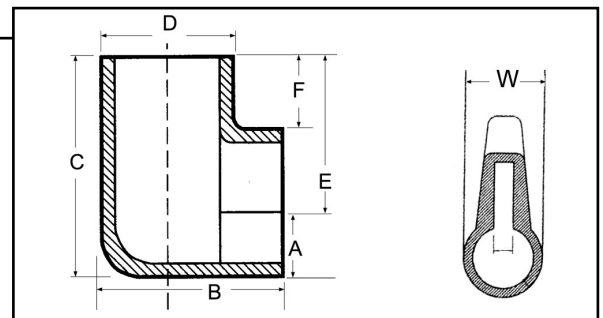

| HOFFMAN PART NO. | TYPE                   | NEMA TAB WIDTH | DIMENSIONS (mm) |       |       |      |      |      |      |  |
|------------------|------------------------|----------------|-----------------|-------|-------|------|------|------|------|--|
|                  |                        |                | A               | B     | C     | D    | E    | W    | L    |  |
| KFF183012M       | Flag Type/ Round Entry | 0.187          | 3.00            | 12.00 | 13.00 | 5.70 | 6.00 | 2.30 | 8.00 |  |
| KFF1832          | Flag Type              | 0.187          | 3.20            | 12.00 | 13.00 | 5.70 | 6.00 | 2.30 | 8.00 |  |
| KFF2540M         | Flag Type/ Round Entry | 0.250          | 4.00            | 16.00 | 17.00 | 8.00 | 9.00 | 3.50 | 8.00 |  |
| KFF2548          | Flag Type              | 0.250          | 4.80            | 16.00 | 17.00 | 8.00 | 9.50 | 3.50 | 8.00 |  |





## X-ON Electronics

Largest Supplier of Electrical and Electronic Components

*Click to view similar products for [hoffman manufacturer](#):*

Other Similar products are found below :

[A-1412CHQR](#) [CSD201610](#) [CSD20168SS](#) [CSD20206](#) [CSD20208SS](#) [CSD24168](#) [CSD36248](#) [CSD36308](#) [PCU7](#) [PDS76R](#) [PRA197TP](#) [PT126](#)  
[A1008CHNFSS](#) [A10106CH](#) [A10106CHFL](#) [A10106PHCW](#) [A1066JFGQRR](#) [A1210CHNF](#) [A1212SC](#) [A1412CHNFSS](#) [A161208LP](#)  
[A161410CH](#) [A16H12ALP](#) [A16P14](#) [A16P16G](#) [A18P16AL](#) [A20H16BLP](#) [A20P16](#) [A24H2408SSLP](#) [Q13138PCE](#) [A404CH](#) [A606CHNF](#)  
[A606NF](#) [A806SC](#) [A845JFGR](#) [A864CHQRFGW](#) [A90P36F1](#) [HJ1412HWPL2LG](#) [HJ1816HWPL2LG](#) [RHJ1210HWPL2LG](#) [AS125SS](#)  
[ASE10X10X4](#) [ASE12X12X4](#) [E1PBG](#) [E2PBG](#) [E3PB](#) [LED24V15](#) [LF230VD](#) [A10106PHC](#) [A10P8SS](#)