

Internal door mount

HEX050PA series

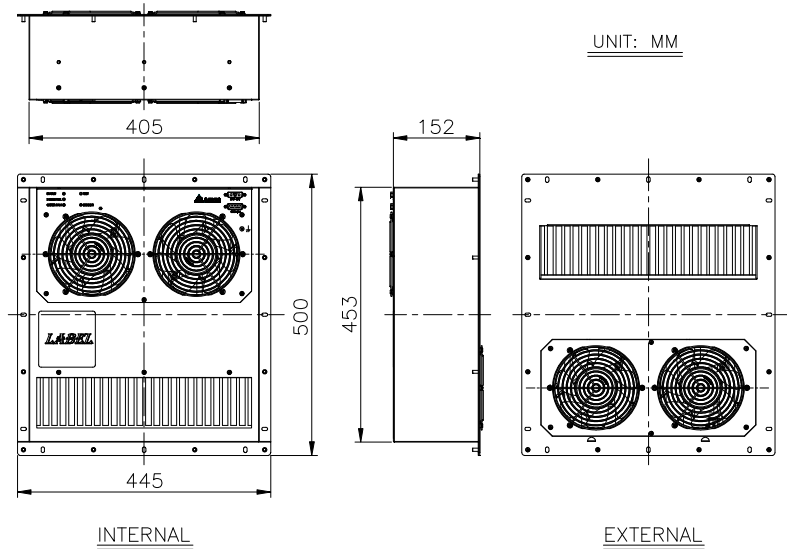

Dimension drawing



Features

- ◆ IP55 waterproof at external side
- ◆ "One touch" dry run test and dust cleaning
- ◆ Standalone temperature control
- ◆ Clear LED status indicator
- ◆ Dry contact alarm output

Design

- ◆ Air to air heat exchange
- ◆ Rated voltage at 48V
- ◆ Redundant fan quantity design
- ◆ High efficiency and reliable fan
- ◆ Easy installation and maintenance

Main feature	Unit	Specification
Dimension (H x W x D)	mm (inch)	500 x 445 x 152 (20 x 18 x 6)
Cooling capacity* _{Note}	W/K (W/°F)	45 (25)
Rated voltage	VDC	48
Operating current	A	1.2
Operating power	W	58
Operating voltage range	VDC	40 ~ 60
Operating temperature range	°C	-10 ~ +65
Noise (1.5 meter)	dB-A	65.0
Weight	Kg (Lb)	10 (22)

* Note : The cooling capacity (W/K , W/°C or W/°F) is defined as $Q / (T_I - T_A)$

Q : Heat dissipation (W) from inside of cabinet

T_I : Return temperature of internal air circuit (K , °C or °F)

T_A : Ambient temperature of external air circuit (K , °C or °F)

* Specifications are subject to change without notice.

X-ON Electronics

Largest Supplier of Electrical and Electronic Components

Click to view similar products for [Racks & Rack Cabinet Accessories](#) category:

Click to view products by [Delta](#) manufacturer:

Other Similar products are found below :

[CR-1727](#) [M00-PLN](#) [F2420](#) [F2424](#) [8310-1032-SS](#) [9104](#) [PLFF2000](#) [PLFF6000](#) [GP216](#) [PTFA60000LG](#) [H-9163-B](#) [AC220-84-1](#) [HEH050BA](#)
[1427C3](#) [BAS-5104](#) [N-700-2](#) [190-002](#) [HTL10](#) [HTS10](#) [PC-118](#) [PC-780L](#) [PC-79](#) [PC-800](#) [SC4-28](#) [F3024](#) [AKWAMT](#) [PLFF1000](#) [GRPB12PG](#)
[CG3-340S/12](#) [2CWDP36](#) [2CWDP48](#) [2SSHINGE](#) [CP-001BK](#) [CPL19431LG1](#) [R570-004-107](#) [M6123-4007-SS](#) [TS170](#) [531300535](#) [BRX-](#)
[12290](#) [C4BD3077SBK1](#) [UPS 7-17-14 PLAIN](#) [LP40](#) [5261304-07](#) [CCA26-44-01](#) [706-102](#) [CG3-160G](#) [7112C-PLN ALUM](#) [CM10](#) [TS81](#) [7142](#)