

Type

Abox 025

80 x 80 x 52 mm

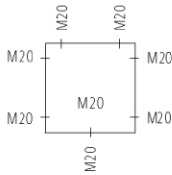

Description

IP 65 junction box complying with DIN VDE 0606, $U_i=690$ V, with M20 self-sealing soft entry membranes, seal range 2-16 mm, cable range 1-4 mm²

Abox 025 L – empty, grey

895 - 902

3

Abox 025 – 2.5², grey,

5-pole 1.5-4 mm² screw terminal
(4 x 1.5² / 4 x 2.5² / 3 x 4²)

895 - 402

3

Recommended accessories:

IP 68 cable gland with lock-nut
M 20 (seal range 6-12 mm)

227 420 01

50

M 20 IP 54 mini-conduit adapter, grey

233 455 01

240 / 20

M 20 IP 54 mini-conduit adapter, white

233 655 01

240 / 20

Abox 025 AB

80 x 80 x 52 mm

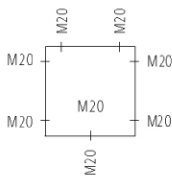

IP 65 junction box complying with DIN VDE 0606, $U_i=690$ V, with M20 self-sealing soft entry membranes, seal range 2-16 mm,

with external fixing lugs

Abox 025 L – empty,
grey

895 - 903

3

Abox 025 – 2.5²,

grey, 5-pole 1.5-4 mm² screw terminal
(4 x 1.5² / 4 x 2.5² / 3 x 4²)

895 - 403

3

Recommended accessories:

Set of lead seals

890 010 01

10

IP 68 cable gland with lock-nut
M20 (seal range 6 - 12 mm)

227 420 01

50

M20 IP 54 mini-conduit adapter, grey

233 455 01

240 / 20

ABOX SERIES - FLAT LID



Type

Abox 040

93 x 93 x 55 mm

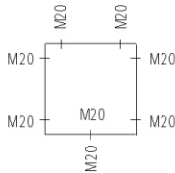

Description

IP 65 junction box complying with DIN VDE 0606, $U_i=690$ V, with M20 self-sealing soft entry membranes, seal range 2-16 mm, cable range 1-4 mm²

Abox 040 L – empty, grey

895 - 904

3

Abox 040 – 4², grey,

5-pole 1-4 mm² screw terminal
(4 x 1.5² / 4 x 2.5² / 3 x 4²)

895 - 404

3

Recommended accessories:

IP 68 cable gland with lock-nut

M20 (seal range 6 - 12 mm)

227 420 01

50

M20 (" 7 - 14 mm)

227 421 01

30

M 20 IP 54 mini-conduit adapter, grey

233 455 01

240 / 20

M 20 IP 54 mini-conduit adapter, white

233 655 01

240 / 20

Abox 060

110 x 110 x 67 mm

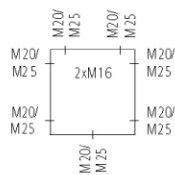

IP 65 junction box complying with DIN VDE 0606, $U_i=690$ V, with IP 54 extension pieces and M25 locking seals, seal range 9-18.5 mm

Abox 060 L – empty,

grey

895 - 906

2

Abox 060 – 6²,

grey, 5-pole 6 mm² high-set screw terminal
(4 x 2.5² / 4 x 4² / 3 x 6²)

895 - 406

2

Recommended accessories:

Set of lead seals

890 010 01

10

IP 68 cable gland with lock-nut

M20 (seal range 6 - 12 mm)

227 420 01

50

M20 (" 7 - 14 mm)

227 421 01

30

M25 (" 7 - 16 mm)

227 425 01

25

IP 66 double membrane spouts

M20 (seal range 7 - 12 mm)

260 420 01

600 / 50

M25 (" 9 - 16 mm)

260 425 01

600 / 50

NS 35 DIN rail

81 mm

198 081 01

1

Mounting plate from insulating material

83 x 83 mm

895 006 01

1

ABOX SERIES - FLAT LID

Type

Abox 100
140 x 140 x 79 mm

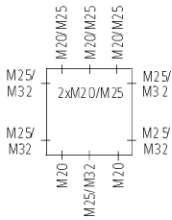

Description

IP 65 junction box complying with DIN VDE 0606, U_i=690 V, with IP 54 extension pieces and M32 locking seals, seal range 11- 23 mm

Abox 100 L – empty,
grey

Abox 100 – 10²,
grey, 5-pole 10 mm² high-set screw terminal
(4 x 4² / 4 x 6² / 4 x 10²)

Recommended accessories:
Set of lead seals

IP 68 cable gland with lock-nut
M20 (seal range 6 - 12 mm)
M20 (" 7 - 14 mm)
M25 (" 7 - 16 mm)
M32 (" 11 - 21 mm)

IP 66 double membrane spouts
M25 (seal range 9 - 16 mm)
M32 (" 14 - 21 mm)

NS 35 DIN rail 106 mm
Mounting plate from insulating material 109 x 109 mm

Order N°

Packing Qty

895 - 910

2

895 - 410

2

890 010 01

10

227 420 01

50

227 421 01

30

227 425 01

25

227 432 01

10

260 425 01

600 / 50

260 432 01

300 / 25

198 106 01

1

895 010 01

1

X-ON Electronics

Largest Supplier of Electrical and Electronic Components

Click to view similar products for [spelsberg](#) manufacturer:

Other Similar products are found below :

[10040501](#) [247-421 01](#) [10540501](#) [110-404](#) [130-008](#) [74790201](#) [74140301](#) [74500301](#) [74390401](#) [74500401](#) [12790901](#) [13750901](#) [12841401](#)
[12791601](#) [13751301](#) [13750201](#) [10650401](#) [11090901](#) [10940601](#) [10591501](#) [10601601](#) [10700701](#) [11041301](#) [10441101](#) [10591201](#) [73572401](#)
[26344001](#) [70043401](#) [RKK 4/08-8X4²](#) [12791001](#) [12841101](#) [56273501](#) [79506001](#) [70610201](#) [73381301](#) [19810701](#) [10590501](#) [802-907](#) [110-](#)
[908](#) [73361401](#) [74390301](#) [74790301](#) [74140401](#) [74790401](#) [74040201](#) [12740901](#) [13700901](#) [13701401](#) [10650901](#) [11090501](#)