



ELECTRONICS, INC.
 44 FARRAND STREET
 BLOOMFIELD, NJ 07003
 (973) 748-5089

NTE5318 thru NTE5320 Single Phase Bridge Rectifier 4 Amp

Features:

- Ideal for Printed Circuit Board
- Surge Overload Rating: 200A (Peak)

Maximum Ratings and Electrical Characteristics: ($T_A = +25^\circ\text{C}$ unless otherwise specified. Single Phase, Full Wave, 60Hz, Resistive or Inductive Load. For Capacitive Load, Derate Current by 20%)

Maximum Recurrent Peak Reverse Voltage, P_{RV}	
NTE5318	200V
NTE5319	600V
NTE5320	1000V
Maximum RMS Bridge Input Voltage,	
NTE5318	140V
NTE5319	420V
NTE5320	700V
Maximum DC Blocking Voltage,	
NTE5318	200V
NTE5319	600V
NTE5320	1000V
Maximum Average Forward Output Current ($T_A = +50^\circ\text{C}$), $I_{F(AV)}$	
4A	
Peak Forward Surge Current, I_{FSM}	
(8.3ms Single Sine-Wave Superimposed on Rated Load)	
200A	
Maximum Forward Voltage Drop (Per Bridge Element, $I_F = 3A$), V_F	
1.0V	
Maximum Reverse Current (at Rated DC Blocking Voltage per Element), I_R	
$T_A = +25^\circ\text{C}$	10 μ A
$T_A = +100^\circ\text{C}$	1mA
Operating Junction Temperature Range, T_J	
-55° to +125°C	
Storage Temperature Range, T_{stg}	
-55° to +150°C	

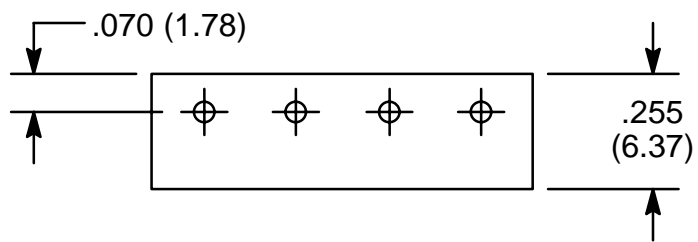
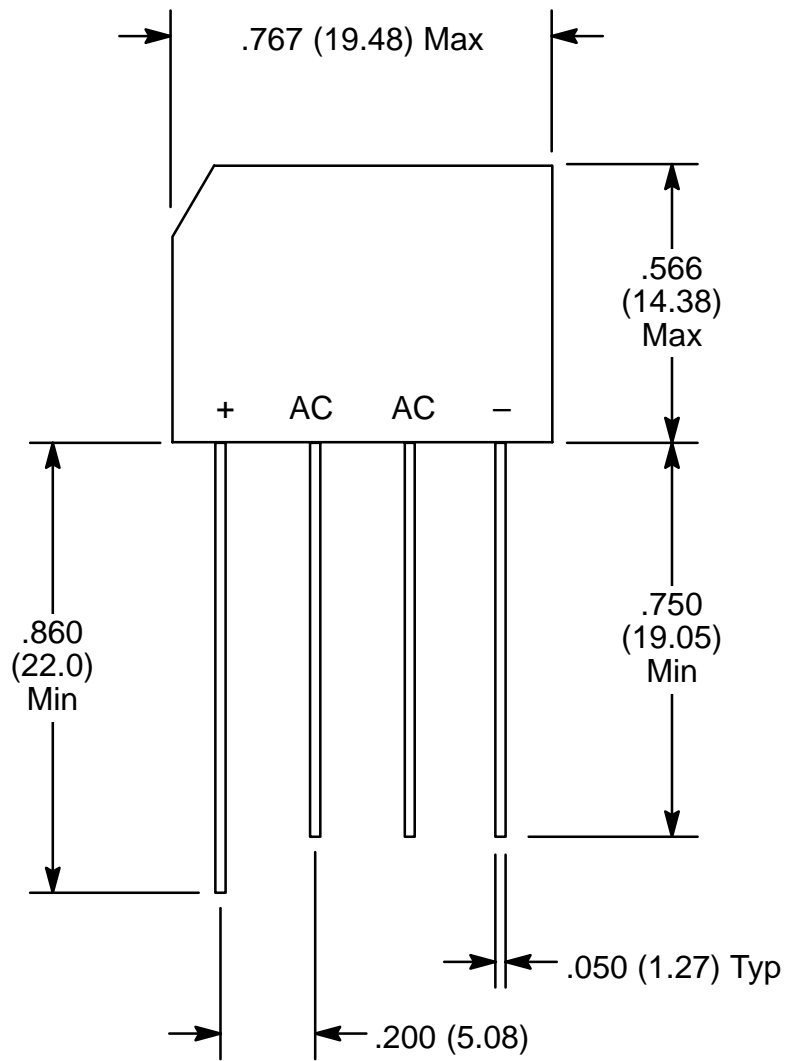

X-ON Electronics

Largest Supplier of Electrical and Electronic Components

Click to view similar products for [Bridge Rectifiers](#) category:

Click to view products by [NTE manufacturer](#):

Other Similar products are found below :

[G3SBA60-E351](#) [GBJ1504-BP](#) [GBU10B-BP](#) [GBU15J-BP](#) [GBU15K-BP](#) [GBU4A-BP](#) [GBU4D-BP](#) [GBU6B-E3/45](#) [GSIB680-E3/45](#) [DB101-BP](#) [DF10SA-E345](#) [RMB2S](#) [RCG](#) [APT30DF100HJ](#) [APT60DF20HJ](#) [B2S-E3/80](#) [BU1506-E351](#) [BU15085S-E345](#) [BU1508-E3/45](#) [BU1510-E3/45](#) [RS404GL-BP](#) [RS405GL-BP](#) [G3SBA20-E3/51](#) [G5SBA20-E3/51](#) [G5SBA60-E3/51](#) [GBJ1502-BP](#) [GBL02-E351](#) [GBL10-E3/45](#) [GBU10J-BP](#) [GBU4J-BP](#) [GBU4K-BP](#) [GBU8B-E3/45](#) [GBU8D-BP](#) [GBU8J-BP](#) [GSIB1520-E3/45](#) [MB1510](#) [MB352W](#) [MB6M-G](#) [B2M-E345](#) [B40C7000A](#) [B500C7000A](#) [MP5010W-BP](#) [MP501W-BP](#) [MP502-BP](#) [BR1005-BP](#) [BR101-BP](#) [BU1006-E345](#) [BU12065S-E3/45](#) [BU1508-E3/51](#) [BU2006-E3/45](#) [BU2008-E345](#)