

THIS DRAWING IS A CONTROLLED DOCUMENT. DWN FU.BO CHK ZHANG.XIAONING NAME:		APVD C.H.HSU PRODUCT SPEC:		OMIT CUSTOMER DRAWING	
MATERIAL:		FINISH:		WEIGHT:	
DIMENSIONS: mm		TOLERANCES UNLESS OTHERWISE SPECIFIED:		APPLICATION SPEC:	
0 PLC ± 1 PLC ± 2 PLC ± 3 PLC ± 4 PLC ±		ANGLES:		DRAWING NO:	
-		-		CAGE CODE:	
-		-		SIZE:	
-		-		CAGE CODE:	
-		-		DRAWING NO:	
-		-		SCALE:	
-		-		SHEET:	
-		-		REV:	
-		-		CUSTOMER DRAWING	

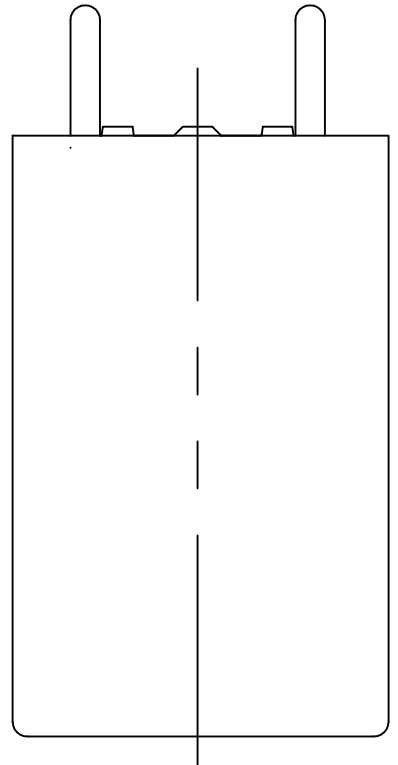

OMIT CUSTOMER DRAWING

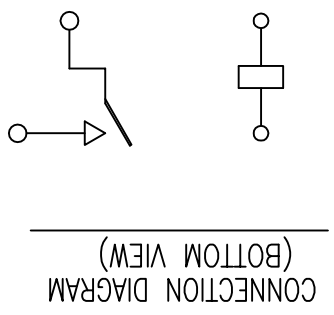
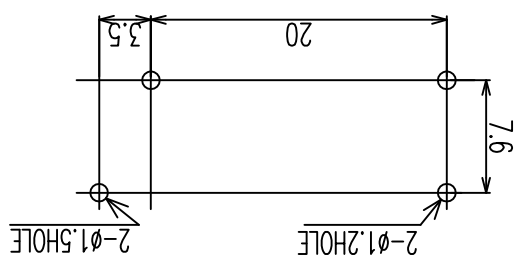
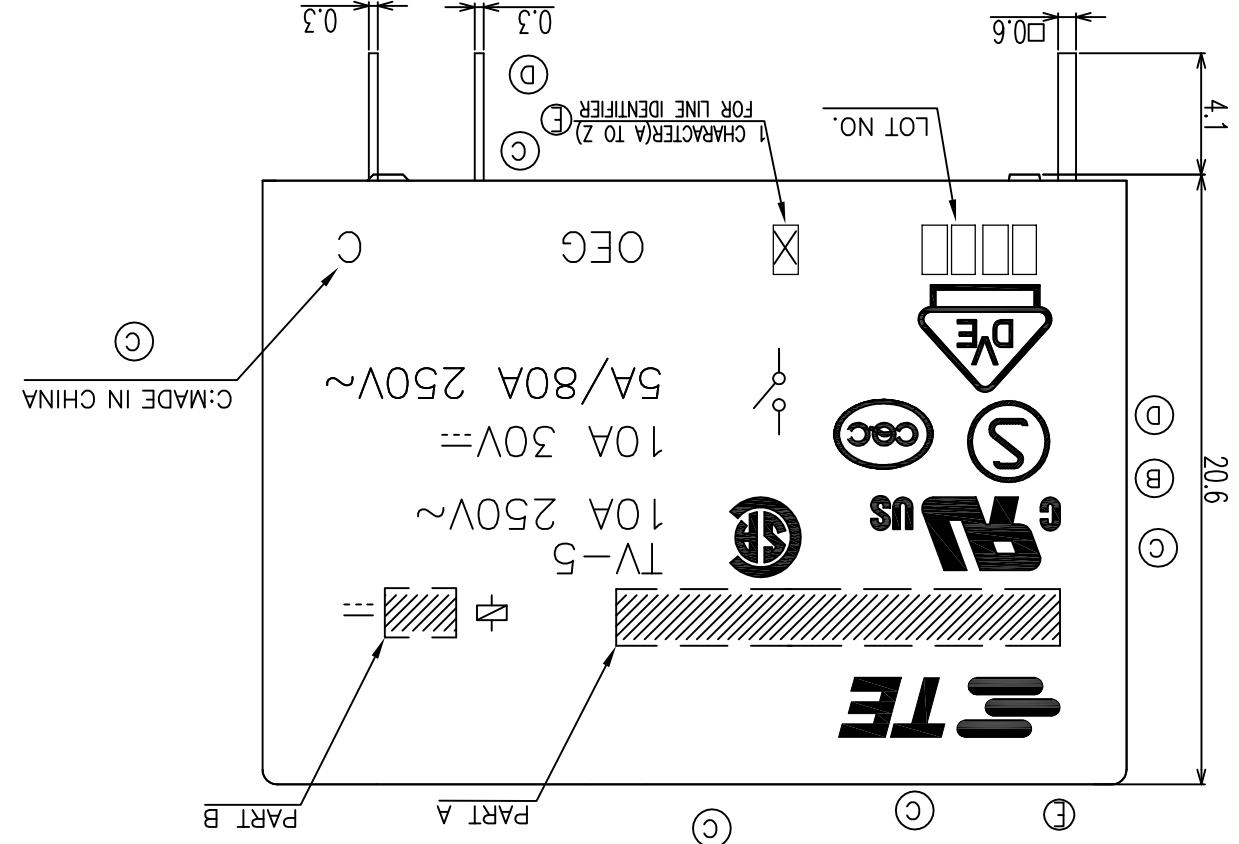
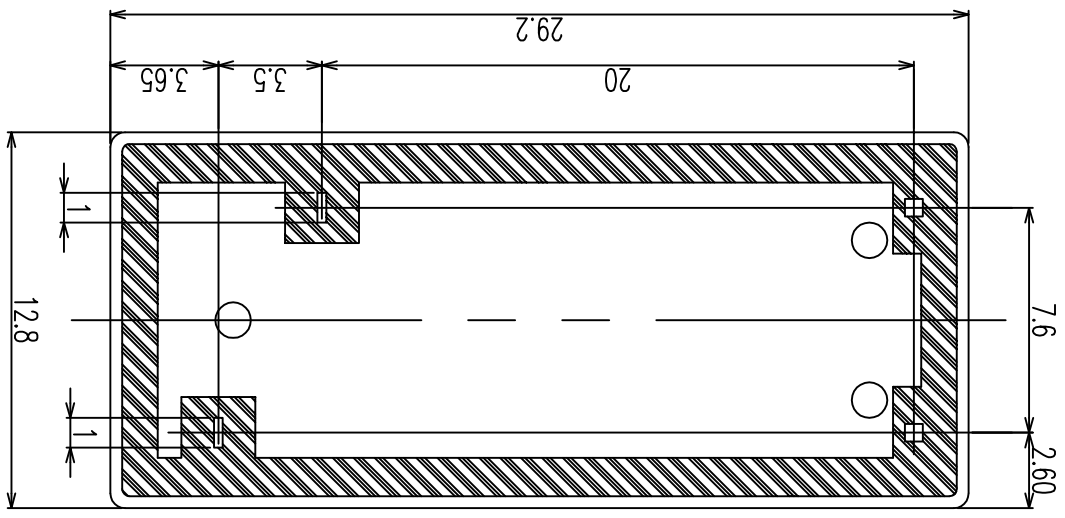

REV	DATE	DESCRIPTION	LTR	P
F	16-DEC-13	ECO-13-015347	REVERSE ONLY	B,F
E	06-APR-12	ECO-12-005726	1.UPDATE THE LOGO&DE LOGO&ADD LINE IDENTIFICATION 3.TERMINALS TOLERANCE CLARIFICATION&VENT HOLE CHANGE	B,H,Y

HB
DIST

THIS DRAWING IS UNPUBLISHED.
 RELEASED FOR PUBLICATION
 ALL RIGHTS RESERVED.
 BY TE Connectivity
 COPYRIGHT ©

A
B
C
D

A
B
C
D

THIS DRAWING IS A CONTROLLED DOCUMENT.
 DWN FU,BO
 CHK ZHANG,XIAONING
 NAME C.H.HSU
 APVD
 TOLERANCES UNLESS OTHERWISE SPECIFIED:
 0 PLC ±
 1 PLC ±
 2 PLC ±
 3 PLC ±
 4 PLC ±
 ANGLES ±
 FINISH ±

MATERIAL	
DIMENSIONS:	mm

APVD: FU,BO
 CHK: ZHANG,XIAONING
 NAME: C.H.HSU
 APVD:
 TOLERANCES UNLESS OTHERWISE SPECIFIED:
 0 PLC ±
 1 PLC ±
 2 PLC ±
 3 PLC ±
 4 PLC ±
 ANGLES ±
 FINISH ±

WEIGHT	
APPLICATION SPEC	
PRODUCT SPEC	
SIZE	A3
CAGE CODE	00779
DRAWING NO	9-144000-6
RESTRICTED TO	

CUSTOMER DRAWING
 SCALE 4:1
 SHEET 2 OF 2
 REV F

ITEM	DESCRIPTION	MATERIAL	TREATMENT	INCOMBUSTIBILITY
1	YOKE	STEEL		
2	ARMATURE	STEEL		
3	CORE	STEEL		
4	MOVABLE SPRING	CU ALLOY	SOLDER DIP	
5	STATIONARY TERMINAL	CU ALLOY	SOLDER DIP	
6	HINGE SPRING	CU ALLOY		
7	STATIONARY CONTACT	Ag ALLOY		
8	MOVABLE CONTACT	Ag ALLOY		
9	CARD	PPS		UL94 V-0
10	COIL TERMINAL	CP WIRE	SOLDER DIP	
11	BOBBIN	PBT		UL94 V-0
12	BASE	PET		UL94 V-0
13	MAGNETIC WIRE	UEW		CLASS E
14	CASE	PBT		UL94 V-0
15	SEAL	EPOXY RESIN		
16	UV SEAL	UV RESIN		

REV	DATE	DESCRIPTION	P	LTR
-	-	SEE SHEET 1	-	-

HB
 DIST

RELAY TYPE

TE PART NO	DESCRIPTION	PART B	PART A
2-1461387-3	OMIT-SH-148LM	48V	OMIT-SH-148LM
2-1461387-1	OMIT-SH-148DM	48V	OMIT-SH-148DM
1-1461387-9	OMIT-SH-124LM	24V	OMIT-SH-124LM
1-1461387-7	OMIT-SH-124DM	24V	OMIT-SH-124DM
9-144000-6	OMIT-SH-112LM	12V	OMIT-SH-112LM
1-1461387-4	OMIT-SH-112DM	12V	OMIT-SH-112DM
1-1461387-2	OMIT-SH-109LM	9V	OMIT-SH-109LM
1-1461387-0	OMIT-SH-109DM	9V	OMIT-SH-109DM
1461387-8	OMIT-SH-106LM	6V	OMIT-SH-106LM
1461387-6	OMIT-SH-106DM	6V	OMIT-SH-106DM
1461387-4	OMIT-SH-105LM	5V	OMIT-SH-105LM
1461387-2	OMIT-SH-105DM	5V	OMIT-SH-105DM

TOLERANCE	
0~0.99mm	±0.1
1mm~2.99mm	±0.2
3mm MIN.	±0.3

2. GENERAL TOLERANCE AS FOLLOWING:

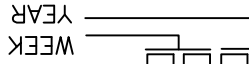

NOTES:
 (B) 1. LOT NO. SYSTEM AS FOLLOWING:

- (C) 3. TERMINAL DIMENSION IS NOT INCLUDING SOLDER TIP.
- (E) 4. FOR THE TIN-PLATING OF THE PINS:
 +0.1mm FOR WIDTH, THICKNESS AND DIAMETER.
 +0.5mm FOR LENGTH.

X-ON Electronics

Largest Supplier of Electrical and Electronic Components

Click to view similar products for [General Purpose Relays](#) category:

Click to view products by [TE Connectivity](#) manufacturer:

Other Similar products are found below :

[APF30318](#) [JVN1AF-4.5V-F](#) [PCN-105D3MHZ](#) [5JO-10000S-SIL](#) [5JO-1000CD-SIL](#) [5JO-400CD-SIL](#) [LY2S-AC220/240](#) [LYQ20DC12](#)
[6031007G](#) [6131406HQ](#) [6-1393099-3](#) [6-1393099-8](#) [6-1393122-4](#) [6-1393123-2](#) [6-1393767-1](#) [6-1393843-7](#) [6-1415012-1](#) [6-1419102-2](#) [6-1423698-4](#) [6-1608051-6](#) [6-1608067-0](#) [6-1616170-6](#) [6-1616248-2](#) [6-1616282-3](#) [6-1616348-2](#) [6-1616350-1](#) [6-1616350-8](#) [6-1616358-7](#) [6-1616359-9](#) [6-1616360-9](#) [6-1616931-6](#) [6-1617039-1](#) [6-1617052-1](#) [6-1617090-2](#) [6-1617090-5](#) [6-1617347-5](#) [6-1617353-3](#) [6-1617801-8](#) [6-1617802-2](#) [6-1618107-9](#) [6-1618248-4](#) [M83536/1-027M](#) [CX-4014](#) [MAHC-5494](#) [MAVCD-5419-6](#) [703XCX-120A](#) [7-1393100-5](#) [7-1393111-7](#)
[7-1393144-5](#) [7-1393767-8](#)