

THIS COPY IS PROVIDED ON A RESTRICTED BASIS AND IS NOT TO BE USED IN ANY WAY DETRIMENTAL TO THE INTERESTS OF PANDUIT CORP.

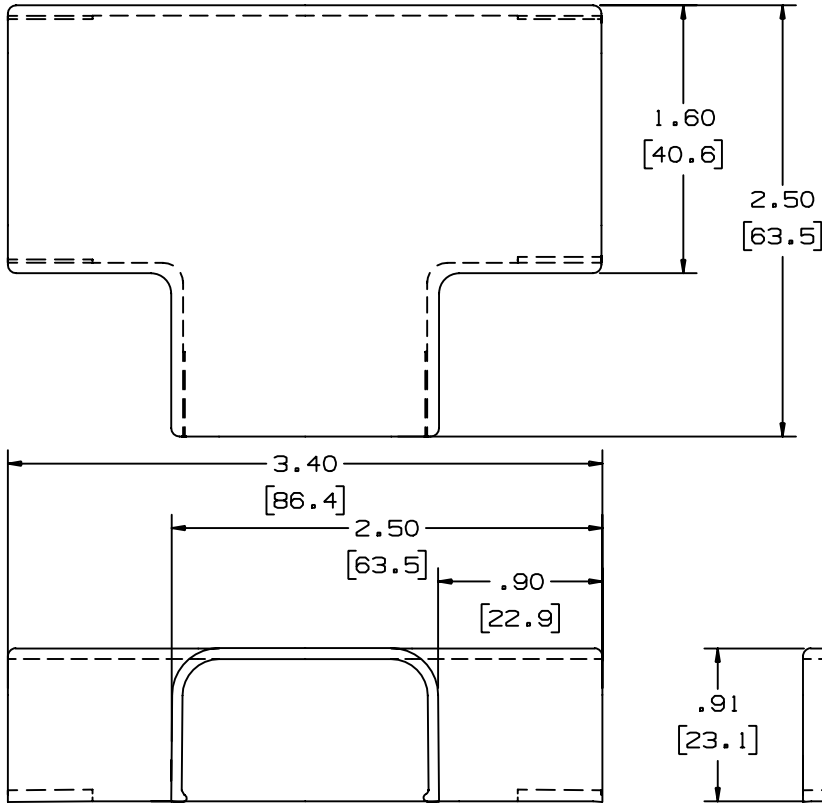

PANDUIT P/N	WEIGHT
TF10	2.77 LB/ 100PCS. (1258g/ 100PCS.)



**NOTES:**

1. SEE CURRENT CATALOG FOR ADDITIONAL PART SUFFIXES TO INDICATE COLOR AND OR PACKAGE QUANTITY.
2. DIMENSIONS IN PARENTHESIS ARE IN METRIC.

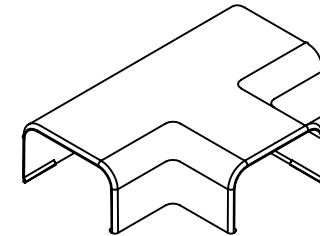

CAD FILENAME/LAYERS D34116BC\_DC\_TF10\_02C.PRT

REV	DATE	BY	CHK	DESCRIPTION	ECN	R	CUST	SUP	CHK'D
6	07-08-02	JHNU	RMHI	G. REVISED MATERIAL IN DRAWING TITLE BLOCK.	17779		RGRC	RGRC	
5	09-13-00	JHNU	HIW	F. REVISED SCALE: NONE WAS FULL. E. REVISED AND REDRAWN.	17779		HIW	HIW	
4	10-03-91	DW	CF	D. REV'D NOTE AND REMOVED COLOR FROM DWG.	17779	4	WJB/CF		
3	02-28-91	DW	CF	C. REV'D COLORS: OMIT BEIGE, BLACK LIGHT IVORY, AND LIGHT GREY. ADDED INT. WHITE AND INT. GREY	17779	3	WJB		
2	12-02-87	LDB	WJB	B. ADDED P/N TF10EI AND TF10LI.	17779	2	WJS		
1	10-01-84	CEW	HMP	A. REVISED MAT'L.	17779	1	AJC		
R	11-11-82	SS	HMP	DRAWING RELEASED	17779	R	JKR		

<p>PANDUIT CORP. TINLEY PARK, ILLINOIS</p> <p>TEE FITTING (TF10) CUSTOMER DRAWING</p> <p>UNLESS OTHERWISE SPECIFIED, DIMENSIONAL TOLERANCES ARE: (.X) ± (.XXX) ± (.XX) ±.03(.8) ANGLES ±</p>		<p>UNLESS OTHERWISE SPECIFIED, ALL DIMENSIONS ARE GIVEN IN INCHES, THIRD ANGLE PROJECTION.</p>
<p>DRAWN BY SARGIS</p> <p>DATE 11-08-82</p> <p>CHK'D JVL</p>	<p>MAT'L: ABS </p>	<p>SCALE NONE </p> <p>DRAWING NO. SS-17779</p> <p>DWG SIZE A</p>

## X-ON Electronics

Largest Supplier of Electrical and Electronic Components

*Click to view similar products for [Wire Ducting](#) category:*

*Click to view products by [Panduit](#) manufacturer:*

Other Similar products are found below :

[66200A-10](#) [CVED32VEPG](#) [CVED40VEPG](#) [F512D5-5F140Y](#) [F512D5-5F200Y](#) [F512D5-5F26Y](#) [F512D5-5F30Y](#) [F512D5-5F33Y](#) [F512D5-5F34Y](#) [F512D5-5F45Y](#) [F512D5-5F50Y](#) [F512D5-5F54Y](#) [F512D5-5F66Y](#) [F512D5-5F70Y](#) [F512D5-5F75Y](#) [F512D5-5F90Y](#) [F612D5-5F100Y](#) [F612D5-5F130Y](#) [F612D5-5F50Y](#) [F612D5-5F56Y](#) [F612D5-5F58Y](#) [F6L12D5-5F46](#) [F912D5-5F11Y](#) [F912D5-5F170Y](#) [F912D5-5F175Y](#) [F912D5-5F230Y](#) [F912D5-5F300Y](#) [F912D5-5F55Y](#) [F912D5-5F56Y](#) [F912D5-5F63Y](#) [F912D5-5F6Y](#) [F912D5-5F75Y](#) [F912D5-5F85Y](#) [F912D5-5F86Y](#) [F912D5-5F88Y](#) [F912D5-5F96Y](#) [FAP0047WBLMTP](#) [FAP12WBRDRDDLZ](#) [FAP12WDYLYLDLZ](#) [FAP12WEORORDLZ](#) [FAP6WEORORDLZ](#) [FAP6WFDBDBDLZ](#) [FAP8WEORORDLZ](#) [FCE2UWCL](#) [800A-LB](#) [802A-ECSP](#) [802I-ICSP](#) [FJQADH](#) [FJQFXT](#) [PED10](#)