



In über 40 Ländern  
weltweit vertreten



**HARTMANN**

A Phoenix Mecano Company

Hartmann Codier GmbH • Industriestraße 3 • 91330 Baiersdorf  
Tel: +49 (0)9133/7793-0 • Fax: +49 (0)9133/7793-36  
email: info@hartmann-codier.de

[WWW.HARTMANN-CODIER.DE](http://WWW.HARTMANN-CODIER.DE)

# P25 Rotary Code Switch

- ▷ 2.5mm height
- ▷ 7.0mm length
- ▷ Lateral C-contact
- ▷ SMJ, SMT-Pins
- ▷ Contacts with hard gold plating
- ▷ Solid, tinned PCB pins

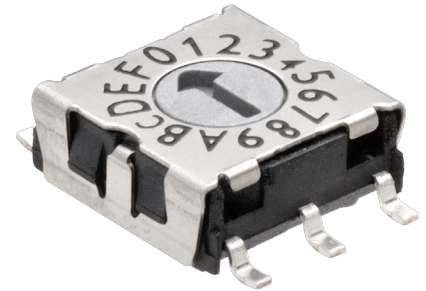

## Technical Data

Height	2.5mm
Length	7.0mm
Width	7.0mm
Pin connection	3+3, lateral C-contact
Perm. ambient temperature	-50...+125°C
Perm. storage temperature	-55...+135°C
Torque	min. 0.7Ncm
Positions per rotation	10, 16
Operating voltage	≤42V
Contact load, static	≤0.4A
Contact load, dynamic	≤0.1A
Minimum load	1μA 20mV DC
Test voltage	250V 50Hz/1min
Contact resistance	<80mΩ
Insulation resistance	>100MΩ
Vibration, Shock	DIN EN 60068-2-6 DIN EN 60068-2-27
Humidity	21days at 40°C 93% RH
Reflow soldering max.	10s/260°C

## Dimensions

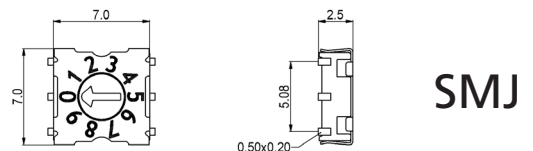

SMJ

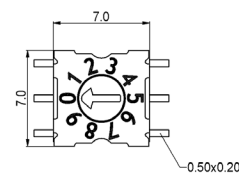
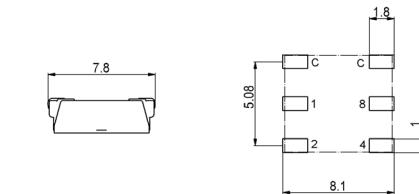

SMT

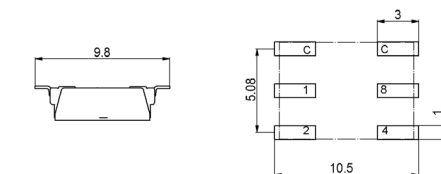

Life size



Represented worldwide in more than 40 countries

Hartmann Codier GmbH • Industriestraße 3 • 91330 Baiersdorf  
Tel: +49 (0)9133/7793-0 • Fax: +49 (0)9133/7793-36  
email: info@hartmann-codier.de



**HARTMANN**

A Phoenix Mecano Company

[WWW.HARTMANN-CODIER.DE](http://WWW.HARTMANN-CODIER.DE)

# P25 Rotary Code Switch

## Features and Order Code

**1**

### CONTACT PINS

SMT

Code: P25 **SMT** 2 3 4

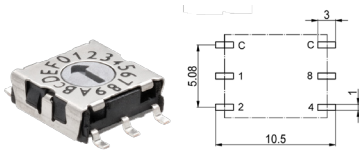

J-Hook

Code: P25 **SMJ** 2 3 4

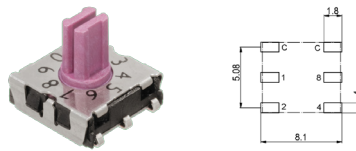

**2**

### ACTUATORS

Arrow shaped slot

Code: P25 1 **1** 3 4

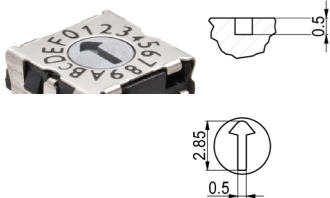

Spindle

Code: P25 1 **3** 3 4

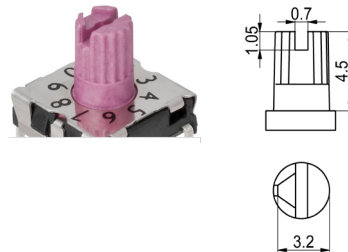

Slotted spindle

Code: P25 1 **8** 3 4

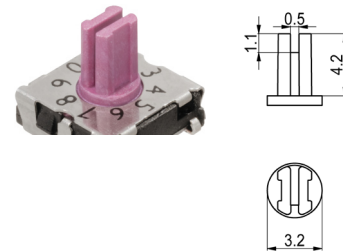

**3**

### CODES

	Positions	Rotor	
BCD	10	red	Code: P25 1 2 <b>01</b> 4
BCD Complement	10	orange	Code: P25 1 2 <b>02</b> 4
Hexadecimal	16	gray	Code: P25 1 2 <b>03</b> 4
Hexadecimal Complement	16	white	Code: P25 1 2 <b>06</b> 4

**4**

### Packing

Tape & Reel Packing

Code: P25 1 2 3 **TR**

## X-ON Electronics

Largest Supplier of Electrical and Electronic Components

*Click to view similar products for [Coded Rotary Switches](#) category:*

*Click to view products by [Hartmann](#) manufacturer:*

Other Similar products are found below :

[PT65SG178](#) [PT65SG23](#) [DRS4010](#) [CW1S-2E11](#) [S-1031A](#) [SBS1004](#) [P36S101TR](#) [P65THR101L254](#) [RM3AF-10R-V-T/R](#) [RH3HAF-10R-V-B](#)  
[PT65501RT](#) [P25SMT101TR](#) [P65SMT101](#) [P65THR101V](#) [MSDR-10H1](#) [GSDR-10S](#) [01-1433](#) [07-3153](#) [07-3154](#) [CRD10CM0SBR](#) [DRS4116](#)  
[94HCB16RAT](#) [94HCB10T](#) [94HBB16WT](#) [94HBB16RAT](#) [94HBB10WT](#) [94HBB10RAT](#) [94HBB08RAT](#) [94HAC10T](#) [94HAB16WT](#)  
[94HAB16T](#) [94HAB10WT](#) [94HAB10RAT](#) [94HAB08WT](#) [94HAB08RAT](#) [ND3FR10P](#) [ND3FR16B-R](#) [DRR3110](#) [94HEB08WRT](#)  
[94HCB16WT](#) [94HCB16T](#) [94HCB10RAT](#) [94HCB08T](#) [94HBB16T](#) [94HBB10T](#) [94HBB08T](#) [94HAB16RAT](#) [94HAB10T](#) [94HAB08T](#) [S-2011A](#)