

TYPE M

High power contacts – solder pin – angled

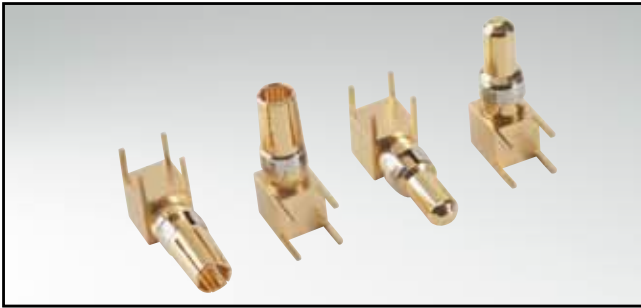

RoHS compliant

DESCRIPTION

- Precision machined contacts
- Quality class 3: gold flash
- Quality class 1: 0.8µm gold on mating side
- Other quality classes on request
- Assembled contacts available on request

PRODUCT DRAWING

Socket contact

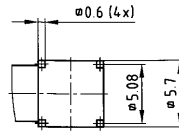
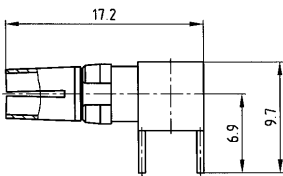

Plug contact

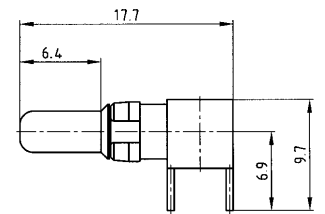

Premating contact

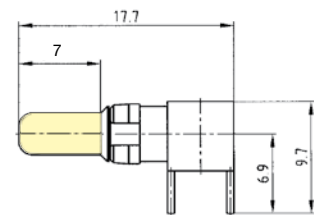

ORDER DATA

(Dim. = mm)

SOCKET CONTACT			
Current rating	Quality class	Termination	Part number
40 A	1	26	124 C 10019 X
40 A	3	13	124 A 10019 X

PLUG CONTACT			
Current rating	Quality class	Termination	Part number
40 A	1	26	123 C 10019 X
40 A	3	13	123 A 10019 X

PREMATING CONTACT		
Current rating	Quality class	Part number
40 A	1	123 C 10029 X

X-ON Electronics

Largest Supplier of Electrical and Electronic Components

Click to view similar products for [conec](#) manufacturer:

Other Similar products are found below :

[121A10139X](#) [121A10309X](#) [121A10569X](#) [122A10249X](#) [122A10129X](#) [132J22039X](#) [141A10269X](#) [142A10289X](#) [15-000423](#) [161A10119X](#)
[162A10169X](#) [163A11199X](#) [165X16459X](#) [17-101244](#) [17-103530](#) [17-200351](#) [17-210131](#) [17-300800](#) [220F10079X](#) [241A25780X](#)
[243A10110X](#) [8HDD15PCM99B30X](#) [3005W5PXX99E40X](#) [302A10759X](#) [162A10079X](#) [162A10099X](#) [163A11259X](#) [163A13759X](#)
[163A17079X](#) [164A10059X](#) [17-111244](#) [244C11250X](#) [3005W1SAR71E40X](#) [3008W8SXX57A30X](#) [302A10109X](#) [360X30049X](#) [42-00010](#)
[DLS1PP5AN23X](#) [4STD25SAM99A10X](#) [17-101254](#) [15-000453](#) [33TS3101S-88N](#) [17-101184](#) [43-10032](#) [164A18119X](#) [15-006513](#)
[164A17039X](#) [43-11275](#) [17-103084](#) [43-20377](#)