

60 mm sq.

San Ace 60L



General Specifications

- Material Frame: Aluminum,
Impeller: Plastics (Flammability: UL94V-1)
- Expected Life Refer to specifications (L10:Survival rate:90% at 60°C ,
rated voltage, and continuously run in a free air state)
- Lead Wire ⊕red ⊖black (Sensor) yellow (Control) brown
- Storage Temperature -30°C to +70°C (Non-condensing)

60×60×25mm (Mass : 100g) **9LG type** **High Airflow**

Specifications

The following nos. **have PWM controls and pulse sensors.**

Model No.	Rated Voltage [V]	Operating Voltage Range [V]	PWM duty cycle ^{Note1)} [%]	Rated Current [A]	Rated Input [W]	Rated Speed [min ⁻¹]	Max. Airflow [m ³ /min] [CFM]	Max. Static Pressure [Pa] [inchH ₂ O]	SPL [dB(A)]	Operating Temperature [°C]	Expected Life [h]		
9LG0612P4S001	12	10.8 to 13.2	100	0.67	8.04	11,000	1.40 49.4	300 1.204	53	-20 to +70	180,000/60°C		
			20	0.06	0.72	2,900	0.36 12.7	20.8 0.083	20				
9LG0612P4J001			100	0.39	4.68	8,650	1.10 38.8	182 0.730	47				
			20	0.03	0.36	1,150	0.13 4.8	3.3 0.013	14				
9LG0612P4H001			100	0.17	2.04	6,150	0.78 27.5	97 0.389	35				
			20	0.03	0.36	1,350	0.17 6.0	4.7 0.018	14				
9LG0612P4M001			100	0.09	1.08	4,200	0.53 18.7	45 0.180	24				
			20	0.03	0.36	900	0.11 3.8	2.0 0.008	14				
9LG0624P4S001			24	21.6 to 26.4	100	0.34	8.16	11,000	1.40 49.4			300 1.204	53
					20	0.03	0.72	2,900	0.36 12.7			20.8 0.083	20
9LG0624P4J001					100	0.19	4.56	8,650	1.10 38.8			182 0.730	47
					20	0.02	0.48	2,200	0.28 9.8			12.0 0.048	17
9LG0624P4H001	100	0.08			1.92	6,150	0.78 27.5	97 0.389	35				
	20	0.02			0.48	1,300	0.16 5.6	4.3 0.017	14				
9LG0624P4M001	100	0.04			0.96	4,200	0.53 18.7	45 0.180	24				
	20	0.01			0.24	800	0.10 3.5	1.6 0.006	14				
9LG0648P4S001	48	36 to 72			100	0.18	8.64	11,000	1.40 49.4	305 1.224	53		
					20	0.02	0.96	2,900	0.36 12.7	20.8 0.083	20		
9LG0648P4J001					100	0.10	4.80	8,650	1.10 38.8	182 0.730	47		
					20	0.02	0.96	2,100	0.26 9.1	10.7 0.042	17		
9LG0648P4H001			100	0.06	2.88	6,150	0.78 27.5	97 0.389	35				
			20	0.02	0.96	1,000	0.12 4.2	2.5 0.010	14				
9LG0648P4M001			100	0.04	1.92	4,200	0.53 18.7	45 0.180	24				
			20	0.02	0.96	650	0.08 2.8	1.0 0.004	14				

Note : Fan does not rotate when PWM duty cycle is 0%.

※PWM Frequency : 25kHz

Other sensor specifications are available as options. Please refer to the index (p. 509).

Dimensions (unit: mm)

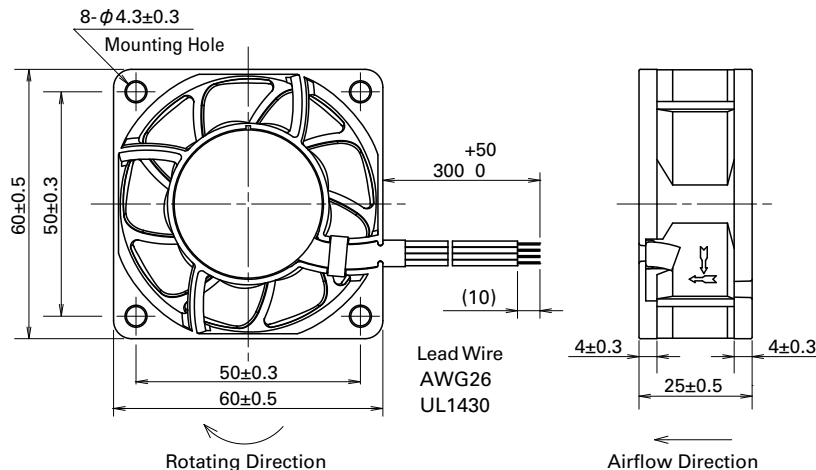

Reference Dimensions of Mounting Holes and Vent Opening (unit: mm)

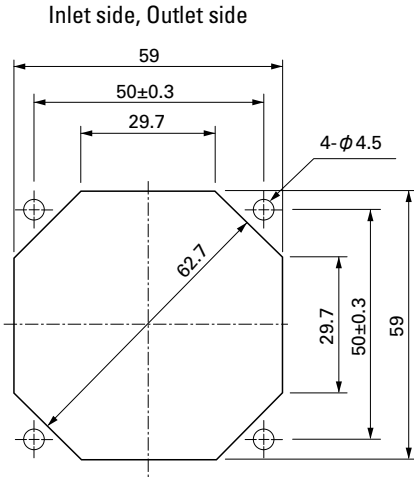

Options (unit: mm)

Finger Guards

Model : 109-139E Surface treatment : Nickel-chrome plating (silver)
 : 109-139H : Cation electropainting (black)

Color

Resin Finger Guards

Model : 109-1003G

Inlet side, Outlet side

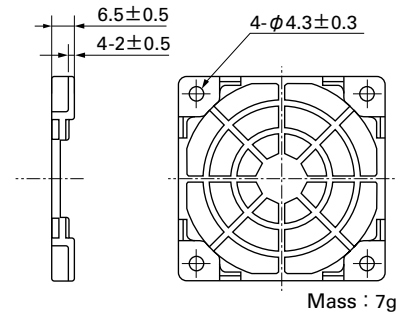
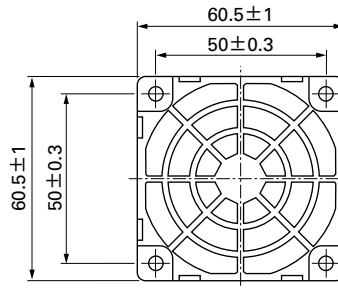
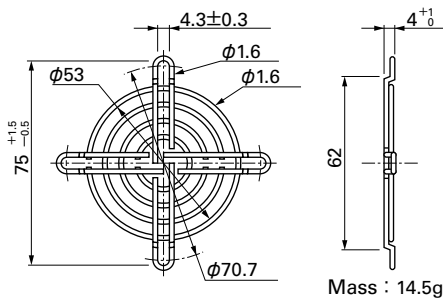

Resin Filter Kits

Model : 109-1003F13 (13PPI), 109-1003F20 (20PPI)
 : 109-1003F30 (30PPI), 109-1003F40 (40PPI)

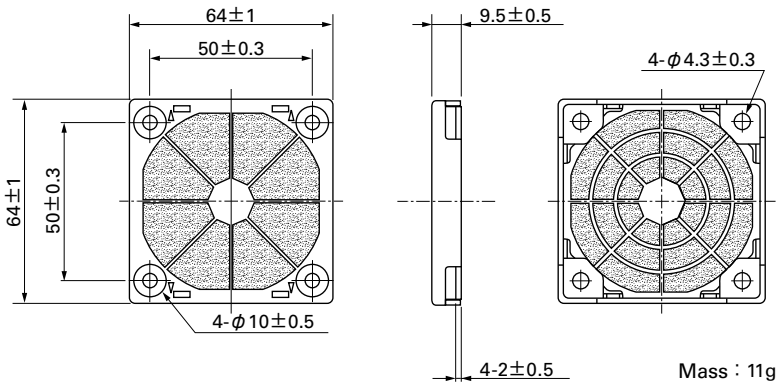

60mm sq.

San Ace 60L

60×60×25mm [Mass : 100g]

Airflow - Static Pressure Characteristics

PWM Duty Cycle

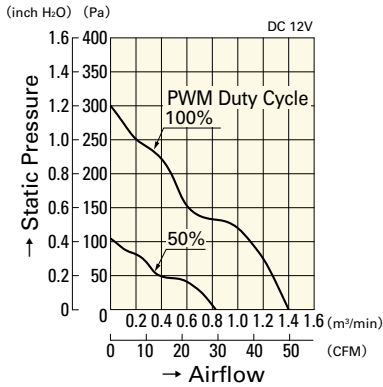

9LG0612P4S001

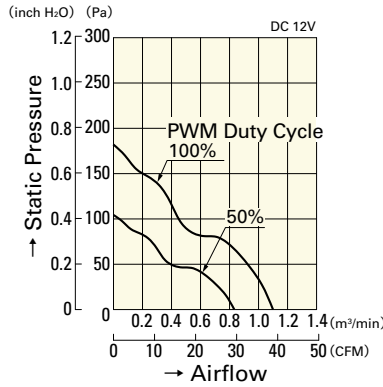

9LG0612P4J001

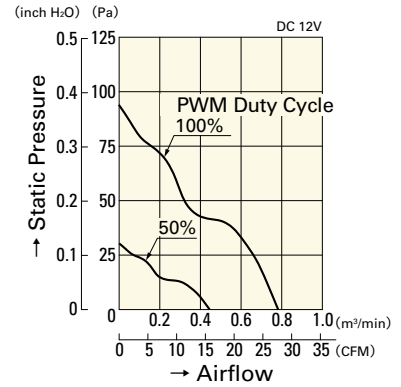

9LG0612P4H001

Operating Voltage Range

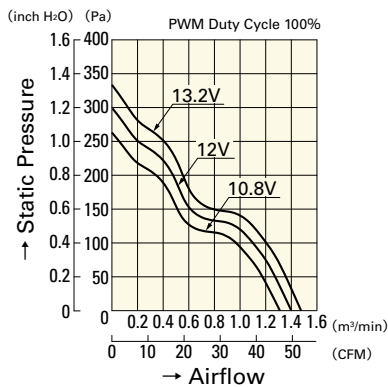

9LG0612P4S001

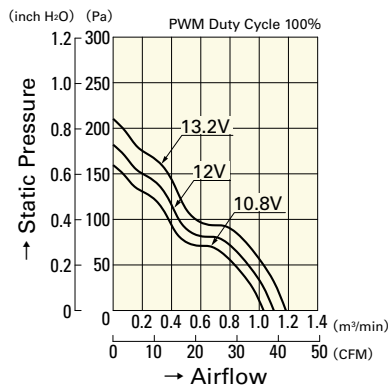

9LG0612P4J001

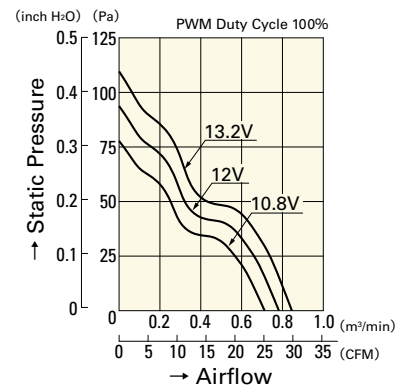

9LG0612P4H001

PWM Duty - Speed Characteristics Example

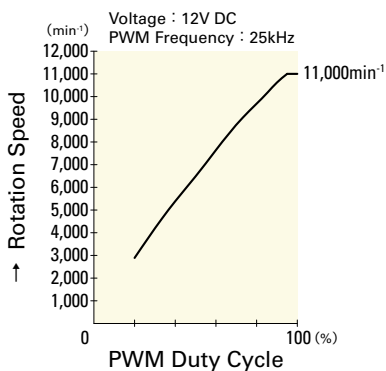

9LG0612P4S001

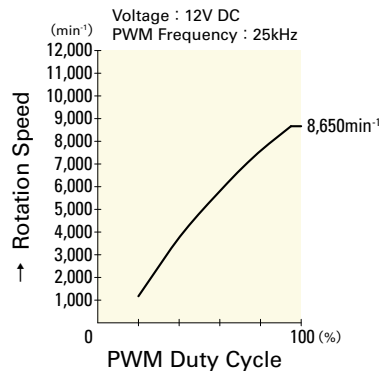

9LG0612P4J001

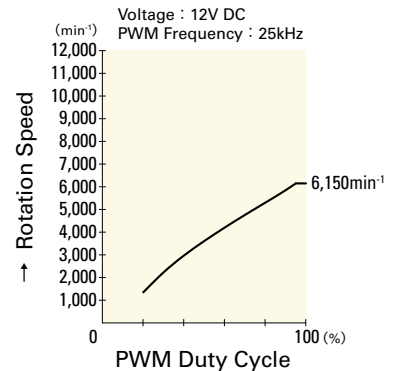

9LG0612P4H001

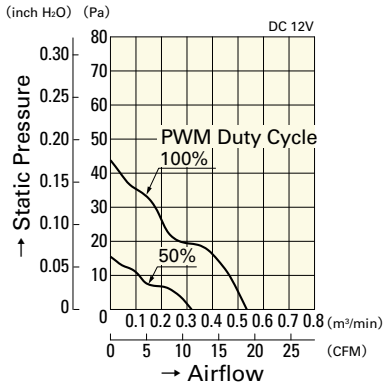

9LG0612P4M001

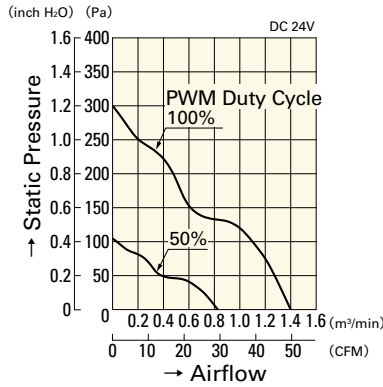

9LG0624P4S001

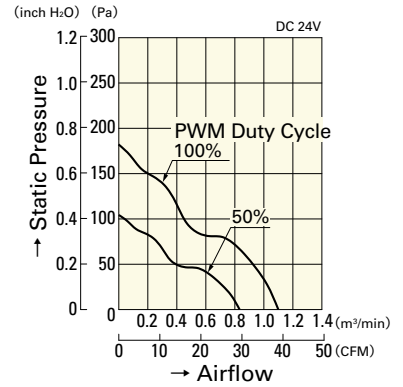

9LG0624P4J001

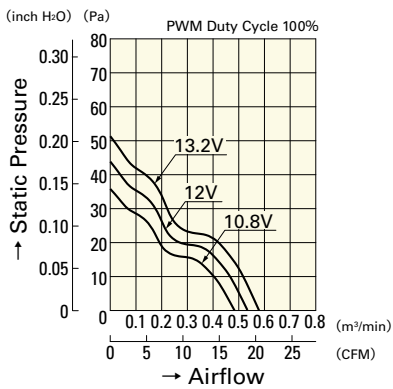

9LG0612P4M001

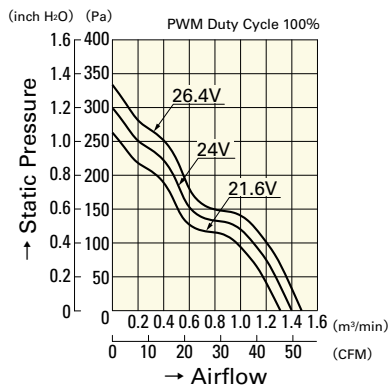

9LG0624P4S001

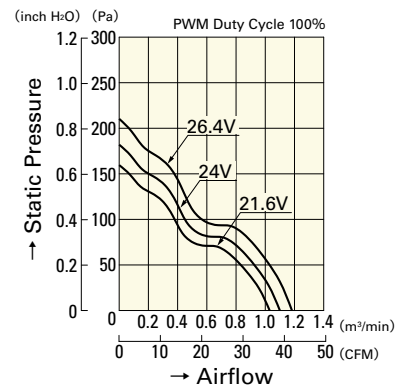

9LG0624P4J001

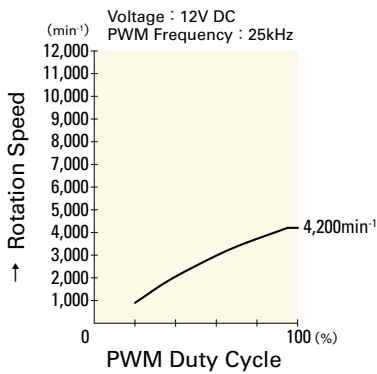

9LG0612P4M001

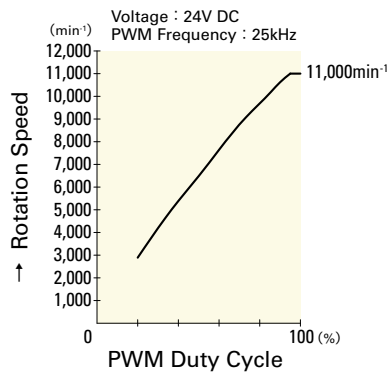

9LG0624P4S001

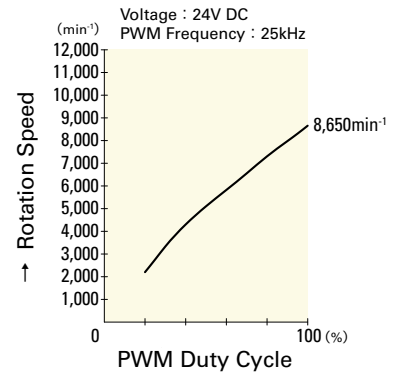

9LG0624P4J001

60mm sq.

San Ace 60L

60×60×25mm [Mass : 100g]

Airflow - Static Pressure Characteristics

PWM Duty Cycle

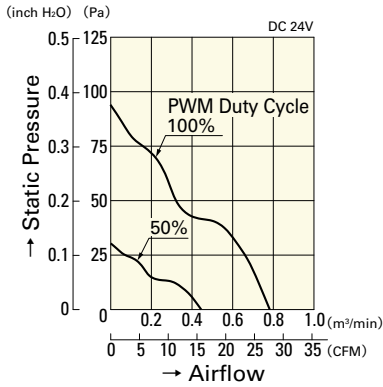

9LG0624P4H001

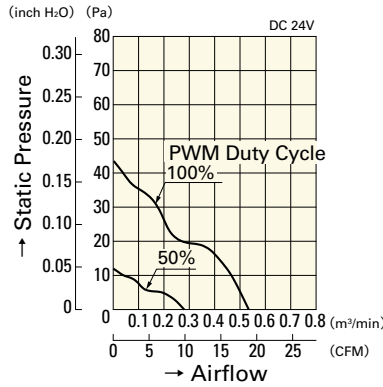

9LG0624P4M001

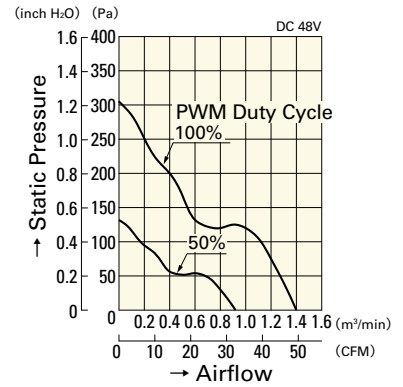

9LG0648P4S001

Operating Voltage Range

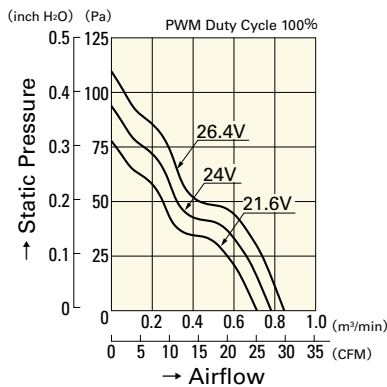

9LG0624P4H001

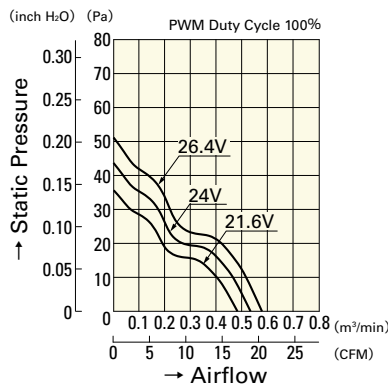

9LG0624P4M001

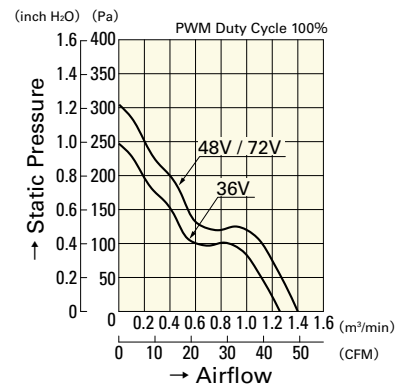

9LG0648P4S001

PWM Duty - Speed Characteristics Example

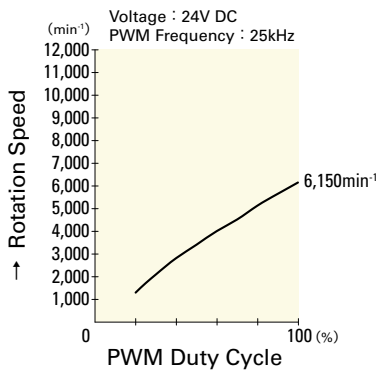

9LG0624P4H001

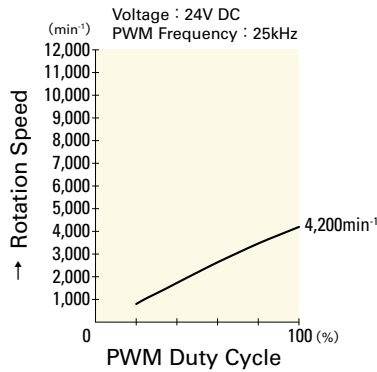

9LG0624P4M001

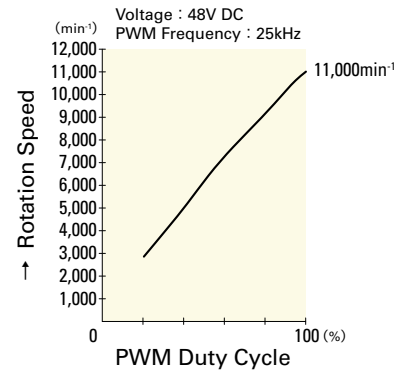

9LG0648P4S001

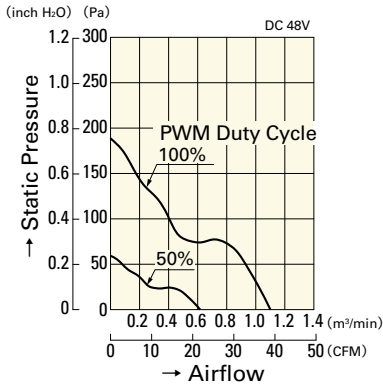

9LG0648P4J001

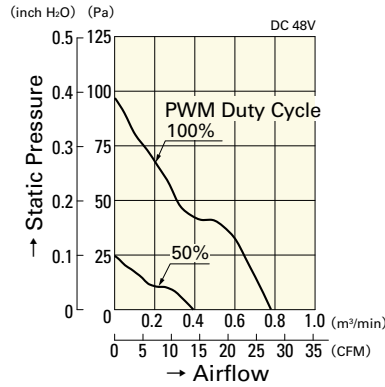

9LG0648P4H001

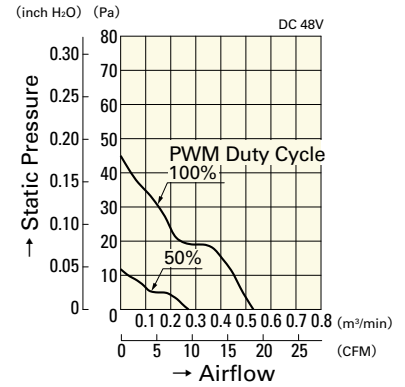

9LG0648P4M001

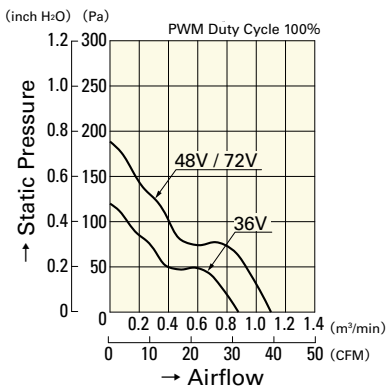

9LG0648P4J001

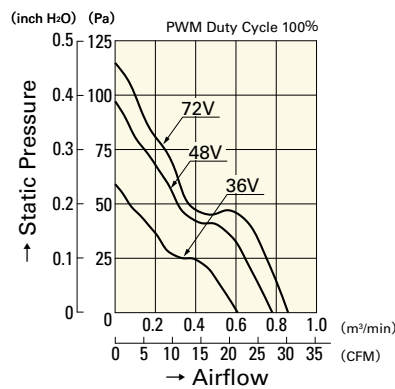

9LG0648P4H001

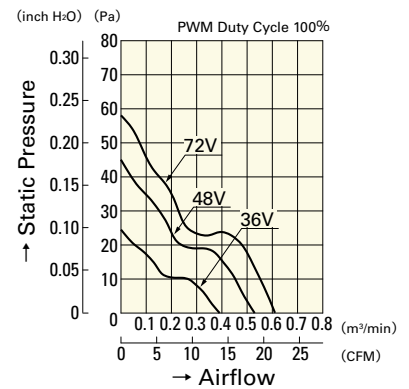

9LG0648P4M001

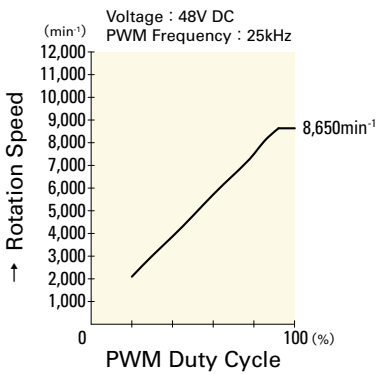

9LG0648P4J001

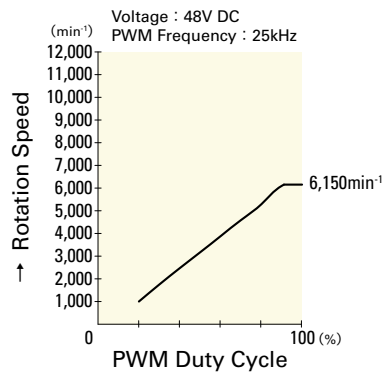

9LG0648P4H001

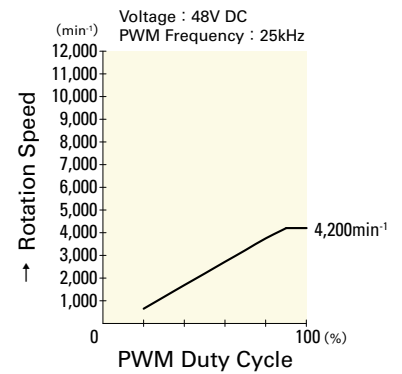

9LG0648P4M001

X-ON Electronics

Largest Supplier of Electrical and Electronic Components

Click to view similar products for [DC Fans](#) category:

Click to view products by [Sanyo Denki](#) manufacturer:

Other Similar products are found below :

[614R](#) [6424/2HP-210](#) [8312R](#) [DV4118/2NP-183](#) [AFB0948HH-S687](#) [PFB0824DHE-8B72](#) [G2E085-AA05-10](#) [RD20S-4/210660](#) [4318/12T](#)
[4418HH](#) [AUB0912H-F00](#) [3412N/2ME](#) [K2E225-RA92-09](#) [4184N/2XR](#) [5214N2HH](#) [614J2HHPR-010](#) [8412NGL-12](#) [4114N/12HHR-297](#)
[4656](#) [ZWR-903](#) [4112N12GL-175](#) [KD2406PKB2.\(2\).GN](#) [AFB1248HHE](#) [AFB1212LE-F00](#) [FAN-SCH-1](#) [MF60151V1-1000U-G99](#)
[PF80252V1-1000U-G99](#) [PF92252V1-1000U-G99](#) [4112N/2H6P](#) [4114N/17-251](#) [6212NH](#) [622/2N](#) [712F-011](#) [8218J/2NP-181](#) [W1G180-AB47-](#)
[15](#) [FAA1-12038NBKW31-A](#) [6318N/2TDP](#) [6318N/2H3PU](#) [6318HU](#) [424JMU](#) [PMD1206PTVX-A.U.GN](#) [PF80251B2-000U-F99](#)
[EF40101BX-1000U-G99](#) [AD1224LB-A71GL](#) [9GA0924L4021](#) [9GA0924M4021](#) [9GA0924M4011](#) [9GA0824B20011](#) [9GA0812A2D0011](#)
[9GA0912M4D011](#) [9GA0924W4D01](#)