

Solenoids

Series 43 high force/stroke ratio solenoid

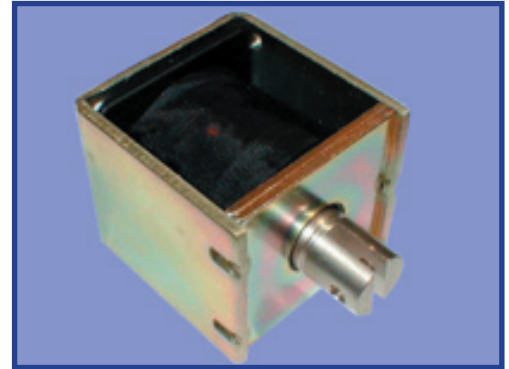

GENERAL DESCRIPTION

Heavy Duty

Pull & thrust versions

Shading ring for quiet AC operation

PERFORMANCE

| | Item | Specification |
|------------|---|---|
| ELECTRICAL | Maximum Ontime | See table below |
| | Closed power (continuous rating) | AC: 20VA DC: 12W |
| | Maximum permissible voltage | 240V |
| | Insulation | All coils tested to frame at 1500V RMS 50Hz |
| MECHANICAL | Weight | 425g Plunger: 49g |
| | Ambient temperature Force/Stroke curve | The information given on this page is based on room temperature of 20 C allowing for a nominal 75 C temperature rise in coil. These force curves show average performance only. In addition to normal manufacturing tolerances, deviations can be expected at some voltages due to the coil winding tolerances. |

FORCE/STROKE CURVES & ON TIME

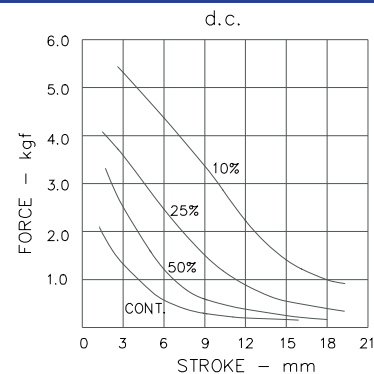
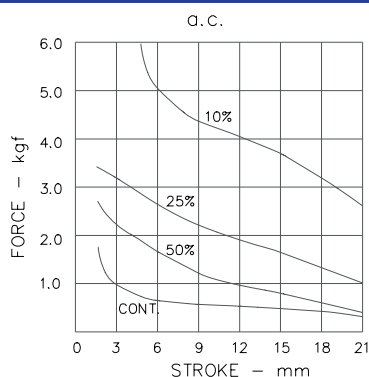

MAXIMUM ON TIME

| | 10% | | 25% | | 50% | |
|----|---------|-------------|----------|--------------|----------|---------------|
| | 1 cycle | Cont. cycle | 1 cycle | Cont cycling | 1 cycle | Cont. cycling |
| AC | 65 sec | 5 sec | 7.75 min | 1.25 min | 14.5 min | 2 min |
| DC | 55 sec | 35 sec | 3.5 min | 2 min | 7 min | 4.25 min |

DIMENSIONS (mm)

PULL TYPE - SHOWN ENERGISED

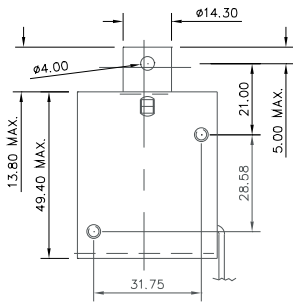

PUSH TYPE - SHOWN ENERGISED

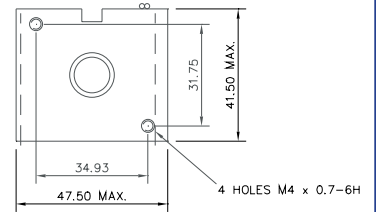
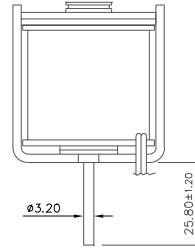
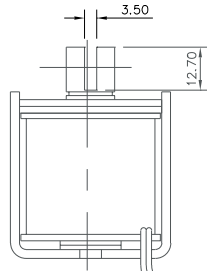

LEADS 203 LONG

CODING

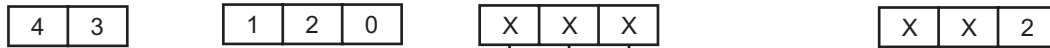

| | |
|----------------------|---|
| AC | 1 |
| DC | 6 |
| Pull | 1 |
| Push | 2 |
| STANDARD | 0 |
| With Push Off Spring | 1 |

| COIL | COIL | | | |
|--------------|-------|-----|-----|-----|
| | Cont. | 50% | 25% | 10% |
| 24V AC 50 Hz | 01 | 02 | 03 | N/A |
| 50V AC 50Hz | 08 | 09 | 10 | 11 |
| 115V AC 50Hz | 15 | 16 | 17 | 18 |
| 220V AC 50Hz | 23 | 24 | 25 | 26 |
| 230V AC 50Hz | 39 | 40 | 41 | 42 |
| 115V AC 60Hz | 19 | 20 | 21 | 22 |
| 220V AC 60Hz | 27 | 28 | 29 | 30 |
| 230V AC 60Hz | 43 | 44 | 45 | 46 |
| 6V DC | 54 | N/A | N/A | N/A |
| 9V DC | 58 | 59 | 59 | 60 |
| 12V DC | 62 | 63 | 64 | 65 |
| 24V DC | 72 | 73 | 74 | 75 |
| 28V DC | 76 | 77 | 78 | 79 |
| 36V DC | 80 | 81 | 82 | 83 |
| 50V DC | 84 | 85 | 86 | 87 |
| 115V DC | 88 | 89 | 90 | 91 |
| 220V DC | 92 | 93 | 93 | 94 |
| 240V DC | 96 | 97 | 98 | 99 |

| | |
|----------------|---|
| Standard Leads | 0 |
| Faston Tags | 3 |



BLP products are designed, manufactured and tested to ISO 9001 quality standards.
 BLP Reserve the right to change without prior notice the information contained in this leaflet.

BLP Components Ltd., Exning Rd, Newmarket, Suffolk CB8 0AX, England
 Tel: +44 (0)1638 665161 Fax: +44 (0)1638 660718 Email: sales@blpcomp.com Website: http://www.blpcomp.com

X-ON Electronics

Largest Supplier of Electrical and Electronic Components

Click to view similar products for [ped manufacturer](#):

Other Similar products are found below :

[41 120 610 620](#)