

USB3 female to female keystone coupler, wired 1:1



USB3 A female to A female keystone coupler (KCUAA311wh)

This USB3 keystone coupler can be used as an interconnection point between two A-A cables. With its standardised dimensions it can be used for easy snap-in mounting in a keystone patch panel, face plate or surface-mount box.

Features

- USB 3.0 style keystone coupler type (A female connectors on the front and back)
- Wired pin 1 : 1 and clearly marked with wiring
- Connection from and to USB1.1, USB2.0 and USB3.0
- Standard format keystone fits a wide range of panels, adaptors and faceplates
- Available as part of our innovative new panel mount and D UNIVERSAL range

Specifications:

- Dimensions (LxWxH): approx. 34.3x16.2x19.5mm
- Weight: approx. 10g
- Housing: ABS UL94V-0
- Colour: white
- Connection: USB3.0 F/F

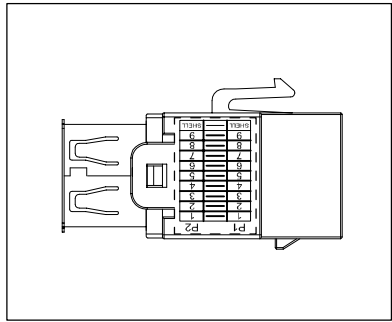
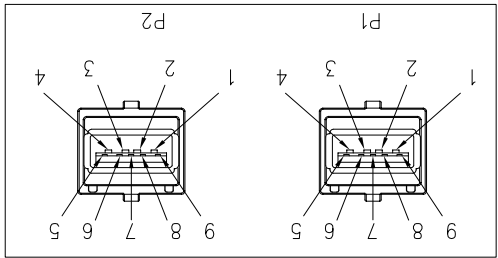

P1	1	2	3	4	5	6	7	8	9	SHELL
P2	1	2	3	4	5	6	7	8	9	SHELL

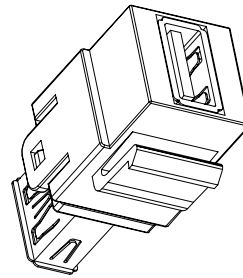
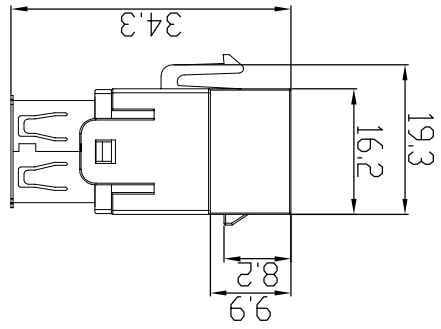
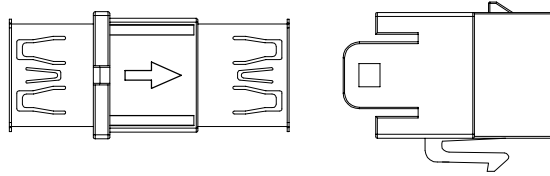

X-ON Electronics

Largest Supplier of Electrical and Electronic Components

Click to view similar products for [tuk](#) manufacturer:

Other Similar products are found below :

[SP1YW](#) [SP0.5BL](#) [FJKPT](#) [SKMCBKDPM](#) [PXCAT6S8XL2](#) [OT45BK](#) [SKFYW](#) [TSY](#) [PXSPDY6S#100](#) [PSPDY5#100](#) [PSDL-6#20](#) [WJOL](#)
[F78BKB](#) [FACK2BKDPM](#) [FJP2](#) [SKFBKDPM](#) [SPDL5BK](#) [SP10BK](#) [SKH1LJ](#) [PXSPDY5#10](#) [PSDL-5#100](#) [WJSG](#) [FJ445](#) [SP2GN](#) [SP10GN](#)
[SLJBKDPM](#) [SILS](#) [SP5GN](#) [SGPZ10BK](#) [MGOP6](#) [PXSPDY6#10](#) [TRCSPDY3](#) [SKH4](#) [SGKSSU-45WH](#) [SP10BL](#) [SGPZ3BK](#) [ADF](#) [CPR2](#)
[SEKEI-45WH](#) [SGKH2](#) [TRCSPDYBP](#) [SP10YW](#) [KPJ2BK](#) [KH2](#) [KOCSM](#) [SGACK2SPM](#) [KPH1BK](#) [PXSPDY6#100](#) [KOCSMDPM](#) [SP1BK](#)