

# R13 Round Rocker Switches 10A 250Vac

rocker switches



- ▶ Miniature round rocker switch
- ▶ Ratings up to 10A, 250Vac
- ▶ Single & double pole
- ▶ Illuminated & non-illuminated, neon and LED
- ▶ Choice of actuators
- ▶ Matching indicator
- ▶ Panel cut out: 20.2 dia.

## Approvals and specifications



SP 10(4)A 250Vac T85 1E4



DP 10(4)A 250Vac T85 1E4



UL CSA SP 16A 125Vac & 10A 250Vac  
 UL CSA DP 16A 125Vac, 10A 250Vac, 10A 28Vdc  
 UL 85°C, file E67774(S), CSA file LR45128

### RoHS compliant

Single pole has  $\mu$  contact gap. Technical data on pages 4 & 5.

### Special products

Are made to order and can be supplied with a range of body and rocker/lens colours, print & lamp voltage. Call sales for availability to your special requirements.

## R13 112A AAA

TERMINAL FUNCTION ROCKER BODY PRINT, COLOUR, VOLTAGE ETC

### PRODUCT DETAILS



SP ON - OFF  $\mu$

**Cat no.**  
R13 112A AAA

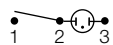

SP ON - OFF  $\mu$   
Lit 230V

**Cat no.**  
R13 112B NAC



SP ON - OFF  $\mu$

**Cat no.**  
R13 112A AAB

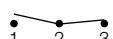

SP ON - ON  $\mu$

**Cat no.**  
R13 112C AAA



SP ON - OFF  $\mu$   
Lit 230V

**Cat no.**  
R13 112B NAA



SP ON - OFF - ON  $\mu$

**Cat no.**  
R13 112D AAA



SP ON - OFF  $\mu$   
Lit 230V

**Cat no.**  
R13 112B NAB



SP ON - OFF  $\mu$   
(Momentary ON)

**Cat no.**  
R13 208F AAA\*



DP ON - OFF

**Cat no.**  
R13 244A AAA

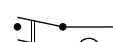

DP ON - OFF  
Lit 230V

**Cat no.**  
R13 244B NAA

### DIMENSIONS (mm)

#### Panel cut-out

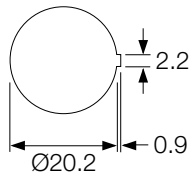

Snap fixing into panel thickness up to 3.0

#### Single pole

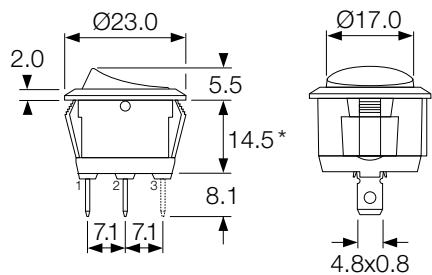

\* R13 208F has 12.5mm deep body

#### Double pole

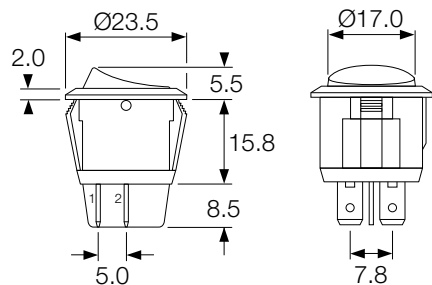



R13 112B NAA



R13 112A AAA



R13 112A2 ---

**PRODUCT DETAILS**

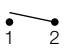

  
 SP ON - OFF  $\mu$   
 Bright colour ON signal  
**Cat no.**  
**R13 112A2 - -**

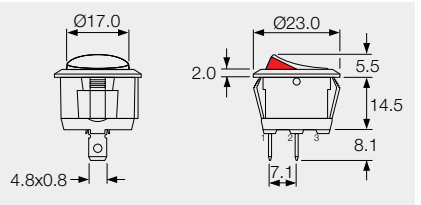

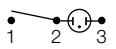
  
 SP ON - OFF  $\mu$   
 Lit Window  
**Cat no.**  
**R13 112B2 - -**

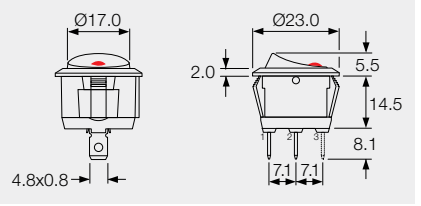

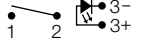
  
 SP ON - OFF  $\mu$   
 Paddle tip has red LED  
**Cat no.**  
**R13 112LP - -**

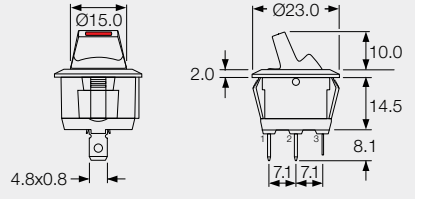

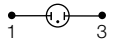
  
 Indicator light  
**Cat no.**  
**R9 92B - -**

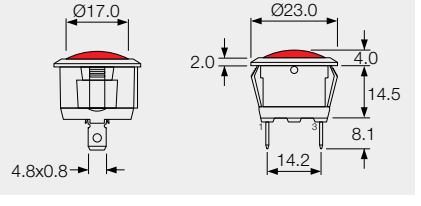

**PANEL CUT-OUT (mm)**

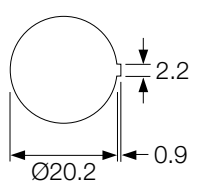

Snap fixing into 2.0 to 3.0mm panels

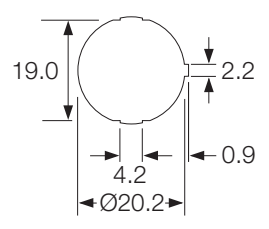

Snap fixing into 0.7 to 3.0mm panels



**Protective cover L188**  
 Snaps on to bodies (not R13 211 or R13 112LP), this reduces maximum acceptable panel thickness by 0.8mm.

## X-ON Electronics

Largest Supplier of Electrical and Electronic Components

*Click to view similar products for [Rocker Switches](#) category:*

*Click to view products by [Arcoelectric](#) manufacturer:*

Other Similar products are found below :

[VKD2GHNB-00000-000](#) [VSD2GNNB-00000-000](#) [6-1571986-5](#) [6-1571986-9](#) [7036WWCDBX653+U622](#) [8055K52Z7V](#) [8138K20E6M50](#)  
[FMC18A2200002](#) [84206L](#) [84312LX](#) [PREDD4-07F-BB0FW](#) [PREDD5-07F-BB0GW](#) [PRFDD1-16F-BB000](#) [PRFDD3-16F-BB000](#) [1-](#)  
[1634201-0](#) [999-16702-001](#) [A101J2ZQ004](#) [A101J4ZQ004](#) [A101J51CB0004](#) [A107J51ZQ0004](#) [A201J1AQ004](#) [A201J1AV2Q004](#)  
[A201J3ZB004](#) [A201J50ZQ004](#) [A203J51ZQ0004](#) [A226L11YZQ](#) [A22L11A](#) [A435S1YZQ](#) [H8500XBBBBL-A](#) [H8653VBBG2577W](#)  
[HB130CHNWWNAAC](#) [1251.0303](#) [AE205J60V3B004](#) [RH110C2NBB](#) [1352.0107](#) [1363.0201](#) [AML25GBF2AA03GR](#) [1571099-3](#) [1571987-4](#)  
[1571987-5](#) [1571989-7](#) [B123J77V7B2](#) [B226J50W4Q22P](#) [B433J37ZQ22M](#) [160212E](#) [1801.1164](#) [1831.1102](#) [1833.3402](#) [1837.1118](#) [1838.8302](#)