

# R13 Round Rocker Switches 10A 250Vac

rocker switches



- ▶ Miniature round rocker switch
- ▶ Ratings up to 10A, 250Vac
- ▶ Single & double pole
- ▶ Illuminated & non-illuminated, neon and LED
- ▶ Choice of actuators
- ▶ Matching indicator
- ▶ Panel cut out: 20.2 dia.



SP 6A 250Vac T85,  
DP 10(4)A 250Vac T85

UL CSA SP 10A 125Vac & 6A 250Vac (For 16A call the factory)  
UL CSA DP 8A 125/250Vac  
UL 85°C, file E67774(S)  
CSA file LR45128



RoHS compliant

Single pole has  $\mu$  contact gap.  
Technical data on pages 4 & 5.

**Standard products**

Are supplied with the body and rocker color, print & lamp voltage shown in the product illustration and description.

**PRODUCT DETAILS**



SP ON - OFF  $\mu$

**Cat no.**  
**R13 112ABB-602AW**



SP ON - OFF  $\mu$   
Lit 110V

**Cat no.**  
**R13 112BWR2**



SP ON - OFF  $\mu$

**Cat no.**  
**R13 112AWW-602AB**

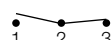

SP ON - ON  $\mu$

**Cat no.**  
**R13 112CBB**

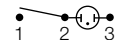

SP ON - OFF  $\mu$   
Lit 110V

**Cat no.**  
**R13 112BBBR2**

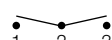

SP ON - OFF - ON  $\mu$

**Cat no.**  
**R13 112DBB-730W**



SP ON - OFF  $\mu$   
Lit 110V

**Cat no.**  
**R13 112BBG2**



SP ON - OFF  $\mu$   
(Momentary On)\*

**Cat no.**  
**R13 208FBB**



DP ON - OFF  
Lit 110V

**Cat no.**  
**R13 244ABB-602AW**



DP ON - OFF  
Lit 110V

**Cat no.**  
**R13 244BBR2**

**DIMENSIONS (mm)**

**Panel cut-out**

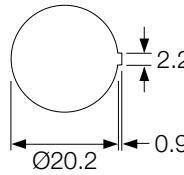

Snap fixing into panel thickness up to 3.0

**Single pole**

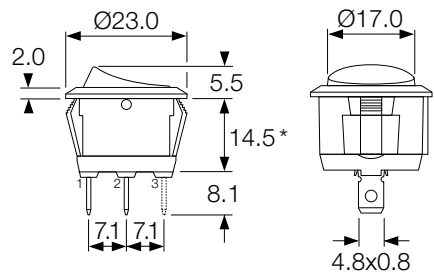

\* R13 208F has 12.5mm deep body

**Double pole**

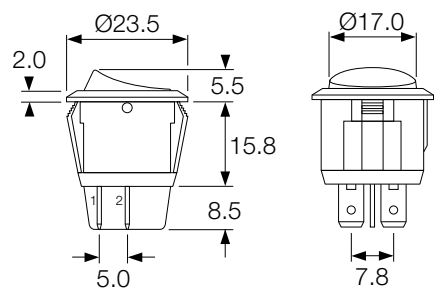

**ORDER FORMAT**



R13 112B



R13 112A



R13 112A2 ---

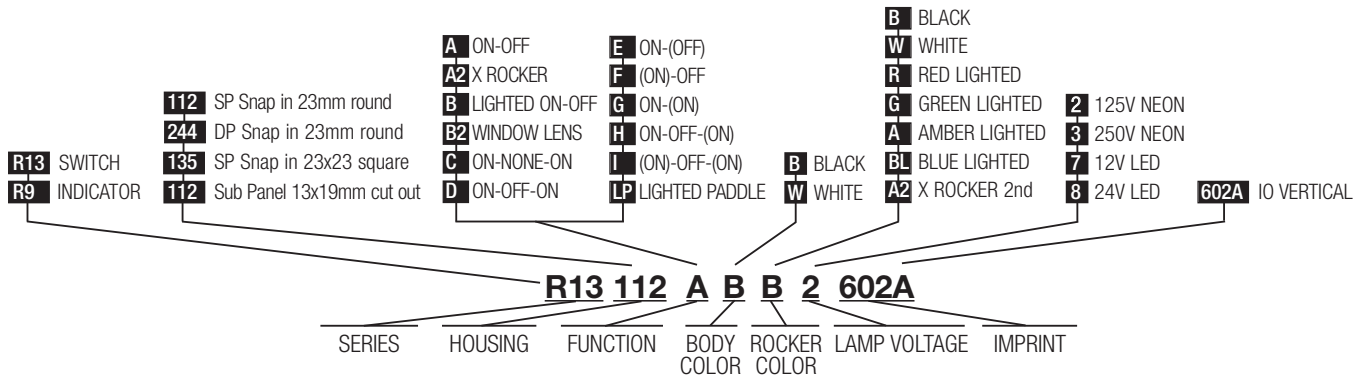

rocker switches

**PRODUCT DETAILS**



SP ON - OFF  $\mu$   
Bright colour ON signal  
**Cat no.**  
**R13 112A2BBR**

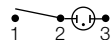
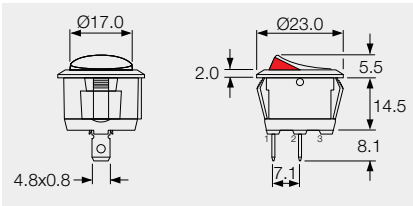

SP ON - OFF  $\mu$   
Lit Window 110V  
**Cat no.**  
**R13 112B2BR2**

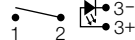
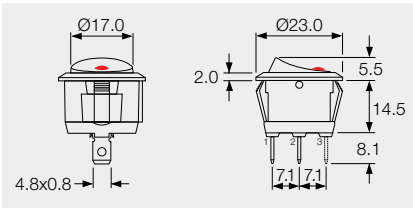

SP ON - OFF  $\mu$   
Paddle tip has red LED  
**Cat no.**  
**R13 112LPBBR**

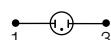
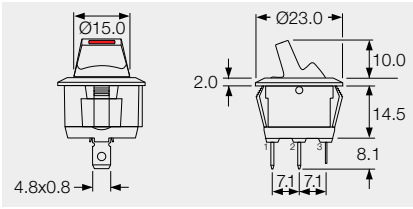

Indicator light 110V  
**Cat no.**  
**R9 92B BR2**

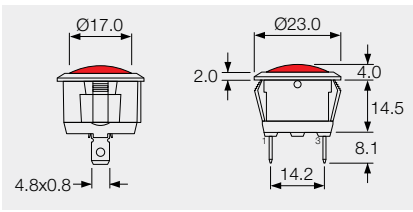

approvals - contact sales

**PANEL CUT-OUT (mm)**

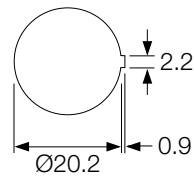

Snap fixing into panel thickness up to 3.0



**Protective cover L188**

Snaps on to bodies (not R13 211 or R13 112LP), this reduces maximum acceptable panel thickness to 2.4mm.

## X-ON Electronics

Largest Supplier of Electrical and Electronic Components

*Click to view similar products for [Rocker Switches](#) category:*

*Click to view products by [Arcoelectric](#) manufacturer:*

Other Similar products are found below :

[VKD2GHNB-00000-000](#) [VSD2GNNB-00000-000](#) [6-1571986-5](#) [6-1571986-9](#) [7036WWCDBX653+U622](#) [8055K52Z7V](#) [8138K20E6M50](#)  
[FMC18A2200002](#) [84206L](#) [84312LX](#) [PREDD4-07F-BB0FW](#) [PREDD5-07F-BB0GW](#) [PRFDD1-16F-BB000](#) [PRFDD3-16F-BB000](#) [1-](#)  
[1634201-0](#) [999-16702-001](#) [A101J2ZQ004](#) [A101J4ZQ004](#) [A101J51CB0004](#) [A107J51ZQ0004](#) [A201J1AQ004](#) [A201J1AV2Q004](#)  
[A201J3ZB004](#) [A201J50ZQ004](#) [A203J51ZQ0004](#) [A226L11YZQ](#) [A22L11A](#) [A435S1YZQ](#) [H8500XBBBBL-A](#) [H8653VBBG2577W](#)  
[HB130CHNWWNAAC](#) [1251.0303](#) [AE205J60V3B004](#) [RH110C2NBB](#) [1352.0107](#) [1363.0201](#) [AML25GBF2AA03GR](#) [1571099-3](#) [1571987-4](#)  
[1571987-5](#) [1571989-7](#) [B123J77V7B2](#) [B226J50W4Q22P](#) [B433J37ZQ22M](#) [160212E](#) [1801.1164](#) [1831.1102](#) [1833.3402](#) [1837.1118](#) [1838.8302](#)