



# JD9 SERIES

KEY SWITCH  
 Ø19.2 mm PANEL CUTOUT



## KEYSWITCH

### ELECTRICAL SPECIFICATION:

CONTACT RATING:	4A 125VAC/28VDC, 2A 250VAC
CONTACT RESISTANCE:	BELOW 10 MILLION OHMS
INSULATION RESISTANCE:	10 <sup>9</sup> OHMS Min.
DIELECTRIC STRENGTH:	1000V RMS Min. Sea level
ELECTRICAL LIFE:	6,000 make-and-break cycles at Full load.

PATENT NO. 36076

### MATERIALS:

LOCK HOUSING:	ZINC ALLOY DIE-CASTED NICKEL PLATED
CYLINDER:	4 DISC TUMBLER CONSTRUCTION, ZINC ALLOY DIE-CASTED NICKEL PLATED.
KEYS:	BRASS, NICKEL PLATED, SINGLE BITTED.
CONTACTS:	SUPER HARD COPPER ALLOY, GOLD PLATED.
MOUNTING NUT:	ZINC ALLOY DIE CASTED NICKEL PLATED.

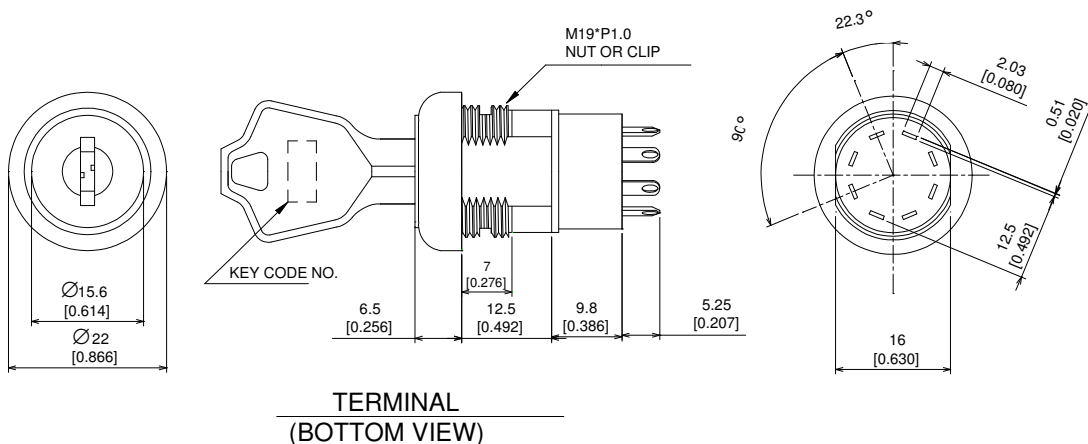

TERMINAL  
(BOTTOM VIEW)

### LEGEND:

- ▼ = Momentary position (45°)
- = Detent positions (45° or 90°)
- ⊙ = Key pull possible in these positions
- ▼ or ● or ⊙ --- Stop positions.

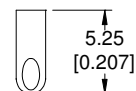
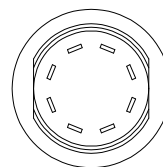



# JD9 SERIES

KEY SWITCH  
Ø19.2 mm PANEL CUTOUT

LOCK CONFIGURAIION (AS VIEWED FROM KEY END)	MODEL / NO. NO. / POLES	CONNEDCTED TERMINALS					KEY PULL POSSIBLE THESE POS.
		POS.1	POS.2	POS.3	POS.4	POS.5	
 POS.1 2 45° 3 INDEXING	JD9H126W	8-1 4-5	1-2 5-6	7-8 3-4			POS.1
 POS.1 2 45° 3 INDEXING	JD9J126W	8-1 4-5	1-2 5-6	7-8 3-4			POS.1 POS.2 POS.3
 POS.1 2 90° 3 INDEXING	JD9O126W	8-1 4-5	1-3 5-7				POS.1
 POS.1 2 90° 3 INDEXING	JD9S126W	8-1 4-5	1-3 5-7				POS.1 POS.2

## ATTACHED WIRE SPEC

TERMINAL	LENGTH(mm)	SPEC		
1	250	UL1007	20AWG	BLACK
2	250	UL1007	20AWG	BLUE
3	250	UL1007	20AWG	BROWN
4	250	UL1007	20AWG	GREEN
5	250	UL1007	20AWG	GREY
6	250	UL1007	20AWG	RED
7	250	UL1007	20AWG	VIOLET
8	250	UL1007	20AWG	YELLOW

## X-ON Electronics

Largest Supplier of Electrical and Electronic Components

*Click to view similar products for [Keylock Switches](#) category:*

*Click to view products by [Apem](#) manufacturer:*

Other Similar products are found below :

[89496-09](#) [89638-00](#) [58J9A90-01C02N](#) [719-0022-020](#) [719-0122-000](#) [719-0201-000](#) [719-0202-000](#) [719-0702-000](#) [84800-04](#) [88521-00](#)  
[GKNC33L](#) [GKNC3L](#) [PVA2OAH5](#) [14-136.025K](#) [14-235.022K](#) [AS6H-2K2A](#) [AS6M-2K1B](#) [1571487-1](#) [HW4K-2BF20](#) [JD7510H](#)  
[K6SLYE1.55NL327SD](#) [KH3C-20C](#) [89638-05](#) [A028301](#) [A165K-J2AL-2](#) [A165K-J2M-2](#) [A165K-J3AMR](#) [A165K-J3M](#) [205389 \(PAYGUARD](#)  
[BUTTON PAD\)](#) [2SWK131AL102](#) [30PA39-AML](#) [LW6MJ-2C64WWB](#) [AS6M-2K1A](#) [51-401.036D](#) [51-401.036K](#) [51-414.036D](#) [HW1K-](#)  
[3HF20](#) [4370039](#) [Y1112-2027CLFT](#) [4B01H322NCFQ](#) [51-155.025D](#) [51-195.025D](#) [51-378.AD](#) [51-404.036D](#) [51-405.036D](#) [51-415.036D](#) [1-](#)  
[1437597-8](#) [86945-05](#) [88169-05](#) [719-0204-000](#)