

3M™ INDUSTRIAL RJ45 MODULAR PLUG
FOR ENHANCED CATEGORY 5 CABLE, MODULAR, IDC, WIREMOUNT

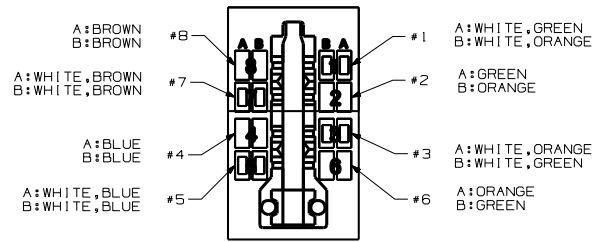

SIGNAL WIRING GUIDE
ON SEAL (T568A/T568B)

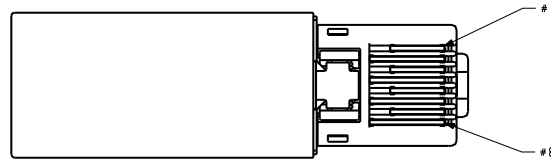
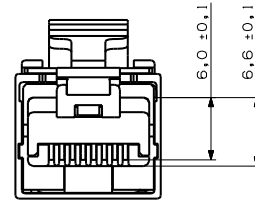
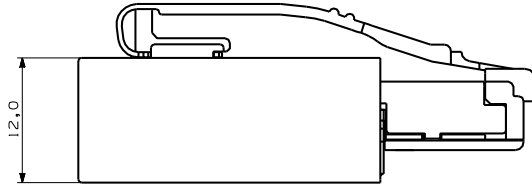
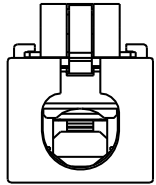
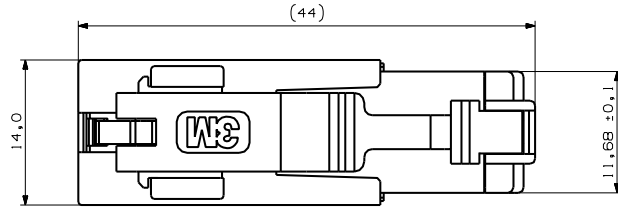
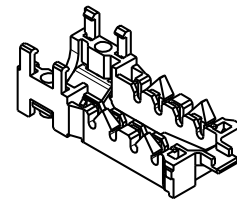

SIGNAL WIRING LAYOUT INFORMATION
OF COVER MODULES

PERFORMANCE

- 1) MECHANICAL
 - INSERTION FORCE: 20N MAX.
 - WITHDRAWL FORCE: 20N MAX. (EXCLUDE LATCH MECHANISM)
 - LATCH RETENTION FORCE: 49N MIN.
 - 2) ELECTRICAL
 - CURRENT RATING: 0.5A
 - VOLTAGE RATING: 24V
 - WITHSTANDING VOLTAGE: 100VACrms
 - INSULATION RESISTANCE: 5×10^8 OHMS at 100VDC
 - RETURN LOSS: TO MEET ENHANCED CATEGORY 5 REQUIREMENT (EIA/TIA-568 B.2 CAT5)
 - NEAR END CROSS TALK: TO MEET ENHANCED CATEGORY 5 REQUIREMENT (EIA/TIA-568 B.2 CAT5)
 - SHIELD RESISTANCE: 100 MILLI OHM AT INITIAL CONDITION
 - CONTACT RESISTANCE: 100 MILLI OHM AT INITIAL CONDITION DELTA R 25 MILLI OHM MAX. AFTER EVALUATION TEST BASED ON 78-5102-0130-0
 - 3) ENVIRONMENTAL
 - TEMPERATURE RATING: -40°C TO 70°C
- NOTE
THE HIGH FREQ. ELECTRICAL PERFORMANCE OF CABLES DIFFERS ACCORDING TO FACTORS SUCH AS CABLE STRUCTURE, CABLE LENGTH, AND INSTALLATION LAYOUT. THEN TO CHECK THE HIGH FREQ. ELECTRICAL PERFORMANCE OF THE CABLE ASSEMBLY BEFORE INSTALLATION IS RECOMMENDED.
- NOTE
FOR LOW TEMPERATURE LIMIT: EXCLUDING CABLE PERFORMANCE, NO DEW CONDITION
FOR HIGH TEMPERATURE LIMIT: INCLUDING TEMPERATURE RAISING BY CURRENT

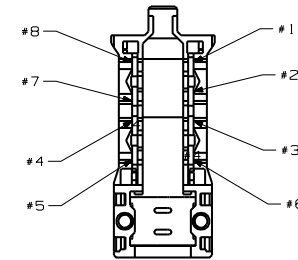

NOTES

- 1 MATERIAL:
BODY: GLASS REINFORCED THERMOPLASTIC, UL 94V0
CASE, COVER AND LATCH THERMOPLASTIC, UL 94V0
CONTACT: COPPER ALLOY
- 2 PLATING
UNDER NICKEL PLATING
CONTACT AREA: 1.27um GOLD MIN.
TERMINAL AREA: Sn PLATING
- 3 MATED WITH INDUSTRIAL RJ45 MODULAR JACK CONNECTOR
- 4 COMPATIBLE CABLE: ENHANCED CATEGORY 5 CABLE AS FOLLOWS
 - 1) WIRE
AWG 24 SOLID
AWG 24 STRANDED (7 WIRES)
AWG 26 STRANDED (7 WIRES)
 - 2) CABLE GROUNDING
BRAIDED SHIELD OR DRAIN WIRES
 - 3) CABLE OUTER DIAMETER
6.8mm MAX.
- 5 RoHS COMPLIANT. SEE THE REGULATORY INFORMATION APPENDIX (RIA) IN THE "RoHS COMPLIANCE" SECTION OF WWW.3MCONNECTORS.COM FOR COMPLIANCE INFORMATION (RIA E1 & C1 APPLY).
- 6 FOR PRODUCT SPECIFICATIONS AND WARRANTY INFORMATION SEE 3M 78-5102-0130-0
- 7 IN THE EVENT OF CONFLICT BETWEEN THIS DATA AND THAT CONTAINED IN THE PRODUCT SPECIFICATION, THE PRODUCT SPECIFICATION TAKES PRECEDENT.

3M™ ELECTRONIC SOLUTIONS DIVISION
INTERCONNECT SOLUTIONS
VISIT <http://www.3mconnectors.com>

3M IS A TRADEMARK OF 3M COMPANY.
FOR TECHNICAL, SALES OR ORDERING INFORMATION
CALL YOUR LOCAL SALES REPRESENTATIVE

ORDERING INFORMATION RJ45 MODULAR PLUG

3R1 08-0000-000 CE

PRODUCTION SERIES:
3R1: INDUSTRIAL RJ45
MODULAR PLUG

CONTACT QUANTITY:
08: 8 PIN

PLATING SUFFIX
CE: UNDER Ni PLATING
CONTACT AREA: 1.27um GOLD MIN.
TERMINAL AREA: Sn

DESIGN REFERENCE	NEXT ASSEMBLY	REV	ECO	ISSUE DATE AND DESCRIPTION	DRFT	CHKD
				MAR 20, 2012		JNC ULAB
DESIGN CODE	DIVISION CODE	DATE	BY	ISSUE DATE AND DESCRIPTION	DATE	
		MAR 20, 2012	H. MATUSOKA	MAR 29, 2012		
<p>3M Interconnect Solutions DO NOT SCALE DRAWING</p> <p>THIRD ANGLE PROJECTION INTERPRET PER ASME Y14.5 - 1994</p> <p>UNLESS SURFACE FINISHES ARE SPECIFIED OTHERWISE, ALL DIMENSIONS ARE UNLESS OTHERWISE NOTED.</p> <p>UNLESS OTHERWISE SPECIFIED, DIMENSIONS ARE IN INCHES. TOLERANCES ARE AS NOTED.</p> <p>UNLESS OTHERWISE SPECIFIED, DIMENSIONS ARE IN MILLIMETERS. TOLERANCES ARE AS NOTED.</p> <p>UNLESS OTHERWISE SPECIFIED, DIMENSIONS ARE IN MILLIMETERS. TOLERANCES ARE AS NOTED.</p> <p>UNLESS OTHERWISE SPECIFIED, DIMENSIONS ARE IN MILLIMETERS. TOLERANCES ARE AS NOTED.</p>						
<p>TITLE: INDUSTRIAL RJ45 MODULAR PLUG, FOR CAT 5-e CABLE, IDC, WMT, TS-2515</p> <p>CAGE NUMBER: D78-5100-2515-4</p> <p>REV. 1</p> <p>MODEL: 01/13</p>						

X-ON Electronics

Largest Supplier of Electrical and Electronic Components

Click to view similar products for [Modular Connectors](#) / [Ethernet Connectors](#) category:

Click to view products by [3M](#) manufacturer:

Other Similar products are found below :

[RJE231881317T](#) [MP1010RX-1000](#) [MP44RX-1000](#) [GAX-3-66](#) [GAX-8-62](#) [93606-0253](#) [GD-A-44](#) [GDCX-PA-66-50](#) [GDCX-PN-64](#) [GDCX-PN-66](#) [GDCX-PN-66-50](#) [GDLX-A-66](#) [GDLX-A-88](#) [GDLX-N-66](#) [GDLX-S-88K](#) [GDTX-S-88-50](#) [GDX-PA-1010](#) [GLX-N-1010M-BLK](#) [GLX-N-44M](#) [GLX-S-88M-BLK](#) [GMX-N-1010](#) [GMX-S-1010](#) [GMX-S-66](#) [GMX-SMT2-N-1010](#) [GMX-SMT2-N-64-50](#) [GMX-SMT2-S6-88](#) [GMX-SMT4-N-88](#) [GPX-2-64](#) [GRT1-BT1-5](#) [GSGX-N-2-88](#) [GSX-NS2-88-3.05](#) [GSX-NS2-88-3.05-50](#) [GSX-NS-88-3.05-30](#) [GSX-NS-88-3.05-50](#) [GSX-NS-88-3.68](#) [1-1775629-2](#) [GWLX-S-88-GR](#) [GWLX-S9-88-YG](#) [1300500326](#) [1300500227](#) [1300530003](#) [1300570002](#) [1324640-4](#) [RJ11FTVC2G](#) [RJ11FTVC2N](#) [RJFTVX2SA1G](#) [132764-001](#) [1400000](#) [1413176](#) [1413235](#)