

## Features

- 1 & 2 Pole - Low profile (15.7 mm height)
- 41.31 - 1 Pole 12 A (3.5 mm pin pitch)
- 41.52 - 2 Pole 8 A (5 mm pin pitch)
- 41.61 - 1 Pole 16 A (5 mm pin pitch)

### PCB mount

- direct or via PCB socket
- 35 mm rail mount
- via screw and screwless sockets

- AC and DC coils
- 8 mm, 6 kV (1.2/50  $\mu$ s) isolation, coil-contacts
- Cadmium Free contact materials
- Flux proof: RT II standard, (RT III option)

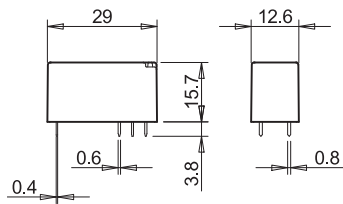

FOR UL RATINGS SEE:  
"General technical information" page V

## 41.31



- 3.5 mm contact pin pitch
- 1 Pole 12 A
- PCB direct or via socket

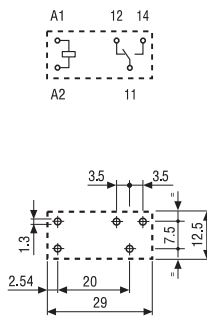

Copper side view

## 41.52



- 5 mm contact pin pitch
- 2 Pole 8 A
- PCB direct or via socket

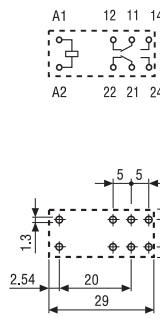

Copper side view

## 41.61



- 5 mm contact pin pitch
- 1 Pole 16 A
- PCB direct or via socket

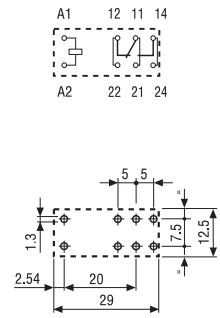

Copper side view

### Contact specification

Contact configuration	1 CO (SPDT)	2 CO (DPDT)	1 CO (SPDT)
Rated current/Maximum peak current A	12/25	8/15	16/30
Rated voltage/Maximum switching voltage V AC	250/400	250/400	250/400
Rated load AC1 VA	3,000	2,000	4,000
Rated load AC15 (230 V AC) VA	600	400	750
Single phase motor rating (230 V AC) kW	0.5	0.3	0.5
Breaking capacity DC1: 30/110/220 V A	12/0.3/0.12	8/0.3/0.12	16/0.3/0.12
Minimum switching load mW (V/mA)	300 (5/5)	300 (5/5)	300 (5/5)
Standard contact material	AgNi	AgNi	AgNi

### Coil specification

Nominal voltage (U <sub>N</sub> )	V AC (50/60 Hz)	24 - 115 - 230	24 - 115 - 230	24 - 115 - 230
	V DC	5 - 6 - 12 - 24 - 48 - 60 - 110	5 - 6 - 12 - 24 - 48 - 60 - 110	5 - 6 - 12 - 24 - 48 - 60 - 110
Rated power AC/DC	VA (50 Hz)/W	0.75/0.4	0.75/0.4	0.75/0.4
Operating range	AC	(0.8...1.1)U <sub>N</sub>	(0.8...1.1)U <sub>N</sub>	(0.8...1.1)U <sub>N</sub>
	DC	(0.7...1.5)U <sub>N</sub>	(0.7...1.5)U <sub>N</sub>	(0.7...1.5)U <sub>N</sub>
Holding voltage	AC/DC	0.8/0.4U <sub>N</sub>	0.8/0.4 U <sub>N</sub>	0.8/0.4 U <sub>N</sub>
Must drop-out voltage	AC/DC	0.15/0.1U <sub>N</sub>	0.15/0.1 U <sub>N</sub>	0.15/0.1 U <sub>N</sub>

### Technical data

Mechanical life AC/DC	cycles	10·10 <sup>6</sup> /10·10 <sup>6</sup>	10·10 <sup>6</sup> /10·10 <sup>6</sup>	10·10 <sup>6</sup> /10·10 <sup>6</sup>
Electrical life at rated load AC1	cycles	60 · 10 <sup>3</sup>	60 · 10 <sup>3</sup>	50 · 10 <sup>3</sup>
Operate/release time	ms	8/6	8/6	8/6
Insulation between coil and contacts (1.2/50 $\mu$ s)	kV	6 (8 mm)	6 (8 mm)	6 (8 mm)
Dielectric strength between open contacts	V AC	1,000	1,000	1,000
Ambient temperature range	°C	-40...+70 (AC); +85 (DC)	-40...+70 (AC); +85 (DC)	-40...+70 (AC); +85 (DC)
Environmental protection		RT II	RT II	RT II

### Approvals (according to type)



# 41 Series - Bistable low profile PCB relays 8 - 16 A

## Features

- 1 & 2 Pole - Polarized bistable, Low profile (15.7 mm height)
- 41.52 - 2 Pole 8 A (5 mm pin pitch)
- 41.61 - 1 Pole 16 A (5 mm pin pitch)

### Printed Circuit mount

- Polarized bistable relay with 2 coils
- 10 mm, 6 kV (1.2/50µs) isolation, coil-contacts
- Cadmium Free contact materials
- Flux proof: RT II standard

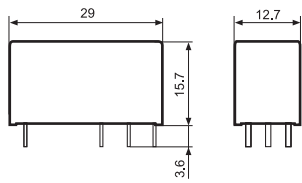

### 41.52.6.xxx



- 2 Pole, 8 A
- PCB direct mount

### 41.61.6.xxx



- 1 Pole, 16 A
- PCB direct mount

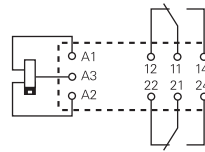

2 coil version:  
A3(+) A2 (-) = Set  
A3(+) A1 (-) = Reset

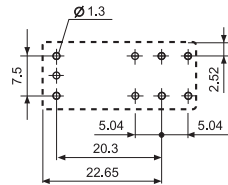

Copper side view

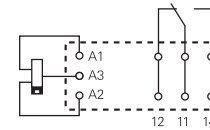

2 coil version:  
A3(+) A2 (-) = Set  
A3(+) A1 (-) = Reset

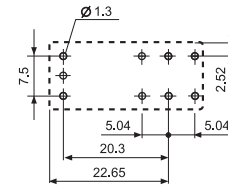

Copper side view

Contact specification			
Contact configuration		2 CO (DPDT)	1 CO (SPDT)
Rated current/Maximum peak current ( $I_N/I_{max}$ ) A		8 / 15	16 / 30
Rated voltage/Maximum switching voltage ( $U_N/U_{max}$ ) V AC		250 / 400	250 / 400
Rated load AC1 VA		2,000	4,000
Rated load AC15 (230 V AC) VA		350	750
Single phase motor rating (230 V AC) kW		0.37	0.55
Breaking capacity DC1: 30/110/220 V A		8/0.3/0.12	16/0.3/0.12
Minimum switching load mW (V/mA)		500 (5/100)	500 (5/100)
Standard contact material		AgSnO <sub>2</sub>	AgSnO <sub>2</sub>
Coil specification			
Nominal voltage ( $U_N$ ) V DC		5 - 12 - 24	5 - 12 - 24
Rated power ( $P_N$ ) W		0.65	0.65
Operating range DC		(0.7 ... 1.1)U <sub>N</sub>	(0.7 ... 1.1)U <sub>N</sub>
Min. impulse duration ms		20	20
Max. impulse duration s		30	30
Technical data			
Mechanical life DC cycles		5 · 10 <sup>6</sup>	5 · 10 <sup>6</sup>
Electrical life at rated load AC1 cycles		30 · 10 <sup>3</sup>	30 · 10 <sup>3</sup>
Operate/release time ms		10 / 5	10 / 10
Insulation between coil and contacts (1.2/50 µs) kV		6 (10 mm)	6 (10 mm)
Dielectric strength between open contacts V AC		1,000	1,000
Ambient temperature range °C		-40...+85	-40...+85
Environmental protection		RT II	RT II

Approvals (according to type) —

## Features

### Solid State Relays

#### Printed circuit mount:

- direct or via PCB socket

#### 35 mm rail mount:

- via screw or screwless sockets

- Single circuit output switching options
  - 5 A 24 V DC
  - 3 A 240 V AC
- Silent, high speed switching with long electrical life
- LED indicator
- Low profile (15.7 mm)
- Wash tight: RT III
- 2,500 V AC insulation, input-output

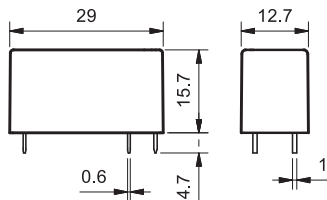

### 41.81 - 9024



- 5 A, 24 V DC output switching
- PCB or 93 Series sockets

### 41.81 - 8240



- 3 A, 240 V AC output switching
- Zero crossing switching
- PCB or 93 Series sockets

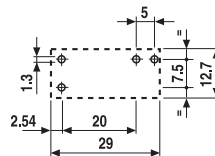
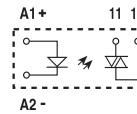
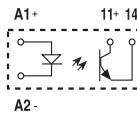

Copper side view

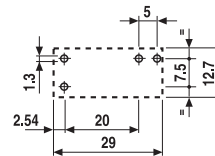

Copper side view

Output circuit					
Contact configuration		1 NO (SPST-NO)		1 NO (SPST-NO)	
Rated current/Maximum peak current (10 ms) A		5/40		3/40	
Rated voltage/Maximum blocking voltage V		(24/35)DC		(240/-)AC	
Switching voltage range V		(1.5...24)DC		(12...275)AC	
Repetitive peak off-state voltage $V_{pk}$		-		600	
Minimum switching current mA		1		50	
Max. "OFF-state" leakage current mA		0.01		1	
Max. "ON-state" voltage drop V		0.3		1.1	
Input circuit					
Nominal voltage V DC		12	24	12	24
Operating range V DC		8...17	14...32	8...17	14...32
Control current mA		5.5	9	8.8	9
Release voltage V DC		4	9	4	9
Impedance $\Omega$		1,550	2,600	1,030	2,600
Technical data					
Operate/release time ms		0.05/0.25		10/10	
Dielectric strength between input/output V AC		2,500		2,500	
Ambient temperature range $^{\circ}\text{C}$		-20...+60		-20...+60	
Environmental protection		RT III		RT III	
Approvals (according to type)					

Ordering information

**Electromechanical relay (EMR)**

Example: 41 series low-profile PCB relay, 2 CO (DPDT), 24 V DC coil.

A

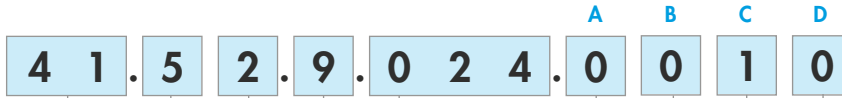

- Series** —————
- Type** —————  
3 = PCB - 3.5 mm pinning  
5 = PCB - 5 mm pinning  
6 = PCB - 5 mm pinning
- No. of poles** —————  
1 = 1 pole for  
    41.31, 12 A  
    41.61, 16 A  
2 = 2 pole for  
    41.52, 8 A
- Coil version** —————  
6 = DC bistable, 2 coils  
8 = AC  
9 = DC
- Coil voltage** —————  
See coil specifications

- A: Contact material**  
0 = Standard AgNi  
4 = AgSnO<sub>2</sub>  
5 = AgNi + Au
- B: Contact circuit**  
0 = CO (nPDT)  
3 = NO (nPST)

- D: Special versions**  
0 = Flux proof (RT II)  
1 = Wash tight (RT III)  
6 = Bistable version (RT II)
- C: Options**  
0 = Production line 0  
1 = Production line 1

**Selecting features and options: only combinations in the same row are possible.**  
Preferred selections for best availability are shown in **bold**.

Type	Coil version	A	B	C	D
41.31	DC	<b>0</b> - 4 - 5	<b>0</b> - 3	<b>1</b>	<b>0</b> - 1
41.52	DC	<b>0</b> - 5	<b>0</b> - 3	<b>1</b>	<b>0</b> - 1
41.61	DC	<b>0</b> - 4	<b>0</b> - 3	<b>1</b>	<b>0</b> - 1
41.31/52/61	AC	<b>0</b>	<b>0</b>	<b>0</b>	<b>0</b>
41.52	DC bistable	4	<b>0</b>	<b>1</b>	<b>6</b>
41.61	DC bistable	4	<b>0</b> - 3	<b>1</b>	<b>6</b>

**Solid state relay (SSR)**

Example: 41 series SSR relay, 5 A output, 24 V DC supply.



- Series** —————
- Type** —————  
8 = SSR type
- Output** —————  
1 = 1 NO (SPST-NO)
- Input circuit** —————  
See input specifications

- Output circuit**  
9024 = 5 A - 24 V DC  
8240 = 3 A - 240 V AC

## Electromechanical relay

### Technical data

#### Insulation according to EN 61810-1

		1 pole		1 pole bistable	2 pole		2 pole bistable
Nominal voltage of supply system	V AC	230/400		230/400	230/400		230/400
Rated insulation voltage	V AC	250	400	250	250	400	250
Pollution degree		3	2	2	3	2	2
<b>Insulation between coil and contact set</b>							
Type of insulation		Reinforced (8 mm)		Reinforced (10 mm)	Reinforced (8 mm)		Reinforced (10 mm)
Overvoltage category		III		III	III		III
Rated impulse voltage	kV (1.2/50 µs)	6		6	6		6
Dielectric strength	V AC	4,000		4,000	4,000		4,000
<b>Insulation between adjacent contacts</b>							
Type of insulation		—		—	Basic		Basic
Overvoltage category		—		—	III		III
Rated impulse voltage	kV (1.2/50 µs)	—		—	4		4
Dielectric strength	V AC	—		—	2,000		2,000
<b>Insulation between open contacts</b>							
Type of disconnection		Micro-disconnection			Micro-disconnection		
Dielectric strength	V AC/kV (1.2/50 µs)	1,000/1.5			1,000/1.5		
<b>Conducted disturbance immunity</b>							
Burst (5...50)ns, 5 kHz, on A1 - A2		EN 61000-4-4			level 4 (4 kV)		
Surge (1.2/50 µs) on A1 - A2 (differential mode)		EN 61000-4-5			level 3 (2 kV)		
<b>Other data</b>							
Bounce time: NO/NC	ms	4/6 (monostable) - 2/10 (bistable)					
Vibration resistance (5...55)Hz: NO/NC	g	15/2 (monostable) - 5/3 (bistable)					
Shock resistance	g	16 (monostable) - 10 (bistable)					
Power lost to the environment	without contact current	W	0.4 (monostable)				
	with rated current	W	1.7 (41.31)	1.2 (41.52)		1.8 (41.61)	
Recommended distance between relays mounted on PCB	mm	≥ 5					

A

Contact specification

F 41 - Electrical life (AC) v contact current (monostable)  
Types 41.31/61

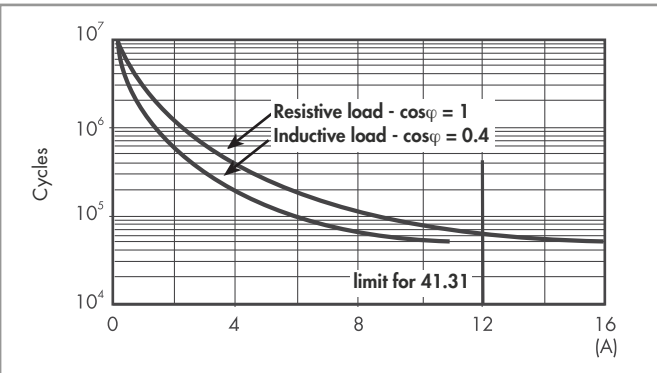

F 41 - Electrical life (AC) v contact current (bistable)

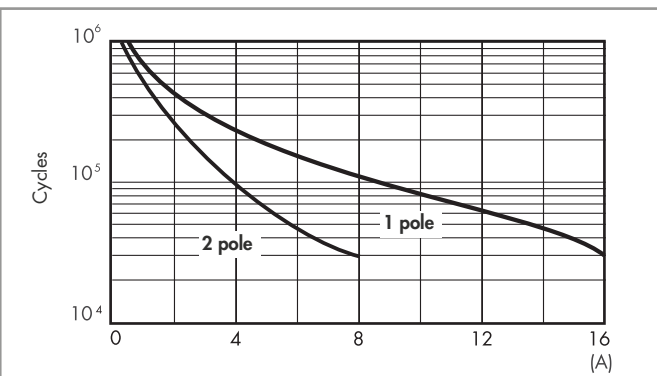

F 41 - Electrical life (AC) v contact current (monostable)  
Type 41.52

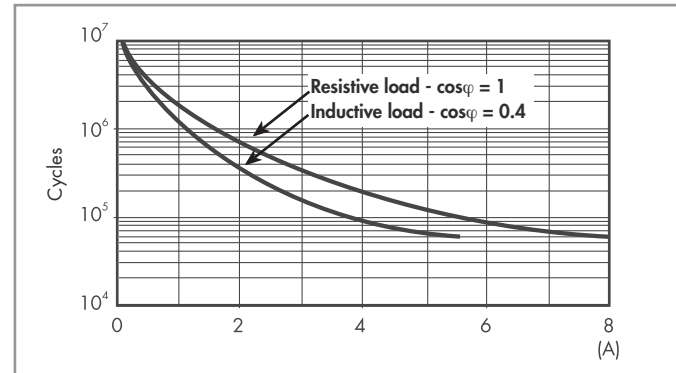

H 41- Maximum DC1 breaking capacity

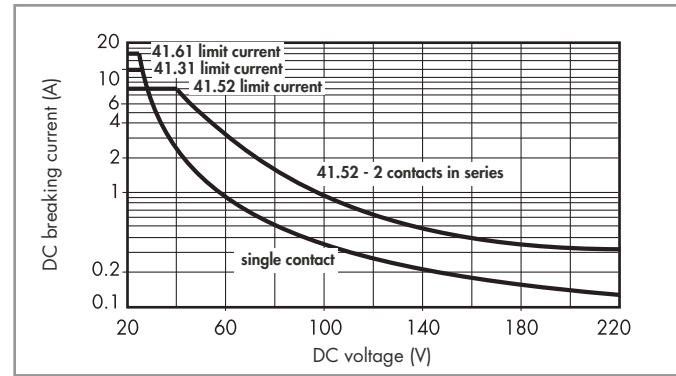

- When switching a resistive load (DC1) having voltage and current values under the curve, an electrical life of  $\geq 100 \cdot 10^3$  can be expected.
- In the case of DC13 loads, the connection of a diode in parallel with the load will permit a similar electrical life as for a DC1 load. Note: the release time for the load will be increased.

Coil specifications

AC coil data

Nominal voltage $U_N$ V	Coil code	Operating range		Resistance R $\Omega$	Rated coil consumption I at $U_N$ mA
		$U_{min}$ V	$U_{max}$ V		
24	8.024	19.2	26.4	350	31.6
115	8.115	92	126.5	8,100	6
230	8.230	184	253	32,500	3.2

DC coil data

Nominal voltage $U_N$ V	Coil code	Operating range		Resistance R $\Omega$	Rated coil consumption I at $U_N$ mA
		$U_{min}$ V	$U_{max}$ V		
5	9.005	3.5	7.5	62	80
6	9.006	4.2	9	90	66.7
12	9.012	8.4	18	360	33.3
24	9.024	16.8	36	1,440	16.7
48	9.048	33.6	72	5,760	8.3
60	9.060	42	90	9,000	6.6
110	9.110	77	165	24,200	4.5

DC coil data (bistable)

Nominal voltage $U_N$ V	Coil code	Operating range			Resistance R $\Omega$	Rated coil power mW
		Set $U_{min}$ V	Reset $U_{min}$ V	Set/Reset $U_{max}$ V		
5	6.005	3.5	3.5	5.5	38	650
12	6.012	8.4	8.4	13.2	220	650
24	6.024	16.8	16.8	26.4	885	650

R 41 - AC coil operating range v ambient temperature

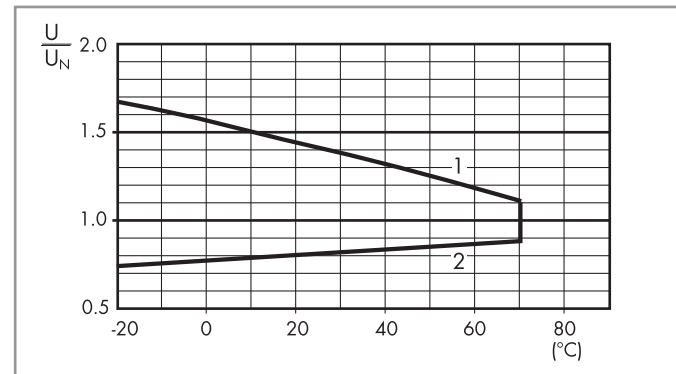

- 1 - Max. permitted coil voltage.
- 2 - Min. pick-up voltage with coil at ambient temperature.

R 41 - DC coil operating range v ambient temperature

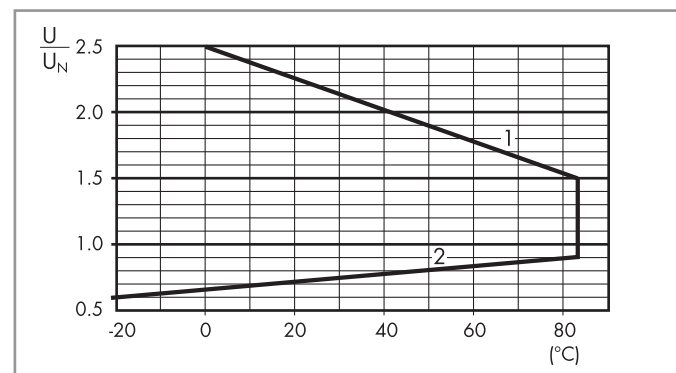

- 1 - Max. permitted coil voltage.
- 2 - Min. pick-up voltage with coil at ambient temperature.

Solid state relay

**Technical data**

Other data			41.81 - 9024	41.81 - 8240
Power lost to the environment	without current	W	0.25	0.25
	with maximum current	W	1.75	3.5

**Input specification**

**Input data - DC types**

Nominal voltage $U_N$	Input code	Operating range		Release voltage	Impedance	Control current I at $U_N$
		$U_{min}$	$U_{max}$			
V		V	V	V	$\Omega$	mA
12	7.012	8	17	4	1,550	5.5
24	7.024	14	32	9	2,600	9

**Output specification**

**L 41 - Output current v ambient temperature**  
SSR - 5 A DC output types

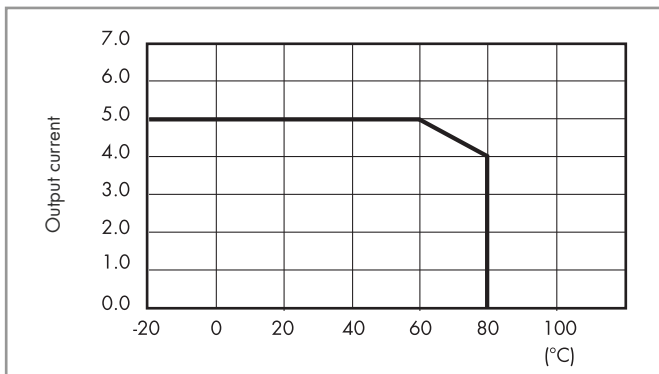

**L 41 - Output current v ambient temperature**  
SSR - 3 A AC output types

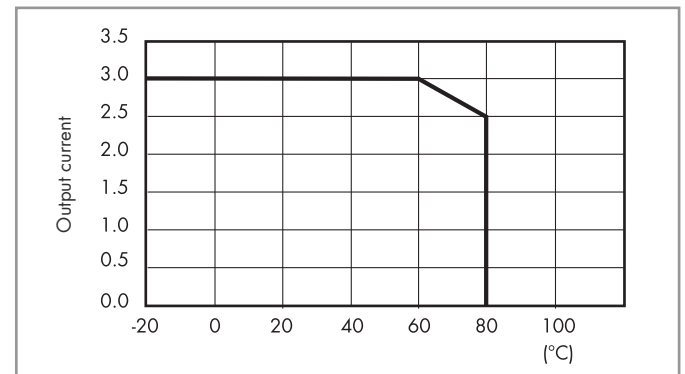

A

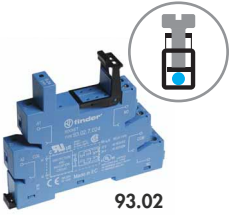

93.02

Approvals  
(according to type):



**Screw terminal socket 35 mm (EN 60715) mounting**

Supply voltage	Relay type	Socket type
6 V AC/DC	41.52.9.005.0010 or 41.61.9.005.0010	93.02.0.024
12 V AC/DC	41.52.9.012.0010 or 41.61.9.012.0010	93.02.0.024
24 V AC/DC	41.52/61.9.024.0010 or 41.81.7.024.xxxx	93.02.0.024
60 V AC/DC	41.52.9.060.0010 or 41.61.9.060.0010	93.02.0.060
(110...125)V AC/DC	41.52.9.110.0010 or 41.61.9.110.0010	93.02.0.125
(220...240)V AC/DC	41.52.9.110.0010 or 41.61.9.110.0010	93.02.0.240
(230...240)V AC	41.52.9.110.0010 or 41.61.9.110.0010	93.02.8.230
6 V DC	41.52.9.005.0010 or 41.61.9.005.0010	93.02.7.024
12 V DC	41.52/61.9.012.0010 or 41.81.7.012.xxxx	93.02.7.024
24 V DC	41.52/61.9.024.0010 or 41.81.7.024.xxxx	93.02.7.024
48 V DC	41.52.9.048.0010 or 41.61.9.048.0010	93.02.7.060
60 V DC	41.52.9.060.0010 or 41.61.9.060.0010	93.02.7.060

Accessories	
8-way jumper link	093.08 (see specification next page)
Plastic separator	093.01 (see specification next page)
Sheet of marker tags, 72 tags	060.72 (see specification next page)

Technical data			
Rated values	10 A - 250 V		
Dielectric strength	6 kV (1.2/50 μs) between coil and contacts		
Protection category	IP 20		
Ambient temperature (U <sub>N</sub> ≤ 60 V / > 60 V) °C	-40...+70 / -40...+55		
⊕ Screw torque	Nm 0.5		
Wire strip length	mm 8		
Max. wire size for 93.02 socket	solid wire	stranded wire	
	mm <sup>2</sup>	1x6 / 2x2.5	1x4 / 2x2.5
	AWG	1x10 / 2x14	1x12 / 2x14

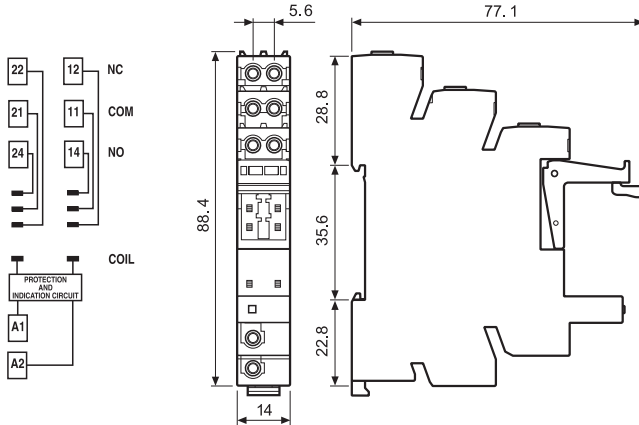

Note: Not for bistable relays



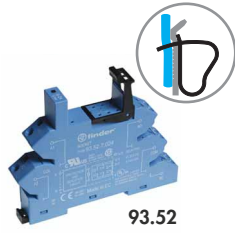

93.52

Approvals (according to type):

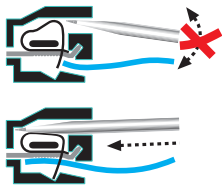
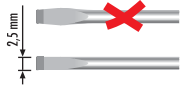

**Screwless terminal socket 35 mm (EN 60715) mounting**

Supply voltage	Relay type	Socket type
6 V AC/DC	41.52.9.005.0010 or 41.61.9.005.0010	93.52.0.024
12 V AC/DC	41.52.9.012.0010 or 41.61.9.012.0010	93.52.0.024
24 V AC/DC	41.52/61.9.024.0010 or 41.81.7.024.xxxx	93.52.0.024
60 V AC/DC	41.52.9.060.0010 or 41.61.9.060.0010	93.52.0.060
(110...125)V AC/DC	41.52.9.110.0010 or 41.61.9.110.0010	93.52.0.125
(220...240)V AC/DC	41.52.9.110.0010 or 41.61.9.110.0010	93.52.0.240
(230...240)V AC	41.52.9.110.0010 or 41.61.9.110.0010	93.52.8.230
6 V DC	41.52.9.005.0010 or 41.61.9.005.0010	93.52.7.024
12 V DC	41.52/61.9.012.0010 or 41.81.7.012.xxxx	93.52.7.024
24 V DC	41.52/61.9.024.0010 or 41.81.7.024.xxxx	93.52.7.024
48 V DC	41.52.9.048.0010 or 41.61.9.048.0010	93.52.7.060
60 V DC	41.52.9.060.0010 or 41.61.9.060.0010	93.52.7.060

**Accessories**

8-way jumper link	093.08 (see table below)
Plastic separator	093.01 (see table below)
Sheet of marker tags, 72 tags	060.72 (see table below)

**Technical data**

Rated values	10 A - 250 V		
Dielectric strength	6 kV (1.2/50 μs) between coil and contacts		
Protection category	IP 20		
Ambient temperature (U <sub>N</sub> ≤ 60 V / > 60 V) °C	-40...+70 / -40...+55		
Wire strip length	mm	8	
Max. wire size for 93.52 socket	solid wire	stranded wire	
	mm <sup>2</sup>	1x2.5	1x2.5
	AWG	1x14	1x14

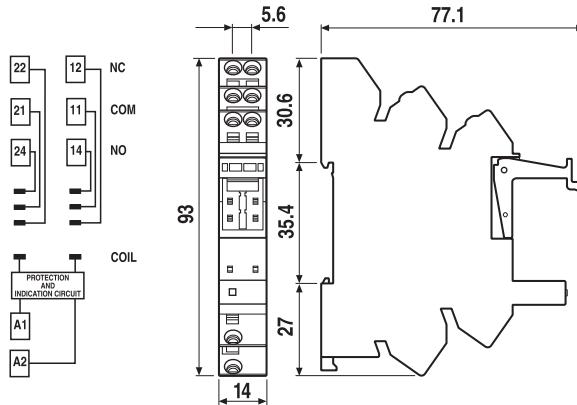

Note: Not for bistable relays

**Accessories**

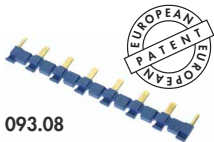

093.08

Approvals (according to type):



<b>8-way jumper link</b> for 93.02 and 93.52 sockets	093.08 (blue)	093.08.0 (black)	093.08.1 (red)
Rated values	10 A - 250 V		

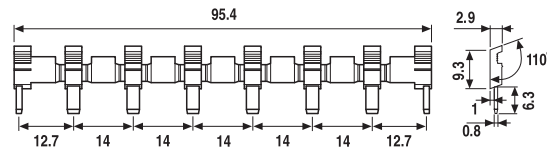

<b>Plastic separator</b> for 93.02 and 93.52 sockets	093.01
--	--------

Thickness 2 mm, required at the start and the end of a group of interfaces.

Can be used for visual separation group, must be used for:

- protective separation of different voltages of neighbouring PLC interfaces according to VDE 0106-101
- protection of cut jumper links



093.01

<b>Sheet of marker tags</b> for 38.x2, plastic, 72 tags, 6x12 mm	060.72
--	--------

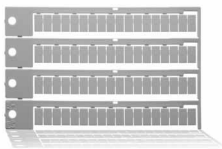

060.72

A



95.13.2



95.15.2

Approvals  
(according to type):



PCB socket	95.13.2 (blue)	95.13.20 (black)	95.15.2 (blue)	95.15.20 (black)
For relay type	41.31		41.52, 41.61, 41.81 <sup>(1)</sup>	
<b>Accessories</b>				
Plastic retaining clip	095.42			
<b>Technical data</b>				
Rated values	10 A - 250 V *			
Dielectric strength	6 kV (1.2/50 µs) between coil and contacts			
Protection category	IP 20			
Ambient temperature	°C -40...+70			

\* For currents >10 A, contact terminals must be connected in parallel (21 with 11, 24 with 14, 22 with 12).

<sup>(1)</sup> With the relay 41.81 the NO change-over contact will be 11-14.

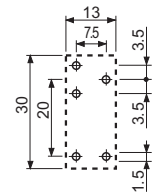
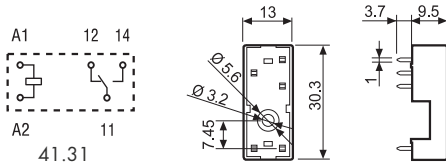

95.13.2

Copper side view

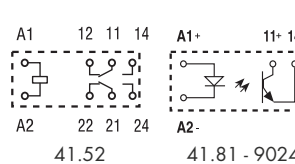

41.52

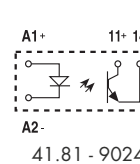

41.81 - 9024

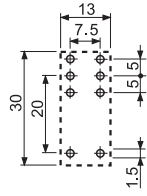
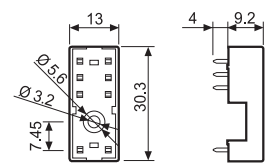

95.15.2

Copper side view

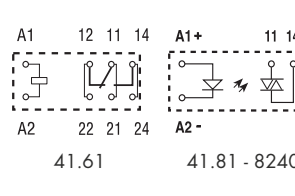

41.61

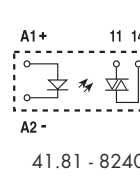

41.81 - 8240

Note: Not for bistable relays

### Packaging codes

How to code and identify retaining clip and packaging options for sockets.

Example:

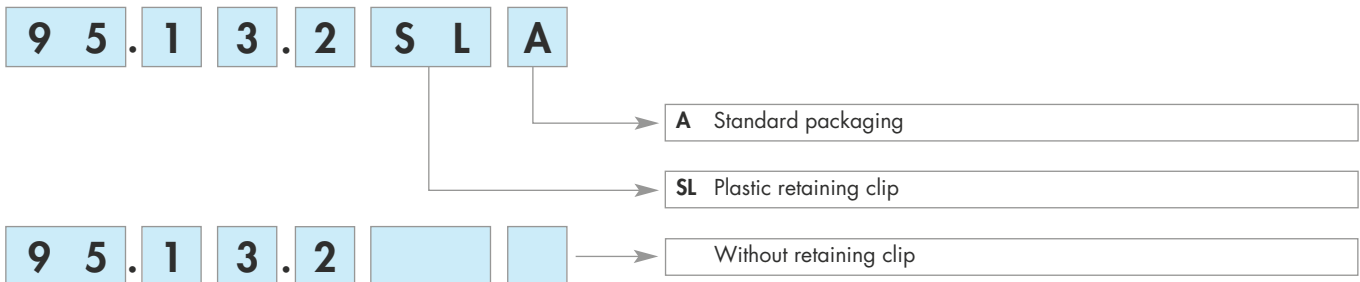

## X-ON Electronics

Largest Supplier of Electrical and Electronic Components

*Click to view similar products for [General Purpose Relays](#) category:*

*Click to view products by [Finder](#) manufacturer:*

Other Similar products are found below :

[APF30318](#) [JVN1AF-4.5V-F](#) [PCN-105D3MHZ](#) [5JO-10000S-SIL](#) [5JO-1000CD-SIL](#) [5JO-400CD-SIL](#) [LY2S-AC220/240](#) [LYQ20DC12](#)  
[6031007G](#) [6131406HQ](#) [6-1393099-3](#) [6-1393099-8](#) [6-1393122-4](#) [6-1393123-2](#) [6-1393767-1](#) [6-1393843-7](#) [6-1415012-1](#) [6-1419102-2](#) [6-](#)  
[1423698-4](#) [6-1608051-6](#) [6-1608067-0](#) [6-1616170-6](#) [6-1616248-2](#) [6-1616282-3](#) [6-1616348-2](#) [6-1616350-1](#) [6-1616350-8](#) [6-1616358-7](#) [6-](#)  
[1616359-9](#) [6-1616360-9](#) [6-1616931-6](#) [6-1617039-1](#) [6-1617052-1](#) [6-1617090-2](#) [6-1617090-5](#) [6-1617347-5](#) [6-1617353-3](#) [6-1617801-8](#) [6-](#)  
[1617802-2](#) [6-1618107-9](#) [6-1618248-4](#) [M83536/1-027M](#) [CX-4014](#) [MAHC-5494](#) [MAVCD-5419-6](#) [703XCX-120A](#) [7-1393100-5](#) [7-1393111-7](#)  
[7-1393144-5](#) [7-1393767-8](#)