

(2,54mm) .100"

CLH SERIES

CLH-108-F-D-DV-P



CLH-120-F-D-BE



CLH-110-F-D-DV



SMT LOW PROFILE SOCKET

SPECIFICATIONS

For complete specifications and recommended PCB layouts see www.samtec.com?CLH

Insulator Material:

Black Liquid Crystal Polymer



Contact Material:

Phosphor Bronze

Operating Temp Range:

-65°C to +125°C with Gold

-65°C to +105°C with Tin

Plating:

Au or Sn over

50µ" (1,27µm) Ni

Contact Resistance:

10 mΩ max

Insertion Depth:

(2,67mm) .105" to

(3,43mm) .135"

plug from top, (3,18mm) .125"

min plus board thickness plug

Insertion Force:

4.0oz (1,11N) average

Normal Force:

50 grams (0,48N)

Withdrawal Force:

1.1oz (0,31N) average

Max Cycles:

100 with 10µ" (0,25µm) Au

RoHS Compliant:

Yes

Processing:

Lead-Free Solderable:

Yes

SMT Lead Coplanarity:

(0,10mm) .004" max

CLH

1

NO. PINS PER ROW

PLATING OPTION

D

ENTRY OPTION

OTHER OPTION

Mates with:
TSW, MTSW, HW, DW,
EW, ZW, TLW, TSM,
MTLW

-DV
= Top Entry

-BE
= Bottom Entry

-K
= (6,50mm) .256"
DIA Polyimide film
Pick & Place Pad
(3 positions min.)

-P
= Pick & Place Pad
(3 positions minimum)

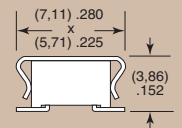

Not always necessary for auto placement. Call Samtec.

-F
= Pre-plated Gold flash on contact,
75µ" (1,91µm) Matte Tin on tail

-L
= Pre-plated 10µ" (0,25µm)
Gold on contact,
75µ" (1,91µm) Matte Tin on tail

Note: Other Gold plating options available. Contact Samtec.

-A
= Alignment Pin
(4 positions minimum)

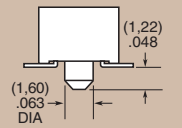

-LC
= Locking Clip

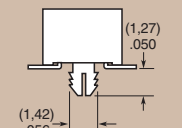

-TR
= Tape & Reel Packaging
(29 positions maximum)

02 thru 50

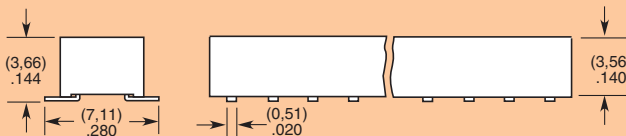
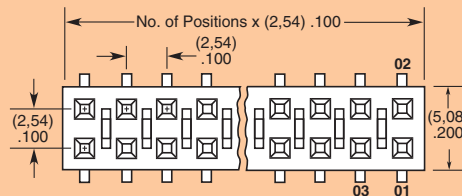

TAPE & REEL AVAILABILITY
No tooling charges.
Minimum order is the lesser of a full reel quantity or 125 pieces.
Order any quantity above minimum.
In-house design, manufacture.
Quick turn-around.
Call Samtec for specifications and ordering information.

Note: Some lengths, styles and options are non-standard, non-returnable.

Due to technical progress, all designs, specifications and components are subject to change without notice.

WWW.SAMTEC.COM

X-ON Electronics

Largest Supplier of Electrical and Electronic Components

Click to view similar products for [FFC & FPC Connectors](#) category:

Click to view products by [Samtec](#) manufacturer:

Other Similar products are found below :

[HFW11R-1STE1H1LF](#) [FH29B-100S-0.2SHW\(99\)](#) [FA5S008HP1](#) [FH29B-120S-0.2SHW\(99\)](#) [FH29B-80S-0.2SHW\(99\)](#) [FHS-16](#) [FPH-2022G](#)
[52610-1075](#) [52610-1275](#) [52610-1934](#) [XF3M\(1\)-1415-1B-R100](#) [501864-3091-TR225](#) [0525594033](#) [086210010340800](#) [086222026001800](#)
[52271-2869-CUT-TAPE](#) [62674-201121DLF](#) [62684-36210E9ALF](#) [52610-1675](#) [52746-1671-TR250](#) [10051922-2810EHLF](#) [6-520415-9](#)
[BD021-09A-A1-0350-0200-0550-LD](#) [SFV6R-1STE9HLF](#) [XF3M-2915-1B-R100](#) [1658549-1](#) [62674-221121ALF](#) [46214008010800](#)
[046298003000883](#) [151660622](#) [842-816-2630-035](#) [AYF530665TA](#) [AYF351525](#) [046296011930846+](#) [AYF352325A](#) [046254020000800+](#)
[FH19C-13S-0.5SH\(99\)](#) [FH39J-51S-0.3SHW\(99\)](#) [AYF355125A](#) [AYF530365TA](#) [FH29B-44S-0.2SHW\(99\)](#) [SFW5R-2STAE9LF](#) [AYF351125A](#)
[AYF350725A](#) [62684-502100AHLF](#) [FH39-61S-0.3SHW\(99\)](#) [AYF414035A](#) [10064555-172520HLF](#) [AYF212335A](#) [504754-2500](#)