

This Drawing is the property of J.S.T.(U.K.) Ltd.
It must not be copied or used for manufacturing
without written permission from J.S.T.(U.K.) Ltd.

**UNCONTROLLED
CUSTOMER ISSUE**

Page 1 / 2

CS-48N003V0	48N003V0	PA66	UL94V-0	Natural	110	--	
4803-187 Red	48N303	PA66	UL94V-2	Red	110	E172855 (M)	
4803-187 Green	48N403	PA66	UL94V-2	Green	110	E172855 (M)	
4803-187 Black	48N503	PA66	UL94V-2	Black	110	E172855 (M)	
4803-187	48N003	PA66	UL94V-2	Natural	110	E172855 (M)	
JST Part Number	Mfg Number	Material	Flame Class	Colour	Max Operating Temp (°C)	UL Card No.	//

Revision Record		
	Add suffixes; 003V0	16.12.02
	Add suffixes; 003, 503, 403 & 303	16.12.02
	Modification Detail	Date
<i>JST</i>		

Part Description & General Details:		
Housing for 4.8 (.187) receptacle. Applicable JST terminal; STO-**(*)-187*(-*) Not suitable for STO-62(*)-187*(-*)		
Series:	48 Series	
Drawing Ref:	CS48N003-040794	
Issues by:	MR	16.12.02
Approved by:	AR	17.12.02

This Drawing is the property of J.S.T.(U.K.) Ltd.
It must not be copied or used for manufacturing
without written permission from J.S.T.(U.K.) Ltd.

**UNCONTROLLED
CUSTOMER ISSUE**

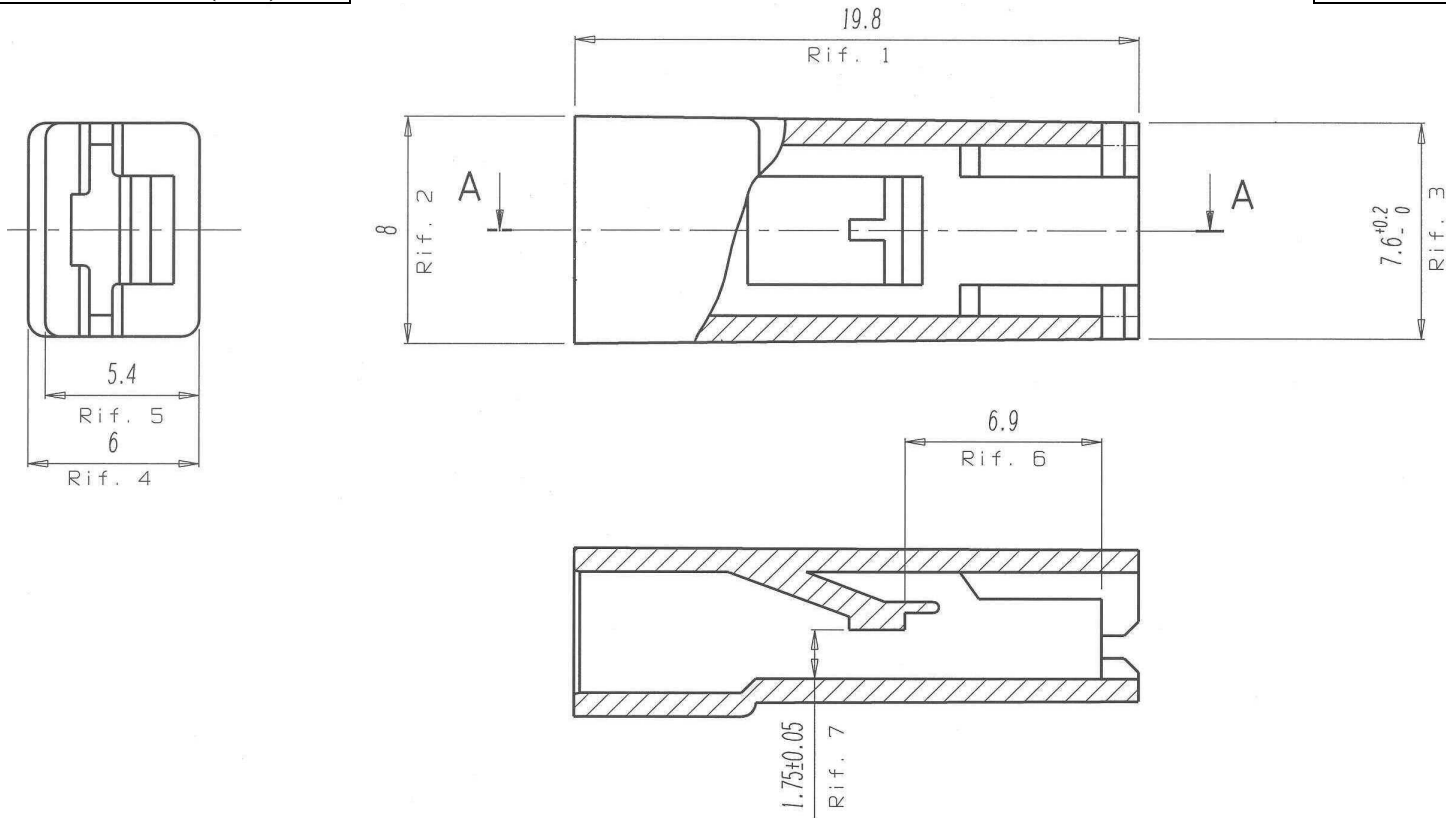

Revision Record		
	Add suffixes; 003, 503, 403 & 303	16.12.02
	Modification Detail	Date

JST

Part Description & General Details:		
Housing for 4.8 (.187) receptacle. Applicable JST terminal; STO-**(*)-187*(-*) Not suitable for STO-62(*)-187*(-*)		
Series:	48 Series	
Drawing Ref:	CS48N003-040794	
Issues by:	MR	16.12.02
Approved by:	AR	17.12.02

X-ON Electronics

Largest Supplier of Electrical and Electronic Components

Click to view similar products for [jst manufacturer](#):

Other Similar products are found below :

[GS3-0.5](#) [GS8-6](#) [B08B-JWPF-SK-R](#) [B3PS-VH](#) [B5B-XH-A](#) [B5P-VH](#) [B7B-XH-A](#) [B8B-PH-SM4-TB](#) [FVGS5-6](#) [B34B-PHDSS-B\(LF\)\(SN\)](#)
[B3B-ZR-SM4-TF](#) [B4B-PH-SM4-TB](#) [B4PS-VH](#) [B6B-PH-SM4-TB](#) [B6B-XH-A](#) [B8B-PH-K-S](#) [IDH-KR-12](#) [10HR-4K](#) [WC-ZE2426](#) [WC-691](#)
[WC-122](#) [FVDDF5.5-375A \(LF\)](#) [FVGS12-6 \(LF\)](#) [FVWS2-S3.3 \(LF\)](#) [FVWS5.5-5 \(LF\)](#) [B6PS-VH\(LF\)\(SN\)](#) [FNGS12-6](#) [TWE0.5-8](#) [FVGS4-1](#)
[\(LF\)](#) [HILR-06VF-1-S](#) [WC-GVH2630](#) [WC-PUD2](#) [S10B-PH-SM4-TB\(LF\)\(SN\)](#) [B4B-EH-A-TW \(LF\)\(SN\)](#) [B4B-XH-TW \(LF\)\(SN\)](#) [B5B-PH-](#)
[TW-S \(LF\)\(SN\)](#) [B8B-PH-TW-S \(LF\)\(SN\)](#) [B9B-XH-A](#) [BM02B-GHS-TBT](#) [BM03B-GHS-TBT](#) [BM04B-GHS-TBT](#) [BM06B-GHS-TBT](#)
[BM10B-GHS-TBT](#) [10FPZ-SM-TF\(LF\)\(SN\)](#) [YRS-852](#) [B04B-VYHSK-M-1](#) [B4B-PH-SM4-GW-TB](#) [B2B-ZR-SM4-TFT\(LF\)\(SN\)](#) [S24B-](#)
[PADSS-1\(LF\)\(SN\)](#) [WC-SH2832](#)