

3M™ Scotchlok™ Copper/ Aluminum Compression Lugs, 40000 Series

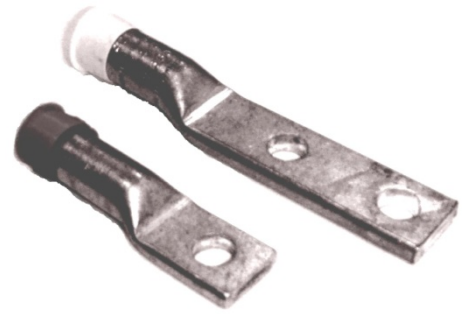

Data Sheet

October 2015

Description

3M Scotchlok Copper/Aluminum Compression Lugs 40000 Series are made of high conductivity aluminum and are designed to cover a wide range of conductor sizes from 6 AWG through 1000 kcmil (MCM). The lugs consist of a series of one-hole lugs ranging from 6 AWG through 1000 kcmil (MCM) and two-hole lugs, for increased secureness requirements, ranging from 1/0 AWG through 1000 kcmil (MCM). They are designed to terminate either aluminum or copper conductors. Each lug is electro-tin plated to resist electrolytic corrosion. They are installed using standard industry tooling. Chamfered ends ensure simplicity and ease of conductor insertion.

Agency Approvals

UL Listed, UL Standard 486A-486B, File No. E23438

Features

- Simple installation using readily available tools
- Manufactured using high conductivity aluminum
- Color coded end caps for easy lug identification
- Antioxidant material (compatible with all solid insulations) inside lug barrel to facilitate clean conductor to lug contact

Applications

- Termination of aluminum or copper conductor sizes as follows;
 - One-Hole Lugs: 6 AWG - 1000 kcmil (MCM)
 - Two-Hole Lugs: 1/0 AWG - 1000 kcmil (MCM)
- For low and medium voltage up to 35 kV
- For indoor and outdoor use

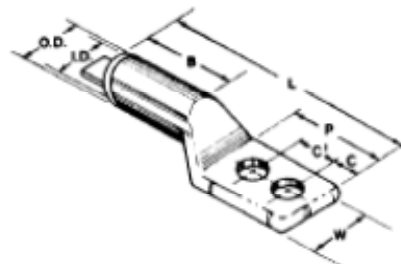
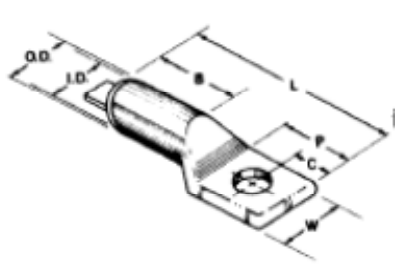

3M™ Scotchlok™ Copper/Aluminum Compression Lugs, 40000 Series

One-Hole Lug Dimensions and Selection Guide [Dimensions in Inches and (Millimeters)]

3M™ Scotchlok™ Lug Number	Conductor Size AWG or kcmil (MCM)	Stud Size	Color Code	I.D., +/- .010"	O.D., +/- .010"	L, Length, +/- .125"	B, Barrel Length, Min.	P, Pad Length, Min.	W, Pad Width, +/- .060"	C, Center of Hole-to-End of Pad, +/- .031"
40016	6 AWG	5/16	Gray	.200 (5,1)	.344 (8,8)	2.281 (57,9)	.750 (19,1)	.875 (22,2)	.562 (14,3)	.437 (11,1)
40020	4 AWG	5/16	Green	.265 (6,7)	.468 (11,9)	2.250 (57,2)	.938 (23,8)	.969 (24,6)	.625 (15,9)	.437 (11,1)
40024	2 AWG	3/8	Pink	.307 (7,8)	.531 (13,5)	2.625 (66,7)	.922 (23,4)	1.031 (26,2)	.750 (19,1)	.437 (11,1)
40025	2 AWG	1/2	Pink	.307 (7,8)	.531 (13,5)	2.625 (66,7)	.922 (23,4)	1.125 (28,6)	.750 (19,1)	.437 (11,1)
40028	1 AWG	3/8	Gold	.350 (8,9)	.531 (13,5)	2.625 (66,7)	.922 (23,4)	1.031 (26,2)	.750 (19,1)	.437 (11,1)
40029	1 AWG	1/2	Gold	.350 (8,9)	.531 (13,5)	2.625 (66,7)	.922 (23,4)	1.125 (28,6)	.750 (19,1)	.437 (11,1)
40032	1/0 AWG	3/8	Tan	.414 (10,5)	.635 (16,1)	3.125 (79,4)	1.187 (30,1)	1.312 (33,3)	.875 (22,5)	.625 (15,9)
40033	1/0 AWG	1/2	Tan	.414 (10,5)	.635 (16,1)	3.125 (79,4)	1.187 (30,1)	1.312 (33,3)	.875 (22,5)	.625 (15,9)
40037	2/0 AWG	1/2	Olive	.439 (11,2)	.687 (17,5)	3.187 (80,9)	1.303 (33,1)	1.250 (31,8)	.953 (24,2)	.625 (15,9)
40041	3/0 AWG	1/2	Ruby	.484 (12,3)	.760 (19,3)	3.437 (87,3)	1.500 (38,1)	1.281 (32,5)	1.065 (27,1)	.625 (15,9)
40045	4/0 AWG	1/2	White	.547 (13,9)	.875 (22,2)	3.562 (90,5)	1.438 (36,5)	1.344 (34,1)	1.187 (30,2)	.625 (15,9)
40046	4/0 AWG	5/8	White	.547 (13,9)	.875 (22,2)	3.562 (90,5)	1.438 (36,5)	1.344 (34,1)	1.187 (30,2)	.625 (15,9)
40049	250 kcmil	1/2	Red	.594 (15,1)	.906 (23,0)	3.625 (92,1)	1.563 (39,7)	1.313 (33,4)	1.237 (31,4)	.625 (15,9)
40050	250 kcmil	5/8	Red	.594 (15,1)	.906 (23,0)	3.625 (92,1)	1.590 (40,4)	1.313 (33,4)	1.237 (31,4)	.625 (15,9)
40053	300 kcmil	1/2	Dark Blue	.650 (16,5)	1.010 (25,7)	4.000 (101,6)	2.198 (55,6)	1.313 (33,4)	1.360 (34,5)	.625 (15,9)
40056	350 kcmil	1/2	Brown	.720 (18,3)	1.105 (28,1)	4.250 (108,0)	2.198 (55,6)	1.313 (33,4)	1.490 (37,8)	.625 (15,9)
40057	350 kcmil	5/8	Brown	.720 (18,3)	1.105 (28,1)	4.313 (109,5)	2.198 (55,6)	1.313 (33,4)	1.490 (37,8)	.625 (15,9)
40067	500 kcmil	5/8	Pink	.843 (21,4)	1.320 (33,5)	5.437 (138,1)	2.938 (74,6)	1.500 (38,1)	1.734 (44,0)	.625 (15,9)
40073	750 kcmil	5/8	Yellow	1.031 (26,2)	1.500 (38,1)	6.375 (161,9)	3.313 (84,2)	1.875 (47,6)	1.719 (43,7)	.875 (22,2)
40079	1000 kcmil	5/8	Brown	1.193 (30,3)	1.843 (46,8)	7.937 (201,6)	4.625 (117,5)	1.875 (47,6)	2.422 (61,5)	.875 (22,2)

3M™ Scotchlok™ Copper/Aluminum Compression Lugs, 40000 Series

Two-Hole Lug Dimensions and Selection Guide [Dimensions in Inches and (Millimeters)]

3M™ Scotchlok™ Lug Number	Conductor Size AWG or kcmil (MCM)	Stud Size	Color Code	I.D., +/- .010"	O.D., +/- .010"	L, Length, +/- .125"	B, Barrel Length, Min.	P, Pad Length, ±.060"	W, Pad Width, +/- .060"	C, Center of Hole-to-End of Pad	C1, Hole-to-Hole, Center-to-Center, +/- .015"
40132	1/0 AWG	3/8	Tan	.414 (10,5)	.640 (16,3)	5.281 (134,1)	1.50 (38,1)	3.250 (82,6)	.875 (22,2)	.625 (15,9)	1.75 (44,5)
40137	2/0 AWG	1/2	Olive	.439 (11,2)	.687 (17,5)	5.500 (139,7)	1.50 (38,1)	3.250 (82,6)	.938 (23,8)	.625 (15,9)	1.75 (44,5)
40141	3/0 AWG	1/2	Ruby	.484 (12,3)	.760 (19,3)	5.500 (139,7)	1.50 (38,1)	3.250 (82,6)	1.063 (27,0)	.625 (15,9)	1.75 (44,5)
40145	4/0 AWG	1/2	White	.547 (13,9)	.875 (22,2)	6.000 (152,4)	1.938 (49,2)	3.375 (85,7)	1.188 (30,2)	.625 (15,9)	1.75 (44,5)
40149	250 kcmil	1/2	Red	.594 (15,1)	.906 (23,0)	6.000 (152,4)	1.938 (49,2)	3.375 (85,7)	1.250 (31,8)	.625 (15,9)	1.75 (44,5)
40153	300 kcmil	1/2	Dark Blue	.650 (16,5)	1.010 (25,7)	6.562 (166,7)	2.25 (57,2)	3.563 (90,5)	1.375 (35,0)	.625 (15,9)	1.75 (44,5)
40156	350 kcmil	1/2	Brown	.720 (18,3)	1.105 (28,1)	6.562 (166,7)	2.25 (57,2)	3.563 (90,5)	1.500 (38,1)	.625 (15,9)	1.75 (44,5)
40160	400 kcmil	1/2	Green	.762 (19,4)	1.187 (30,2)	6.875 (174,6)	2.50 (63,5)	3.563 (90,5)	1.625 (41,3)	.625 (15,9)	1.75 (44,5)
40166	500 kcmil	1/2	Pink	.843 (21,4)	1.320 (33,5)	7.312 (185,7)	3.00 (76,2)	3.563 (90,5)	1.750 (44,5)	.625 (15,9)	1.75 (44,5)
40170	600 kcmil	1/2	Black	.923 (23,4)	1.438 (36,3)	7.750 (190,5)	3.00 (76,2)	3.625 (92,1)	1.750 (44,5)	.625 (15,9)	1.75 (44,5)
40172	750 kcmil	1/2	Yellow	1.031 (26,2)	1.500 (38,1)	8.250 (209,6)	3.38 (85,9)	3.625 (92,1)	1.750 (44,5)	.625 (15,9)	1.75 (44,5)
40178	1000 kcmil	1/2	Brown	1.193 (30,3)	1.843 (46,8)	9.687 (246,0)	4.625 (117,5)	3.625 (92,1)	2.438 (62,0)	.625 (15,9)	1.75 (44,5)

Typical Properties

Not for specifications. Values are typical, not to be considered minimum or maximum. Properties measured at room temperature 73°F (23°C) unless otherwise stated.

3M Scotchlok Copper/Aluminum Compression Lugs, 40000 Series, when crimped with approved die sets, can be used on cables with an operating temperature of 194°F (90°C) and an emergency overload rating of 266°F (130°C). The lugs pass the requirements of UL486B (Underwriters Laboratories standard for safety). The current rating of these lugs meets or exceeds the current rating of the conductor size for which it is intended.

Tool/Installation Information

Lugs shall be crimped with one of the approved die sets according to the engineering information supplied with the lugs. (Also see Crimping Tool-Die Sets table below). If different crimping tools and die sets are used, consult the tool and die manufacturer.

3M™ Scotchlok™ Copper/Aluminum Compression Lugs, 40000 Series

Crimping Tool Recommendations

One-Hole Lug Crimping Tool – Die Sets (Minimum # of Crimps)

3M™ Scotchlok™ Lug Number	Conductor Size AWG or kcmil (MCM)	Burdny Corporation						Thomas & Betts			Kearney
		Die Index	MD6	Y35	Y39	Y45	Y46	TBM5	TBM 8	TBM15	WH2,052
40016	6 AWG	161 346	W161 (1) -----	U161 (1) U6CABT (1)	----- U6CABT (1)	U161 (1) U6CABT (1)	U161 (1) U6CABT (1)	Grey (1)	Grey (1)	29 (1)	5/16 (1)
40020	4 AWG	162 375	W162 (2) -----	U162 (1) U4CABT (1)	----- U4CABT (1)	U162 (1) U4CABT (1)	U162 (1) U4CABT (1)	Green (2)	Green (2)	37 (1)	-----
40024	2 AWG	163 348	W163 (3) -----	U163 (1) U2CABT (1)	----- U2CABT (1)	U163 (1) U2CABT (1)	U163 (1) U2CABT (1)	Gold (2)	Gold (2)	45 (2)	1/2 (2)
40025	2 AWG	163 348	W163 (3) -----	U163 (1) U2CABT (1)	----- U2CABT (1)	U163 (1) U2CABT (1)	U163 (1) U2CABT (1)	Gold (2)	Gold (2)	45 (2)	1/2 (2)
40028	1 AWG	163 348	W163 (3) -----	U163 (1) U2CABT (1)	----- U2CABT (1)	U163 (1) U2CABT (1)	U163 (1) U2CABT (1)	Gold (2)	Gold (2)	45 (1)	1/2 (2)
40029	1 AWG	163 348	W163 (3) -----	U163 (1) U2CABT (1)	----- U2CABT (1)	U163 (1) U2CABT (1)	U163 (1) U2CABT (1)	Gold (2)	Gold (2)	45 (1)	1/2 (2)
40032	1/0 AWG	BG 243	W-BG (2) W243 (2)	U-BG (2) U243 (1)	----- -----	U-BG (2) U243 (1)	U-BG (2) U243 (1)	Tan (3)	Tan (3)	52 (1)	5/8 (3)
40033	1/0 AWG	BG 243	W-BG (2) W243 (2)	U-BG (2) U243 (1)	----- -----	U-BG (2) U243 (1)	U-BG (2) U243 (1)	Tan (3)	Tan (3)	52 (1)	5/8 (3)
40037	2/0 AWG	297	-----	U26ART (2)	U26ART (2)	U26ART (2)	U26ART (2)	Olive (3)	Olive (3)	58 (2)	5/8-1 (3)
40041	3/0 AWG	167 467	----- -----	U167 (2) U27ART (3)	----- U27ART (3)	U167 (2) U27ART (3)	U167 (2) U27ART (3)	Ruby (3)	Ruby (3)	66 (1)	-----
40045	4/0 AWG	296	-----	U28ART (2)	U28ART (2)	U28ART (2)	U28ART (2)	-----	White (3)	71H (3)	640 (3)
40046	4/0 AWG	296	-----	U28ART (2)	U28ART (2)	U28ART (2)	U28ART (2)	-----	White (3)	71H (3)	640 (3)
40049	250 kcmil	249	W249 (2)	U249 (1)	-----	U249 (1)	U249 (1)	-----	Red (2)	76 (1)	640 (3)
40050	250 kcmil	249	W249 (2)	U249 (1)	-----	U249 (1)	U249 (1)	-----	Red (2)	76 (1)	640 (3)
40053	300 kcmil	251 470	----- -----	U251 (2) U30ART (2)	----- U30ART (2)	U251 (2) U30ART (2)	U251 (2) U30ART (2)	-----	Blue (3)	87H (2)	1 (3)
40056	350 kcmil	299 655	----- -----	U31ART (2) U655 (2)	U31ART (2) -----	U31ART (2) U655 (2)	U31ART (2) U655 (2)	-----	Brown (4)	96 (2)	1 1/8-1 (2)
40057	350 kcmil	299 655	----- -----	U31ART (2) U655 (2)	U31ART (2) -----	U31ART (2) U655 (2)	U31ART (2) U655 (2)	-----	Brown (4)	96 (2)	1 1/8-1 (2)
40067	500 kcmil	300 317	----- -----	U34ART (4) U317 (3)	U34ART (4) -----	U34ART (4) U317 (3)	U34ART (4) U317 (3)	-----	-----	106A (2)	1 5/16 (3)
40073	750 kcmil	608 786 936	----- ----- -----	U608 (2) U786* -----	----- ----- U39ART-2(3)	U608 (2) S786* U39ART-2 (3)	U608 (2) P786* U39ART-2 (3)	-----	-----	125H (4)	1 1/2 (3)
40079	1000 kcmil	292 302 319 352	----- ----- ----- -----	----- ----- ----- -----	----- ----- ----- -----	S292 (4) S44ART (4) S319 (3) S352 (3)	P292 (2) P44ART (2) P319 (2) P352 (2)	-----	-----	161 (2)	1 3/4 (3)

* Install as many crimps as possible without overlapping.

() Indicates minimum number of crimps for each cable insertion. Overlapping of crimps in order to obtain specified number is permissible.

3M™ Scotchlok™ Copper/Aluminum Compression Lugs, 40000 Series

Crimping Tool Recommendations, *continued*

Two-Hole Lug Crimping Tool – Die Sets (Minimum # of Crimps)

3M™ Scotchlok™ Lug Number	Conductor Size AWG or kcmil (MCM)	Burdny Corporation						Thomas & Betts			Kearney
		Die Index	MD6	Y35	Y39	Y45	Y46	TBM5	TBM 8	TBM15	WH2,052
40132	1/0 AWG	BG 243	W-BG (2) W243 (2)	U-BG (2) U243 (1)	----- -----	U-BG (2) U243 (1)	U-BG (2) U243 (1)	Tan (3)	Tan (3)	52 (1)	5/8 (3)
40137	2/0 AWG	297	-----	U26ART (2)	U26ART (2)	U26ART (2)	U26ART (2)	Olive (3)	Olive (3)	58 (2)	5/8-1 (3)
40141	3/0 AWG	167 467	----- -----	U167 (2) U27ART (3)	----- U27ART (3)	U167 (2) U27ART (3)	U167 (2) U27ART (3)	Ruby (3)	Ruby (3)	66 (1)	-----
40145	4/0 AWG	296	-----	U28ART (2)	U28ART (2)	U28ART (2)	U28ART (2)	-----	White (3)	71H (3)	640 (3)
40149	250 kcmil	249	W249 (2)	U249 (1)	-----	U249 (1)	U249 (1)	-----	Red (2)	76 (1)	640 (3)
40153	300 kcmil	251 470	----- -----	U251 (2) U30ART (2)	----- U30ART (2)	U251 (2) U30ART (2)	U251 (2) U30ART (2)	-----	Blue (3)	87H (2)	1 (3)
40156	350 kcmil	299 655	----- -----	U31ART (2) U655 (2)	U31ART (2) -----	U31ART (2) U655 (2)	U31ART (2) U655 (2)	-----	Brown (4)	96 (2)	1 1/8-1 (2)
40160	400 kcmil	472 655	----- -----	U32ART (3) U655 (2)	U32ART (3) -----	U32ART (3) U655 (2)	U32ART (3) U655 (2)	-----	-----	96 (2)	1 1/8-1 (2)
40166	500 kcmil	300 317	----- -----	U34ART (4) U317 (3)	U34ART (4) -----	U34ART (4) U317 (3)	U34ART (4) U317 (3)	-----	-----	106A (2)	1 5/16 (3)
40170	600 kcmil	473 786 936	----- ----- -----	U36ART (3) U786* -----	U36ART (3) ----- U39ART-2(2)	U36ART (3) S786* U39ART-2 (2)	U36ART (3) P786* U39ART-2 (2)	-----	-----	115H (3)	1 5/16 (3)
40172	750 kcmil	608 786 936	----- ----- -----	U608 (2) U786* -----	----- ----- U39ART-2(3)	U608 (2) S786* U39ART-2 (3)	U608 (2) P786* U39ART-2 (3)	-----	-----	125H (4)	1 1/2 (3)
40178	1000 kcmil	292 302 319 352	----- ----- ----- -----	----- ----- ----- -----	----- ----- ----- -----	S292 (4) S44ART (4) S319 (3) S352 (3)	P292 (2) P44ART (2) P319 (2) P352 (2)	-----	-----	161 (2)	1 3/4 (3)

* Install as many crimps as possible without overlapping.

() Indicates minimum number of crimps for each cable insertion. Overlapping of crimps in order to obtain specified number is permissible.

Storage

Components of the lugs are not impaired by freezing or overheating due to ambient temperatures found in typical storage or shipping. Normal stock rotation procedures are recommended.

Availability

Please contact your local distributor; available from 3M.com/electrical [Where to Buy] or call 1.800.245.3573.

3M™ Scotchlok™ Copper/Aluminum Compression Lugs, 40000 Series

Important Notice

All statements, technical information, and recommendations related to 3M's products are based on information believed to be reliable, but the accuracy or completeness is not guaranteed. Before using this product, you must evaluate it and determine if it is suitable for your intended application. You assume all risks and liability associated with such use. Any statements related to the product, which are not contained in 3M's current publications, or any contrary statements contained on your purchase order, shall have no force or effect unless expressly agreed upon, in writing, by an authorized officer of 3M.

Warranty; Limited Remedy; Limited Liability

This product will be free from defects in material and manufacture at the time of purchase. **3M MAKES NO OTHER WARRANTIES INCLUDING, BUT NOT LIMITED TO, ANY IMPLIED WARRANTY OF MERCHANTABILITY OR FITNESS FOR A PARTICULAR PURPOSE.** If this product is defective within the warranty period stated above, your exclusive remedy shall be, at 3M's option, to replace or repair the 3M product or refund the purchase price of the 3M product. **Except where prohibited by law, 3M will not be liable for any direct, indirect, special, incidental or consequential loss or damage arising from this 3M product, regardless of the legal theory asserted.**

3M and Scotchlok are trademarks of 3M Company.

**Electrical Markets Division**

6801 River Place Blvd.
Austin, TX 78726-9000
800.245.3573
FAX: 800.245.0329
www.3M.com/electrical

Please recycle
© 3M 2015 All rights reserved
78-8129-9549-2 Rev D

X-ON Electronics

Largest Supplier of Electrical and Electronic Components

Click to view similar products for [Terminals](#) category:

Click to view products by [Jokari](#) manufacturer:

Other Similar products are found below :

[HT-13-10](#) [71M-250-32-NB](#) [01-2065-1-0216](#) [00581P0075](#) [M10-10RX](#) [M10BCK](#) [60205-1](#) [604200-1](#) [60598-1-CUT-TAPE](#) [60617-1-C](#) [60873-1](#) [M14-516R/SK](#) [M14-6RSX](#) [M18-10FLX](#) [M18-8FBX](#) [M18-8R/LX](#) [M18BCK](#) [61314-6-C](#) [61-S](#) [61-SN-A](#) [62-NBM-A](#) [63-S](#) [640179-1](#) [640917-2-CUT-TAPE](#) [6501550002](#) [66107-2-C](#) [696683-1](#) [696834-1](#) [696861-1](#) [696931-1](#) [696999-1](#) [M8-516RK](#) [M86700006](#) [MA250DMFMX-A](#) [701-2007](#) [701-2307](#) [701-7761-03](#) [70F-110-32-PB](#) [718-N-A](#) [71M-187-20-NBL](#) [71M-250-32-NBL](#) [72F-187-20-NBL](#) [72M-250-32-NBL](#) [7310](#) [73F-250-32](#) [73F-250-32-NBL](#) [73F-250-32-NL](#) [F14-10C](#) [F-1M](#) [751-250](#)