

General data

LUMOTAST 75 IP65 pushbutton range

Illuminated pushbuttons and signal lamps with lamp socket T 4.5

- Mounting hole diameter 16.2 mm
- Degree of protection IP65
- Solder terminals for the following wire cross-sections:
 - Installed 0.5 mm² max.
 - Factory terminated 0.35 mm² max.
- 250 V/4 A max.
- 2 NC + 2 NO max. (3 NC + 3 NO on request)

Content

LUMOTAST 75 illuminated pushbutton IP65

LUMOTAST 75 illuminated pushbutton IP65, flush lens, square collar	1 - 54
LUMOTAST 75 illuminated pushbutton IP65, protruding lens, square collar	1 - 56
LUMOTAST 75 illuminated pushbutton IP65, flush lens, round collar	1 - 57
LUMOTAST 75 illuminated pushbutton IP65, protruding lens, round collar	1 - 58
LUMOTAST 75 illuminated pushbutton IP65, flush lens, rectangular collar	1 - 59
LUMOTAST 75 illuminated pushbutton IP65, protruding lens, rectangular collar	1 - 60

LUMOTAST 75 signal lamp IP65

LUMOTAST 75 signal lamp IP65, flush lens, square collar	1 - 62
LUMOTAST 75 signal lamp IP65, protruding lens, square collar	1 - 63
LUMOTAST 75 signal lamp IP65, flush lens, round collar	1 - 64
LUMOTAST 75 signal lamp IP65, protruding lens, round collar	1 - 64
LUMOTAST 75 signal lamp IP65, flush lens, rectangular collar	1 - 65
LUMOTAST 75 signal lamp IP65, protruding lens, rectangular collar	1 - 65

1

LUMOTAST 75 illuminated pushbutton IP65

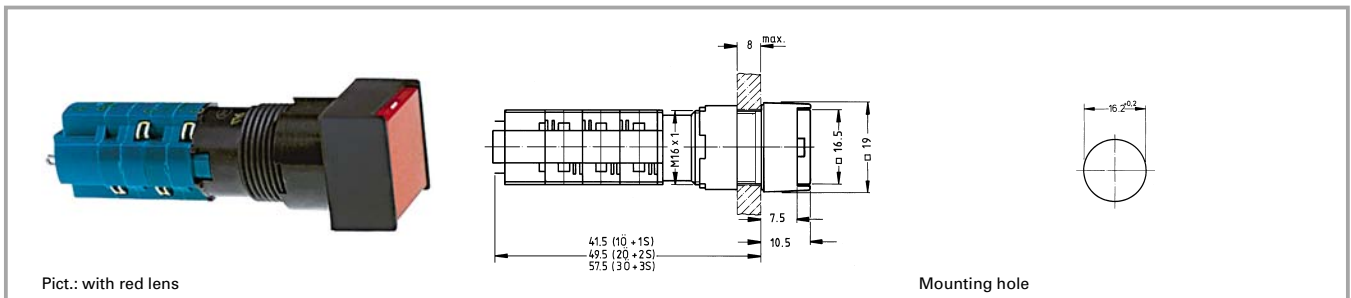

Technical data

General information

Form of lens	see order block
Colour of lens	see order block
Form of collar	see order block
Colour of collar	black

Dimensions

Length of collar	see order block
Diameter of collar	see order block
Width of collar	see order block
Overall height	10.5 mm
Mounting depth	see order block
Mounting hole	16.2 mm

Mechanical design

Mounting	ring nut
Terminals	solder terminals
Contact system	snap-action bridge contact
Contact function	see order block
Contact arrangement	see order block
Contact materials	Ag
Illuminability	yes
Lamp socket	T 4.5

Mechanical characteristics

Operating force	3 ... 6.5 N
Operating travel	2.5 mm
Switching travel NC	1.8 mm
Switching travel NO	0.9 mm
Robustness min.	100 N

Electrical characteristics

Rated voltage AC max.	250 V
Rated voltage DC max.	220 V
Rated voltage AC/DC min.	12 V
Rated current AC max.	4 A

Rated current DC max.	0.2 A
Rated current AC/DC min.	5 mA
Contact resistance acc. to life max.	200 mΩ
Protection class	II
ESD-strength min.	14 kV

Other specifications

Operating life, at 250 V/2 A (operations)	200000 (momentary), 50000 (latching)
Operating life, at 250 V/4 A (operations)	60000 (momentary)
Degree of protection from front side	IP65
Ambient temp. operating min.	-25 °C
Ambient temp. operating without lamp max.	+70 °C
Ambient temp. operating with lamp max.	+55 °C
Storage temperature min.	-40 °C
Storage temperature max.	+80 °C
Resistance to constant environment	according to IEC 600 68-2-3 and 2-30
Resistance at variable environment	according to IEC 600 68-2-14 and 2-33
Weight	15 g
Approvals	ENEC 25 T 55 (70), UL, CSA
Flame class acc. to UL 94	V 0
Hot wire ignition acc. to IEC 60695-2-1	yes

Accessories LUMOTAST 75 illuminated pushbutton IP65

Description	Photo	Order no.	Page
Filament lamp, T 4.5 base, 12 V		1.90.100.022/0000	5 - 6
Filament lamp, T 4.5 base, 24 V		1.90.100.023/0000	5 - 6

Accessories LUMOTAST 75 illuminated pushbutton IP65

Description	Photo	Order no.	Page
LED T 4.5 superbright, red, 24 V		1.90.690.331/0000	5 - 18
LED T 4.5 superbright, green, 24 V		1.90.690.332/0000	5 - 18
LED T 4.5 superbright, yellow, 24 V		1.90.690.333/0000	5 - 18
LED T 4.5 superbright, blue, 24 V		1.90.690.334/0000	5 - 18
LED T 4.5 superbright, white, 24 V		1.90.690.335/0000	5 - 18
LED T 4.5, red, 2-3 V		1.90.692.001/0000	5 - 18
LED T 4.5, green, 2-3 V		1.90.692.002/0000	5 - 18
LED T 4.5, yellow, 2-3 V		1.90.692.003/0000	5 - 18
Lamp extractor for T 4.5/5.5, lamp diameter 4 mm		1.90.900.002/0000	5 - 22
Lamp extractor for lamp diameter 5-6 mm		1.90.900.004/0000	5 - 22
Protective cap (for 18 x 24 collar)		5.05.800.027/0000	5 - 26
Blanking cap, black, to cover spare holes, dimensions 18 x 18 mm		5.52.006.020/0103	5 - 28
Blanking cap, black, to cover spare holes, dimensions 18 x 24 mm		5.52.006.021/0100	5 - 28
Blanking cap, black, to cover spare holes, round 18 mm		5.52.006.022/0100	5 - 28
Fixing spanner M 15, M 16		5.58.002.019/0105	5 - 23

1

LUMOTAST 75 illuminated pushbutton IP65, flush lens, square collar

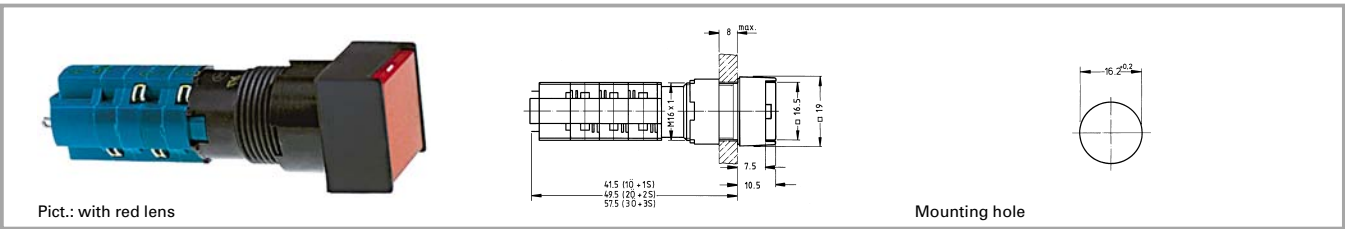

Contact arrangement	Contact function	Colour of collar	Order no. without lens	Note
1 NC + 1 NO	momentary	black	1.15.108.276/0000	Please include the desired lens in your order.
1 NC + 1 NO	latching	black	1.15.108.376/0000	Please include the desired lens in your order.
2 NC + 2 NO	momentary	black	1.15.108.277/0000	Please include the desired lens in your order.
2 NC + 2 NO	latching	black	1.15.108.377/0000	Please include the desired lens in your order.

LUMO
75 (65)

Technical data see page 1 - 54

Lenses:

- Lens, square, transparent colourless, for filament lamp or LED: **5.49.277.052/1002**
- Lens, square, transparent red, for LED: **5.49.277.052/1301**
- Lens, square, transparent red, for filament lamp: **5.49.277.052/1303**
- Lens, square, transparent yellow, for filament lamp or LED: **5.49.277.052/1402**
- Lens, square, transparent green, for filament lamp: **5.49.277.052/1502**
- Lens, square, transparent green, for LED: **5.49.277.052/1503**
- Lens, square, transparent blue, for filament lamp: **5.49.277.052/1601**

Accessories:

- Legend insert, square, without legend: **5.70.629.000/2000**

LUMOTAST 75 illuminated pushbutton IP65, protruding lens, square collar

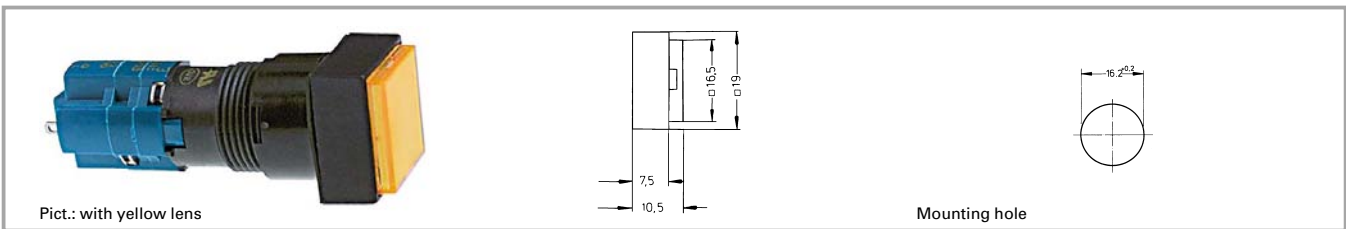

Contact arrangement	Contact function	Colour of collar	Order no. without lens	Note
1 NC + 1 NO	momentary	black	1.15.108.281/0000	Please include the desired lens in your order.
1 NC + 1 NO	latching	black	1.15.108.381/0000	Please include the desired lens in your order.
2 NC + 2 NO	momentary	black	1.15.108.282/0000	Please include the desired lens in your order.
2 NC + 2 NO	latching	black	1.15.108.382/0000	Please include the desired lens in your order.

Technical data see page 1 - 54

Lenses:

- Lens, square, transparent colourless, for filament lamp or LED: **5.49.277.052/1002**
- Lens, square, transparent red, for LED: **5.49.277.052/1301**
- Lens, square, transparent red, for filament lamp: **5.49.277.052/1303**
- Lens, square, transparent yellow, for filament lamp or LED: **5.49.277.052/1402**
- Lens, square, transparent green, for filament lamp: **5.49.277.052/1502**
- Lens, square, transparent green, for LED: **5.49.277.052/1503**
- Lens, square, transparent blue, for filament lamp: **5.49.277.052/1601**

Accessories:

- Legend insert, square, without legend: **5.70.629.000/2000**

1

LUMO
75 (65)

LUMOTAST 75 illuminated pushbutton IP65, flush lens, round collar



Pict.: with blue lens

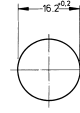
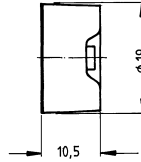

Mounting hole

Contact arrangement	Contact function	Colour of collar	Order no. without lens	Note
1 NC + 1 NO	momentary	black	1.15.108.481/0000	Please include the desired lens in your order.
1 NC + 1 NO	latching	black	1.15.108.981/0000	Please include the desired lens in your order.
2 NC + 2 NO	momentary	black	1.15.108.482/0000	Please include the desired lens in your order.
2 NC + 2 NO	latching	black	1.15.108.982/0000	Please include the desired lens in your order.

Technical data see page 1 - 54

LUMO
75 (65)

Lenses:

Lens, round, transparent colourless, for filament lamp or LED: **5.49.259.013/1002**

Lens, round, transparent red, for LED: **5.49.259.013/1301**

Lens, round, transparent red, for filament lamp: **5.49.259.013/1303**

Lens, round, transparent yellow, for filament lamp or LED: **5.49.259.013/1402**

Lens, round, transparent green, for filament lamp: **5.49.259.013/1502**

Lens, round, transparent green, for LED: **5.49.259.013/1503**

Lens, round, transparent blue, for filament lamp: **5.49.259.013/1601**

Accessories:

Legend insert, round, without legend: **5.70.059.000/2000**

LUMOTAST 75 illuminated pushbutton IP65, protruding lens, round collar



Pict.: with colourless lens

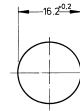
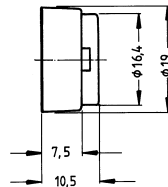

Mounting hole

Contact arrangement	Contact function	Colour of collar	Order no. without lens	Note
1 NC + 1 NO	momentary	black	1.15.108.476/0000	Please include the desired lens in your order.
1 NC + 1 NO	latching	black	1.15.108.976/0000	Please include the desired lens in your order.
2 NC + 2 NO	momentary	black	1.15.108.477/0000	Please include the desired lens in your order.
2 NC + 2 NO	latching	black	1.15.108.977/0000	Please include the desired lens in your order.

Technical data see page 1 - 54

Lenses:

Lens, round, transparent colourless, for filament lamp or LED: **5.49.259.013/1002**

Lens, round, transparent red, for LED: **5.49.259.013/1301**

Lens, round, transparent red, for filament lamp: **5.49.259.013/1303**

Lens, round, transparent yellow, for filament lamp or LED: **5.49.259.013/1402**

Lens, round, transparent green, for filament lamp: **5.49.259.013/1502**

Lens, round, transparent green, for LED: **5.49.259.013/1503**

Lens, round, transparent blue, for filament lamp: **5.49.259.013/1601**

Accessories:

Legend insert, round, without legend: **5.70.059.000/2000**

1

LUMO
75 (65)

1

LUMOTAST 75 illuminated pushbutton IP65, flush lens, rectangular collar



Pict.: with green lens, without threaded ring

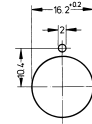
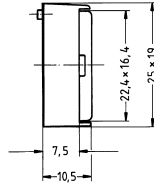

Contact arrangement	Contact function	Colour of collar	Order no. without lens	Note
1 NC + 1 NO	momentary	black	1.15.108.076/0000	Please include the desired lens in your order.
1 NC + 1 NO	latching	black	1.15.108.176/0000	Please include the desired lens in your order.
2 NC + 2 NO	momentary	black	1.15.108.077/0000	Please include the desired lens in your order.
2 NC + 2 NO	latching	black	1.15.108.177/0000	Please include the desired lens in your order.

LUMO
75 (65)

Technical data see page 1 - 54

Lenses:

- Lens, rectangular, transparent colourless, for filament lamp or LED: **5.49.277.058/1002**
- Lens, rectangular, transparent red, for LED: **5.49.277.058/1301**
- Lens, rectangular, transparent red, for filament lamp: **5.49.277.058/1303**
- Lens, rectangular, transparent yellow, for filament lamp or LED: **5.49.277.058/1402**
- Lens, rectangular, transparent green, for filament lamp: **5.49.277.058/1502**
- Lens, rectangular, transparent green, for LED: **5.49.277.058/1503**
- Lens, rectangular, transparent blue, for filament lamp: **5.49.277.058/1601**

Accessories:

- Legend insert, rectangular without legend: **5.70.630.000/2000**

1

LUMOTAST 75 signal lamp IP65

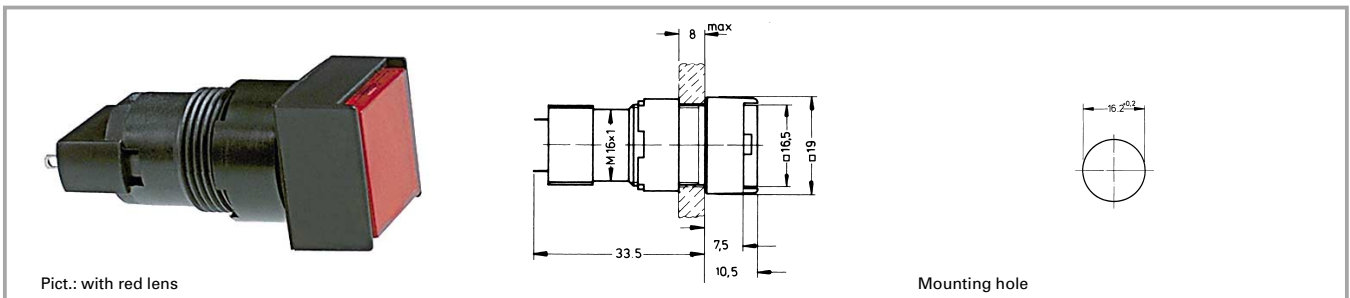

Technical data

General information

Form of lens see order block
 Form of collar see order block
 Diameter of collar see order block

Dimensions

Length of collar see order block
 Width of collar see order block
 Overall height 10.5 mm
 Mounting depth 33.5 mm
 Mounting hole 16.2 mm

Mechanical design

Mounting ring nut
 Terminals solder terminals
 Lamp socket T 4.5
 Lamp filament lamp / LED

Electrical characteristics

Voltage limit max. 42 V
 Power limit max. 1.2 W

Other specifications

Degree of protection from front side IP65
 Weight 5 g
 Approvals ENEC 25 T 55 (70), UL, CSA
 Ambient temp. operating min. -25 °C
 Ambient temp. operating max. +55 °C
 Storage temperature min. -40 °C
 Storage temperature max. +80 °C

LUMO
75 (65)

Accessories LUMOTAST 75 signal lamp IP65

Description	Photo	Order no.	Page
Filament lamp, T 4.5 base, 12 V		1.90.100.022/0000	5 - 6
Filament lamp, T 4.5 base, 24 V		1.90.100.023/0000	5 - 6
LED T 4.5 superbright, red, 24 V		1.90.690.331/0000	5 - 18
LED T 4.5 superbright, green, 24 V		1.90.690.332/0000	5 - 18
LED T 4.5 superbright, yellow, 24 V		1.90.690.333/0000	5 - 18
LED T 4.5 superbright, blue, 24 V		1.90.690.334/0000	5 - 18
LED T 4.5 superbright, white, 24 V		1.90.690.335/0000	5 - 18
LED T 4.5, red, 2-3 V		1.90.692.001/0000	5 - 18

Accessories LUMOTAST 75 signal lamp IP65

Description	Photo	Order no.	Page
LED T 4.5, yellow, 2-3 V		1.90.692.003/0000	5 - 18
Lamp extractor for T 4.5/5.5, lamp diameter 4 mm		1.90.900.002/0000	5 - 22
Lamp extractor for lamp diameter 5-6 mm		1.90.900.004/0000	5 - 22
Blanking cap, black, to cover spare holes, dimensions 18 x 18 mm		5.52.006.020/0103	5 - 28
Blanking cap, black, to cover spare holes, dimensions 18 x 24 mm		5.52.006.021/0100	5 - 28
Blanking cap, black, to cover spare holes, round 18 mm		5.52.006.022/0100	5 - 28
Fixing spanner M 15, M 16		5.58.002.019/0105	5 - 23

1

LUMO
75 (65)

LUMOTAST 75 signal lamp IP65, flush lens, square collar

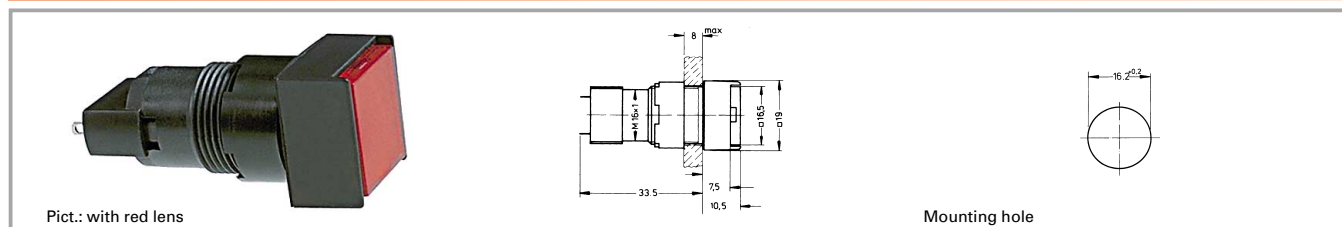

Voltage limit max.	Power limit max.	Lamp socket	Form of collar	Order no. without lens	Note
42 V	1.2 W	T 4.5	square	1.65.111.066/0000	Please include the desired lens in your order.

Technical data see page 1 - 62

Lenses:

Lens, square, transparent colourless, for filament lamp or LED: **5.49.277.052/1002**

Lens, square, transparent red, for LED: **5.49.277.052/1301**

Lens, square, transparent red, for filament lamp: **5.49.277.052/1303**

Lens, square, transparent yellow, for filament lamp or LED: **5.49.277.052/1402**

Lens, square, transparent green, for filament lamp: **5.49.277.052/1502**

Lens, square, transparent green, for LED: **5.49.277.052/1503**

Lens, square, transparent blue, for filament lamp: **5.49.277.052/1601**

Accessories:

Legend insert, square: **5.70.629.000/2000**

For assembly, press the lens as far as possible.

1

LUMOTAST 75 signal lamp IP65, protruding lens, square collar

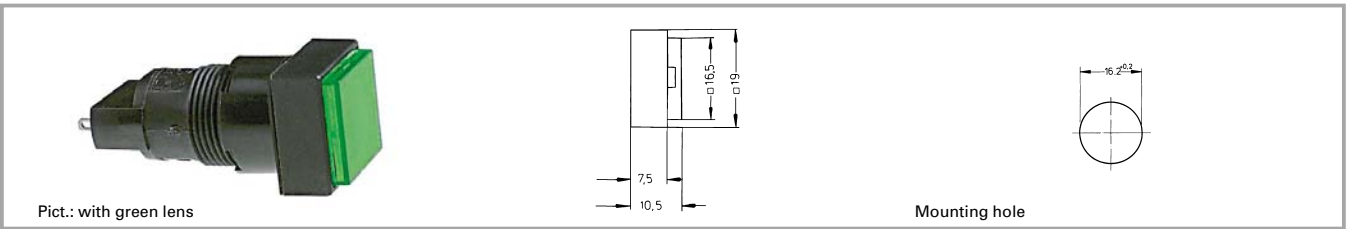

Voltage limit max.	Power limit max.	Lamp socket	Form of collar	Order no. without lens	Note
42 V	1.2 W	T 4.5	square	1.65.111.086/0000	Please include the desired lens in your order.

Technical data see page 1 - 62

Lenses:

- Lens, square, transparent colourless, for filament lamp or LED: **5.49.277.052/1002**
- Lens, square, transparent red, for LED: **5.49.277.052/1301**
- Lens, square, transparent red, for filament lamp: **5.49.277.052/1303**
- Lens, square, transparent yellow, for filament lamp or LED: **5.49.277.052/1402**
- Lens, square, transparent green, for filament lamp: **5.49.277.052/1502**
- Lens, square, transparent green, for LED: **5.49.277.052/1503**
- Lens, square, transparent blue, for filament lamp: **5.49.277.052/1601**

LUMO
75 (65)

Accessories:

Legend insert, round, without legend: **5.70.629.000/2000**

For assembly, press the lens as far as possible.

LUMOTAST 75 signal lamp IP65, flush lens, round collar

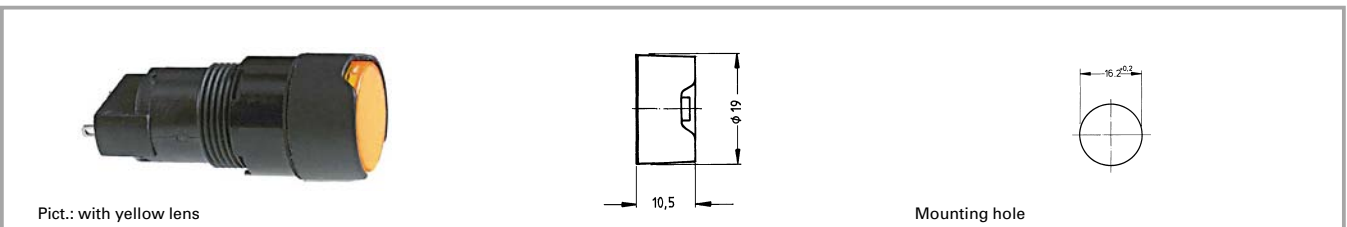

Voltage limit max.	Power limit max.	Lamp socket	Form of collar	Order no. without lens	Note
42 V	1.2 W	T 4.5	round	1.65.111.096/0000	Please include the desired lens in your order.

Technical data see page 1 - 62

Lenses:

- Lens, round, transparent colourless, for filament lamp or LED: **5.49.259.013/1002**
- Lens, round, transparent red, for LED: **5.49.259.013/1301**
- Lens, round, transparent red, for filament lamp: **5.49.259.013/1303**
- Lens, round, transparent yellow, for filament lamp or LED: **5.49.259.013/1402**
- Lens, round, transparent green, for filament lamp: **5.49.259.013/1502**
- Lens, round, transparent green, for LED: **5.49.259.013/1503**
- Lens, round, transparent blue, for filament lamp: **5.49.259.013/1601**

Accessories:

Legend insert, round, without legend: **5.70.059.000/2000**

For assembly, press the lens as far as possible.

LUMOTAST 75 signal lamp IP65, protruding lens, round collar

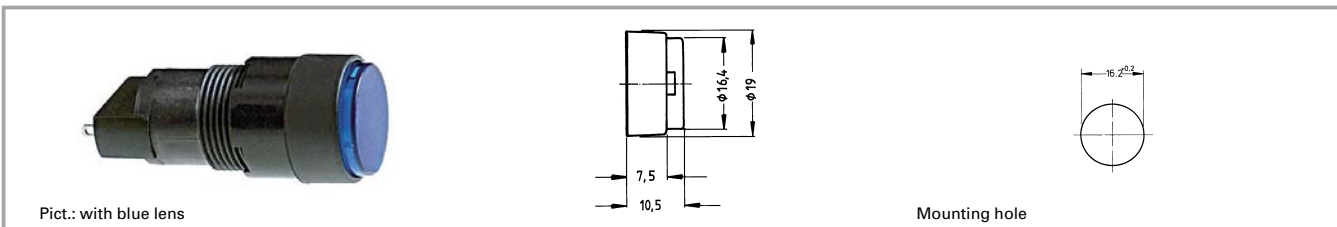

Voltage limit max.	Power limit max.	Lamp socket	Form of collar	Order no. without lens	Note
42 V	1.2 W	T 4.5	round	1.65.111.076/0000	Please include the desired lens in your order.

Technical data see page 1 - 62

Lenses:

- Lens, round, transparent colourless, for filament lamp or LED: **5.49.259.013/1002**
- Lens, round, transparent red, for LED: **5.49.259.013/1301**
- Lens, round, transparent red, for filament lamp: **5.49.259.013/1303**
- Lens, round, transparent yellow, for filament lamp or LED: **5.49.259.013/1402**
- Lens, round, transparent green, for filament lamp: **5.49.259.013/1502**
- Lens, round, transparent green, for LED: **5.49.259.013/1503**
- Lens, round, transparent blue, for filament lamp: **5.49.259.013/1601**

Accessories:

Legend insert, round, without legend: **5.70.059.000/2000**

For assembly, press the lens as far as possible.

LUMOTAST 75 signal lamp IP65, flush lens, rectangular collar

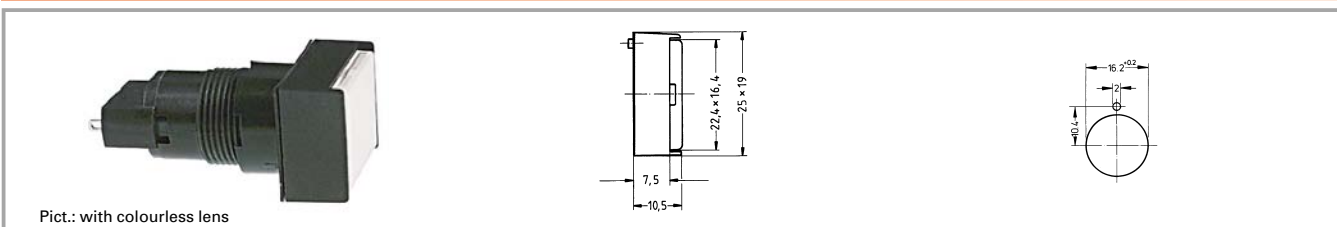

Voltage limit max.	Power limit max.	Lamp socket	Form of collar	Order no. without lens	Note
42 V	1.2 W	T 4.5	rectangular	1.65.111.056/0000	Please include the desired lens in your order.

Technical data see page 1 - 62

Lenses:

- Lens, rectangular, transparent colourless, for filament lamp or LED: **5.49.277.058/1002**
- Lens, rectangular, transparent red, for LED: **5.49.277.058/1301**
- Lens, rectangular, transparent red, for filament lamp: **5.49.277.058/1303**
- Lens, rectangular, transparent yellow, for filament lamp or LED: **5.49.277.058/1402**
- Lens, rectangular, transparent green, for filament lamp: **5.49.277.058/1502**
- Lens, rectangular, transparent green, for LED: **5.49.277.058/1503**
- Lens, rectangular, transparent blue, for filament lamp: **5.49.277.058/1601**

Accessories:

Legend insert, rectangular without legend: **5.70.630.000/2000**

For assembly, press the lens as far as possible.

X-ON Electronics

Largest Supplier of Electrical and Electronic Components

Click to view similar products for [Pushbutton Switches](#) category:

Click to view products by [Rafi](#) manufacturer:

Other Similar products are found below :

[LW1L-M1C10V-A](#) [LW2L-A1C20M-GD](#) [LW2L-M1C20M-A](#) [60324L](#) [M7E-HRN2](#) [67021K512](#) [67081K512X](#) [701PB580](#) [719-5504-000](#)
[MDPSSGLFS](#) [810KSV30B](#) [FLT 2U EE 01A](#) [MML21KA3ABK](#) [MML23KA3AC05K-001](#) [MML23KW3AA01W](#) [8418K2](#) [8646AB6X718UL](#)
[8646ABUL](#) [FSDWH](#) [9001KXRK](#) [9001T8BK](#) [9533CD4+U574+U4922](#) [1203MRA](#) [A22EM01S](#) [A595](#) [1202A6](#) [12037A2ULCSA](#) [1203A2UL](#)
[ABD122N-B](#) [1211390004](#) [ABN111-Y](#) [ABN400-R](#) [1211500044](#) [1211580012](#) [1212MRA](#) [1232A6NF](#) [RA3CSH6A](#) [1241.1183.7047](#)
[1241.2511](#) [1241.3428](#) [1223A2ULCSA](#) [1223MRA](#) [1232AX2119](#) [1241.1183.8000](#) [1241.1183.8029](#) [1241.2506](#) [1241.2606](#) [12MA6](#)
[1301940184](#) [RELBARF6X10\(PLASTIC\)](#)