

Item #	Description	Connector Orientation	1-9	10-24	25-99	100-249
<b>IEEE-488 GPIB Bulkhead Adapters - The Easiest Way to Feed GPIB Cables Through Panels</b>						
IEEE-488 bulkhead adapters originated because of a need by design and test engineers. Because of user concerns for ground loops, we offer another version of the popular CIB24BF with an insulated mounting bracket rather than a metal one. Model CIB24BF-I features a fiberglass mounting bracket.						
CIB24BA	IEEE-488 Bulkhead Adapter, Male / Female	Normal	32.00	29.44	26.88	24.32
CIB24BF	IEEE-488 Bulkhead Adapter, Female / Female	Normal	34.00	31.28	28.56	25.84
CIB24BF-I	IEEE-488 Bulkhead Adapter, Insulated, Female / Female	Normal	35.00	32.20	29.40	26.60

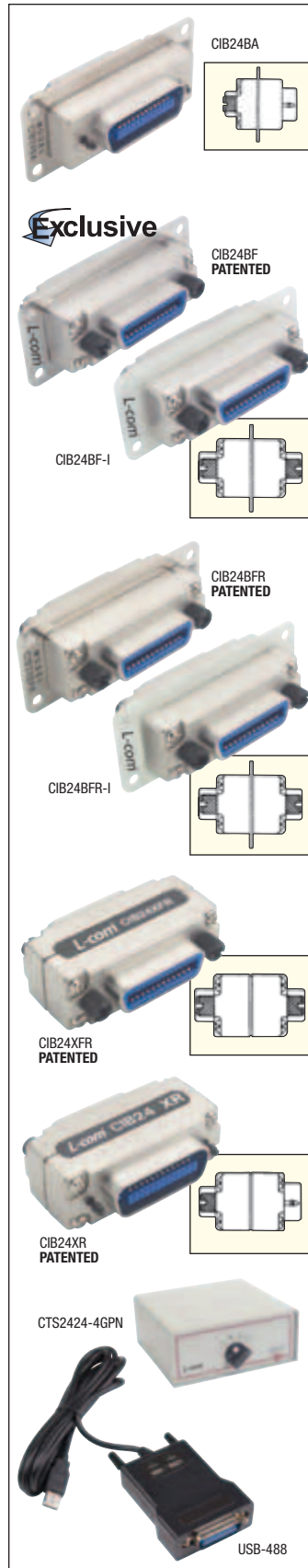

**Exclusive**

### Recommended Panel Openings for IEEE-488 GPIB Bulkhead Adapters

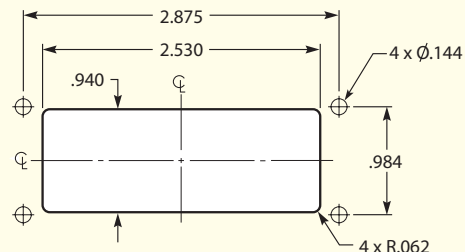

**L-com reverse entry adapters solve cable extension problems in the field.**

**Before:**

**A**

Typical GPIB cables with normal entry are difficult to extend.



**After:**

**B**

A reverse entry adapter solves the problem.



### IEEE-488 GPIB Reverse Entry Adapters - The Ultimate Solution for Many Difficult Situations

A twist has been added to IEEE-488 networking by the introduction of reverse entry adapters.

CIB24BFR	Reverse Entry IEEE-488 Bulkhead Adapter, Female / Female	Reverse	34.00	31.28	28.56	25.84
CIB24BFR-I	Reverse Entry IEEE-488 Bulkhead Adapter, Insulated, Female / Female	Reverse	35.00	32.20	29.40	26.60

### IEEE-488 GPIB Reverse GPIB Adapter - For Easy Extension of Two Standard IEEE-488 Cables

CIB24XFR	180° Reverse IEEE-488 Adapter, Female / Female	Reverse	26.00	23.92	21.84	19.76
----------	------------------------------------------------	---------	-------	-------	-------	-------

### IEEE-488 GPIB Reverse Extender - Changes Cable Direction 180° and Extends Port

CIB24XR	180° Reverse IEEE-488 Extender, Male / Female	Reverse	26.00	23.92	21.84	19.76
---------	-----------------------------------------------	---------	-------	-------	-------	-------

### IEEE-488 GPIB Transfer Switches - Compact Metal Construction and Rotary Switching

An economy transfer switch that is fully shielded to afford maximum RF/EMI protection. Two models are offered, the traditional A-B two position type and an A-B-C-D switch box.

CTS1224GAB	2 Way IEEE-488 Switch Box, A or B to I/O	94.00	88.36	82.72	77.08
CTS2424-4GPN	4 Way IEEE-488 Switch Box, A, B, C or D to I/O	105.00	98.70	92.40	86.10

### USB-488 USB to GPIB Converter Cable

The USB-488 is a USB to GPIB Controller Module that converts any PC with a USB interface into a full-function, IEEE 488.2 Bus Controller.

USB-488	USB to GPIB Converter Cable	495.00	CALL	CALL	CALL
---------	-----------------------------	--------	------	------	------

### IEEE-488 GPIB Connector Specifications

The IEEE-488 GPIB connector utilizes 24 contacts in a parallel configuration.

#### PLUG (male)

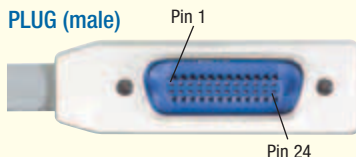

#### JACK (female)

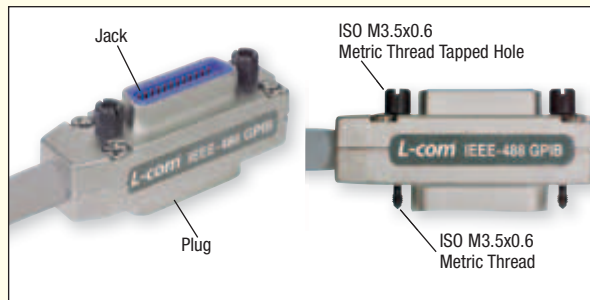
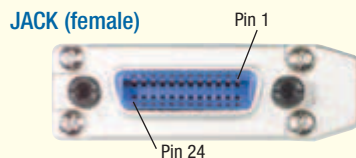

## X-ON Electronics

Largest Supplier of Electrical and Electronic Components

*Click to view similar products for [l-com](#) manufacturer:*

Other Similar products are found below :

[FOA-550A](#) [UMC-201](#) [CSMN50MF-5](#) [CSMNB15MF-15](#) [TRD815RA2BL-5](#) [CA3A-90DA-1M](#) [CTLF3VGAMM-20](#) [HDCAMM-3](#)  
[U3A00014-03M](#) [CSMT15MF-10](#) [CSMT15MM-15](#) [CSMT15MM-25](#) [CSPL15MF-50](#) [CSPL25MF-25](#) [CSPL9MF-10](#) [CSPL9MF-5](#)  
[CSPL25MF-5](#) [CSPL25MF-2.5](#) [AL-IPEPS](#) [NB201611-10F-1](#) [TDG1026KC5-MNL](#) [NB121005-10F](#) [TRD855SRA6DBL-10M](#)  
[TRD855SRA7DBL-1M](#) [TRD855SRA7DBL-10M](#) [U2A00017-05M](#) [PR175SCDLCQ24](#) [TRG508-T4T-3M](#) [TRA5261-15F](#) [TRA5261S-1F](#)  
[TRA6261-1F](#) [USBBFT](#) [DGB25M](#) [HG2403RD-RSF](#) [CASATAL-18](#) [CSM25MM-10](#) [CSM37MF-10](#) [CSUSB-100](#) [CA3A-90RA-1M](#) [CA3A-](#)  
[90RMICB-1M](#) [U2A00003-3M](#) [U3A00003-05M](#) [U2A00008-12I](#) [U3A00007-075M](#) [U3A00007-1M](#) [HGV-903U](#) [CSMT15MF-5](#)  
[CSMT15MM-50](#) [CSPL15MF-25](#) [LPXT-WP-PMT](#)