

**LUMOTAST 75 IP40 - Illuminated pushbutton, flush lens, square collar, momentary, housing****1.15.108.251/0000**

3 NC + 3 NO available on request.

**General information**

Form of lens	flat lens
Form of collar	square
Colour of collar	black

**Dimensions**

Length of collar	18 mm
Width of collar	18 mm
Overall height	7.5 mm
Mounting depth	41.5/49.5/57.5 mm
Mounting hole	16.2 mm

**Mechanical design**

Mounting	ring nut
Terminals	solder terminals
Contact system	snap-action bridge contact
Contact function	momentary
Contact arrangement	1 NC + 1 NO
Contact materials	Ag
Illumination	LED / filament lamp
Lamp socket	T 4.5

**Mechanical characteristics**

Operating force max.	3 ... 6.5 N
Operating travel	2.7 mm
Switching travel NC	1.6 mm
Switching travel NO	0.9 mm
Robustness min.	100 N

**Electrical characteristics**

Rated voltage AC max.	250 V
Rated voltage DC max.	230 V
Rated voltage AC/DC min.	12 V
Rated current AC max.	4 A
Rated current DC max.	0.2 A
Rated current AC/DC min.	5 mA
Contact resistance acc. to life max.	200 mΩ
Protection class	II
ESD-strength min.	14 kV

### Other specifications

Operating life, at 250 V/2 A (operations)	200,000 (momentary) cycle
Operating life, at 250 V/4 A (operations)	60,000 (momentary), 10,000 (latching)
Degree of protection from front side	IP40
Operation temperature min.	-25 °C
Ambient temp. operating max. without lamp / LED	+70 °C
Ambient temp. operating max. with lamp /LED	+55 °C
Storage temperature min.	-40 °C
Storage temperature max.	+80 °C
Environmental resistance	acc. to IEC 60068-2-14, -30, -33 and -78
Approvals	ENEC 25 T 55 (70), UL, CSA
Flame class acc. to UL 94	V 1
Hot wire ignition acc. to IEC 60695-2-1	yes
ROHS compliant	yes
REACH compliant	yes

### Mounting hole

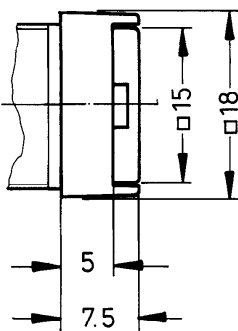
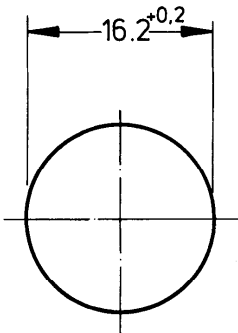

## X-ON Electronics

Largest Supplier of Electrical and Electronic Components

*Click to view similar products for [rafi](#) manufacturer:*

Other Similar products are found below :

[5.05.510.935/0000](#) [5.00.070.074/0000](#) [1.15.114.936/0000](#) [1.15.108.152/0000](#) [1.30.279.021/0700](#) [1.74.510.011/2500](#) [1.10.119.967/0000](#)  
[1.69.508.113/1002](#) [1.30.270.021/2400](#) [1.20.126.604/0000](#) [1.30.276.601/0000](#) [1.10.011.001/0551](#) [5.00.888.506/1500](#) [1.02.157.201/1300](#)  
[3.13.026.001/0000](#) [1.30.285.221/0100](#) [1.30.270.021/2300](#) [1.20.124.018/0000](#) [1.66.003.081/1400](#) [1.30.241.001/2207](#) [5.76.204.114/0400](#)  
[5.73.110.000/0000](#) [1.90.690.351/0000](#) [1.30.295.222/0000](#) [1.30.285.101/0100](#) [1.30.280.001/2201](#) [1.30.275.221/0800](#) [1.30.273.602/0300](#)  
[1.30.242.026/2207](#) [1.30.073.601/2000](#) [1.20.123.035/0000](#) [1.10.010.001/0221](#) [1.10.099.201/0011](#) [5.70.090.016/1001](#) [5.70.090.011/1001](#)  
[5.70.090.015/1001](#) [1.20.126.303/9000](#) [5.05.511.747/1500](#) [1.90.692.001/0000](#) [1.01.102.001/0104](#) [3.14.002.052/0000](#) [1.30.275.321/0100](#)  
[5.05.511.476/2200](#) [1.30.299.021/0700](#) [1.15.108.632/0100](#) [1.15.156.011/0000](#) [1.65.111.051/0000](#) [5.00.100.105/0000](#) [5.00.070.078/0000](#)  
[1.30.142.114/0209](#)