

LOC	DIST	REVISIONS					
		P	LTN	DESCRIPTION	DATE	DWN	APVD
ES	00	F		REVISED 2-2 BY CUSTOMER	09MAR2015	CZ	SZ

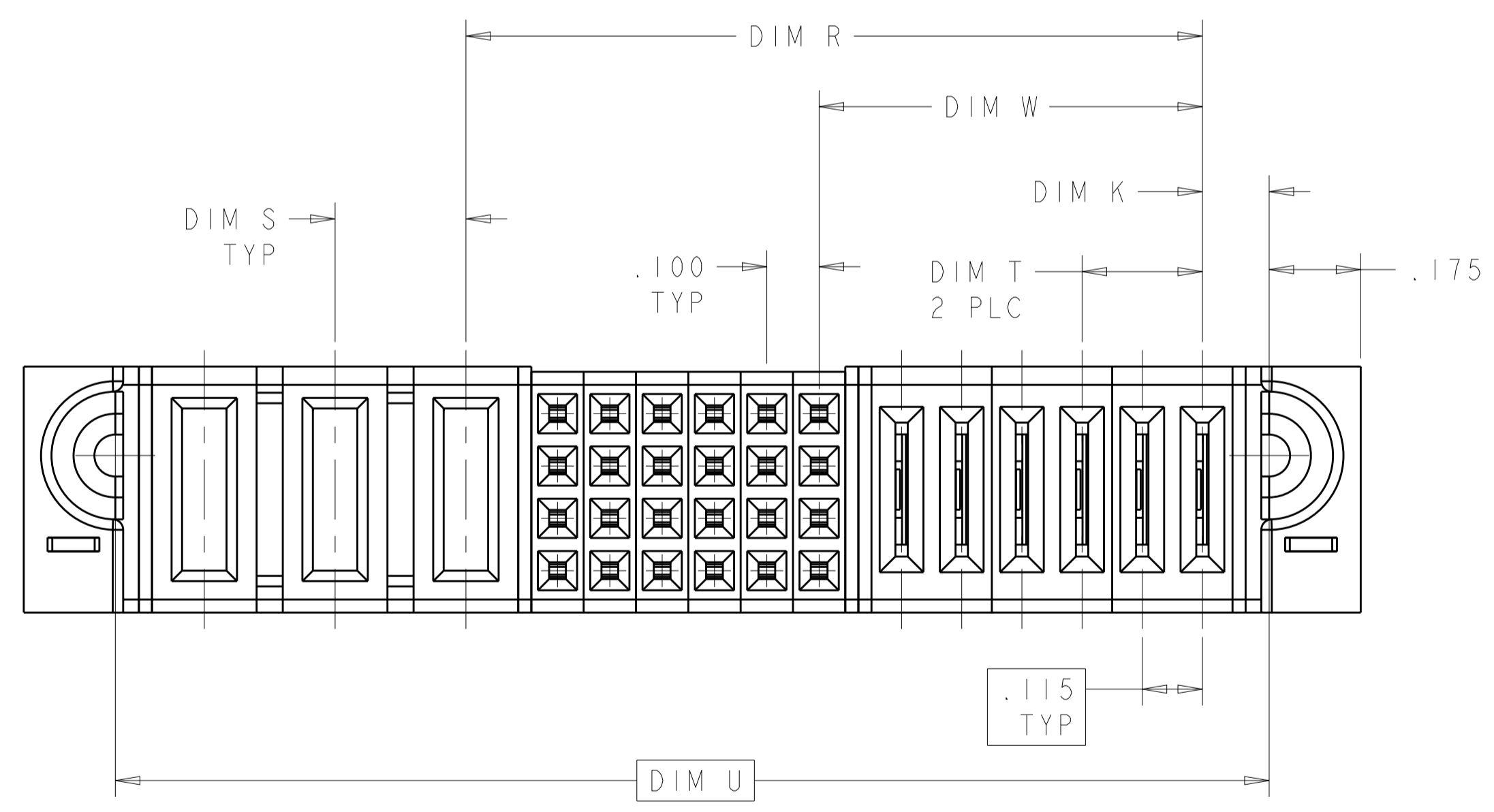

- ① "AMP", TRADEMARK, PART NUMBER AND DATE CODE TO BE MARKED IN AREA SHOWN
- ② MATERIAL: HOUSING - GLASS FILLED HIGH TEMP THERMO PLASTIC, UL94 V-0, BLACK
 SIGNAL CONTACT - HIGH CONDUCTIVITY COPPER ALLOY
 POWER CONTACT - HIGH CONDUCTIVITY COPPER ALLOY
- ③ CONTACT PLATING: NOBLE METAL PLATING ON CONTACT FUNCTIONAL AREA OF POWER AND SIGNAL CONTACTS
- ④ MECHANICAL CONNECTOR KEEP OUT ZONE
- ⑤ DATUM AND BASIC DIMENSIONS ESTABLISHED BY CUSTOMER
- ⑥ PCB - ALL HOLE DIAMETERS ARE FINISHED HOLE SIZES
- ⑦ PCB - .0453 ± .0010 DRILLED HOLES PLATED WITH .0003 MIN Sn OVER .001 TO .003 CU PLATING TO ACHIEVE A .040 ± .003 DIA HOLE
- ⑧ DIM W & DIM R ARE APPLICABLE TO P+S+P CONFIGURATION.
- ⑨ FOR P/N 6450850-3, -11, THE VARIABLE DIMENSIONS PLEASE SEE SHEET 2.
- ⑩ VARIABLE DIMENSIONS SHOW ON TABLE OR PART VIEW

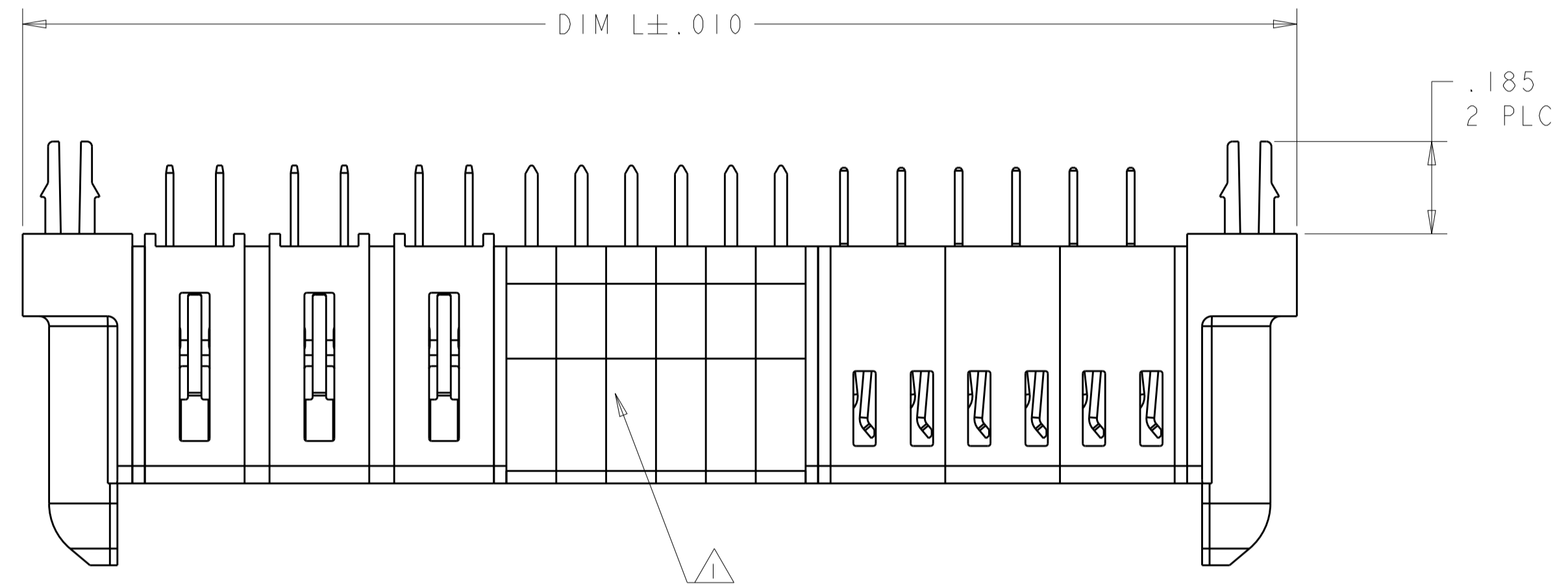
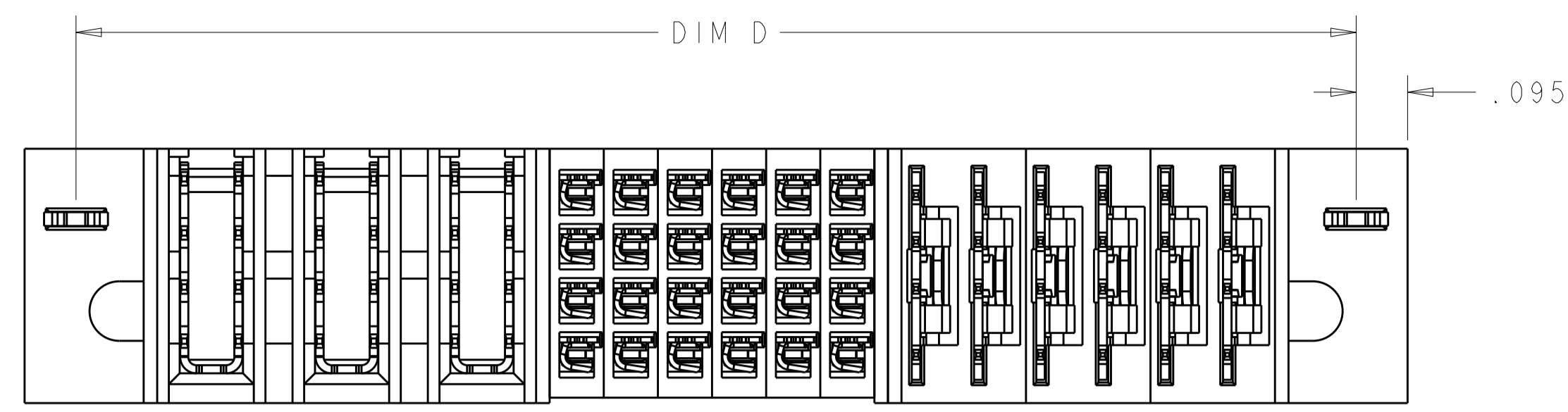
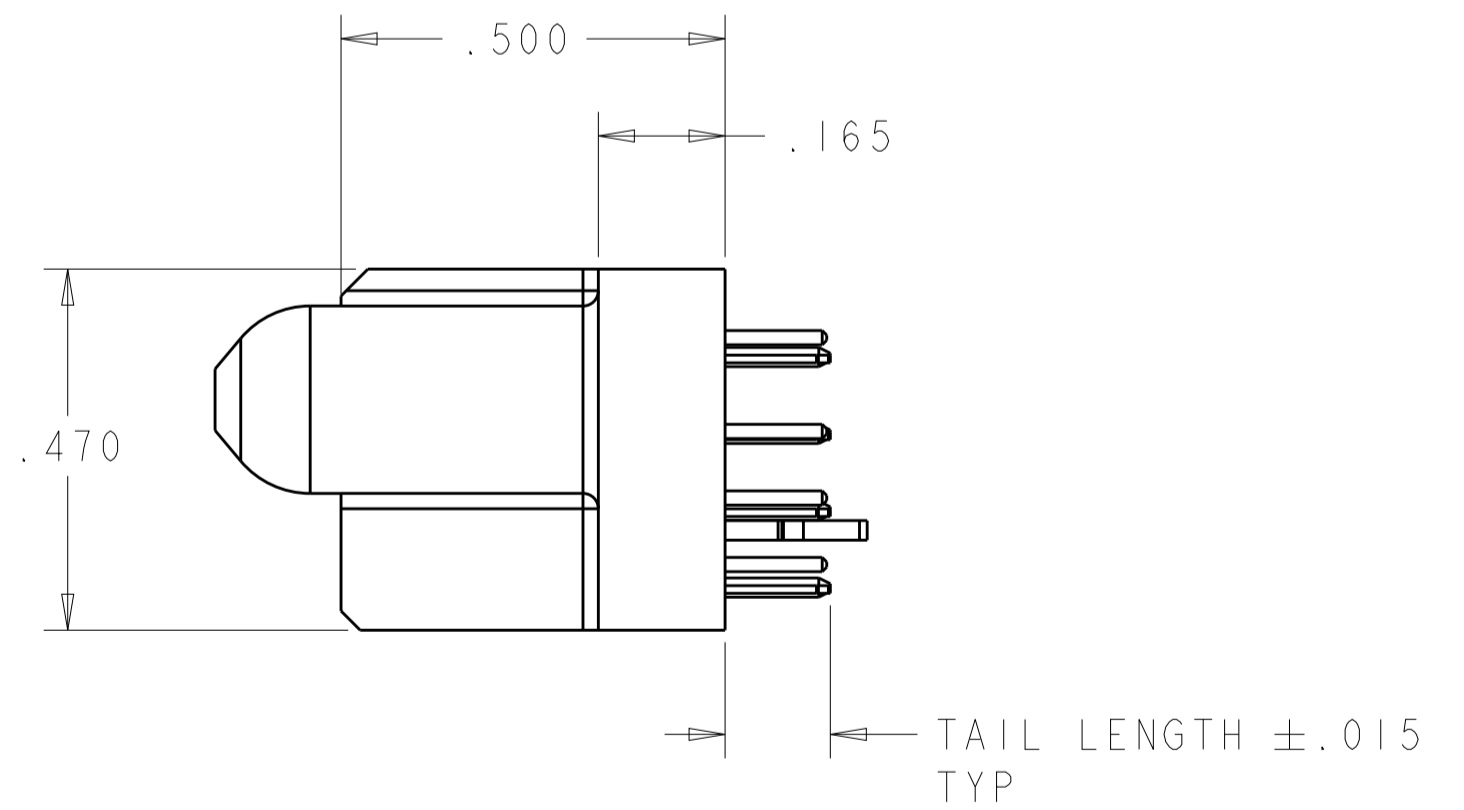

THIS DRAWING IS A CONTROLLED DOCUMENT.		DWN S. ZHAO CHK S. ZHAO	20SEP2007	TE Connectivity
DIMENSIONS: INCHES		APVD S. YAO		
		TOLERANCES UNLESS OTHERWISE SPECIFIED: 0 PLC ±. 1 PLC ±.01 2 PLC ±.01 3 PLC ±.005 4 PLC ±.0020 ANGLES ±.7°		NAME VERTICAL RECEPTACLE ASSEMBLY, WITH GUIDES MULTI-BEAM XLE
MATERIAL		PRODUCT SPEC 108-1973 APPLICATION SPEC 114-13038		SIZE CAGE CODE DRAWING NO A100779C=6450850
FINISH		WEIGHT		RESTRICTED TO
CUSTOMER DRAWING		SCALE 4:1		SHEET 1 OF 8 REV F

LOC	DIST	REVISIONS					
		P	LTN	DESCRIPTION	DATE	DWN	APVD
ES	00	-	-	SEE SHEET 1	-	-	-

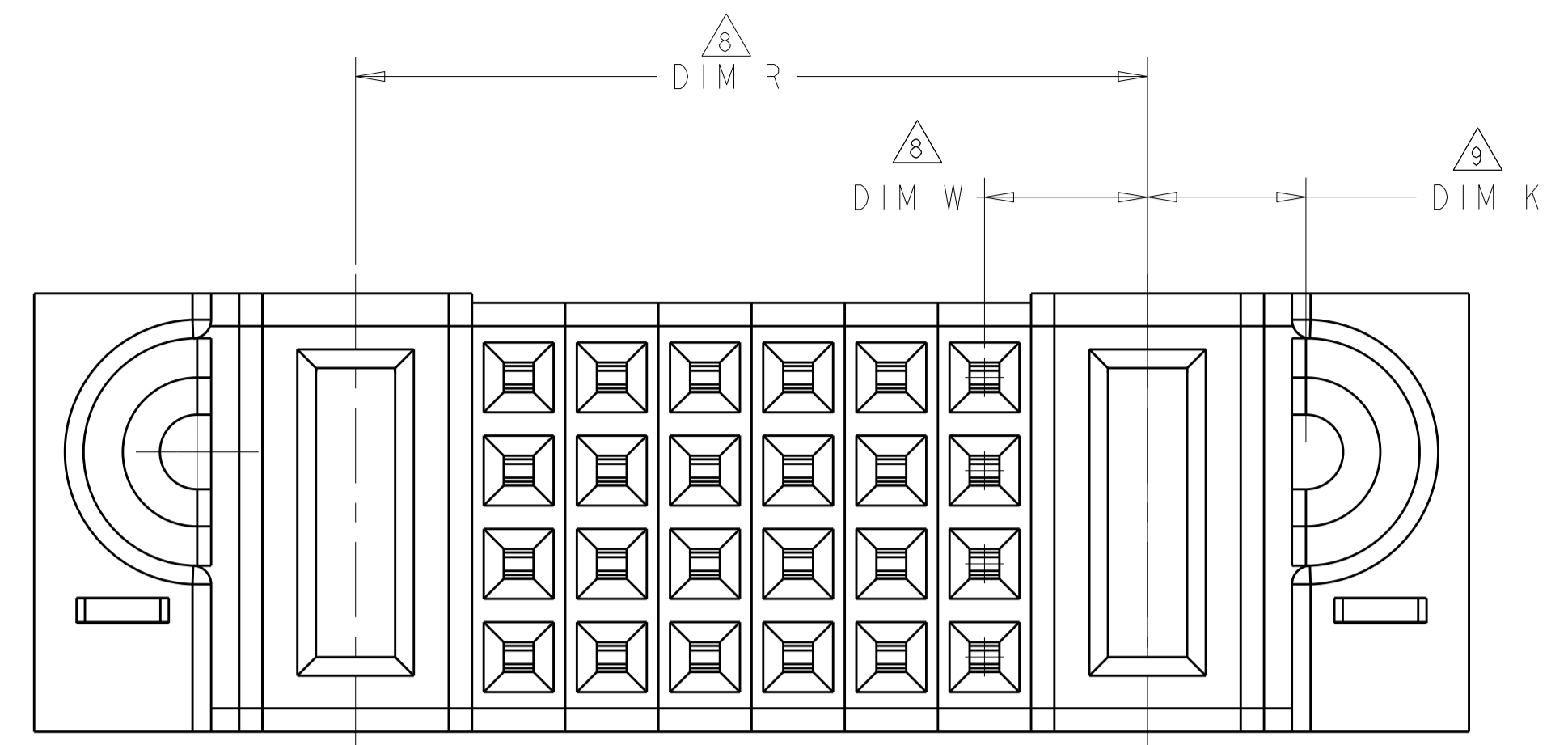

FOR P/N 6450850-3, -11, THE OTHER DIMENSIONS PLEASE SEE THE TABLE OF SHEET 1.

Δ	Δ	2.1275	1.1025	4.590	4.240	4.400	.1025	9LP + 36S + IP + 16LP	2-6450850-2
.300	.250	1.275	.800	2.490	2.140	2.300	.195	3ACP + 16S + 3P	2-6450850-1
.230	.230	1.090	.7825	1.990	1.640	1.800	.1025	3LP + 12S + 4LP	2-6450850-0
.250	.250	1.150	.675	2.340	1.990	2.150	.170	3P + 16S + 3P	1-6450850-9
Δ	Δ	Δ	Δ	3.270	2.920	3.080	.170	5HDP + 24S + IP + 7LP	1-6450850-8
-	-	.500	.200	1.140	.790	.950	.145	IP + 8S + IP	1-6450850-7
.300	.250	1.250	.775	2.940	2.590	2.750	.170	3ACP + 16S + 5P	1-6450850-6
.200	.200	.800	.350	1.840	1.490	1.650	.145	2P + 16S + 3P	1-6450850-4
.250	.250	1.300	.925	2.740	2.390	2.550	.170	4P + 12S + 4P	1-6450850-3
-	-	.850	.175	1.540	1.190	1.350	.170 Δ	IP + 24S + IP	1-6450850-1
-	-	.850	.175	1.540	1.190	1.350	.170 Δ	IP + 24S + IP	6450850-3
.230	.250	1.4075	.7325	2.555	2.205	2.365	.1275	6LP + 24S + 3P	6450850-2
DIM T	DIM S	DIM R Δ	DIM W Δ	DIM L	DIM U	DIM D	DIM K	DESCRIPTION	PART NUMBER

THIS DRAWING IS A CONTROLLED DOCUMENT. DWN S.ZHAO 20SEP2007
 CHK S.ZHAO 20SEP2007

DIMENSIONS: INCHES. TOLERANCES UNLESS OTHERWISE SPECIFIED:
 0 PLC ±.01
 1 PLC ±.01
 2 PLC ±.01
 3 PLC ±.005
 4 PLC ±.0020
 ANGLES ±.7°

MATERIAL: FINISH:

APVD S.YAO

PRODUCT SPEC: 108-1973
 APPLICATION SPEC: 114-13038

WEIGHT: CUSTOMER DRAWING

NAME: VERTICAL RECEPTACLE ASSEMBLY, WITH GUIDES MULTI-BEAM XLE

SIZE: A1 CAGE CODE: 00779 DRAWING NO: 6450850

RESTRICTED TO: SCALE: 4:1 SHEET 2 OF 8 REV F

STE TE Connectivity

LOC		DIST		REVISIONS				
ES	00	P	LTN	DESCRIPTION	DATE	DWN	APVD	
		-		SEE SHEET 1				

PART NUMBER	ROWS	POWER			SIGNAL					POWER						
		P3	P2	P1	6	5	4	3	2	1	LP6	LP5	LP4	LP3	LP2	LP1
6450850-2	D C B A	VM	VM	VM	E	E	E	E	E	E	E	LM	LM	LM	LM	LM
6LP + 24S + 3P																

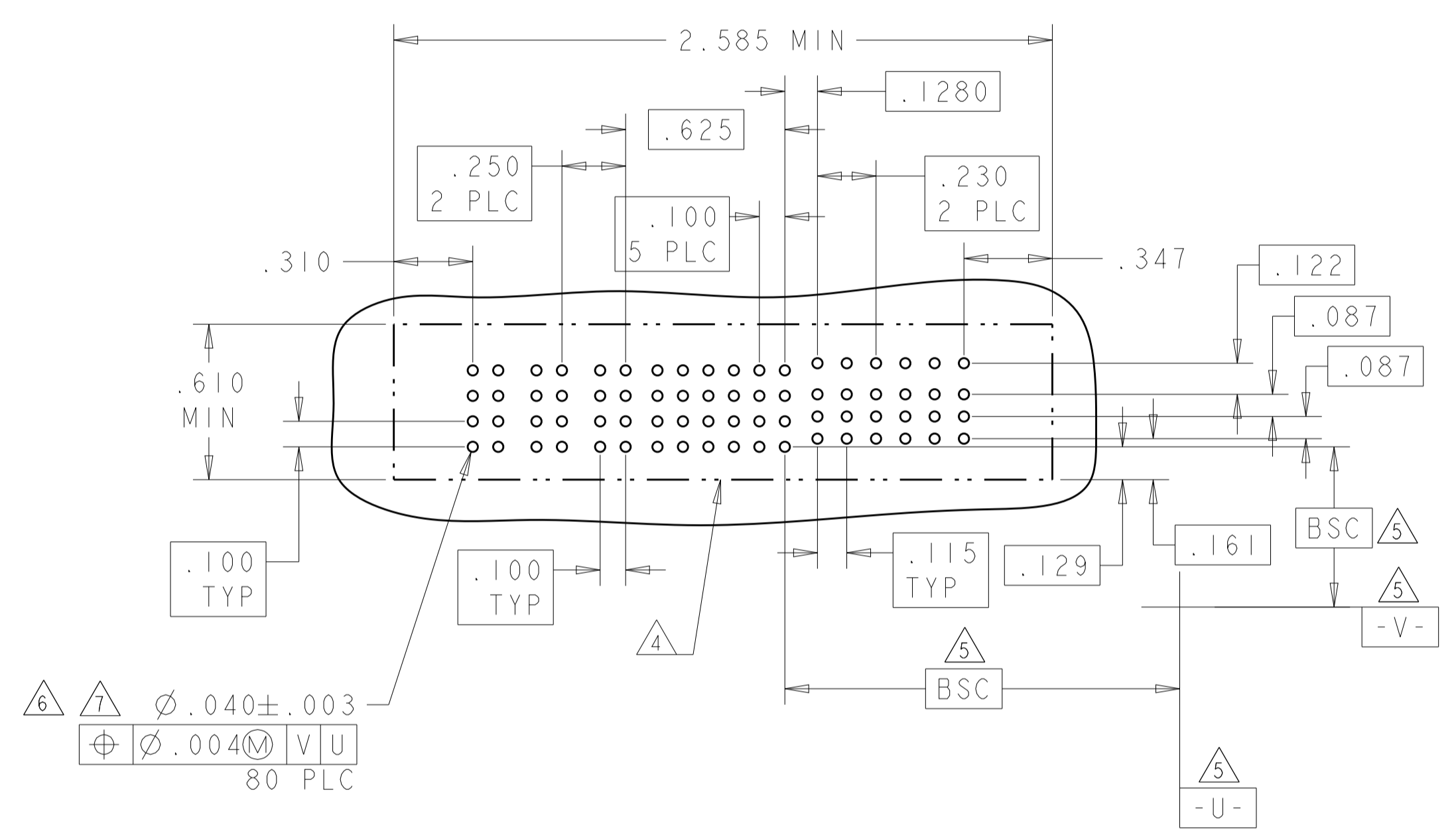

PART NUMBER	ROWS	POWER		SIGNAL					POWER			
		P2	P1	6	5	4	3	2	1	P1	P2	
6450850-3	D C B A	VM	VM	E	E	E	E	E	E	E	VM	VM
IP + 24S + IP												

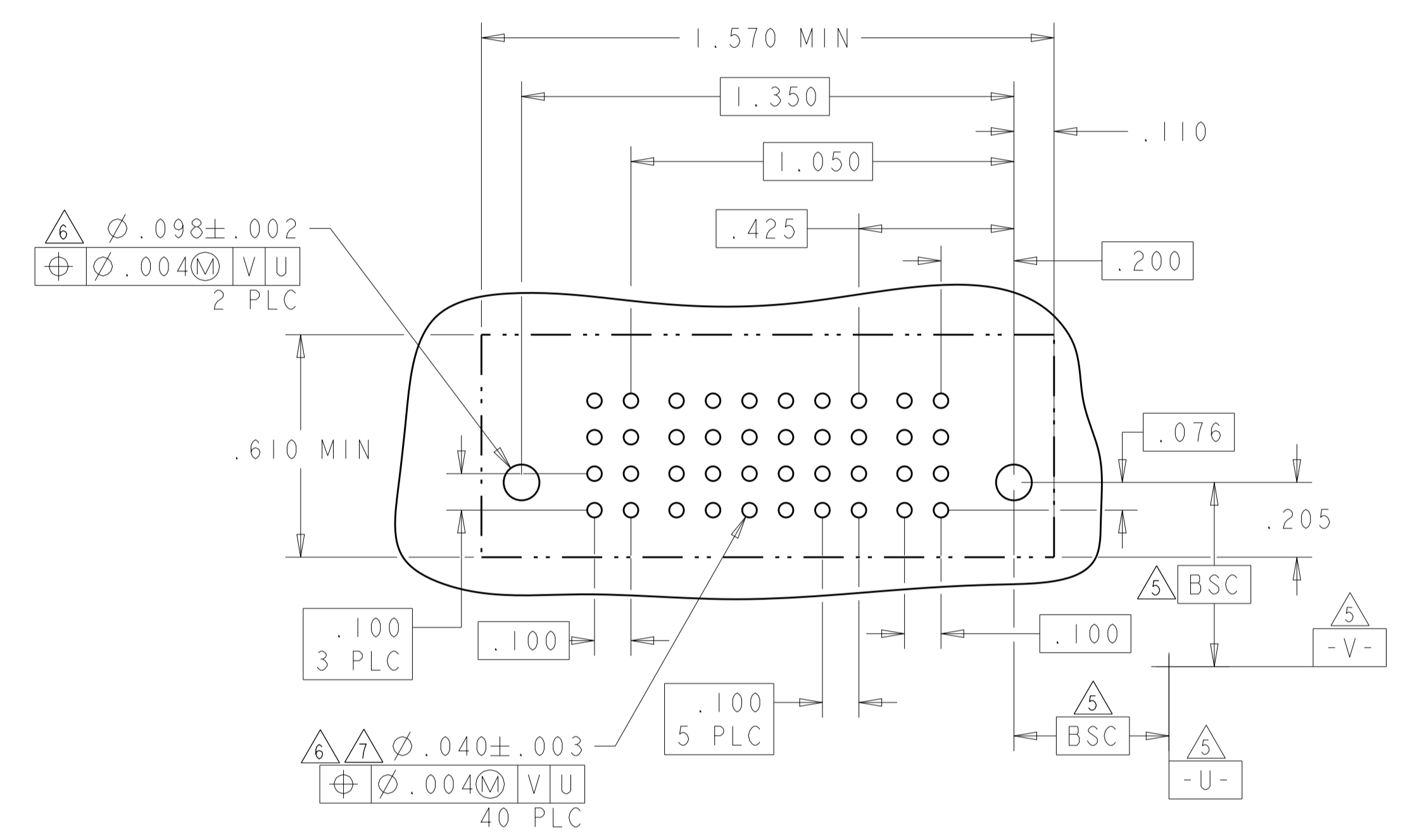

PART NUMBER	ROWS	POWER		SIGNAL					POWER			
		P2	P1	6	5	4	3	2	1	P1	P2	
1-6450850-1	D C B A	VM	VA	E	E	E	E	E	E	E	VA	VA
IP + 24S + IP												

LAYOUT OF 1-6450850-1 IS SAME AS 6450850-3.

LM	LOW POWER CONTACT .135" TAIL LENGTH
M	SIGNAL CONTACT .165" TAIL LENGTH
E	SIGNAL CONTACT .135" TAIL LENGTH
VO	POWER CONTACT, STD.165" TAIL LENGTH
VA	POWER CONTACT, MFBL.135" TAIL LENGTH
VM	POWER CONTACT, STD.135" TAIL LENGTH
CODE	DESCRIPTION
CONTACTS	

THIS DRAWING IS A CONTROLLED DOCUMENT.

DIMENSIONS: INCHES	TOLERANCES UNLESS OTHERWISE SPECIFIED:	DWN S. ZHAO 20SEP2007	CHK S. ZHAO 20SEP2007	APVD S. YAO	NAME
0 PLC ±	1 PLC ±.01	S. ZHAO			VERTICAL RECEPTACLE ASSEMBLY, WITH GUIDES
3 PLC ±.005	4 PLC ±.0020	S. YAO			MULTI-BEAM XLE
ANGLES ±.020	FINISH	PRODUCT SPEC 108-1973	APPLICATION SPEC 114-13038	SIZE CAGE CODE DRAWING NO	RESTRICTED TO
MATERIAL		WEIGHT	114-13038	A100779	6450850
CUSTOMER DRAWING		SCALE 4:1	SHEET 3 OF 8	REV F	

STE TE Connectivity

LOC	DIST	REV	DATE	BY	APPD
ES	00				

REVISIONS					
REV	DATE	BY	APPD	DESCRIPTION	DATE
-	-	-	-	SEE SHEET 1	-

PART NUMBER	ROWS	POWER				SIGNAL			POWER			
		P8	P7	P6	P5	3	2	1	P4	P3	P2	P1
I-6450850-3	D					E	E	E				
	C					E	E	E				
	B	VM	VM	VM	VM	E	E	E	VM	VM	VM	VM
	A	HD				E	E	E				HD

4P + 12S + 4P

PART NUMBER	ROWS	POWER			SIGNAL				POWER	
		P5	P4	P3	4	3	2	1	P2	P1
I-6450850-4	D				E	E	E	E		
	C				E	E	E	E		
	B	VM	VM	VM	E	E	E	E	VM	VM
	A	HD			E	E	E	E		HD

2HDP + 16S + 3HDP

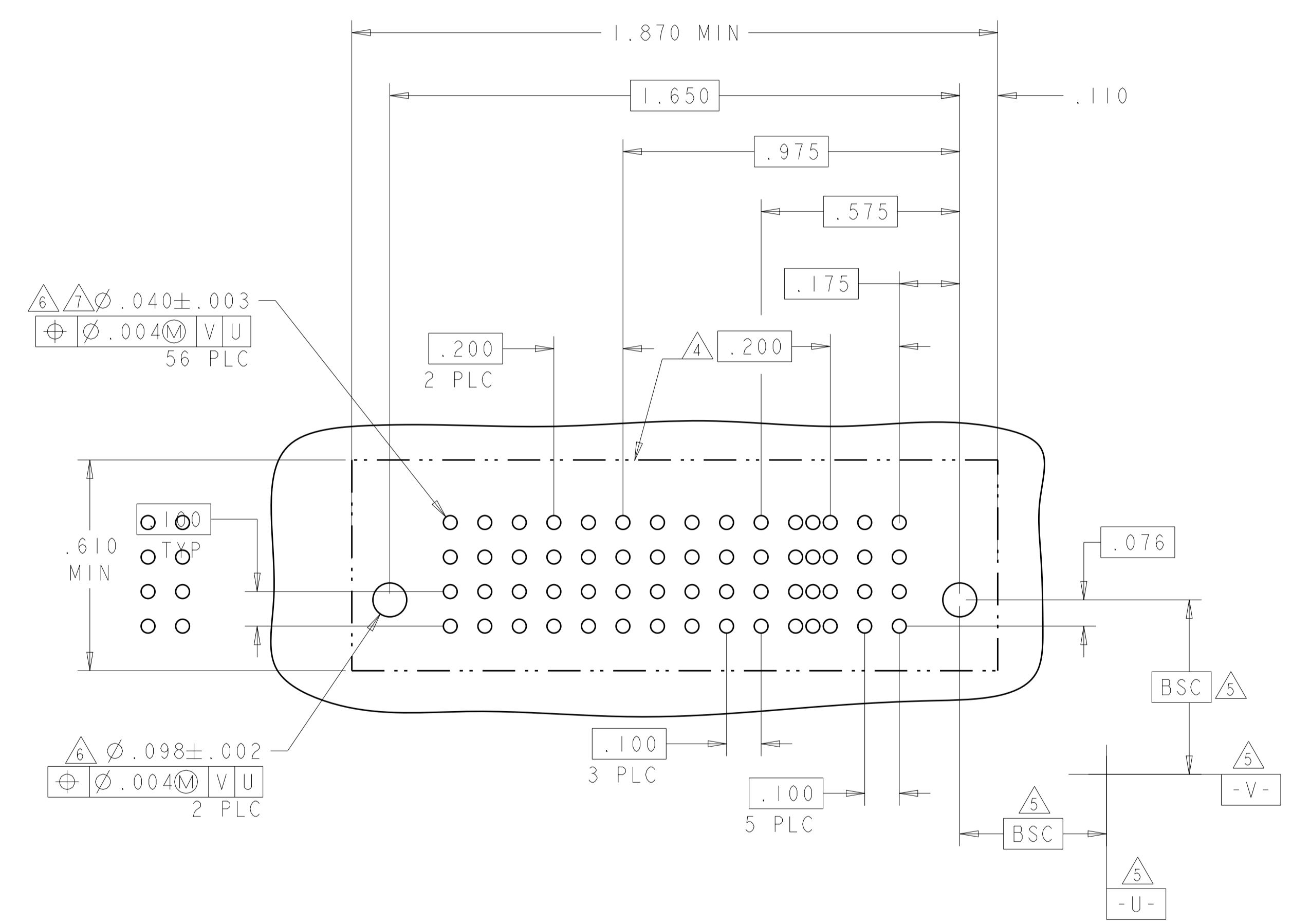
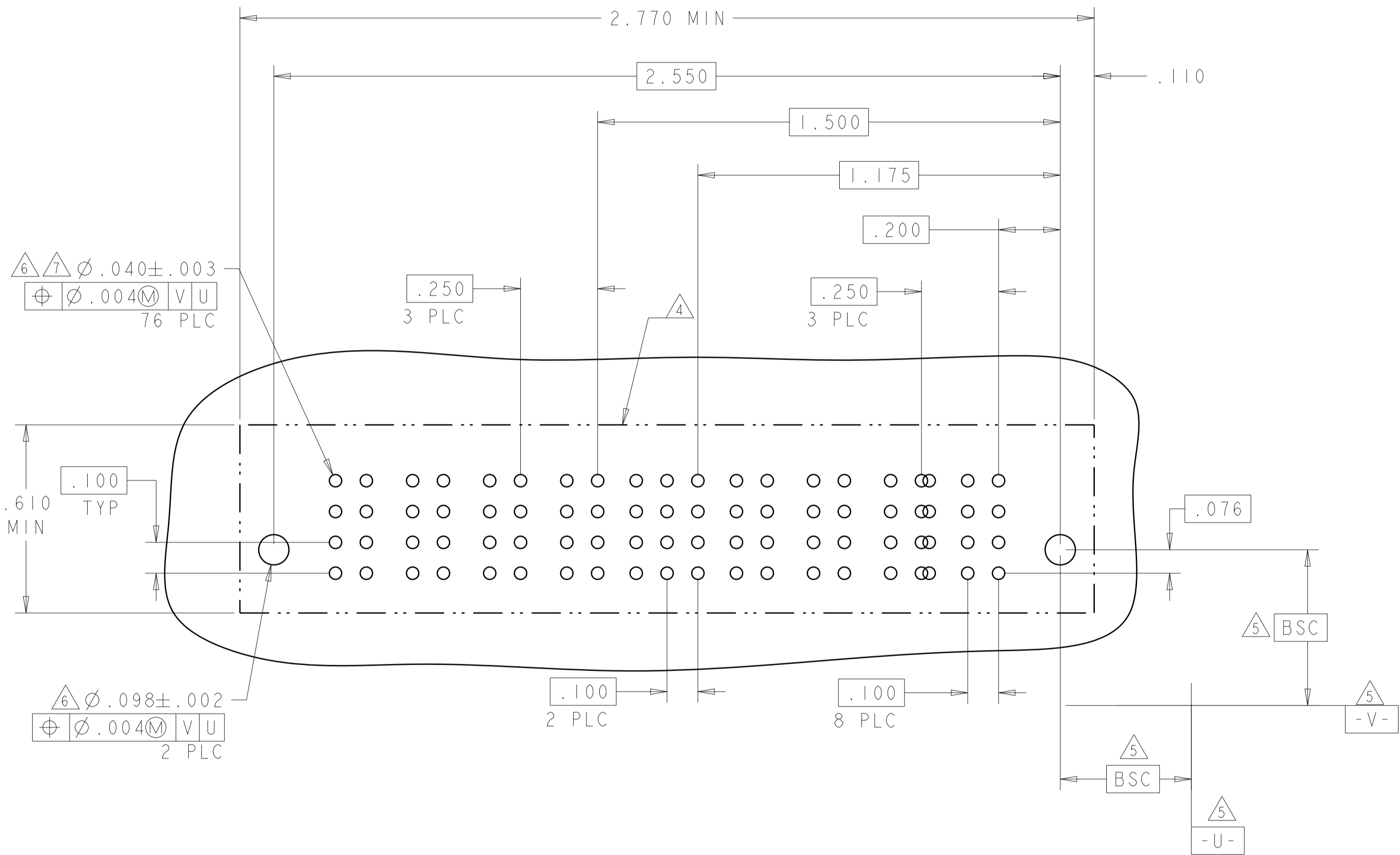

THIS DRAWING IS A CONTROLLED DOCUMENT.		OWN: S. ZHAO 20SEP2007	TE Connectivity
DIMENSIONS: INCHES		CHK: S. ZHAO 20SEP2007	
TOLERANCES UNLESS OTHERWISE SPECIFIED:		APVD: S. YAO	NAME: VERTICAL RECEPTACLE ASSEMBLY, WITH GUIDES MULTI-BEAM XLE
0 PLC ±	1 PLC ±.01	PRODUCT SPEC 108-1973	SIZE: CAGE CODE DRAWING NO. RESTRICTED TO
2 PLC ±.01	3 PLC ±.005	APPLICATION SPEC 114-13038	A100779C=6450850
4 PLC ±.0020	ANGLES ±.2°	WEIGHT	SCALE: 4:1 SHEET 4 OF 8 REV F
MATERIAL	FINISH	CUSTOMER DRAWING	

LOC		DIST		REVISIONS			
ES	00	P	LTN	DESCRIPTION	DATE	DMN	APVD
-	-	-	-	SEE SHEET 1	-	-	-

PART NUMBER	ROWS	POWER					SIGNAL				POWER		
		P8	P7	P6	P5	P4	4	3	2	1	P3	P2	P1
1-6450850-6	D						E	E	E	E			
	C	VA	VM	VM	VM	VA	E	E	E	E	VM	VM	VA
	B						E	E	E	E			
	A	HD					E	E	E	E			HD

3ACP + 16S + 5P

PART NUMBER	ROWS	POWER		SIGNAL		POWER	
		P2	2	1	P1		
1-6450850-7	D			E	E		
	C	VM		E	E	VM	
	B			E	E		
	A	HD		E	E	HD	

IP + 8S + IP

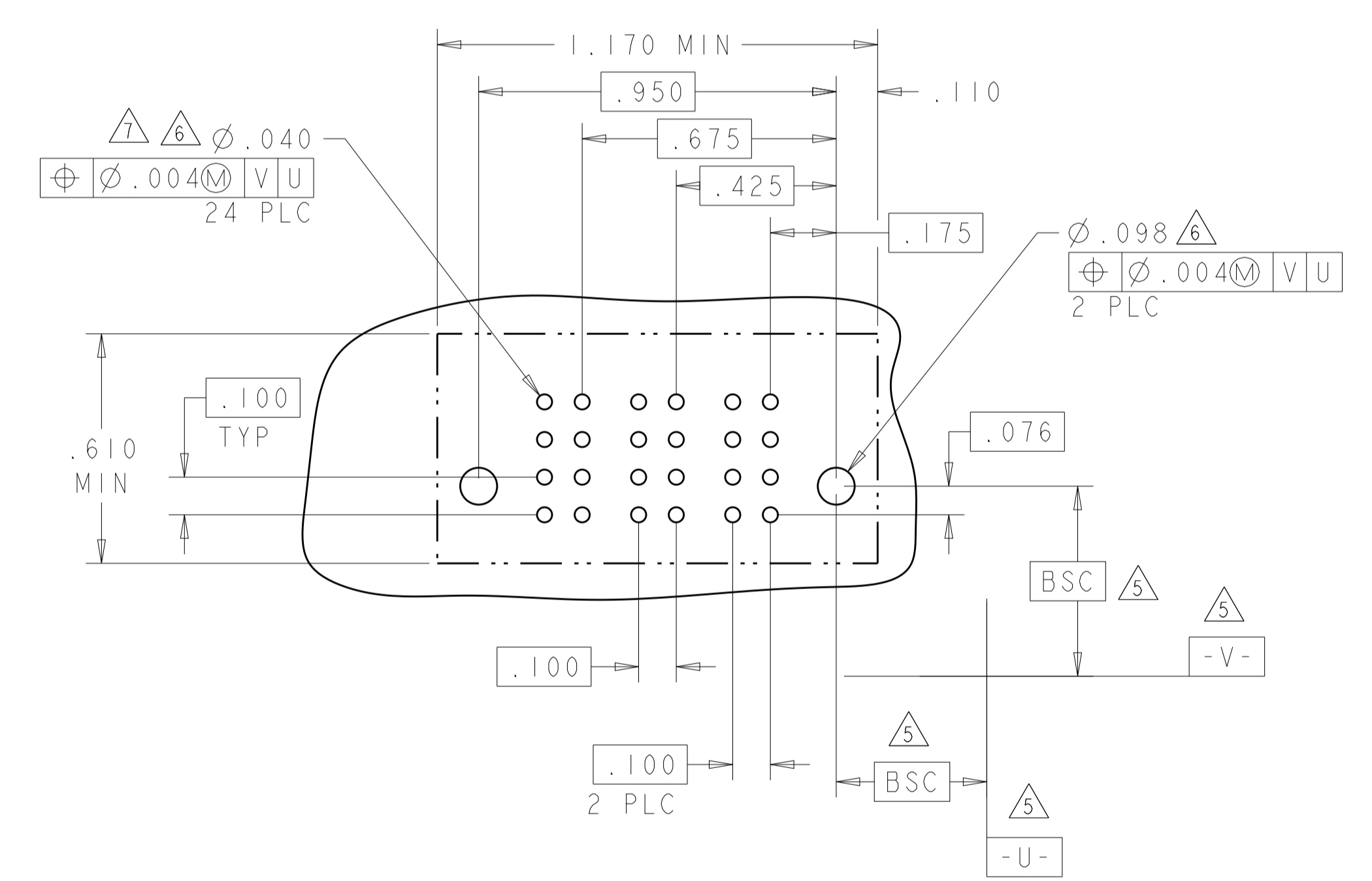
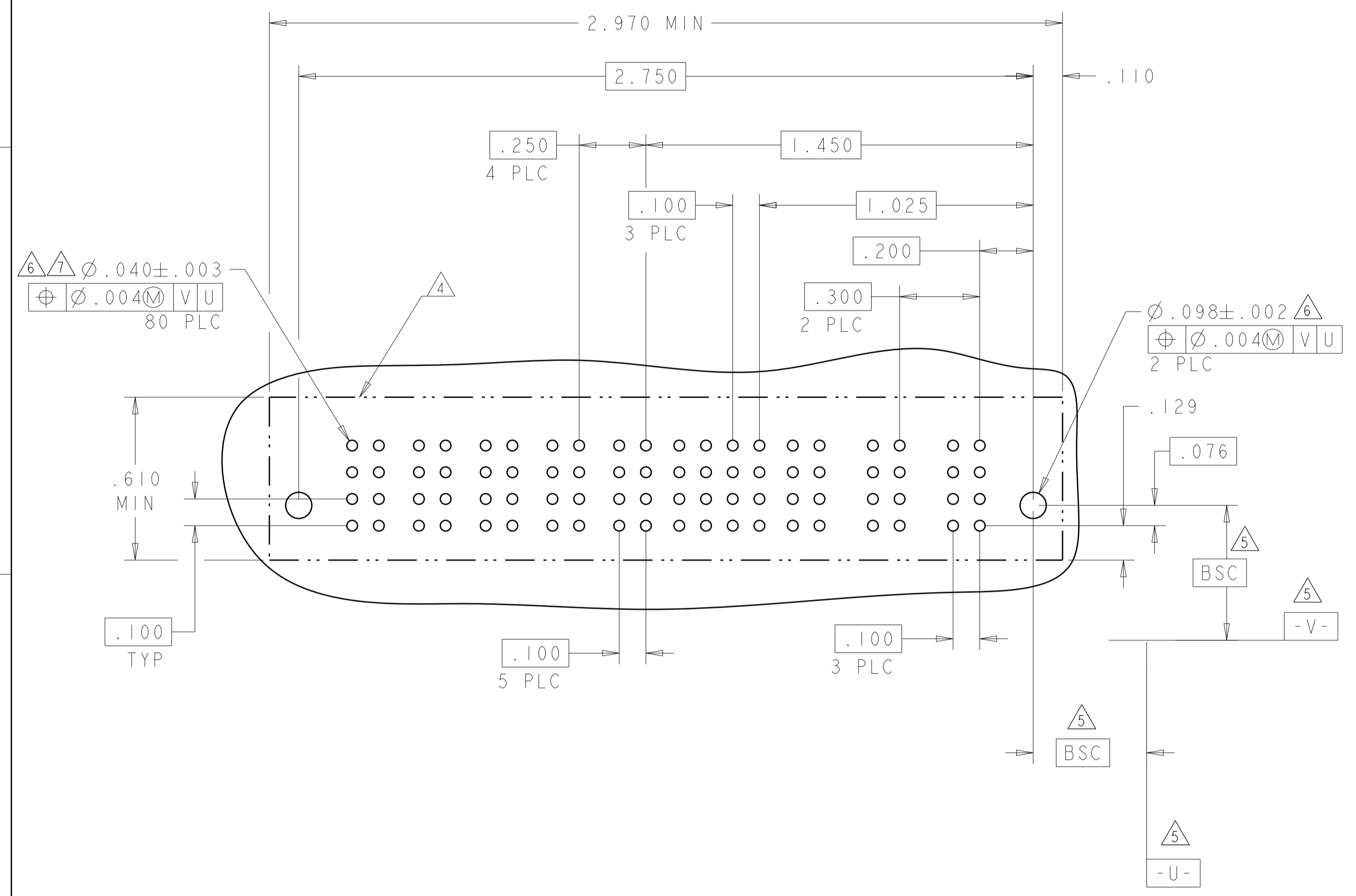

THIS DRAWING IS A CONTROLLED DOCUMENT.		DMN S. ZHAO 20SEP2007	TE Connectivity
DIMENSIONS: INCHES		CHK S. ZHAO 20SEP2007	
TOLERANCES UNLESS OTHERWISE SPECIFIED:		APVD S. YAO	NAME VERTICAL RECEPTACLE ASSEMBLY, WITH GUIDES MULTI-BEAM XLE
0 PLC ±.01	1 PLC ±.01	PRODUCT SPEC 108-1973	SIZE CAGE CODE DRAWING NO RESTRICTED TO
2 PLC ±.01	3 PLC ±.005	APPLICATION SPEC 114-13038	A100779C=6450850
4 PLC ±.0020	ANGLES ±.020	WEIGHT	SCALE 4:1 SHEET 5 OF 8 REV F
MATERIAL	FINISH	CUSTOMER DRAWING	

LOC		DIST		REVISIONS				
ES	00	P	LTN	DESCRIPTION	DATE	DWN	APVD	
				SEE SHEET 1				

PART NUMBER	ROWS	LOW POWER						POWER	SIGNAL						POWER				
		LP7	LP6	LP5	LP4	LP3	LP2	LP1	P6	6	5	4	3	2	1	P5	P4	P3	P2
I-6450850-8	D								E	E	E	E	E	E					
	C	LM	LM	LM				VA	E	E	E	E	E	E	VM	VM			
	B								E	E	E	E	E	E					
5HDP + 24S + 1P + 7LP		A	HD						E	E	E	E	E	E					HD

NO CONTACTS LOADED

PART NUMBER	ROWS	POWER			SIGNAL				POWER		
		P6	P5	P4	4	3	2	1	P3	P2	P1
I-6450850-9	D				E	E	E	E			
	C	VM	VM	VM	E	E	E	E	VM	VM	VM
	B				E	E	E	E			
3P + 16S + 3P		A	HD		E	E	E	E			HD

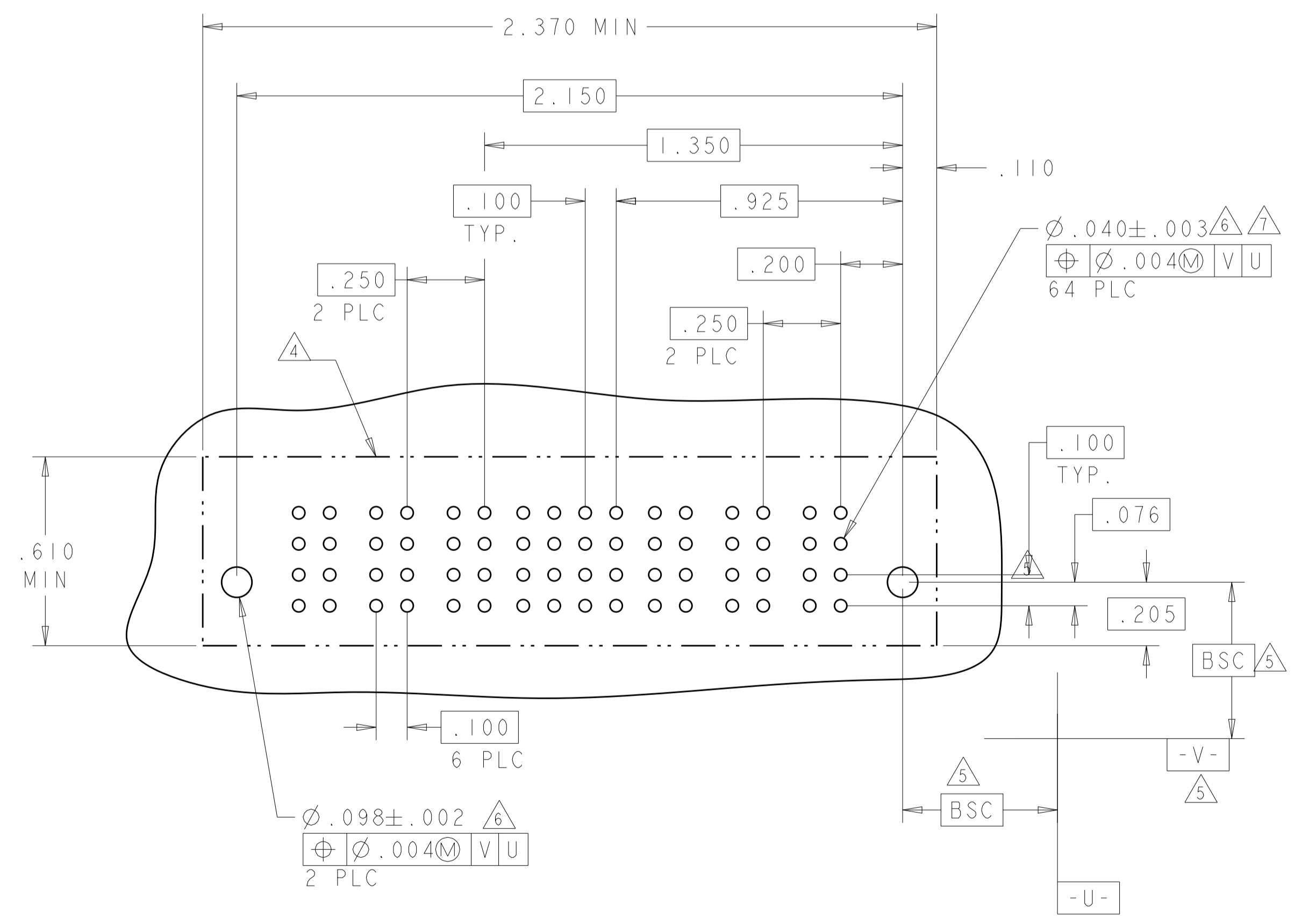
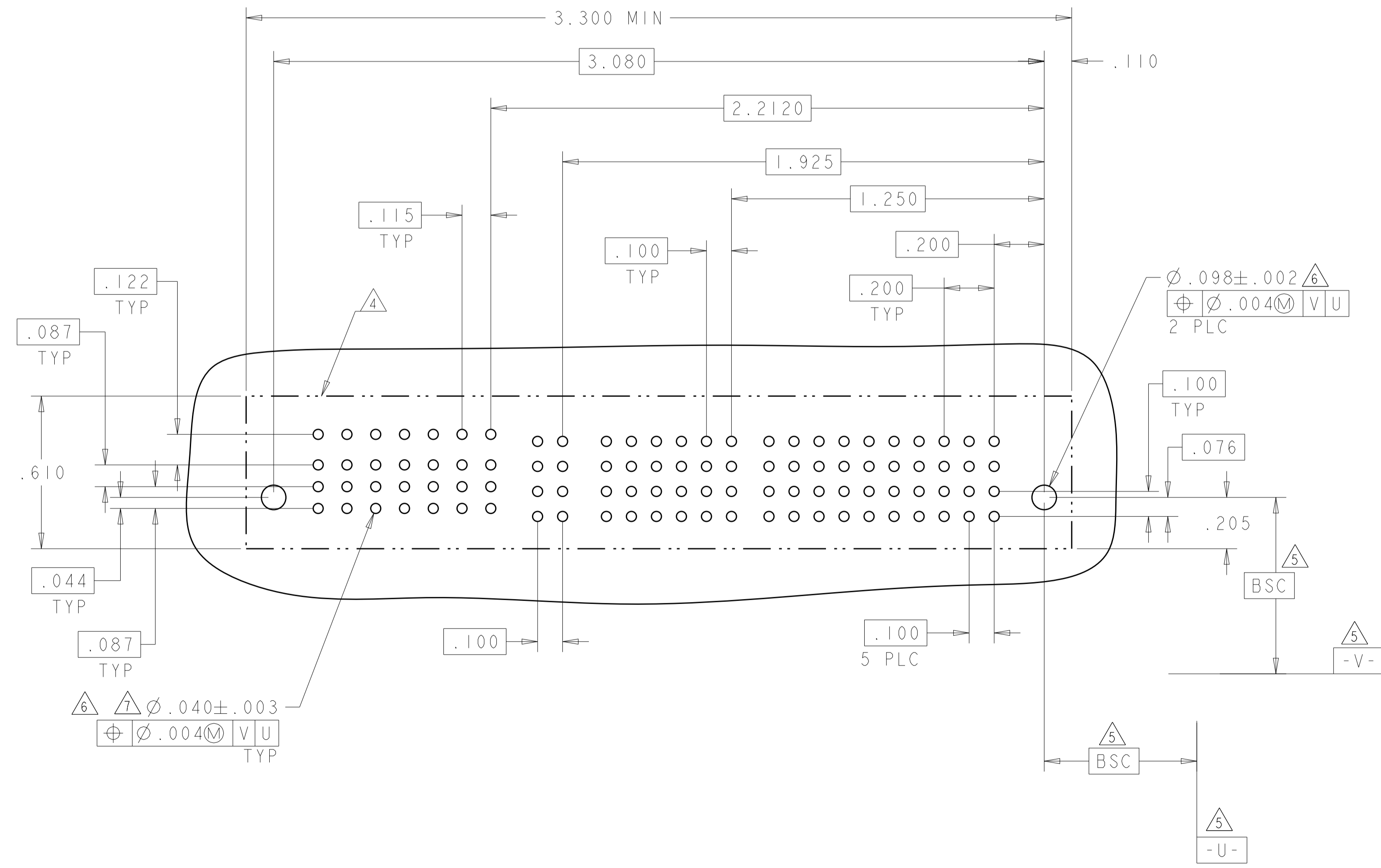
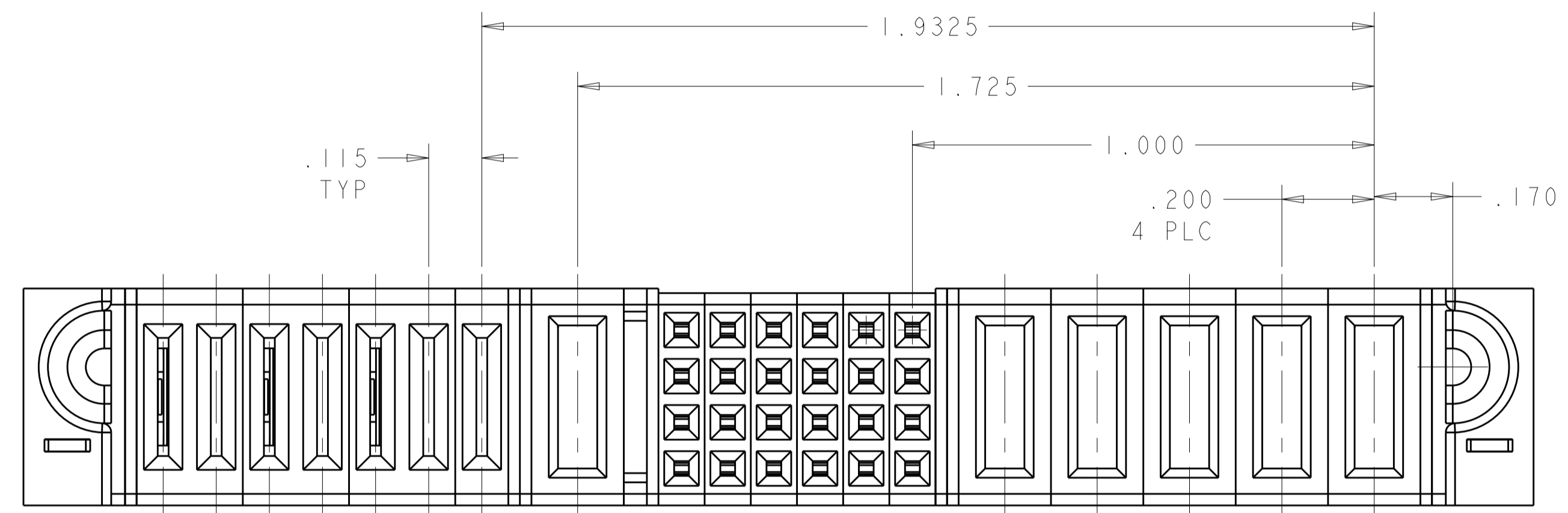

THIS DRAWING IS A CONTROLLED DOCUMENT.		DWN S. ZHAO 20SEP2007		TE Connectivity	
DIMENSIONS: INCHES		CHK S. ZHAO 20SEP2007		NAME VERTICAL RECEPTACLE ASSEMBLY, WITH GUIDES MULTI-BEAM XLE	
TOLERANCES UNLESS OTHERWISE SPECIFIED:		APVD S. YAO	PRODUCT SPEC		
0 PLC ±.01			108-1973		
1 PLC ±.01			APPLICATION SPEC		
2 PLC ±.005			114-13038		
3 PLC ±.0020			WEIGHT		
4 PLC ±.0020			CUSTOMER DRAWING		
5 PLC ±.0020			SCALE 4:1		
6 PLC ±.0020			SHEET 6 OF 8		
7 PLC ±.0020			REV F		

LOC	DIST	REVISIONS			
P	LTN	DESCRIPTION	DATE	DMN	APVD
ES	00	SEE SHEET 1			

PART NUMBER	ROWS	LOW POWER				SIGNAL			LOW POWER		
		LP7	LP6	LP5	LP4	3	2	1	LP3	LP2	LP1
2-6450850-0	D					E	E	E			
	C					E	E	E			
	B					E	E	E			
	A	LM	LM	LM	LM	E	E	E	LM	LM	LM
		HD									HD
3LP + 12S + 4LP											

PART NUMBER	ROWS	POWER			SIGNAL				POWER		
		P6	P5	P4	4	3	2	1	P3	P2	P1
2-6450850-1	D				E	E	E	E			
	C				E	E	E	E			
	B				E	E	E	E			
	A	VA	VM	VA	E	E	E	E	VM	VM	VA
		HD									HD
3ACP + 16S + 3P											

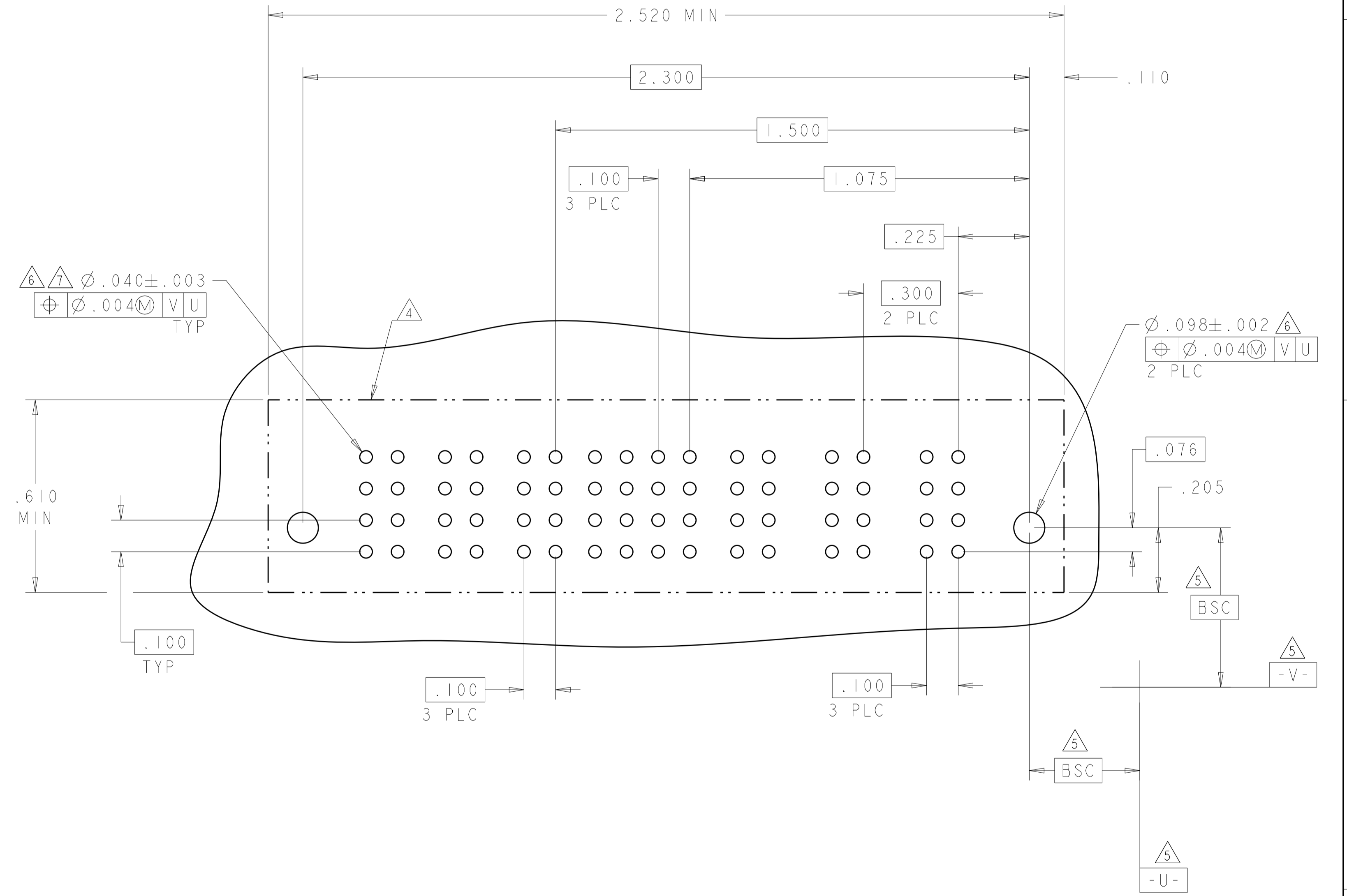
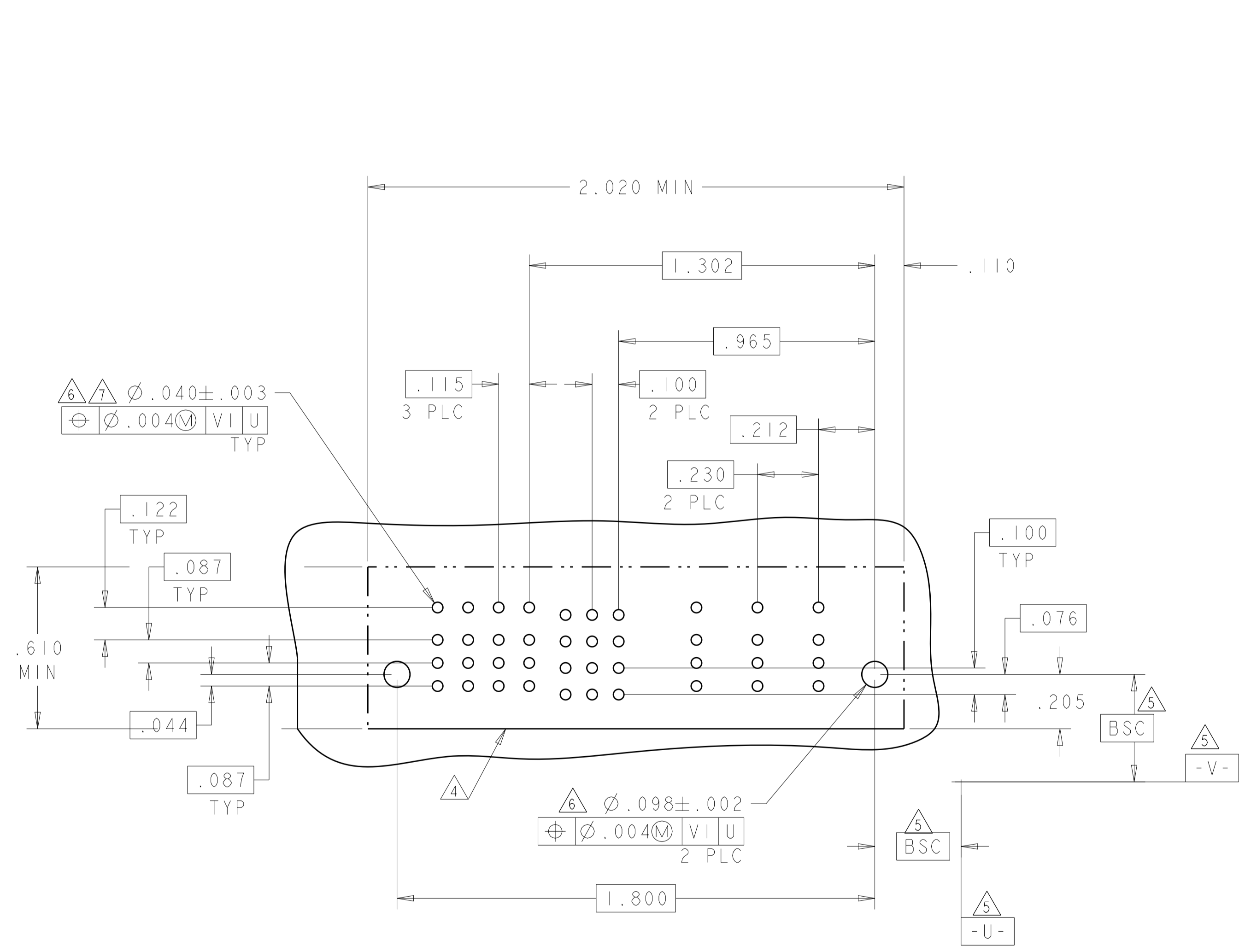

THIS DRAWING IS A CONTROLLED DOCUMENT.		DMN S. ZHAO 20SEP2007	 TE Connectivity
DIMENSIONS: INCHES		CHK S. ZHAO 20SEP2007	
TOLERANCES UNLESS OTHERWISE SPECIFIED:		APVD S. YAO	NAME
0 PLC ±		PRODUCT SPEC	VERTICAL RECEPTACLE ASSEMBLY, WITH GUIDES
1 PLC ±.01		APPLICATION SPEC	MULTI-BEAM XLE
2 PLC ±.01		WEIGHT	SIZE CAGE CODE DRAWING NO RESTRICTED TO
3 PLC ±.005		114-13038	A100779C=6450850
4 PLC ±.0020		CUSTOMER DRAWING	SCALE 4:1 SHEET 7 OF 8 REV F
ANGLES ±.2°			
FINISH			

LOC		DIST		REVISIONS			
ES	00	P	LTN	DESCRIPTION	DATE	DWN	APVD
				SEE SHEET 1			

PART NUMBER	ROWS	LOW POWER														POWER	SIGNAL								LOW POWER																				
		LP25	LP24	LP23	LP22	LP21	LP20	LP19	LP18	LP17	LP16	LP15	LP14	LP13	LP12		LP11	LP10	P1	9	8	7	6	5	4	3	2	1	LP9	LP8	LP7	LP6	LP5	LP4	LP3	LP2	LP1								
2-6450850-2	D																	VA	E	E	E	E	E	E	E	E	E																		
	C	LM	LM	LM	LM		LM	LM	LM	LM		LM	LM	LM	LM				E	E	E	E	E	E	E	E	E									LM	LM	LM	LM		LM	LM	LM	LM	
	B																		E	E	E	E	E	E	E	E	E																		
	A	HD																	E	E	E	E	E	E	E	E	E																		

NO CONTACTS LOADED (pointing to LP25-LP20)
 NO CONTACTS LOADED (pointing to LP19-LP10)
 NO CONTACT LOADED (pointing to P1)

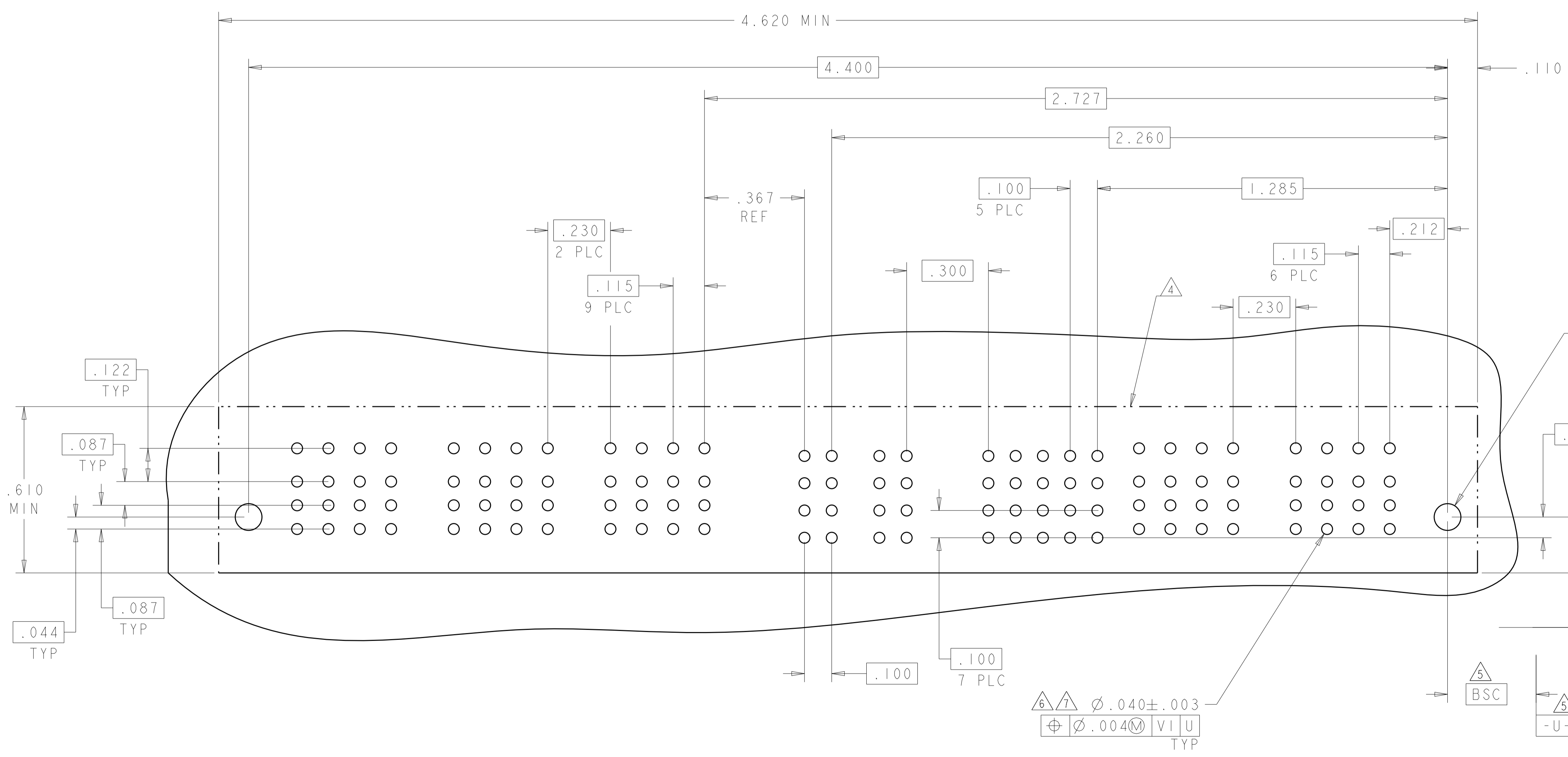
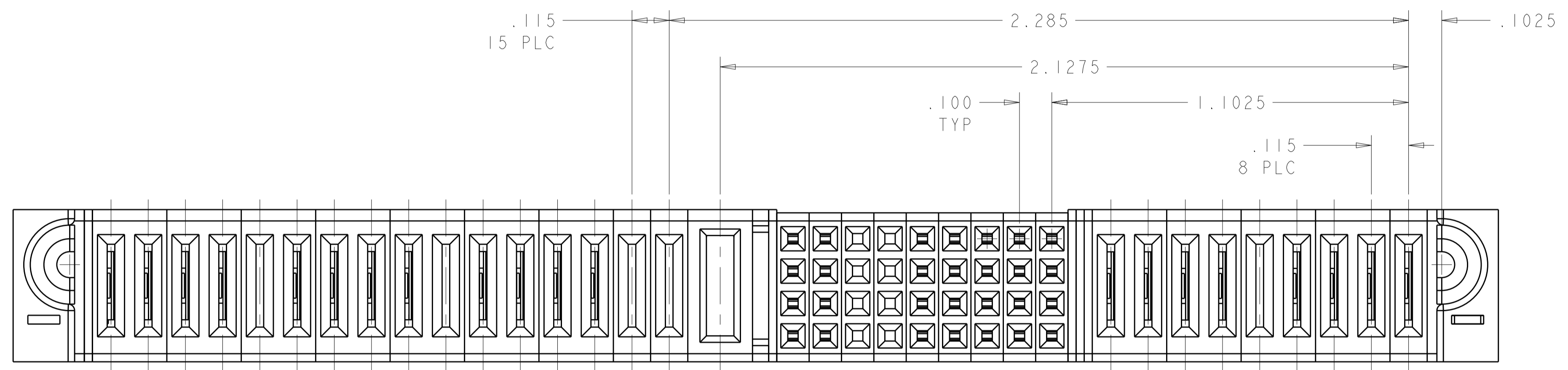

THIS DRAWING IS A CONTROLLED DOCUMENT.		DWN S. ZHAO 20SEP2007	TE Connectivity
DIMENSIONS: INCHES		CHK S. ZHAO 20SEP2007	
TOLERANCES UNLESS OTHERWISE SPECIFIED:		APVD S. YAO	NAME
0 PLC ±	1 PLC ±.01	PRODUCT SPEC	VERTICAL RECEPTACLE ASSEMBLY, WITH GUIDES
2 PLC ±.01	3 PLC ±.005	APPLICATION SPEC	MULTI-BEAM XLE
4 PLC ±.0020	ANGLES ±.020	SIZE CAGE CODE DRAWING NO	RESTRICTED TO
MATERIAL	FINISH	114-13038	A100779C=6450850
CUSTOMER DRAWING		SCALE 4:1	SHEET 8 OF 8 REV F

X-ON Electronics

Largest Supplier of Electrical and Electronic Components

Click to view similar products for [Heavy Duty Power Connectors](#) category:

Click to view products by [TE Connectivity](#) manufacturer:

Other Similar products are found below :

[1424439](#) [1424438](#) [09330062652](#) [2-8675P1](#) [605601-1](#) [6340G1](#) [6341G1](#) [6360G1](#) [6373G1](#) [6374g2](#) [6396G1](#) [647757-1](#) [66394-4](#) [6643411-1](#)
[6646058-2](#) [6646137-1](#) [6646138-1](#) [6646348-1](#) [6646479-1](#) [6646608-1](#) [6646786-1](#) [6646940-1](#) [6651091-1](#) [6651525-1](#) [6651529-1](#) [6651778-1](#)
[6651788-1](#) [696465-1](#) [696475-1](#) [73000005059](#) [73000005349](#) [73000005642](#) [73080255059](#) [73080965046](#) [765-15-0080A](#) [765-16-0080B](#)
[789.700-44](#) [789.700-54](#) [80-1010](#) [80-9](#) [827381-1](#) [829992-1](#) [902-77-02113](#) [PL00U-301-10D10](#) [PM103MOOLOO](#) [PM16S1620S32-50](#)
[PM212MOOLOO](#) [PM309FOOLOO](#) [PM324FOOLCH](#) [PMHPAF11S03](#)