

## 73 72 180 KNIPEX TwinForce

### High Performance Diagonal Cutter



- ideal transmission of force due to double-hinged design
- extremely easy cutting with little strain: cuts again 50 % easier than the tried and tested KNIPEX high leverage diagonal cutters
- reliably cuts all types of wire, including steel tape
- for rough or very fine cutting
- low cutting impact: gentle on hands. The tension on muscles and tendons is relieved
- for comfortable cutting, repetitive cutting or extremely hard cutting jobs
- high degree of stability and zero-backlash due to precisely milled forged-in axles
- Chrome vanadium heavy-duty steel, forged, oil-hardened

#### NEW for diagonal cutters:

The option to reapply the tool. The KNIPEX TwinForce cuts even 4 mm thick wire without great effort when reapplied two or three times. Conventional high leverage diagonal cutters either cannot cut these diameters or only with very great effort.

No.73 72 180

EAN4003773074779

- 5,5∅ mm
- 4,6∅ mm
- 3,2∅ mm
- 3∅ mm
- 304g
- 280g
- 180mm





●



●

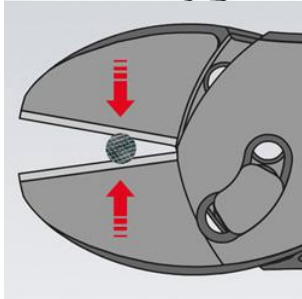

●

Insert the wires as close to the hinge as possible. In case of cutters with very high transmission, the width of the gap between the cutting edges close to the fulcrum may be less than the thickness of the wire. Wires may slip forward when the cutting starts.

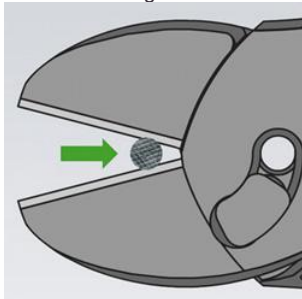

●

First make a notch in the wire using the KNIPEX TwinForce until the required hand force increases considerably. Now open the pliers and slide the wire backwards towards the joint. Hold the cutting edge in the notches you have made in step 1.

## X-ON Electronics

Largest Supplier of Electrical and Electronic Components

*Click to view similar products for [knipex manufacturer](#):*

Other Similar products are found below :

[00 21 41 LE](#) [70 01 160](#) [7006140](#) [70 07 160](#) [7902125](#) [86 03 300](#) [88 06 250](#) [92 22 13](#) [97 43 05](#) [97 49 08](#) [97 49 15](#) [98 03 09](#) [12 42 195](#) [97 52](#)  
[35](#) [98 03 11](#) [30 11 140](#) [34 12 130](#) [48 11 J1](#) [0301160](#) [09 02 240](#) [11 17 160](#) [64 62 120](#) [87 03 250](#) [00 20 16 P ESD](#) [00 20 18 ESD](#) [00 21 35 LE](#)  
[02 02 225](#) [97 91 01](#) [97 54 26](#) [97 49 24](#) [48 21 J21](#) [41 04 250](#) [49 11 A4](#) [49 21 A41](#) [95 32 320](#) [02 06 200](#) [92 27 62](#) [88 02 250](#) [79 52 125](#) [79 42](#)  
[125 ESD](#) [98 67 05](#) [95 36 315 A](#) [1301160](#) [12 80 040 SB](#) [77 32 120 H ESD](#) [78 91 125](#) [79 12 125](#) [81 11 250](#) [12 19 02](#) [67 01 200](#)