

No. 395 / TE5®

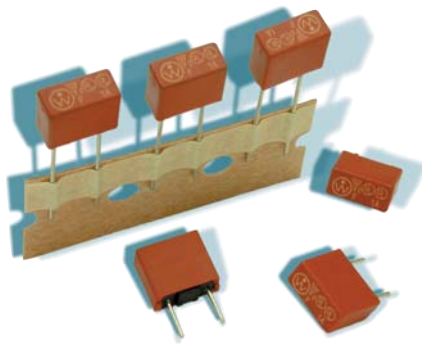

Dimensions (mm)

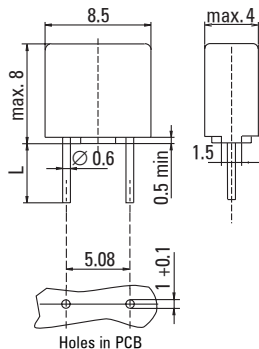

Long Leads (L=18.8 mm)
Short Leads (L=4.3 mm)

UL 248-14, 125 V, F

Time-Current Characteristic
Quick Acting (F)

Standard
UL 248-14
CSA C22.2 No. 248.14

Approvals
UL Listed
cUL Listed
METI-PSE

Features

- Reduced PCB space requirements
- Direct solderable or plug-in versions
- Internationally approved
- Low internal resistance
- Shocksafe casing
- Vibration resistant
- Halogen free

Specifications

Packaging

000: Tape/Ampompack (1,400 pcs.)
044: Short Leads - Bulk (1,400 pcs.)

Materials

Base/Cap: Brown Thermoplastic
Polyamide PA 6.6, UL 94V0
Round Pins: Copper, Sn plated

Operating Temperature

-40 °C to +85 °C (consider de-rating)

Climatic Category

-40 °C/+85 °C/21 days
(EN 60068-1,-2-1,-2-2,-2-78)

Stock Conditions

+10 °C to +60 °C
relative humidity ≤ 75 % yearly average,
without dew, maximum value for 30 days - 95 %

Vibration Resistance

24 cycles at 15 min. each (EN 60068-2-6)
10 - 60 Hz at 0.75 mm amplitude
60 - 2000 Hz at 10 g acceleration

Lead Pull Strength

10 N (IEC 60068-2-21)

Solderability

260 °C, ≤ 3 s (Wave)
350 °C, ≤ 3 s (Soldering iron)

Soldering Heat Resistance

260 °C, 10 s (IEC 60068-2-20)

Marking

Ⓢ, F, Current Rating, Approvals

Unit Weight

0.60 g (approx.)

Limits for Pre-arcing Time

| | | |
|------------------|----------------------|------------------------|
| Rated Current | 2.0 x I _N | 2.0 x I _N Ⓢ |
| 50 mA ... 6.30 A | < 60 s | < 5 s |



Permissible continuous operating current is ≤ 70 % at ambient temperature of 23 °C (73.4 °F).

| Rated Current | Amp Code | Voltage Rating | Breaking Capacity | Voltage Drop 1.0 x I _N Ⓢ max. (mV) | Power Dissipation 1.0 x I _N Ⓢ max. (mW) | Melting Integral 10 x I _N Ⓢ max. (A ² s) | Approvals | | |
|---------------|----------|----------------|-------------------|---|--|--|-----------|-----|----------|
| | | | | | | | UL | cUL | METI-PSE |
| 50mA | 0050 | 125V | | 1600 | 85 | 0.0001 | • | • | • |
| 63mA | 0063 | 125V | | 1300 | 85 | 0.00013 | • | • | • |
| 80mA | 0080 | 125V | | 1200 | 100 | 0.0002 | • | • | • |
| 100mA | 0100 | 125V | | 1100 | 110 | 0.0013 | • | • | • |
| 125mA | 0125 | 125V | | 1350 | 160 | 0.0019 | • | • | • |
| 160mA | 0160 | 125V | | 1000 | 150 | 0.0037 | • | • | • |
| 200mA | 0200 | 125V | | 950 | 210 | 0.0075 | • | • | • |
| 250mA | 0250 | 125V | | 900 | 225 | 0.013 | • | • | • |
| 315mA | 0315 | 125V | | 800 | 255 | 0.026 | • | • | • |
| 400mA | 0400 | 125V | 100A/125VAC | 230 | 95 | 0.015 | • | • | • |
| 500mA | 0500 | 125V | 50-60Hz | 220 | 110 | 0.025 | • | • | • |
| 630mA | 0630 | 125V | cos φ=1.0 | 210 | 135 | 0.045 | • | • | • |
| 800mA | 0800 | 125V | | 200 | 160 | 0.068 | • | • | • |
| 1.00A | 1100 | 125V | | 190 | 190 | 0.13 | • | • | • |
| 1.25A | 1125 | 125V | | 180 | 225 | 0.2 | • | • | • |
| 1.60A | 1160 | 125V | | 170 | 275 | 0.39 | • | • | • |
| 2.00A | 1200 | 125V | | 160 | 450 | 0.53 | • | • | • |
| 2.50A | 1250 | 125V | | 150 | 375 | 1.1 | • | • | • |
| 3.15A | 1315 | 125V | | 140 | 445 | 1.9 | • | • | • |
| 4.00A | 1400 | 125V | | 130 | 520 | 3.2 | • | • | • |
| 5.00A | 1500 | 125V | | 120 | 600 | 6.1 | • | • | • |
| 6.30A | 1630 | 125V | | 115 | 850 | 9.7 | • | • | • |

Note: 1.00 means the number one with two decimal places. 1,000 means the number one thousand.

Order Information

| Qty. | Order-Number | Series | Amp Code | Packaging |
|------|--------------|--------|----------|-----------|
| | | 395 | | |

Specifications are subject to change without notice

TE5[®] / No. 395

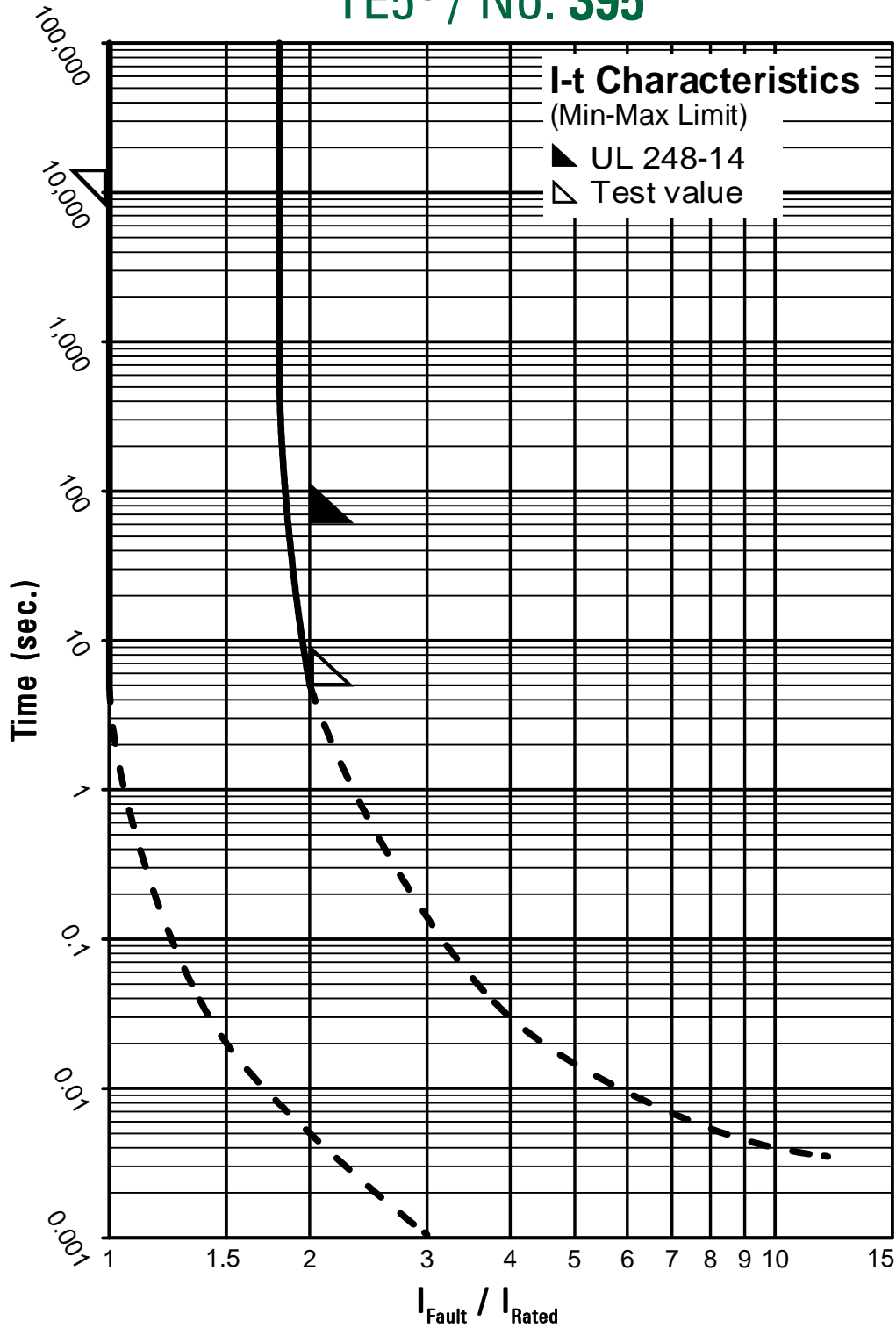

Contact Littelfuse for individual I-t curves

X-ON Electronics

Largest Supplier of Electrical and Electronic Components

Click to view similar products for [Fuses with Leads \(Through Hole\)](#) category:

Click to view products by [Littelfuse](#) manufacturer:

Other Similar products are found below :

[89096-013](#) [89096-015](#) [A170100400](#) [BKPCH-5-R](#) [252010](#) [252.062](#) [SS-5-800MA-AP](#) [SS-5F-3.15A-AP](#) [252004](#) [263.750](#) [LKB-3](#) [0252001.M-0471005.MAT1L](#) [0473004.MAT1L](#) [0473.750HAT1L](#) [0471002.MAT1L](#) [0471.500MAT1L](#) [0491002.MAT1](#) [0473001.HAT1L](#) [0473002.HAT1L](#) [0473.500HAT1L](#) [SS-5-1.6A-AP](#) [SS-5F-2.5A-AP](#) [SR-5H-2.5A-AP](#) [SS-5-6.3A-BK](#) [BK-AGC-2-1-2-R](#) [BK-GMA-8-R](#) [BK-GMD-4-R](#) [BK-GMT-4A](#) [BK-MDL-1](#) [BK-PCD-5-R](#) [BK-C520-5-R](#) [BK-GMC-10-R](#) [BK-MDA-V-30-R](#) [BK-S500-500-R](#) [BK-SFE-20](#) [BK-GMA-1-25-R](#) [GMQ-3-2-10](#) [GLX-12](#) [PCB-34-R](#) [SR-5H-4A-AP](#) [RST 5-AMMO](#) [PCF-1/2-R](#) [SR-5H-3.15A-BK](#) [SR-5H-2A-BK](#) [047101.5MAT1L](#) [0471003.MAT1L](#) [GFA-12](#) [89096-005](#) [SR-5F-1-6A-BK](#)