

A non-insulated terminal binding post, manufactured from nickel plated brass, rated at 30 Amps, with a non-captive 2 BA nut. Can be used on a maximum of 12,5mm panel thickness.

### Dimensions

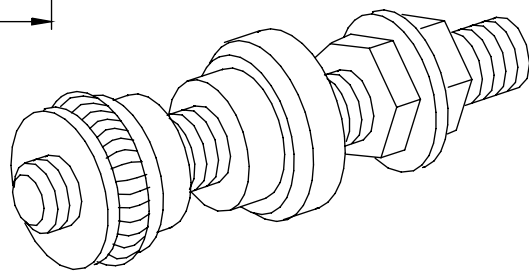
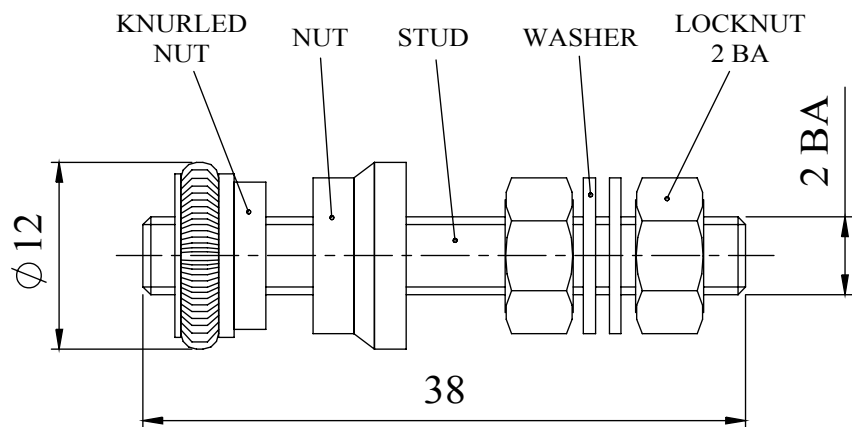

|                        |                              |
|------------------------|------------------------------|
| MATERIAL               |                              |
| LOCKNUT                | : Brass, bright nickel plate |
| WASHER                 | : Brass, bright nickel plate |
| STUD                   | : Brass, bright nickel plate |
| NUT                    | : Brass, bright nickel plate |
| KNURLED NUT            | : Brass, bright nickel plate |
| Maximum Current Rating | : 30 Amps                    |

Tel No. +44(0)1724 273200 Website www.dem-uk.com

PROPRIETARY AND CONFIDENTIAL  
 THE INFORMATION CONTAINED IN THIS DRAWING IS THE SOLE PROPERTY OF  
**ALPHA 3 MANUFACTURING**.  
 ANY REPRODUCTION IN PART OR AS A WHOLE WITHOUT THE WRITTEN PERMISSION OF  
**ALPHA 3 MANUFACTURING** IS PROHIBITED.

UNLESS OTHERWISE SPECIFIED:  
 DIMENSIONS ARE IN MILLIMETRES  
 LINEAR TOLERANCE:  
**NO DECIMAL PLACES ±0.5mm**  
**1 DECIMAL PLACE ±0.25mm**  
**2 DECIMAL PLACES ±0.125mm**  
 ANGULAR TOLERANCE: ±1°



**DEM** Manufacturing, Deltron Emcon House  
 Hargreaves Way, Sawcliffe Ind. Park,  
 Scunthorpe, North Lincolnshire, DN15 8RF, UK

|   |                       |                              |
|---|-----------------------|------------------------------|
| FINISH                                  | TERMINAL BINDING POST | DEBURR AND BREAK SHARP EDGES |
| IF IN DOUBT ASK<br>DO NOT SCALE DRAWING |                       |                              |
| MATERIAL                                | SEE NOTE              |                              |

|                        |              |
|------------------------|--------------|
| DRAWN BY               | SPB          |
| APPROVED BY            | WC           |
| THIRD ANGLE PROJECTION | SHEET 1 OF 1 |
|                        | SCALE 1:1    |
|                        | A4           |

|             |                                    |                 |
|-------------|------------------------------------|-----------------|
| TITLE       | GENERAL SPECIFICATION FOR 351-0000 |                 |
| DRAWING NO. | 351-0000                           | ISSUE <b>02</b> |
|             |                                    | Release         |

## X-ON Electronics

Largest Supplier of Electrical and Electronic Components

*Click to view similar products for [Test Plugs & Test Jacks](#) category:*

*Click to view products by [Deltron](#) manufacturer:*

Other Similar products are found below :

[579-0400](#) [66000-7](#) [R644543000](#) [R921923000](#) [R921930000](#) [R941344000](#) [R948161000](#) [R999351000](#) [1408-4](#) [1533-1](#) [174-R825B-EX](#)  
[NYS508-BU](#) [1680](#) [174-R819B-EX](#) [R644543003](#) [R644543004](#) [R644543020](#) [R644543021](#) [R921926000](#) [R921931000](#) [R921932000](#)  
[R921934000](#) [R929991000](#) [R941460000](#) [R941461000](#) [R941463600](#) [R941920600](#) [R948160000](#) [31B-2-RED](#) [032-0016-023](#) [105-1106-001](#)  
[108-1000-106](#) [108-2301-621](#) [66001-9](#) [7013](#) [1395080-1](#) [930166100](#) [NYS508-GR](#) [NYS508-W](#) [NYS508-Y](#) [NYS511-R](#) [BP30-2BR10-B PKG](#)  
[BP30-10-WT](#) [BP30-2BR-B PKG](#) [BP30Y-1 PKG](#) [R941049000](#) [R941340000](#) [R948141029](#) [R921922000](#) [R644543022](#)