

## PCB terminal block - SPTAF 1/ 6-3,5-IL - 1861975

Please be informed that the data shown in this PDF Document is generated from our Online Catalog. Please find the complete data in the user's documentation. Our General Terms of Use for Downloads are valid (<http://phoenixcontact.com/download>)

PCB terminal block, Nominal current: 16 A, Nom. voltage: 160 V, Pitch: 3.5 mm, Number of positions: 6, Connection method: Push-in spring connection, Mounting: Wave soldering, Conductor/PCB connection direction: 45 °, Color: green



The figure shows a 10-position version of the product

### Why buy this product

- User-friendly and quick conductor connection using Push-in direct plug-in technology
- Arrangement over several rows possible for high packing densities
- Easy operation when releasing the conductor via the orange actuating lever
- Time saving push-in connection, tools not required
- Defined contact force ensures that contact remains stable over the long term
- Intuitive use through colour coded actuation lever
- Small component size for applications where space is at a premium
- Quick and convenient testing using integrated test option

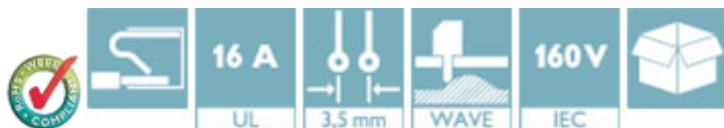

### Key Commercial Data

|                                      |   |
|--------------------------------------|---|
| Packing unit                         | 65 pc   |
| Minimum order quantity               | 65 pc   |
| GTIN                                 | <br>4 055626 135014 |
| Weight per Piece (excluding packing) | 2.22 g  |
| Custom tariff number                 | 85369010  |
| Country of origin                    | Germany   |
| Product key                          | AAABBA  |
| Note                                 | Made to Order (non-returnable)  |

### Technical data

#### Dimensions

|        |         |
|--------|---------|
| Length | 1 mm    |
| Pitch  | 3.50 mm |

# PCB terminal block - SPTAF 1/ 6-3,5-IL - 1861975

## Technical data

### Dimensions

|                          |               |
|--------------------------|---------------|
| Dimension a              | 17.5 mm       |
| Width                    | 2.5 mm        |
| Constructional height    | 8 mm          |
| Height                   | 10.6 mm       |
| Length of the solder pin | 2.6 mm        |
| Pin dimensions           | 0,75 x 0,3 mm |
| Pin spacing              | 5 mm          |
| Hole diameter            | 1.1 mm        |

### General

|  |                   |
|--|-------------------|
| Insulating material group              | I                 |
| Rated surge voltage (III/3)            | 2.5 kV            |
| Rated surge voltage (III/2)            | 2.5 kV            |
| Rated surge voltage (II/2)             | 2.5 kV            |
| Rated voltage (III/3)                  | 160 V             |
| Rated voltage (III/2)                  | 160 V             |
| Rated voltage (II/2)                   | 320 V             |
| Connection in acc. with standard       | EN-VDE            |
| Nominal current $I_N$                  | 16 A              |
| Nominal cross section                  | 1 mm <sup>2</sup> |
| Maximum load current                   | 16 A              |
| Insulating material                    | PA                |
| Solder pin surface                     | Sn                |
| Flammability rating according to UL 94 | V0                |
| Stripping length                       | 8 mm              |
| Number of positions                    | 6                 |

### Connection data

|  |                      |
|--|----------------------|
| Conductor cross section solid min.   | 0.2 mm <sup>2</sup>  |
| Conductor cross section solid max.   | 1.5 mm <sup>2</sup>  |
| Conductor cross section flexible min.                                      | 0.2 mm <sup>2</sup>  |
| Conductor cross section flexible max.                                      | 1.5 mm <sup>2</sup>  |
| Conductor cross section flexible, with ferrule without plastic sleeve min. | 0.25 mm <sup>2</sup> |
| Conductor cross section flexible, with ferrule without plastic sleeve max. | 0.75 mm <sup>2</sup> |
| Conductor cross section flexible, with ferrule with plastic sleeve min.    | 0.25 mm <sup>2</sup> |
| Conductor cross section flexible, with ferrule with plastic sleeve max.    | 0.75 mm <sup>2</sup> |
| Conductor cross section AWG min.   | 24                   |
| Conductor cross section AWG max.   | 16                   |

### Standards and Regulations

|  |        |
|--|--------|
| Connection in acc. with standard       | EN-VDE |
| Flammability rating according to UL 94 | V0     |

# PCB terminal block - SPTAF 1/ 6-3,5-IL - 1861975

## Classifications

eCl@ss

|            |          |
|------------|----------|
| eCl@ss 8.0 | 27440401 |
| eCl@ss 9.0 | 27440401 |

ETIM

|          |          |
|----------|----------|
| ETIM 5.0 | EC002643 |
|----------|----------|

## Accessories

Accessories

Screwdriver tools

Screwdriver - SZF 0-0,4X2,5 - 1204504



Actuation tool, for ST terminal blocks, also suitable for use as a bladed screwdriver, size: 0.4 x 2.5 x 75 mm, 2-component grip, with non-slip grip

## Drawings

Drilling diagram

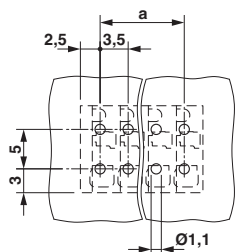

Dimensional drawing

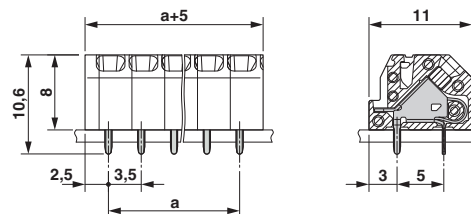

## X-ON Electronics

Largest Supplier of Electrical and Electronic Components

*Click to view similar products for [phoenix contact manufacturer](#):*

Other Similar products are found below :

[1203259](#) [3240366](#) [1893300](#) [2800744](#) [2867076](#) [3006564](#) [2800741](#) [5146480](#) [1582539](#) [1623633](#) [1507793](#) [3025587](#) [3069708](#) [1582223](#)  
[1431461](#) [1586976](#) [0311647](#) [1460160](#) [1771338](#) [3048387](#) [2814605](#) [0309086](#) [1513716](#) [3035684](#) [5451417](#) [0202219](#) [1647747](#) [1730667](#)  
[1709267](#) [5449018](#) [0311634](#) [1730696](#) [3034057](#) [0311579](#) [1730683](#) [0719032](#) [5449843](#) [3240098](#) [0311566](#) [0201391](#) [CRIMPFOX 16 S](#)  
[CRIMPFOX 25R](#) [CRIMPSET 25](#) [7001438](#) [ETD-BL-1T-F-300S](#) [MCR-1CLP-I-I-00](#) [MCR-4CLP-I-I-00](#) [MCR-DAC 8-I- 4-BUS](#) [FL EPA](#)  
[WMS](#) [FLK 50/EZ-DR/ 400/KONFEK/S](#)