

1

2

3

4

5

6

7

8

A

B

C

D

E

F

A

B

C

D

E

F

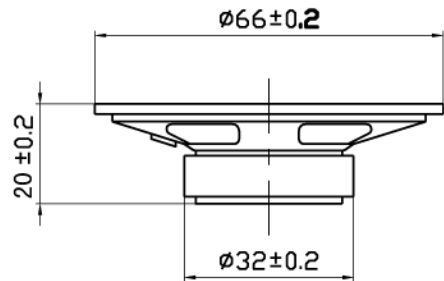
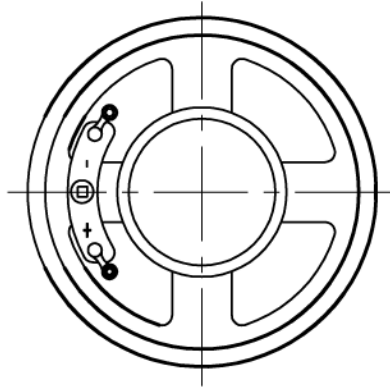

1	Items	Specifications	Test condition
2	Rated Impedance	64 Ω ±15%	at 1000Hz
3	Voice coil size/material		
4	Cone edge/material		
5	Rated Noise Power	0.5W	
6	Max.Input Power	1.0W	
7	Resonant Frequency	400±20% Hz	
8	Rated Frequency Range	f ₀ ~ 7KHz	
9	Ouput Sound Pressure Level	89±3dB	
10	Distortion	≤5%	at 1000Hz1.0W
11	Operation	Must be normal	7Vrms sine wave
12	Sweep test	Must be normal	7V sine wave
13	Load test	Must be normal	white noise with weighted filter 6 vrms sine wave 24 Hrs
14	Heat test	Must meet item 6 & 12 after test	50°C±2 °C 5Hrs.
15	Humidity test	Must meet item 6 & 12 after test	40°C±2°C 90/95%RH 16Hrs.
16	Cold test	Must meet item 6 & 12 after test	-25°C±2 °C 16Hrs.
17	Flux density	GAUSS	
18	Magnet	Ø32xØ18x6mm	
19	Weight	49g	

TOLERANCES UNLESS NOTED OTHERWISE

.X ±
.XX ±
.XXX ±90° FORMED +2°
ANGLES -1°

FIRST ANGLE PROJECTION



DRAWN

DESIGN

CHECKED

APPROVED

DATE

05.08.25

CONTRACT NO.

AGENCY APPROVAL

ITEM NO.

ESP66200MF-R64/05G

VER

1.0

SCALE

UNIT

mm

SHEET

△			
△			
△			
△			
NO.	DATE	REVISION	REFERENCE DWG

1

2

3

4

5

6

7

8

X-ON Electronics

Largest Supplier of Electrical and Electronic Components

Click to view similar products for [cqr manufacturer](#):

Other Similar products are found below :

[SPEAKER MINIATURE 2.5" 8OHM](#)