

Type Number	4120
Designation IEC	LR20
System	Zn-MnO <sub>2</sub> (Alkaline)
Shelf Life (Coding)*	5 years
Nominal Voltage [V]	1.5
Typical Capacity C [mAh]	16500 (discharge with high-resistance)
Permissible Temperature Range	- 10 °C ... 50 °C
Weight, approx. [g]	141
Volume [ccm]	51.3

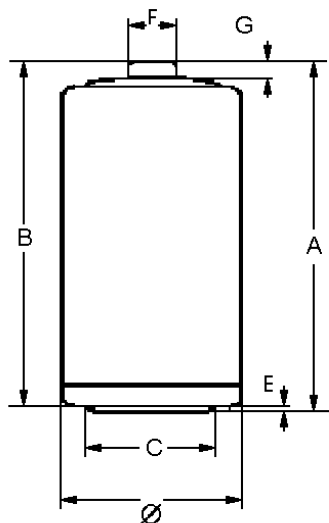

Dimensions [mm]	min:	max:
∅	32.3	34.2
A	-	61.5
B	59.5	-
C	18.0	-
E	-	1.0
F	-	9.5
G	1.5	-

### Typical Capacities (at 20°C)

Discharge Type	Load	End Voltage[V]	1.0	0.9
4M/H,8H/D,7D/W Portable Lightings	2.2 Ω	Time [m]	1280	1535
		Capacity [Ah]	11.65	13.65
		Energy [Wh]	14.05	16.25
Discharge Type	Load	End Voltage[V]	0.9	0.8
1H/D,7D/W Toys	2.2 Ω	Time [h]	23.85	27.20
		Capacity [Ah]	12.10	13.35
		Energy [Wh]	13.65	14.75
Discharge Type	Load	End Voltage[V]	1.0	0.9
1H/D,7D/W Tape Recorders	3.9 Ω	Time [h]	40.50	45.50
		Capacity [Ah]	12.50	13.80
		Energy [Wh]	15.25	16.45
Discharge Type	Load	End Voltage[V]	1.0	0.9
4H/D,7D/W Transistor Radios	10 Ω	Time [h]	114.50	130.10
		Capacity [Ah]	14.30	15.80
		Energy [Wh]	18.05	19.45

\* In consideration of typical loss of capacity at storage and application.

## X-ON Electronics

Largest Supplier of Electrical and Electronic Components

*Click to view similar products for [varta](#) manufacturer:*

Other Similar products are found below :

[56456 702 099](#) [18750](#) [CA317-PB](#) [CG341-030-PB](#) [CG381D-G-100-PB](#) [CG511-030-PB](#) [CG511D-100-PB](#) [4120 210 501](#) [4610 726 406](#)  
[CA311-PB](#) [CA312-PB](#) [LCD-CHARGER + 4XAA 2400MAH](#) [449915B](#) [4607 726 406](#) [CG341-050-PB](#) [CG381D-G-050-PB](#) [CG511D-018-PB](#)  
[55171403014](#) [55625603059](#) [55615602940](#) [MINI-CHARGER](#) [MINI CHARGER + 2XAA 2100MAH](#) [17730](#) [LCD-SMART-CHARGER](#)  
[414086X](#) [CG511D-030-PB](#) [POCKET-CHARGER + 4XAA 2100MAH](#) [LCD MULTI CHARGER](#) [458980A](#) [CG511-150-PB](#) [EE UNIVERSAL](#)  
[CHARGER](#) [CG401D-050-PB](#) [CG511-050-PB](#) [CU303-018-PB](#) [413675G](#) [CU202-030-PB](#) [CU201G-B-030-PB](#) [55615603059](#) [CG381D-G-150-](#)  
[PB](#) [CG481G-050-PB](#) [4600 726 406](#) [095668F](#) [CA418-PB](#) [CU302-030-PB](#) [CG481G-030-PB](#) [CG511D-150-PB](#) [20389101501](#) [CU201G-B-050-](#)  
[PB](#) [CA089-PB](#) [CU202G-B-030-PB](#)