

RoHS compliant

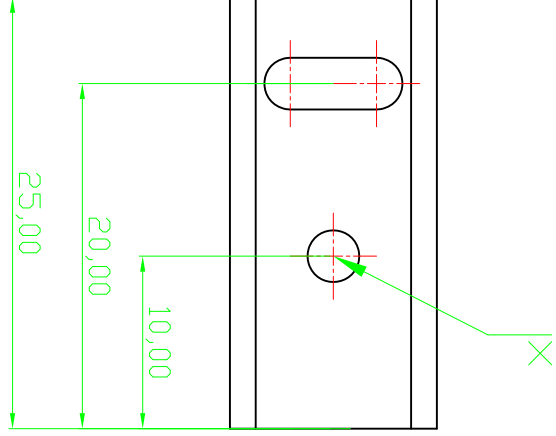
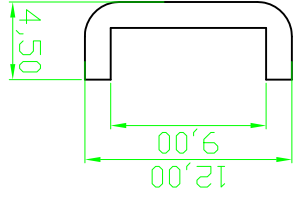

Option	Dimension x	Version	Thermal resistance
V5274A-T	M2,5	Black anodized	60
V5274B-T	M3,0	Black anodized	60
V5274C-T	ø3,2	Black anodized	60

Notes
Material: AL99.5-1mm

H		G		F		E		D		C		B		A																																																																																							
<table border="1"> <tr> <td>Angle</td> <td>X.X°</td> </tr> <tr> <td>DIM</td> <td>TOL</td> </tr> <tr> <td>X.XX</td> <td>±X</td> </tr> <tr> <td>X.X</td> <td>±X</td> </tr> </table>		Angle	X.X°	DIM	TOL	X.XX	±X	X.X	±X	<table border="1"> <tr> <td>TOLERANCE</td> <td>X.X</td> </tr> <tr> <td>±X</td> <td>X.XX</td> </tr> <tr> <td>±X</td> <td>X.XX</td> </tr> <tr> <td>±X</td> <td>X.XX</td> </tr> </table>		TOLERANCE	X.X	±X	X.XX	±X	X.XX	±X	X.XX	<table border="1"> <tr> <td>Scale</td> <td>1:1</td> </tr> <tr> <td colspan="2">TOLERANCE</td> </tr> <tr> <td>X.X</td> <td>±X</td> </tr> <tr> <td>X.X</td> <td>±X</td> </tr> </table>		Scale	1:1	TOLERANCE		X.X	±X	X.X	±X	<table border="1"> <tr> <td>Id.</td> <td>①</td> <td>Drawn</td> <td>12.10.2009</td> <td>Schulz</td> </tr> <tr> <td>②</td> <td>Modify P/N</td> <td>Dean</td> <td>11.10.2010</td> <td>Schulz</td> </tr> <tr> <td colspan="5">Modification</td> </tr> <tr> <td colspan="5">Date</td> </tr> </table>		Id.	①	Drawn	12.10.2009	Schulz	②	Modify P/N	Dean	11.10.2010	Schulz	Modification					Date					<table border="1"> <tr> <td colspan="2">ASSMANN</td> <td colspan="2">VSW/ components</td> </tr> <tr> <td>Drawing-No.</td> <td>ASS 0376 HS</td> <td>Replace</td> <td>Sheet</td> </tr> <tr> <td>Customer-No.</td> <td>V5274x-T</td> <td>ASSMANN WSW-No.</td> <td>V5274x-T</td> </tr> <tr> <td>Name</td> <td>Schulz</td> <td>Date</td> <td>12.10.2009</td> </tr> </table>		ASSMANN		VSW/ components		Drawing-No.	ASS 0376 HS	Replace	Sheet	Customer-No.	V5274x-T	ASSMANN WSW-No.	V5274x-T	Name	Schulz	Date	12.10.2009	<table border="1"> <tr> <td>1</td> <td>2</td> <td>3</td> <td>4</td> <td>5</td> <td>6</td> <td>7</td> </tr> <tr> <td>1</td> <td>2</td> <td>3</td> <td>4</td> <td>5</td> <td>6</td> <td>7</td> </tr> </table>		1	2	3	4	5	6	7	1	2	3	4	5	6	7	<table border="1"> <tr> <td>1</td> <td>2</td> <td>3</td> <td>4</td> <td>5</td> <td>6</td> <td>7</td> </tr> <tr> <td>1</td> <td>2</td> <td>3</td> <td>4</td> <td>5</td> <td>6</td> <td>7</td> </tr> </table>		1	2	3	4	5	6	7	1	2	3	4	5	6	7
		Angle	X.X°																																																																																																		
		DIM	TOL																																																																																																		
		X.XX	±X																																																																																																		
X.X	±X																																																																																																				
TOLERANCE	X.X																																																																																																				
±X	X.XX																																																																																																				
±X	X.XX																																																																																																				
±X	X.XX																																																																																																				
Scale	1:1																																																																																																				
TOLERANCE																																																																																																					
X.X	±X																																																																																																				
X.X	±X																																																																																																				
Id.	①	Drawn	12.10.2009	Schulz																																																																																																	
②	Modify P/N	Dean	11.10.2010	Schulz																																																																																																	
Modification																																																																																																					
Date																																																																																																					
ASSMANN		VSW/ components																																																																																																			
Drawing-No.	ASS 0376 HS	Replace	Sheet																																																																																																		
Customer-No.	V5274x-T	ASSMANN WSW-No.	V5274x-T																																																																																																		
Name	Schulz	Date	12.10.2009																																																																																																		
1	2	3	4	5	6	7																																																																																															
1	2	3	4	5	6	7																																																																																															
1	2	3	4	5	6	7																																																																																															
1	2	3	4	5	6	7																																																																																															
H		G		F		E		D		C		B		A																																																																																							
H		G		F		E		D		C		B		A																																																																																							

X-ON Electronics

Largest Supplier of Electrical and Electronic Components

Click to view similar products for [Heat Sinks](#) category:

Click to view products by [Assmann](#) manufacturer:

Other Similar products are found below :

[581102B00000G](#) [630-35ABT3](#) [656-15ABPE](#) [657-20ABPNE](#) [7020B-TC12-MTG](#) [73452PPBA](#) [7721-13NG](#) [7G0011A](#) [FI306/SE](#) [PF720G](#)
[A22-4026](#) [120-1873-007](#) [HAH10L](#) [HF20](#) [1542256-2](#) [1542026-1](#) [1542616-1](#) [HS-2506-F1](#) [HS-87M0-F2](#) [218-40CTE3](#) [25-7520](#)
[188854F00000G](#) [F-QB-F1](#) [APA501-60-003](#) [253-122ABE-22](#) [PSC22CB](#) [CLP-201](#) [CLP212SG](#) [CLP-7701G](#) [HAA072](#) [HAA083](#) [HAF10L](#)
[HAQ10T](#) [D10100-28](#) [TO5-002D](#) [513101B02500G](#) [BDN183CBA01](#) [531202B0000](#) [HS-56M0-C1](#) [3-21053-4](#) [TX0506-1B](#) [TX1806B](#)
[336614B-00000](#) [V2004X](#) [LAE66A3CB](#) [WA-DT2-101E](#) [511-3U](#) [017177](#) [530510B00000G](#) [6110BG](#)