

Flush-type connector - SACC-E-M8MS-8CON-M10/0,5 - 1424232

Please be informed that the data shown in this PDF Document is generated from our Online Catalog. Please find the complete data in the user's documentation. Our General Terms of Use for Downloads are valid (<http://phoenixcontact.com/download>)



Sensor/actuator flush-type plug, 8-pos., M8, front/screw mounting with M10 fastening thread, with 0.5 m TPE litz wire, 8 x 0.14 mm²



Key commercial data

| | |
|--------------------------------------|--|
| Packing unit | 1 pc |
| GTIN |  4 046356 712446 |
| Weight per Piece (excluding packing) | 16.2 g |
| Custom tariff number | 85366990 |
| Country of origin | Germany |
| Product key | ABQBBA |

Technical data

Dimensions

| | |
|-----------------|-------|
| Length of cable | 0.5 m |
|-----------------|-------|

Ambient conditions

| | |
|---------------------------------|----------------------------------|
| Ambient temperature (operation) | -25 °C ... 85 °C (Plug / socket) |
| Degree of protection | IP67 |

General

| | |
|------------------------|------------------------------|
| Rated current at 40°C | 1.5 A |
| Rated voltage | 30 V |
| Number of positions | 8 |
| Contact resistance | ≤ 3 mΩ |
| Insulation resistance | ≥ 100 MΩ |
| Coding | A - standard |
| Standards/regulations | M8 connector IEC 61076-2-104 |
| Status display | No |
| Surge voltage category | II |
| Pollution degree | 3 |

Flush-type connector - SACC-E-M8MS-8CON-M10/0,5 - 1424232

Technical data

General

| | |
|-------------------|--------------------|
| Connection method | Individual wires |
| Mounting type | Front mounting M10 |

Material

| | |
|---|------------------------------|
| Inflammability class according to UL 94 | HB |
| Contact material | Cu alloy |
| Contact surface material | Au |
| Contact carrier material | PA 66 |
| Material, knurled | Zinc die-cast, nickel-plated |

Cable

| | |
|---------------------------------|--|
| Cable type | PVC litz wire |
| AWG signal line | 26 |
| Wire colors | white, brown, green, yellow, gray, pink, blue, red |
| Material conductor insulation | PVC |
| Conductor material | Tin-plated Cu litz wires |
| Ambient temperature (operation) | -25 °C ... 85 °C (cable, fixed installation) |

Classifications

eCl@ss

| | |
|------------|----------|
| eCl@ss 4.0 | 27250313 |
| eCl@ss 4.1 | 27250313 |
| eCl@ss 5.0 | 27250313 |
| eCl@ss 5.1 | 27143423 |
| eCl@ss 6.0 | 27143423 |
| eCl@ss 7.0 | 27449001 |
| eCl@ss 8.0 | 27440103 |

ETIM

| | |
|----------|----------|
| ETIM 3.0 | EC002061 |
| ETIM 4.0 | EC002635 |
| ETIM 5.0 | EC002061 |

UNSPSC

| | |
|---------------|----------|
| UNSPSC 6.01 | 31251501 |
| UNSPSC 7.0901 | 31251501 |
| UNSPSC 11 | 31251501 |
| UNSPSC 12.01 | 31251501 |
| UNSPSC 13.2 | 31251501 |

Flush-type connector - SACC-E-M8MS-8CON-M10/0,5 - 1424232

Approvals

Approvals

Approvals

EAC

Ex Approvals

Approvals submitted

Approval details

| |
|-----|
| EAC |
|-----|

Drawings

Dimensioned drawing

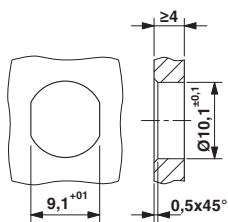

Schematic diagram

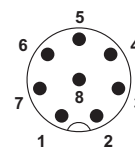

M8 plug pin assignment, 8-pos., view of pin side

Mounting panel with feed-through hole

Dimensioned drawing

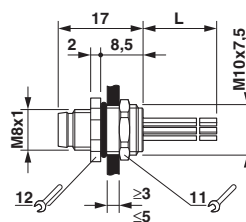

M8 flush-type plug

X-ON Electronics

Largest Supplier of Electrical and Electronic Components

Click to view similar products for [phoenix contact manufacturer](#):

Other Similar products are found below :

[1203259](#) [3240366](#) [1893300](#) [2800744](#) [2867076](#) [3006564](#) [2800741](#) [5146480](#) [1582539](#) [1623633](#) [1507793](#) [3025587](#) [3069708](#) [1582223](#)
[1431461](#) [1586976](#) [0311647](#) [1460160](#) [1771338](#) [3048387](#) [2814605](#) [0309086](#) [1513716](#) [3035684](#) [5451417](#) [0202219](#) [1647747](#) [1730667](#)
[1709267](#) [5449018](#) [0311634](#) [1730696](#) [3034057](#) [0311579](#) [1730683](#) [0719032](#) [5449843](#) [3240098](#) [0311566](#) [0201391](#) [CRIMPFOX 16 S](#)
[CRIMPFOX 25R](#) [CRIMPSET 25](#) [7001438](#) [ETD-BL-1T-F-300S](#) [MCR-1CLP-I-I-00](#) [MCR-4CLP-I-I-00](#) [MCR-DAC 8-I- 4-BUS](#) [FL EPA](#)
[WMS](#) [FLK 50/EZ-DR/ 400/KONFEK/S](#)