

# Flush-type connector - SACC-DSI-M8MS-5CON-M8-L180 DN - 1424242

Please be informed that the data shown in this PDF Document is generated from our Online Catalog. Please find the complete data in the user's documentation. Our General Terms of Use for Downloads are valid (<http://phoenixcontact.com/download>)



Sensor/actuator flush-type connector, plug, 5-pos., DeviceNet, M8, rear/screw mounting with M10 fastening thread, with straight solder connection



## Key commercial data

|                                      |  |
|--------------------------------------|--|
| Packing unit                         | 20 pc  |
| GTIN                                 | <br>4 046356 712545 |
| Weight per Piece (excluding packing) | 6.17 g   |
| Custom tariff number                 | 85366990   |
| Country of origin                    | Germany  |
| Product key                          | ABQBAA   |

## Technical data

### Ambient conditions

|                      |      |
|----------------------|------|
| Degree of protection | IP67 |
|----------------------|------|

### General

|                        |                                    |
|------------------------|------------------------------------|
| Rated current at 40°C  | 3 A                                |
| Rated voltage          | 30 V                               |
| Number of positions    | 5                                  |
| Contact resistance     | ≤ 3 mΩ                             |
| Insulation resistance  | ≥ 100 MΩ                           |
| Coding                 | B - inverse                        |
| Standards/regulations  | M8 connector IEC 61076-2-104       |
| Status display         | No                                 |
| Surge voltage category | II                                 |
| Pollution degree       | 3                                  |
| Connection method      | Solder pins                        |
| Mounting type          | Rear mounting M8 x 1 With flat nut |

### Material

# Flush-type connector - SACC-DSI-M8MS-5CON-M8-L180 DN - 1424242

## Technical data

### Material

|   |                              |
|---|------------------------------|
| Inflammability class according to UL 94 | HB                           |
| Contact material                        | Cu alloy                     |
| Contact surface material                | Au                           |
| Contact carrier material                | PA 66                        |
| Material, knurls                        | Zinc die-cast, nickel-plated |

## Classifications

### eCl@ss

|            |          |
|------------|----------|
| eCl@ss 4.0 | 27250313 |
| eCl@ss 4.1 | 27250313 |
| eCl@ss 5.0 | 27260701 |
| eCl@ss 5.1 | 27143423 |
| eCl@ss 6.0 | 27143423 |
| eCl@ss 7.0 | 27449001 |
| eCl@ss 8.0 | 27440103 |

### ETIM

|          |          |
|----------|----------|
| ETIM 3.0 | EC002061 |
| ETIM 4.0 | EC002635 |
| ETIM 5.0 | EC002061 |

### UNSPSC

|               |          |
|---------------|----------|
| UNSPSC 6.01   | 31251501 |
| UNSPSC 7.0901 | 31251501 |
| UNSPSC 11     | 31251501 |
| UNSPSC 12.01  | 31251501 |
| UNSPSC 13.2   | 31251501 |

## Approvals

### Approvals

---

Approvals

EAC

---

Ex Approvals

---

Approvals submitted

# Flush-type connector - SACC-DSI-M8MS-5CON-M8-L180 DN - 1424242

## Approvals

### Approval details

EAC

## Drawings

Dimensioned drawing

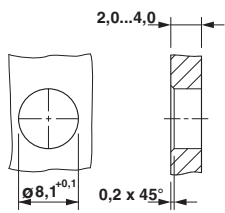

Schematic diagram

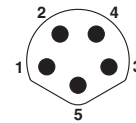

Pin assignment M8 plug, 5-pos., B-coded, view plug side

Housing cutout for M8 flush-type connector, connector, one-section

Drilling diagram

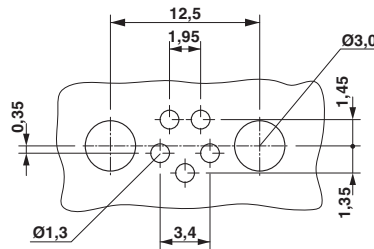

Drilling diagram

## X-ON Electronics

Largest Supplier of Electrical and Electronic Components

*Click to view similar products for [phoenix contact manufacturer](#):*

Other Similar products are found below :

[1203259](#) [3240366](#) [1893300](#) [2800744](#) [2867076](#) [3006564](#) [2800741](#) [5146480](#) [1582539](#) [1623633](#) [1507793](#) [3025587](#) [3069708](#) [1582223](#)  
[1431461](#) [1586976](#) [0311647](#) [1460160](#) [1771338](#) [3048387](#) [2814605](#) [0309086](#) [1513716](#) [3035684](#) [5451417](#) [0202219](#) [1647747](#) [1730667](#)  
[1709267](#) [5449018](#) [0311634](#) [1730696](#) [3034057](#) [0311579](#) [1730683](#) [0719032](#) [5449843](#) [3240098](#) [0311566](#) [0201391](#) [CRIMPFOX 16 S](#)  
[CRIMPFOX 25R](#) [CRIMPSET 25](#) [7001438](#) [ETD-BL-1T-F-300S](#) [MCR-1CLP-I-I-00](#) [MCR-4CLP-I-I-00](#) [MCR-DAC 8-I- 4-BUS](#) [FL EPA](#)  
[WMS](#) [FLK 50/EZ-DR/ 400/KONFEK/S](#)