



Microminiature Rotary Coded Switches for SMT

Specifications:

| | |
|------------------------|---|
| Contact rating: | 50 V DC, 100 mA, non-switching 5 V DC, 100 mA, switching |
| Contact resistance: | < 200 mΩ |
| Insulation resistance: | > 1000 MΩ at 100 V DC |
| Dielectric strength: | 250 V, 50 Hz for the duration of 1 minute |
| Operating temperature: | - 25° to + 75° C |
| Mechanical life: | minimum 20 000 operations |
| Contacts: | phosphor bronze, gold-plated |
| Material: | case: thermoplastic; frame: stainless steel rotor: PA, standard types ivory; inverse types red |
| Construction: | case totally sealed, suitable for washing by immersion |
| Mounting: | on pc-board – SMD |
| Soldering conditions: | reflow-soldering – max.: 30 sec, 240° C |

Models: Code

| | |
|-----------|---------------------|
| SMR 13010 | BCD |
| SMR 13110 | BCD Inverse |
| SMR 13016 | Hexadecimal |
| SMR 13116 | Hexadecimal Inverse |

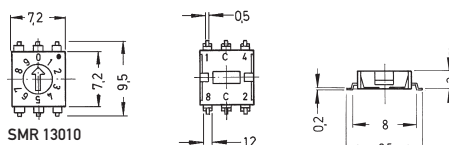

| | |
|-----------|---------------------|
| SMR 14010 | BCD |
| SMR 14110 | BCD Inverse |
| SMR 14016 | Hexadecimal |
| SMR 14116 | Hexadecimal Inverse |

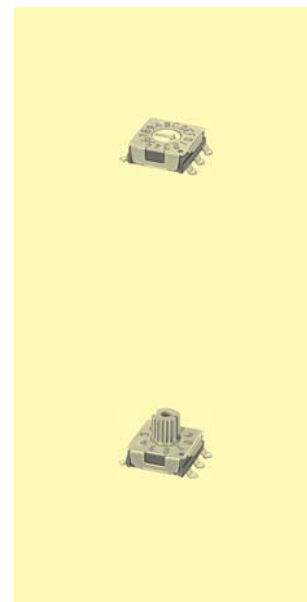
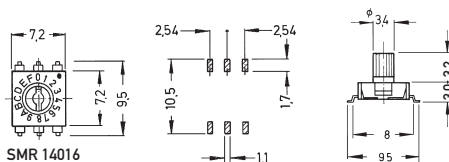

Packaging: sticks or tapes
for order on tapes: additional to type number: T
example of order: SMR 13010 T

| Models | Stick | Tape | Reel |
|------------|---------------------|-------------|----------|
| SMR 13 000 | 65 pieces; L 510 mm | 2000 pieces | ∅ 330 mm |
| SMR 14 000 | 65 pieces; L 510 mm | - | - |

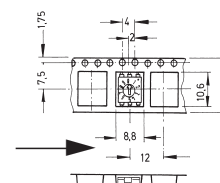

X-ON Electronics

Largest Supplier of Electrical and Electronic Components

Click to view similar products for [DIP Switches/SIP Switches](#) category:

Click to view products by [Knitter-Switch](#) manufacturer:

Other Similar products are found below :

[78M03S](#) [79B10T](#) [8136-475G4T](#) [G7G-1A2-CB-DC12](#) [A7SS-M](#) [DBP 2110](#) [DBP 2112](#) [DBS1008](#) [DHN02FTVTR](#) [DHN10T](#) [DHS108](#)
[DPL08TN](#) [DRD16CSE04](#) [DRR4010](#) [DRR60016](#) [DRS4016](#) [BD06E](#) [1825008-1](#) [1825444-1](#) [25.350.0653.0](#) [LA2-DC12](#) [SBS 5004 TG](#)
[SDA10H1BDA](#) [97R06ST](#) [A2C-2A5](#) [1825444-7](#) [ADE08SA04](#) [ADE12S04](#) [2161391-1](#) [2-1825058-8](#) [CCVA 2.5/ 4-G-5.08](#) [P26THRR32](#)
[25.330.0653.1](#) [25.352.0353.0](#) [MDG305ST](#) [IKN0600000](#) [IKN0800000](#) [LA2-002-DC24](#) [DBP2008](#) [DBS1003](#) [DBS2008](#) [438872000](#)
[DRD10CRAE04](#) [DRS1604](#) [DSR02T](#) [DSS 208 N](#) [5-1825033-1](#) [106-SDN06-EV](#) [1-1437507-6](#) [E2FMX2D1M1TGJ03M](#)
[E3ZMCT81M1TJ03M](#)