



**Strangkühlkörper für  
Leiterplattenmontage**
**Extruded heatsinks  
for PCB mounting**
**Dissipateurs extrudés  
pour montage PCB**

Art. Nr. Art. No. Art. n°		 [mm]	Wärmewiderstand Thermal resistance Résistances thermiques
SK 95 15 STS SOT 32 S	SOT 32	15	38,5 K/W
SK 95 25 STS TO 220	TO 220	25	36 K/W
SK 95 25 STS SOT 32	SOT 32	25	36 K/W

SK 95 15 STS SOT 32 S

SK 95 25 STS TO 220

SK 95 25 STS SOT 32

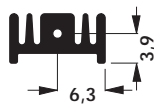

L = lötlarer Stift

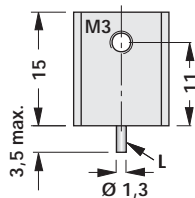

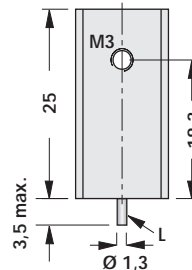

L = solderable pin

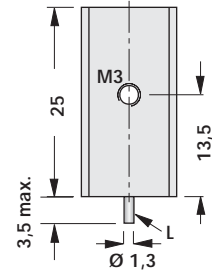

L = picot soudables



Art. Nr. Art. No. Art. n°		 [mm]	Wärmewiderstand Thermal resistance Résistances thermiques
SK 95 15	-	15	38,5 K/W
SK 95 15 SOT 32 S	SOT 32	15	38,5 K/W
SK 95 25	-	25	36 K/W
SK 95 25 TO 220	TO 220	25	36 K/W
SK 95 25 SOT 32	SOT 32	25	36 K/W
SK 95 25 2 x M 3	2 x M 3 (TO 220)	25	36 K/W
SK 95 1000	-	1000	-

SK 95 25 2 x M3

SK 95 15 SOT 32 S

SK 95 25 TO 220

SK 95 25 SOT 32

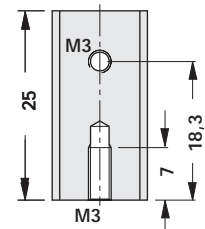
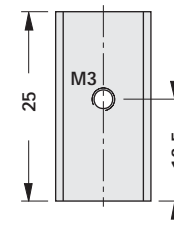
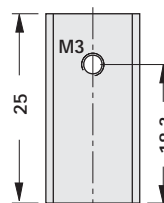
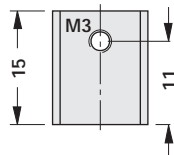
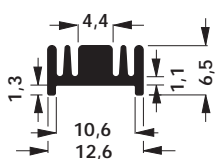
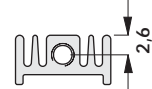
**Oberfläche schwarz eloxiert  
Gewinde eloxalfrei**

 Sonderlängen und Sondertransistor-  
lochungen auf Anfrage.

**Surface black anodised  
threads not anodised**

 Special lengths and transistor drillings on  
request.

**Surface anodisée noire  
taradages non anodisée**

 Longueurs et perçages de boîtier spéciales  
sur demand.

## X-ON Electronics

Largest Supplier of Electrical and Electronic Components

*Click to view similar products for [fisher manufacturer](#):*

Other Similar products are found below :

[FR 105 52 220 ME](#) [FR 120 42 200 ME](#) [GEL 28 30](#) [GEL 45 10](#) [GEL 45 50](#) [GEL 60 10](#) [AKG 33 20 80 ME](#) [AKG 69 24 100 ME](#) [BL 16 SMD](#)  
[067 12](#) [ICKSR40X30](#) [CAB 5 05 GS](#) [LA 17 150 230](#) [LA 21 150 230](#) [LA 21 150 24](#) [LA 27 K 100 12](#) [LA 27 K 100 24](#) [LA 27 K 150 12](#) [LA 27](#)  
[K 50 24](#) [SK4615AL](#) [SK56920AL](#) [SK57225SA](#) [SK57720AL](#) [SK57850SA](#) [SK58420AL](#) [SK58437.5SA](#) [SK 622 1000 AL](#) [SK 622 1000 SA](#)  
[SK 622 100 AL](#) [SK 623 100 SA](#) [SK 626 1000 SA](#) [SK 627 1000 AL](#) [SK 627 200 AL](#) [SK 627 200 SA](#) [SK 627 50 SA](#) [SK 636 100 AL](#) [SK LED](#)  
[R 65 SA](#) [SK LED R 80 SA](#) [AKG 69 24 100 SA](#) [AKG 69 24 50 SA](#) [AKG 71 24 80 ME](#) [FR 80 42 160 ME](#) [GE K 80 42 100 SA](#) [GEL 45 30](#)  
[GEL 60 25](#) [GEL F 15 10](#) [TUF 120 42 220 ME](#) [TUF 55 16 200 SA](#) [CAB 5 ZS](#) [CAB 9 GS](#) [LA 27 K 50 12](#)