

Aluminium Housed Proximity Switch - Changeover Contacts

Part Number : PRC-SA-001
Product Data Sheet

PICTURE

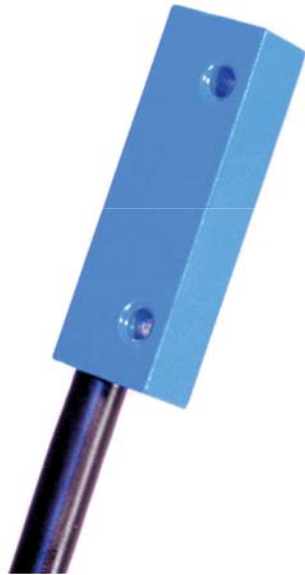

DIMENSIONS

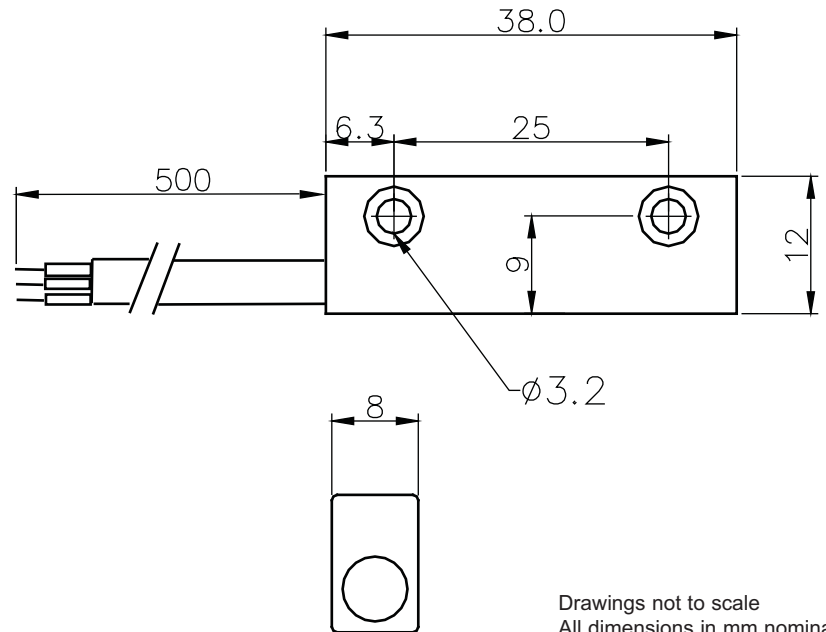

Drawings not to scale
All dimensions in mm nominal

✓ RoHS Compliant

SPECIFICATION

Contact Form / Style		Changeover
Switching voltage	Max Volts	175 AC/DC
Switching Current	Max Amps	0.4
Switching Capacity	Max W/VA	5
Carry Current	Max Amps	0.5
Contact Resistance	Max mOhms	120
Operating Temperature	Celsius	-20° to 85°
Case Material		Blue powder coated Aluminium
Cable		3 core 0.50mm ² Black PVC insulated

Applications Include

- Position sensing.
- Linear actuators.
- Security switching.
- Safety guards/devices

Options/Features

- Robust sealed switch, custom housings available.
- Normally Open version available.
- Custom cable types, cable lengths, connectors or crimp terminals available.
- Hermetically sealed reed switch for long life.
- Powder coated housing for added corrosion resistance.

Did you know we also sell?



Rev. No.

1

Revision Note

Datasheet

Date

10-09-12

Signature

ML



As part of the company policy of continued product improvement, specifications may change without notice. Our sales office will be pleased to help you with the latest information on this product range and the details of our full design and manufacturing service. All products are supplied to our standard conditions of sale unless otherwise agreed in writing.

Phone : +44 (0)1255 862236

www.assemtech.co.uk

Fax: +44 (0)1255 862014

©2012 Copyright Assemtech Europe Ltd, Unit 7, Rice Bridge Industrial Estate, Thorpe - Le - Soken, Essex, CO16 0HL, ENGLAND.
USA: Comus International: +1 973 777 6900, Belgium: Comus Belgium BVBA: +32 (0)12 390400

X-ON Electronics

Largest Supplier of Electrical and Electronic Components

Click to view similar products for [Proximity Sensors](#) category:

Click to view products by [Comus](#) manufacturer:

Other Similar products are found below :

[01.001.5653.1](#) [70.340.1028.0](#) [70.360.2428.0](#) [70.364.4828.0](#) [70.810.1053.0](#) [72.360.1628.0](#) [73.363.6428.0](#) [9221350022](#) [980659-1](#) [QT-12](#)
[E2EX10D1NN](#) [E2E-X14MD1-G](#) [E2E-X2D1-G](#) [E2EX2ME2N](#) [E2E-X3D1-N](#) [10M](#) [E2E-X4MD1-G](#) [E2FMX1R5D12M](#) [E2K-F10MC1](#) [5M](#)
[EI1204TBOSL-6](#) [EI5515NPAP](#) [BSA-08-25-08](#) [IC08ANC15PO-K](#) [IMM2582C](#) [25.161.3253.0](#) [25.332.0653.1](#) [25.352.0653.0](#) [25.352.0753.0](#)
[25.523.3253.0](#) [9151710023](#) [922FS1.5C-A4P-Z774](#) [SC606ABV0S30](#) [SM952A126100LE](#) [A1220EUA-T](#) [F3S-A162-U](#) [CL18](#) [QT-08L](#)
[34.110.0010.0](#) [TL-C2MF1-M3-E4](#) [IA08BLF15NOM5](#) [IA08BSF15NOM5](#) [IA12ASF04DOM1](#) [IMM32188C](#) [IS2](#) [IS31SE5000-UTLS2-TR](#)
[34.110.0021.0](#) [34.110.0022.0](#) [CA150-120VACDC](#) [VM18VA3000Q](#) [XS508BSCBL2](#) [XS512BLNAM12](#)