



**Have a Question?**  
Chat with a Product Information Specialist

What can we help you find?

- [Products](#)
- [Industries](#)
- [Resources](#)
- [About TE](#)
- [My Account](#)
- [Innovation](#)
- [Support Center](#)

**51864 Product Details**

- [Share](#)
- [Print](#)
- [Email](#)

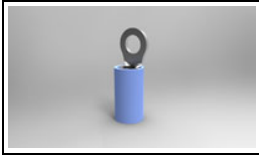

**51864**  
(MS25036-107)  
TE Internal Number: 51864  
✔ Active

[View 3D PDF](#)

**Ring and Spade Tongue Terminals**

✔ Always EU RoHS/ELV Compliant (Statement of Compliance)

**Product Highlights:**

- Terminal Shape = Ring Tongue
- Receptacle Style = Straight
- Body Style = PIDG
- Barrel Type = Closed Barrel
- Wire/Cable Type = Regular Wire

[View all Features](#)

**Quick Links**

- [▶ Pricing & Availability](#)
- [▶ Search for Tooling](#)
- [▶ Product Feature Selector](#)
- [▶ Contact Us About This Product](#)

- [Add to My Part List](#)
  - [Request Sample](#)
  - [Find Similar Products](#)
- [Buy Product](#)

Documentation & Additional Information	
<p><b>Product Drawings:</b></p> <ul style="list-style-type: none"> <li>TERMINAL, RING TONGUE, PIDG, WIRE SIZE, 16-14 AWG (PDF, English)</li> </ul> <p><b>Catalog Pages/Data Sheets:</b></p> <ul style="list-style-type: none"> <li>None Available</li> </ul> <p><b>Product Specifications:</b></p> <ul style="list-style-type: none"> <li>None Available</li> </ul> <p><b>Application Specifications:</b></p> <ul style="list-style-type: none"> <li>Pre-Insulated Diamond Grip (PIDG) Terminals, Splices... (PDF, English)</li> </ul> <p><b>Instruction Sheets:</b></p> <ul style="list-style-type: none"> <li>None Available</li> </ul> <p><b>CAD Files: (CAD Format &amp; Compression Information)</b></p> <ul style="list-style-type: none"> <li>2D Drawing (DXF, Version AE)</li> <li>3D Model (IGES, Version AE)</li> <li>3D Model (STEP, Version AE)</li> </ul>	<p><b>Related Products:</b></p> <ul style="list-style-type: none"> <li>Tooling</li> </ul>
<a href="#">List all Documents</a>	

Product Features (Please use the Product Drawing for all design activity)	
<p><b>Product Type Features:</b></p> <ul style="list-style-type: none"> <li>Terminal Shape = Ring Tongue</li> <li>Receptacle Style = Straight</li> <li>Barrel Type = Closed Barrel</li> <li>Wire/Cable Type = Regular Wire</li> <li>Insulation = Yes</li> <li>Insulation Support = Insulation Support</li> <li>Stud Diameter (mm [in]) = 3.68 [0.145]</li> <li>Stud Size = 6 [M3.5]</li> <li>Shape = RING-041</li> <li>Heavy Duty = No</li> <li>Finish = Tin</li> <li>Color = Blue</li> </ul> <p><b>Electrical Characteristics:</b></p> <ul style="list-style-type: none"> <li>Voltage (VAC) = 300</li> </ul> <p><b>Termination Features:</b></p> <ul style="list-style-type: none"> <li>Wire/Cable Size (CMA) = 2,050 - 5,180</li> </ul> <p><b>Dimensions:</b></p> <ul style="list-style-type: none"> <li>Insulation Diameter (mm [in]) = 2.67 - 3.81 [.105 - .150]</li> <li>Length (mm [in]) = 21.44 [0.844]</li> </ul>	<p><b>Body Features:</b></p> <ul style="list-style-type: none"> <li>Body Style = PIDG</li> <li>Wire Range (mm [AWG]) = 1.25-2.00<sup>2</sup> [16-14]</li> <li>Material = Copper</li> <li>Tongue Material Thickness (mm [in]) = 0.79 [0.031]</li> <li>Insulation Material = Nylon</li> <li>Insulation Sleeve Material = Copper</li> </ul> <p><b>Contact Features:</b></p> <ul style="list-style-type: none"> <li>Class = 1 &amp; 2</li> </ul> <p><b>Industry Standards:</b></p> <ul style="list-style-type: none"> <li>Government/Industry Qualification = Yes</li> <li>Government/Industry Part Number = MS25036-107</li> <li>RoHS/ELV Compliance = RoHS compliant, ELV compliant</li> <li>Lead Free Solder Processes = Not relevant for lead free process</li> <li>RoHS/ELV Compliance History = Always was RoHS compliant</li> </ul> <p><b>Packaging Features:</b></p> <ul style="list-style-type: none"> <li>Packaging Method = Loose Piece</li> </ul> <p><b>Other:</b></p> <ul style="list-style-type: none"> <li>Brand = AMP</li> </ul>

**Corporate Information**

- [About TE](#)
- [Investors](#)
- [News Room](#)
- [Supplier Portal](#)
- [Careers](#)
- [Terms & Conditions](#)
- [Privacy Policy](#)

**Quick Links**

- [Distributor Inventory](#)
- [Product Cross Reference](#)
- [Documents & Drawings](#)
- [Product Compliance Support Center](#)
- [Site Map](#)

**Customer Support**

- [Email or Chat With Us](#)
- [Find a Phone Number](#)
- [Knowledge Base](#)
- [Manage Your Account](#)

**Keep Me Informed**



## X-ON Electronics

Largest Supplier of Electrical and Electronic Components

*Click to view similar products for [Terminals](#) category:*

*Click to view products by [TE Connectivity](#) manufacturer:*

Other Similar products are found below :

[HT-13-10](#) [71M-250-32-NB](#) [01-2065-1-0216](#) [00581P0075](#) [M10-10RX](#) [M10BCK](#) [60205-1](#) [604200-1](#) [60598-1-CUT-TAPE](#) [60617-1-C](#) [60873-1](#) [M14-516R/SK](#) [M14-6RSX](#) [M18-10FLX](#) [M18-8FBX](#) [M18-8R/LX](#) [M18BCK](#) [61314-6-C](#) [61-S](#) [61-SN-A](#) [62-NBM-A](#) [63-S](#) [640179-1](#) [640917-2-CUT-TAPE](#) [6501550002](#) [66107-2-C](#) [696683-1](#) [696834-1](#) [696861-1](#) [696931-1](#) [696999-1](#) [M8-516RK](#) [M86700006](#) [MA250DMFMX-A](#) [701-2007](#) [701-2307](#) [701-7761-03](#) [70F-110-32-PB](#) [718-N-A](#) [71M-187-20-NBL](#) [71M-250-32-NBL](#) [72F-187-20-NBL](#) [72M-250-32-NBL](#) [7310](#) [73F-250-32](#) [73F-250-32-NBL](#) [73F-250-32-NL](#) [F14-10C](#) [F-1M](#) [751-250](#)