

# Versatile easy-mount filter

# FN 420

- 0.6-6.5A current ratings
- Low profile case
- Designed for easy-mounting
- Nennströme von 0,6 bis 6,5A
- Flaches Gehäuse
- Einfache Montage
- Courants de service de 0,6 à 6,5A
- Boîtier à hauteur réduite
- Conçu pour un montage simple



### Filter selection table

Choose the family FN xxx with the required current rating and features, and add /?? to determine input/output (line/load) connection style. Example: FN 422-4/13 is a 4A filter with mini fast-on connections.

### Approvals



Family	Connections 	Current ratings at 40°C (25°) A	Inductance L mH
FN 42? -0.6 /??	/13	0.6 (0.7)	22.5
FN 42? -1 /??	/13	1 (1.2)	13
FN 42? -2.5 /??	/13	2.5 (3)	3.4
FN 42? -4 /??	/13	4 (4.8)	2
FN 42? -6.5 /??	/13	6.5 (7.3)	0.75

### Additional specifications

Filter type	Capacitance		Res. R MΩ	Maximum leakage μA/phase	Maximum operating voltage		Operating frequency Hz	Hipot test voltage		Housing	Weight g
	C <sub>x</sub> nF	C <sub>y</sub> nF			VAC	Hz		PN→E VAC	P→N VDC		
FN 420 types	150	2.2	1	190	250	50/60	DC to 400	2000	1700	A7B	70
FN 422 types	150	4.7	1	190	250	50/60	DC to 400	2000	1700	A7B	70

MTBF at 40°C, 230V, per Mil-HB-217F: 625,000 hours.

### Electrical schematic

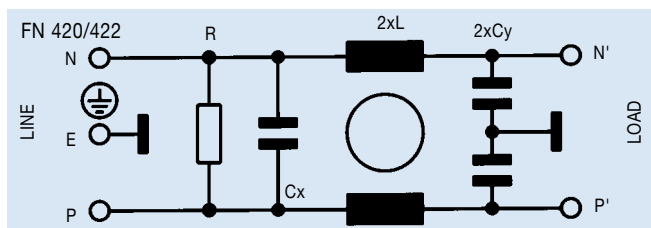

See tables for component values.

## FN 420 insertion loss

Per CISPR 17; A = 50Ω/50Ω sym, B = 50Ω/50Ω asym, C = 0.1Ω/100Ω sym, D = 100Ω/0.1Ω sym

### FN 420 0.6 amp types

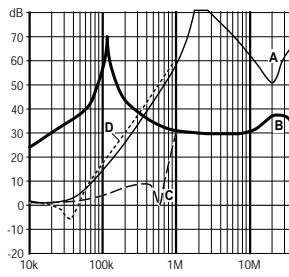

### FN 420 1 amp types

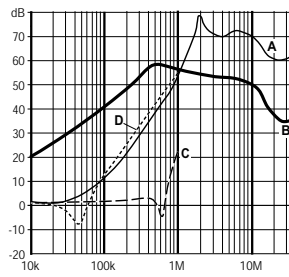

### FN 420 2.5 amp types

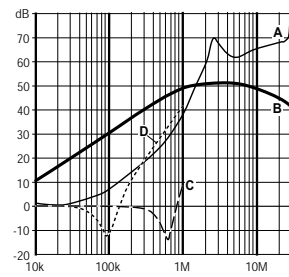

### FN 420 4 amp types

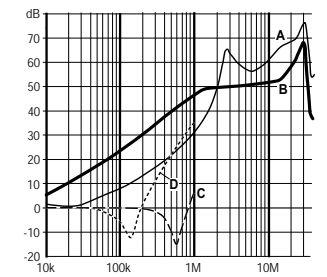

### FN 420 6.5 amp types

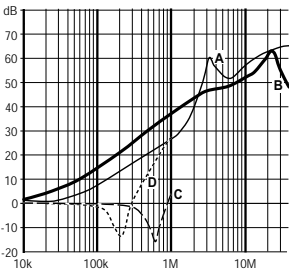

### FN 422 0.6 amp types

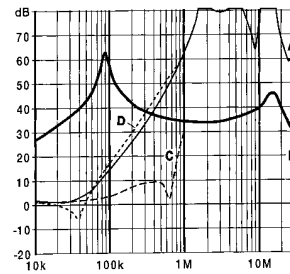

### FN 422 1 amp types

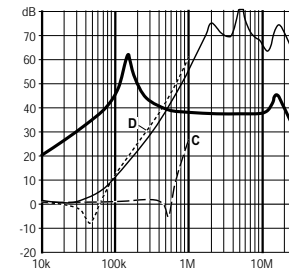

### FN 422 2.5 amp types

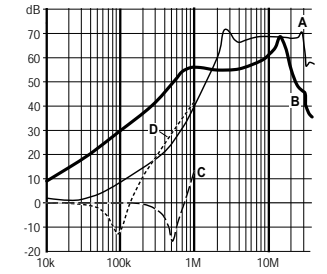

### FN 422 4 amp types

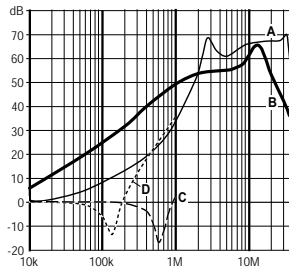

### FN 422 6.5 amp types

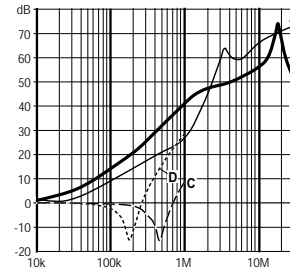

## Mechanical data

		Tol. mm
<b>A</b>	83	± 0.5
<b>B</b>	41	± 0.3
<b>C</b>	17	± 0.3
<b>D</b>	65.8	± 0.2
<b>E</b>	31	± 0.5
<b>F</b>	40	± 0.2
<b>G</b>	5.5	± 0.3
<b>J</b>	15.2	± 0.3
<b>K</b>	1	± 0.1
<b>M</b>	Ø5	± 0.1

### Front view

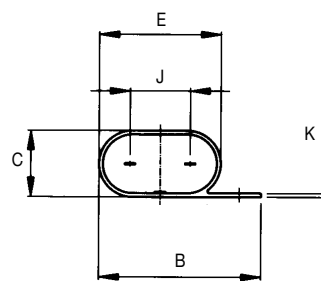

### Top view

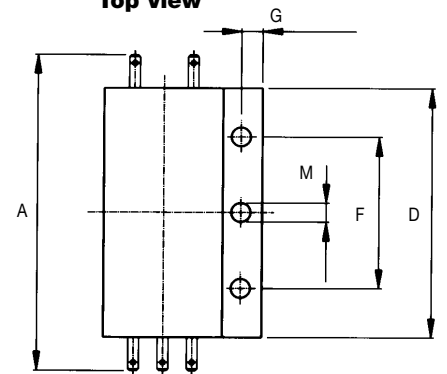

All dimensions in mm; 1 inch = 25.4 mm

## X-ON Electronics

Largest Supplier of Electrical and Electronic Components

*Click to view similar products for [Power Line Filters](#) category:*

*Click to view products by [Schaffner](#) manufacturer:*

Other Similar products are found below :

[5B1](#) [6609019-3](#) [6609026-5](#) [6609030-6](#) [6609063-2](#) [6609973-2](#) [7-1609090-5](#) [F1500CA06](#) [F7382Z](#) [F7863Z](#) [FAHAV3100ZC000](#) [806276](#)  
[FN2020B-1-06](#) [FN2080B-10-06](#) [FN2090A-1-06](#) [FN2410H-32-33](#) [FN2410H-80-34](#) [FN2412H-16-44](#) [FN406B-0.5-02](#) [FN420-1-13](#) [FP144](#) [8-](#)  
[6609089-0](#) [12-MMB-030-11-D](#) [B84144A90R120](#) [20B1](#) [RSEL-2001A](#) [2B1](#) [LP183](#) [1-6609070-1](#) [F1500CA10](#) [1B1](#) [FN2020A-10-06](#)  
[FN2020B-3-06](#) [FN2060A-3-06](#) [FN2070A-16-06](#) [FN2070B-16-08](#) [FN2090B-12-06](#) [FN2090Z-1-06](#) [FN2410H-25-33](#) [FN2410H-60-34](#)  
[FN2410H-8-44](#) [FN2412H-25-33](#) [FN2412H-8-44](#) [FN610R-3-06](#) [20EHZ7](#) [20K1](#) [30B6](#) [30BCF10R](#) [3K1](#) [4-6609089-0](#)