

## M12 Field Attachable Connectors

RSCW | RKCW



### Male, 3-, 4-, 5-, and 8-Pole (90°)

Field attachable connector, M12 male right angle connector, 3-, 4-, 5-, and 8-pole with threaded joint, assembling with screw terminals.

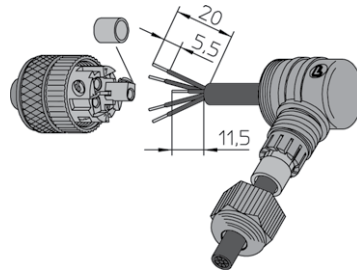

RSCW

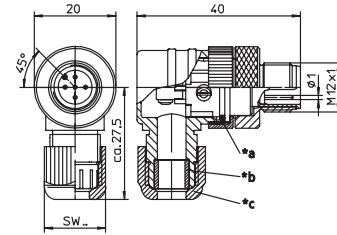

\*a O-Ring  
 \*b gasket  
 \*c cap nut



### Female, 3-, 4-, 5-, and 8-Pole (90°)

Field attachable connector, M12 female right angle connector, 3-, 4-, 5-, and 8-pole with threaded joint, assembling with screw terminals.

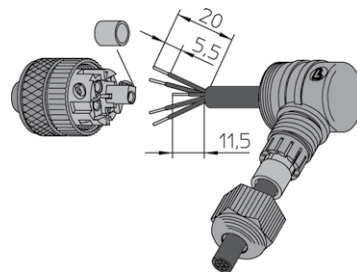

RKCW

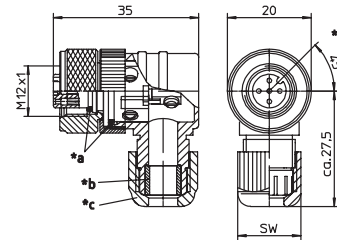

\*a O-Ring  
 \*b gasket  
 \*c cap nut  
 \*d insert 90° rotatable

## Pin Assignments

Face Views / M12, Male / Female

3 pole

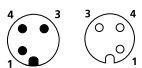

4 pole

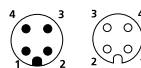

5 pole

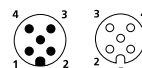

8 pole

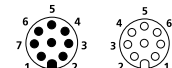



# Be Certain with Belden

## M12 Field Attachable Connectors

RSCW | RKCW

### Technical Data

#### Environmental

Degree of protection IP 67 / NEMA 6P  
 Operating temperature range -25°C (-13°F) / +90°C (+194°F)

#### Mechanical

Housing / Molded body PBT  
 Insert PBT  
 Contact CuZn, pre-coppered, CuSnZn  
 8-poles pre-nickel, gold-plated  
 Receptacle shell CuZn, nickel-plated  
 O-ring FKM  
 Mode of connection Screw terminals  
 Connectable conductor 3-5 poles max. 0.75 mm<sup>2</sup>  
 8 poles max. 0.50 mm<sup>2</sup>

#### Electrical

Contact resistance ≤ 5 mΩ  
 Nominal current at 40°C 3-5 poles 4 A  
 8 poles 2 A  
 Nominal voltage 3-4 poles 240 V  
 5 poles 60 V  
 8 poles 30 V  
 Rated voltage 3-4 poles 250 V  
 5 poles 63 V  
 8 poles 36 V  
 Test voltage 3-4 poles 2.0 kV eff. / 60 s  
 5 poles 1.5 kV eff. / 60 s  
 8 poles 0.9 kV eff. / 60 s  
 Insulation resistance > 10<sup>9</sup> Ω  
 Pollution degree 3

Part Number		Pins	Cable Diameter Range	Characteristics
Male	Female			
RSCW 3/7	RKCW 4/3/7	3	Ø 3.0-6.5 mm /SW 15	
RSCW 3/9	RKCW 4/3/9		Ø 4.0-8.0 mm /SW 19	
RSCW 4/7	RKCW 4/7	4	Ø 3.0-6.5 mm /SW 15	
RSCW 4/9	RKCW 4/9		Ø 4.0-8.0 mm /SW 19	
RSCW 5/7	RKCW 5/7	5	Ø 3.0-6.5 mm /SW 15	
RSCW 5/9	RKCW 5/9		Ø 4.0-8.0 mm /SW 19	
RSCW 8/9	RKCW 8/9	8	Ø 4.0-8.0 mm /SW 19	

## X-ON Electronics

Largest Supplier of Electrical and Electronic Components

*Click to view similar products for [lumberg](#) manufacturer:*

Other Similar products are found below :

[RK20-603/5M](#) [ASBSM 10/LED 3](#) [ASBS-R 8/LED 5-4](#) [ASBSV 8 5](#) [BTOR 1 SCHWARZ](#) [18315 0976 PMC 151](#) [KRE8](#) [SBS 4/LED 3](#)  
[RK30/2M](#) [RKWT 4-07/5M](#) [ASBS-R 4 5-4](#) [ASBS-R 4/LED 5-4](#) [BTO 1 SCHWARZ](#) [BTO 1 V SCHWARZ](#) [BTOR 1 WEISS](#) [KB3](#) [KRES10](#)  
[KRESS8](#) [KS8](#) [KRM 07](#) [0103 03](#) [WKV 81](#) [RK 30-738/20F](#) [RKMV 4-225/10 M](#) [RKT 5-644/2M](#) [RKT 4-679/5M](#) [HZ30](#) [ASBS 2 M12-S2326](#)  
[1614 16](#) [0985 706 100/10M](#) [RST 4-RKWT 4-602/1M](#) [WKV50](#) [RST 4-633/2M](#) [RST 4-RKWT 4-602/3M](#) [RS-TU](#) [0132 05-1](#) [WSV 30](#) [0986](#)  
[EMC 102](#) [0250 03](#) [RKWT 5-612/5M](#) [0980 ESL 393-121](#) [RST 5L-RKT 5L-949/5 M](#) [ASBM 6/LED 3-344/5 M](#) [RKT 4-646/2M](#) [RKHL 8/S 5,5](#)  
[0985 YM57530 100/20M](#) [0985 YM57530 500/1M](#) [RST 4-RKT 4-637/2M](#) [RKT 5L-949/5 M](#) [RST 3-RKMV 3-224/2 M](#)