

P – PANEL MOUNTING ADAPTER

This panel adapter is a rugged, black, auto extinguishable polycarbonate material. It is mounted with two 6/32 screws. A timer is mounted by clipping to the adapter or panel. Order part number P ADAPT.

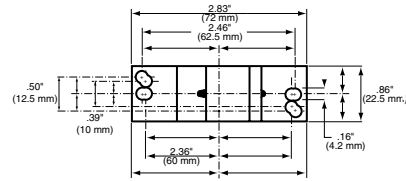
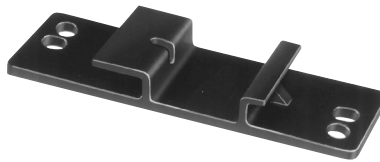

DR – DIN-RAIL

The DR-DIN-Rail material is an extruded aluminum material of the standard configuration, 35mm. Timers and Controls conveniently snap onto the track. Order part number "DR" which is available in 1 meter (39") lengths. Shown with S08, S11 and K11 sockets.

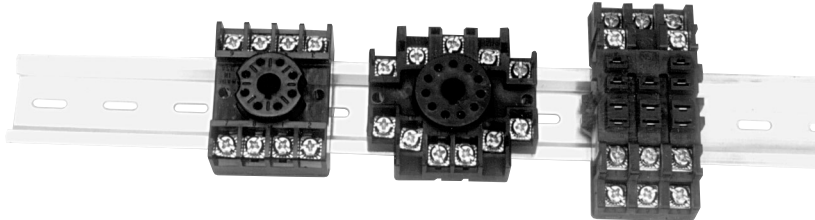

S08, S11 & SCREW TERMINAL SOCKETS

The S08, and S11 are 8 and 11 pin sockets fabricated from a rugged, durable polycarbonate.* The color is grey to match the majority of accessories available. Mounting is with two 6/32 screws .250 or on .30 DIN-Rail, DR. Order part "S08" or "S11."

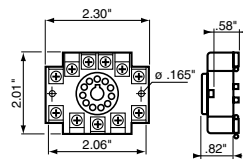

S11

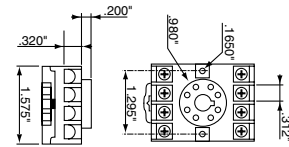

S08

S08-600: 600V, 10A rated 8 pin socket-UL and CSA

S12 & S15 SOLDER TERMINAL SOCKETS

The S12 and S15 are 11 and 8 pin solder terminal sockets fabricated from a rugged, durable polycarbonate. They are black and connections are made by soldering to the tabs or by 3/16" (4.8mm) push-on connectors. Order Part Number "S12" (11 pin) and "S15" (8 pin)

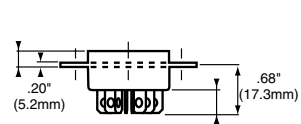
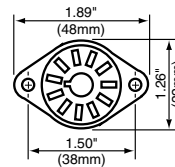

SA8 & SA11 - Back connecting Socket

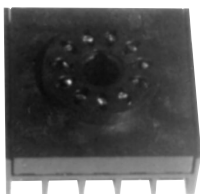

SA11NN

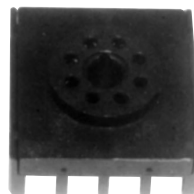
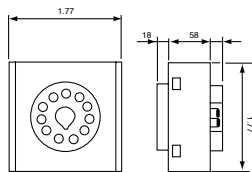

SA8NN

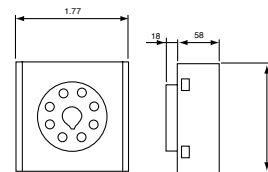

Products and specifications subject to change without notice.

Order/Technical Support – Tel: (800) 677-5311 / FAX: (800) 677-3865 / www.crouzet-usa.com

ACCESSORIES FOR RTM TIMER

SOCKETS PC Board Sockets (mm)

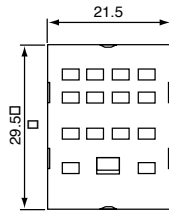
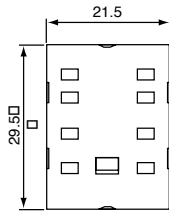

2 Poles
Ref: 26532709

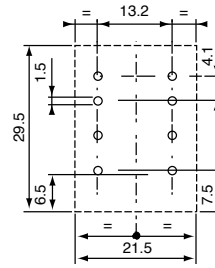
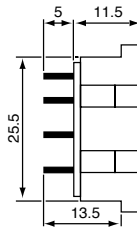

4 Poles
Ref: 26532708

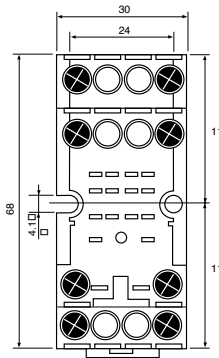
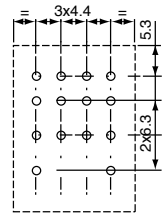

2 Poles
Ref: 26532707

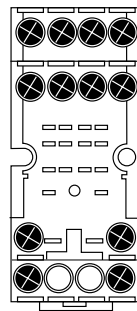

4 Poles
Ref: 26532706

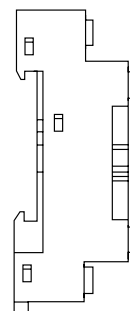

Mounting Clip for DIN-Rail Sockets

Ref: 26532702

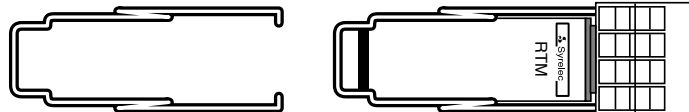

79 238 250 (Part Number)
PANEL MOUNT REMOTE POTENTIOMETER
 470K Ohm ±10% / 0.2 W / linearity ±10%

DIMENSIONS: inches (mm)

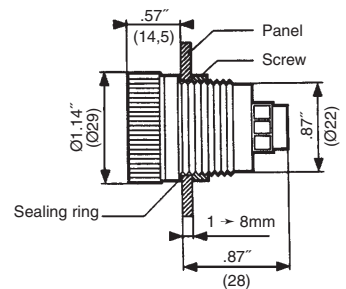

Products and specifications subject to change without notice.

Order/Technical Support – Tel: (800) 677-5311 / FAX: (800) 677-3865 / www.crouzet-usa.com



X-ON Electronics

Largest Supplier of Electrical and Electronic Components

Click to view similar products for [Timers](#) category:

Click to view products by [Crouzet](#) manufacturer:

Other Similar products are found below :

[79237785](#) [H3DS-GL AC24-230/DC24-48](#) [H5AN-4DM DC12-24](#) [H5CN-XDNM AC100-240](#) [H5CN-YAN AC100-240](#) [H5CX-L8S-N AC100-240](#) [H3AMNSCAC100240](#) [H3AM-NSR-B AC100-240](#) [H3CA-8 DC12](#) [H3CR-A8-302 DC24](#) [H3CR-F AC24-48/DC12-48](#) [H3CR-G8EL AC200-240](#) [H5AN-4D DC12-24](#) [81506944](#) [88225029](#) [H5S-YB4-X](#) [H3CR-A-301 AC100-240/DC100-125](#) [H3CR-AS AC24-48/DC12-48](#) [H3DK-GE AC240-440](#) [H3RN-2 AC24](#) [H3RN-21 AC24](#) [H3CR-H8RL AC/DC24 M](#) [H3CR-H8RL AC100-120 S](#) [H3CR-G8EL-31 AC100-120](#) [H3CR-H8RL AC100-120 M](#) [H3CR-HRL AC100-120 M](#) [H3CR-A8-301 AC24-48/DC12-48](#) [H3CR-H8RL AC/DC24 S](#) [H7AN-2D DC12-24](#) [H5CN-XANS DC12-48](#) [H3CA-8 DC110](#) [H7AN-W4DM DC12-24](#) [H7AN-4DM DC12-24](#) [H7AN-4D DC12-24](#) [H7AN-RT6M AC100-240](#) [H3CA-8H AC200/220/240](#) [MTR17-BA-U240-116](#) [PM4HSDM-S-AC240VS](#) [PM4HSDM-S-AC240VSW](#) [PO-405](#) [600DT-CU](#) [H3Y-2-B DC24 30S](#) [PM4HF8-M-DC24V](#) [PM4HS-H-DC12VSW](#) [H3Y-2-B AC100-120 10S](#) [H3Y-2-B AC100-120 30S](#) [H3C-R](#) [H3CR-A8-301 24-48AC/12-48DC](#) [H3CR-A8E 24-48AC/DC](#) [H3CR-F8 100-240AC/100-125DC](#)