

## Pozidrive/slotted collar screw



Part no.: 21101-101

## Features:

- For assembly of partial width front panels
- For use of threaded inserts
- For europacPRO and ratiopacPRO

[Add to basket](#)



## Technical Information:

Description	Description	Qty/PU	Application
M2.5 × 12.3, St, nickel-plated	M2.5 × 12.3, St, nickel-plated	100 piece	Assembly of front panel and rear panel on extruded side panel/rear extrusion of side panel

## Downloads:

3D PDF with CAD data (DWG/DXF/PDF/E-DRAWING/STEP) ([Log in](#) required) 

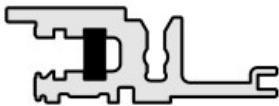
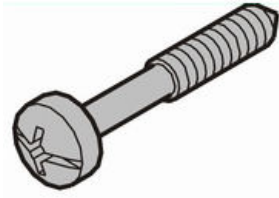
To gain access to the additional information you must [log in](#).  
If you do not yet have a user name, you may [register here](#).



Application: Front panel mounts onto horizontal rail where threaded insert is pushed in at rear

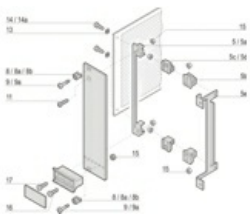

Item 9a, 3 U front panel mounting

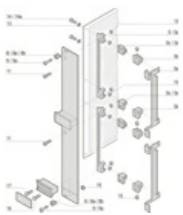

Item 9a, 6 U front panel mounting

Product illustrations are exemplary illustrations and can deviate from supplied products.

## X-ON Electronics

Largest Supplier of Electrical and Electronic Components

*Click to view similar products for [Enclosures, Boxes, & Cases](#) category:*

*Click to view products by [Schroff](#) manufacturer:*

Other Similar products are found below :

[CR-425 PAINTED](#) [585-R-WH-PK](#) [M-10-PLATED](#) [60221-01](#) [60566-01-000](#) [HPL-9VB BATT DOOR](#) [M-16-LID-PLATED](#) [M18-PLTD](#) [M-21-LID-PLATED](#) [M-21-PLATED](#) [M-23-PLATED](#) [CU-281-MB](#) [6711GSKT](#) [71884-29-028](#) [LH45-100 Black](#) [7200B](#) [72868-510-000](#) [CNS-0000 Black](#) [72883-510-000](#) [CNS-0101 Black](#) [72906-510-000](#) [CNS-0407 Black](#) [73091-510-000](#) [CNM-0000-BLACK Kit](#) [73092-510-000](#) [CNM-0101 Black](#) [73108-510-000](#) [CNL-0303 Black](#) [73395-510-039](#) [CNS-0006 Bone](#) [74257-510-000](#) [CNL-0004](#) [MDC-1183-PLAIN-ALUM](#) [MDC-1183-PTD](#) [MDC-13104-PLAIN-ALUM](#) [MDC-211 - PAINTED IVORY/BEIGE](#) [MDC-321-PTD](#) [MDC-432-PLAIN-ALUM](#) [MDC-973-PTD](#) [76](#) [77153-01-028](#) [FLX6030](#) [83535-01-508](#) [PS-11296-G](#) [PS-11298-B](#) [116-508](#) [120-407](#) [120-412](#) [120-909](#) [120-455](#) [R272-100-000](#) [120-910](#) [R501-001-010](#) [R508-080-000](#) [R508-160-000](#) [R530-120-000](#) [R530-122-000](#) [R530-200-000](#) [R531-160-000](#) [R531-200-000](#) [R582-080-100](#)