

THE INFORMATION CONTAINED IN THIS DRAWING IS THE SOLE PROPERTY OF L-COM, INC. ANY REPRODUCTION IN PART OR WHOLE WITHOUT THE WRITTEN PERMISSION OF L-COM, INC. IS PROHIBITED.

REVISIONS			
REV	DESCRIPTION	DATE	APPROVED
E	ECN 6458: USE NEW LOGO	10/12/12	D.FRISIELLO
F	ECN 6485: RETURN TO GLUED VERSION. PRODUCT NOT TOOLED.	10/24/12	D.FRISIELLO
G	ECN 6692: REVISED MODEL FROM GLUED TO SNAP-ON COVERS	2/19/13	D.FRISIELLO

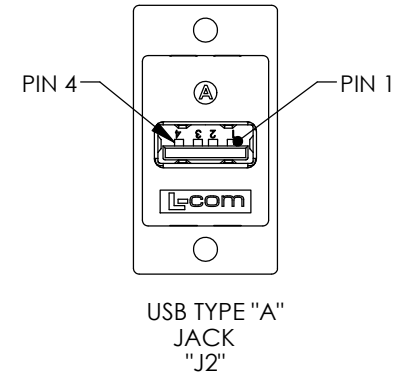
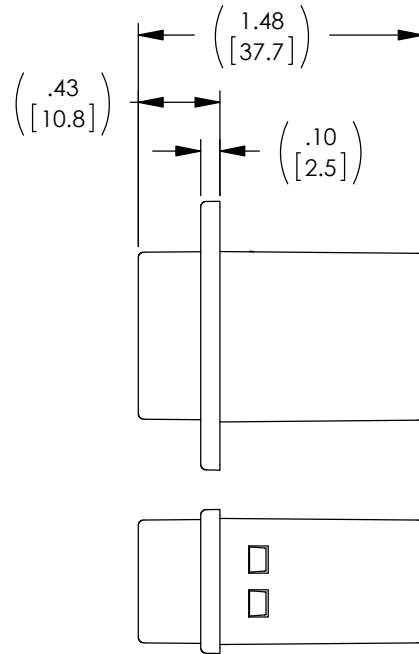
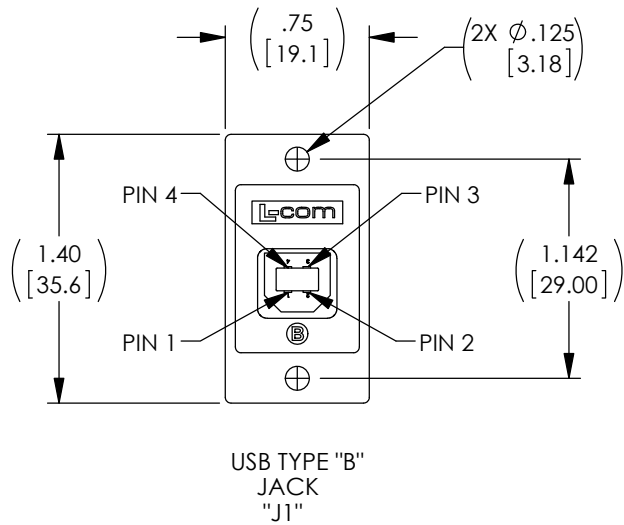

**NOTES:**

**MATERIAL:**

COUPLER HOUSING: ABS, UL94V-0.  
 CONNECTOR INSULATORS: WHITE, PBT WITH GLASS FIBER.  
 TYPE "A" CONNECTOR CONTACTS: PHOSPHOR BRONZE.  
 TYPE "A" CONNECTOR SHELL: BRASS.  
 TYPE "B" CONNECTOR CONTACTS: PHOSPHOR BRONZE.  
 TYPE "B" CONNECTOR SHELL FRONT: BRASS.  
 TYPE "B" CONNECTOR SHELL BACK: STEEL.  
 PCB: EPOXY GLASS FP-4, 94V-0 FLAMMABILITY RATING.

**FINISH:**

COUPLER HOUSING: CHROME.  
 CONNECTOR CONTACTS: GOLD, 30μ INCHES.  
 CONNECTOR SHELLS: NICKEL.

**ELECTRICAL:**

CURRENT RATING: 2 AMP MAX.  
 VOLTAGE RATING: 140 VDC.

**ENVIRONMENTAL:**

OPERATING TEMPERATURE: -20° C TO +80° C.

**MISCELLANEOUS:**

COUPLER SHALL BE TESTED FOR CONTINUITY.  
 COUPLER SHALL BE INDIVIDUALLY PACKAGED IN ACCORDANCE WITH L-COM PACKAGING SPEC PS-0031.

**WIRING MAP**

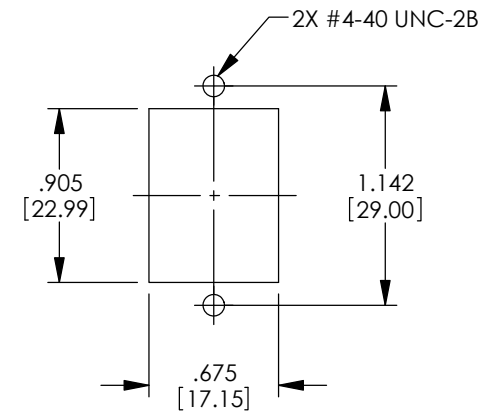
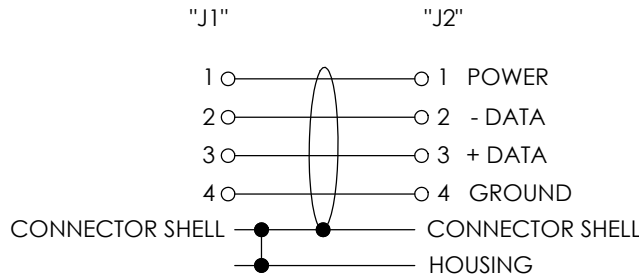

**RoHS Compliant** ✓

UNLESS OTHERWISE SPECIFIED, DIMENSIONS ARE IN INCHES [mm] OVERALL CABLE LENGTH TOLERANCE: ≤12 [305] = +1 [25] / -0 >12 [305] ≤60 [1524] = +2 [51] / -0 >60 [1524] ≤120 [3048] = +4 [102] / -0 >120 [3048] ≤300 [7620] = +6 [152] / -0 >300 [7620] = +3% / -0%	APPROVALS	DATE		45 BEECHWOOD DRIVE NORTH ANDOVER, MA 01845
	DRAWN BY C.MCCORMICK	11/12/2003		CATEGORY
ALL OTHER DIMENSIONAL TOLERANCES: .X = ± .2 .XX = ± .02 .XXX = ± .005	CHECKED BY D.PARHAM	11/12/2003	PRODUCT DESCRIPTION	
PROJECTION	APPROVED BY R. CARRICK	11/12/2003	USB B-A PANEL ADPT SHIELDED	
	CONFIGURATION DETAILS OF UNDIMENSIONED FEATURES MAY VARY	COLOR VARIATIONS MAY OCCUR	SIZE <b>A</b>	FSCM NO. <b>43321</b>
			DWG. NO. <b>ECF504-BAS</b>	REV. <b>G</b>
			SCALE: NONE	CAD FILE: ECF504-BAS.SLDDRW
				SHEET 1 OF 1

## X-ON Electronics

Largest Supplier of Electrical and Electronic Components

*Click to view similar products for [HDMI, Displayport & DVI Connectors](#) category:*

*Click to view products by [L-Com](#) manufacturer:*

Other Similar products are found below :

[1775247-3](#) [2-1932649-5](#) [30-1231](#) [30-528](#) [2069485-1](#) [30-504](#) [30-519](#) [30-542](#) [47648-2000](#) [2002-400](#) [TC142X](#) [1453G1](#) [769-103/021-000](#)  
[1932649-1](#) [233-368NFG6-17NH](#) [G45A19071083HR](#) [233-360NF00-17NH](#) [CP30200GM3B](#) [HYC02-DVI29-371](#) [P136-06NHDV4KBP](#)  
[CP30116](#) [LTWDID-29PFFS-SL8001](#) [46765-1301](#) [47271-1004](#) [32-1121-BU](#) [DS1117-BN0-TME-002](#) [MHDR2A11004BP](#) [EHDMI2PKG](#)  
[1903015-3](#) [DS1114-BN0](#) [WPUSBAF](#) [500254-1931](#) [HDMR-19-01-F-SM](#) [47151-1071](#) [1747981-1](#) [0480372000](#) [0482580001](#) [D121073-19](#)  
[472710111](#) [HDMI-S-RA6-SMT-MF-15](#) [P142-000-UP](#) [P134-003](#) [P120-08N](#) [KDMIX-FS1V-WS-B](#) [P142-000-UD](#) [10029449-101RLF](#) [P132-](#)  
[000](#) [P130-000](#) [P142-06N-MICRO](#) [P142-000-MINI](#)