

Illuminated beacons and indicator banks

Contents

General	Pages 2 and 3
---------	---------------

Type XVB

Characteristics	Pages 4 and 5
-----------------	---------------

References	Pages 6 to 12
------------	---------------

Accessories	Page 13
-------------	---------

Dimensions	Pages 14 and 15
------------	-----------------

Type XVD, miniature

Characteristics, dimensions	Page 16
-----------------------------	---------

References	Page 17
------------	---------

Type XVR, rotating mirror beacon

Characteristics, dimensions	Page 18
-----------------------------	---------

References	Page 19
------------	---------

Type XVS, Sirens

Characteristics	Page 20
-----------------	---------

References, dimensions	Page 21
------------------------	---------

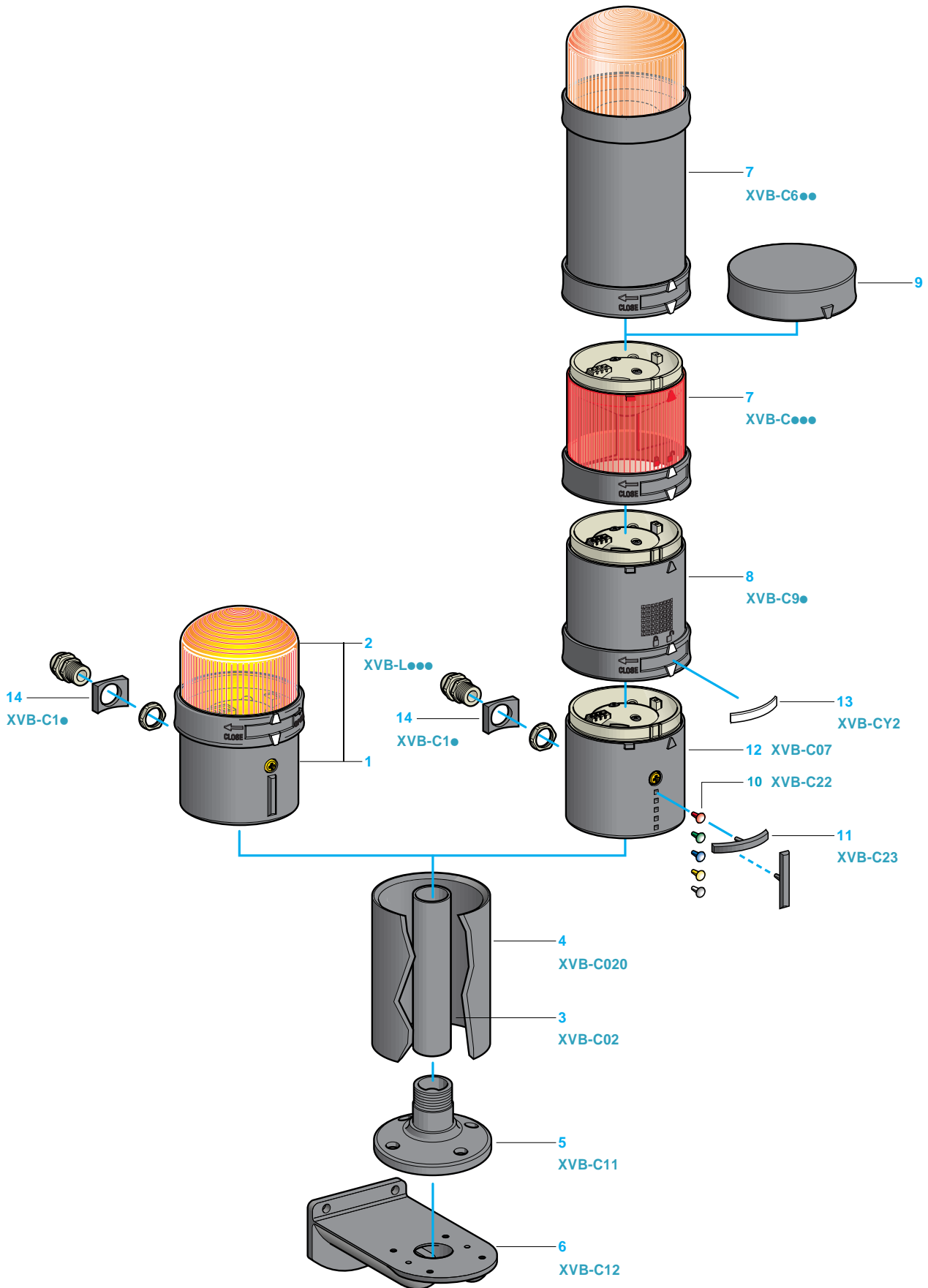

Illuminated beacons and indicator banks

Type XVB

Characteristics :
pages 4 and 5
References :
pages 6 to 13
Dimensions :
pages 14 and 15

General

XVB illuminated beacons and indicator banks are visual or audible signalling units used mainly to indicate machine operation sequences and to check status from a distance. They are visible through 360°. Examples: start, stop machine, no material, call technical staff, fault signalling, etc.

Illuminated beacon

Complete unit

Ready assembled with a single illuminated signalling unit:

- steady,
- flashing,
- or with "flash" discharge tube.

It comprises:

- 1 A base, incorporating a removable terminal block and bottom or side cable entry.
- 2 A coloured lens unit: green, red, orange, blue, clear or yellow

Accessories

- 3 A support tube, 100, 400 or 800 mm long with clamping device on the base
- 4 Support tube concealment cover.
- 5 Fixing plate screwed onto tube for mounting on a horizontal surface.
- 6 Fixing plate for mounting on a vertical surface.
- 14 Adaptor with 13P cable gland.

Indicator bank

For customer assembly

Variable composition, with up to 5 illuminated or audible signalling units, supplied unassembled (for assembly by the user).

It comprises:

- 12 A base, incorporating a removable terminal block and bottom or side cable entry.
- 7 1 to 5 coloured lens units: green, red, orange, blue, clear or yellow
- 8 Or 1 audible signalling unit.
(Maximum of 5 illuminated lens units or 4 illuminated lens units + 1 audible signalling unit).
- 9 A top cover, (except with discharge tube unit).

The illuminated or audible signalling units stack vertically and are easily locked and unlocked by an integral ring nut.

Only one "flash" discharge tube unit can be fitted on each indicator bank, always at the top.

Electrical connections between each unit are made automatically during assembly.

Accessories

- 3 Support tube, 100, 400 or 800 mm long.
- 4 Support tube concealment cover.
- 5 Fixing plate screwed onto tube for mounting on a horizontal surface.
- 6 Fixing plate for mounting on a vertical surface.
- 10 Coloured markers(1).
- 11 Legend holders with legend (1).
- 13 Legends that attach to locking ring of individual signalling units for identification .
- 14 Adaptor and 13P cable gland.

(1) These allow the position of the various units (illuminated or audible) to be marked, for identification in the event of disassembly

Setting up

Fixing

Base mounted directly onto panel by means of 2 screws or by means of a plate screwed to the support tube.

Cabling

By means of a removable terminal block incorporated in the base unit (simplified wiring). The screw and captive cable clamp terminals are protected to prevent accidental contact with live parts.

X-ON Electronics

Largest Supplier of Electrical and Electronic Components

Click to view similar products for [LED Lighting Fixtures](#) category:

Click to view products by [Schneider](#) manufacturer:

Other Similar products are found below :

[1301080067](#) [XVEC21P](#) [XVEC2B7](#) [113163000-00662717](#) [113472000-00691461](#) [LD6A-3DQB-RYG](#) [LD6A-3DZQB-RYG](#) [LF1B-NA3P-2THWW2-3M](#) [LF1B-NC3P-2THWW2-3M](#) [LF1B-ND3P-2THWW2-3M](#) [E35600](#) [NB-RLAMP01-LED](#) [FLK7LED](#) [LD6A-3WQB-RYG](#) [XVC4B3K](#) [XVBC4M7](#) [2702475](#) [2702482](#) [2702935](#) [2702483](#) [2702936](#) [2702485](#) [2702934](#) [ZWF-638-24CW](#) [ZAF-486-24CW](#) [BC5000-N-S](#) [BP3200-C-S-24](#) [BP3200-C-F-12](#) [BP3100-C-S](#) [BC5000-C-S](#) [2702933](#) [2702477](#) [2403122](#) [2403121](#) [2402991](#) [113261000-00641180](#) [113259000-00641174](#) [190007019-00014904](#) [226108019-00610754](#) [4823](#) [4824](#) [4866](#) [4868](#) [E35611](#) [11212573001-00514271](#) [112887037-00076065](#) [113021000-00564565](#) [113473000-00704968](#) [NB-RLAMP01](#) [E35500](#)