

Plug-in units with trapeziform extractor handle, type 1 – front panel, U-profile, shielded

Catalog Number:20848-487

[Back To Product](#)

At 6 U the board position can be offset by 1 HP to the right by swapping the top and bottom board holders. This creates space for SMD components on the left (solder) side. For board thickness 1.6 mm only



Products per Package:
1.0

Products per Package:
1.0

[Change Item >](#)

CHANGING AN ITEM WILL UPDATE THE CATALOG NUMBER. THIS CAN AFFECT THE LIST PRICE AND SPECIFICATION OF THE ITEM.

Other Views

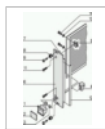

Quantity

[Add Item to Project List](#) ➕

Description

Downloads

Items

Accessories

Plug-in units with trapeziform extractor handle, type 1 – front

Catalog Number 20848-487

Width HP 6.0

EXPLORE

- About Us
- Services & Capabilities
- News and Events
- Strategic Partnerships
- Investor Relations

CONTACT

- Customer Service
- Find a Sales Office or Distributor
- Global Locations
- Product Compliance & Certifications
- Partner Login

DOWNLOAD

- Literature
- White Papers & Case Studies
- Videos & Mobile Apps
- Product Configurators
- Warranties

X-ON Electronics

Largest Supplier of Electrical and Electronic Components

Click to view similar products for [Gate Drivers](#) category:

Click to view products by [Schroff](#) manufacturer:

Other Similar products are found below :

[00028](#) [00053P0231](#) [8967380000](#) [56956](#) [CR7E-30DB-3.96E\(72\)](#) [57.404.7355.5](#) [LT4936](#) [57.904.0755.0](#) [5801-0903](#) [5803-0901](#) [5811-0902](#)
[5813-0901](#) [58410](#) [00576P0030](#) [00581P0070](#) [5882900001](#) [00103P0020](#) [00600P0005](#) [00-9050-LRPP](#) [00-9090-RDPP](#) [5951900000](#) [01-](#)
[1003W-10/32-15](#) [LTI LA6E-1S-WH-RC-FN12VXCR1](#) [0131700000](#) [00-2240](#) [LTP70N06](#) [LVP640](#) [0158-624-00](#) [5J0-1000LG-SIL](#) [020017-13](#)
[LY1D-2-5S-AC120](#) [LY2-0-US-AC120](#) [LY2-US-AC240](#) [LY3-UA-DC24](#) [00-5150](#) [00576P0020](#) [00600P0010](#) [LZNQ2M-US-DC5](#) [LZNQ2-](#)
[US-DC12](#) [LZP40N10](#) [00-8196-RDPP](#) [00-8274-RDPP](#) [00-8275-RDNP](#) [00-8609-RDPP](#) [00-8722-RDPP](#) [00-8728-WHPP](#) [00-8869-RDPP](#) [00-](#)
[9051-RDPP](#) [00-9091-LRPP](#) [00-9291-RDPP](#)