

Automation Technology > Industrial Controls > Switching Devices > Contactors and Contactor Assemblies > Power Contactors for Switching Motors > Contactors SIRIUS 3RT10, 3-pole, 3 ... 250 kW

3RT1015-1BB41 CONTACTOR, AC-3 3 KW/400 V,

Technical / CAx data

Technical Data CAx data



CONTACTOR, AC-3 3 KW/400 V, 1 NO, DC 24 V, 3-POLE, SIZE S00, SCREW CONNECTION

General technical data:

product brand name	SIRIUS
Size of the contactor	S00
Protection class IP / on the front	IP20
Degree of pollution	3
Installation altitude / at a height over sea level / maximum	m 2,000
Ambient temperature / during operating	°C -25...+60
Mechanical operating cycles as operating time	
<ul style="list-style-type: none"> of the contactor / typical 	30,000,000
<ul style="list-style-type: none"> of the contactor with added auxiliary switch block / typical 	10,000,000
<ul style="list-style-type: none"> of the contactor with added electronics-compatible auxiliary switch block / typical 	5,000,000

Main circuit:

Number of NC contacts / for main contacts	0
Number of NO contacts / for main contacts	3
Operational current	
<ul style="list-style-type: none"> at AC-1 / at 400 V 	
<ul style="list-style-type: none"> at 40 °C ambient temperature / rated value 	A 18
<ul style="list-style-type: none"> at 60 °C ambient temperature / rated value 	A 16
<ul style="list-style-type: none"> at AC-3 / at 400 V / rated value 	A 7
<ul style="list-style-type: none"> at AC-4 / at 400 V / rated value 	A 6.5
<ul style="list-style-type: none"> with 1 current path / at DC-1 	
<ul style="list-style-type: none"> at 24 V / rated value 	A 15
<ul style="list-style-type: none"> at 110 V / rated value 	A 1.5
<ul style="list-style-type: none"> with 2 current paths in series / at DC-1 	
<ul style="list-style-type: none"> at 24 V / rated value 	A 15

● at 110 V / rated value	A	8.4
● with 3 current paths in series / at DC-1		
● at 24 V / rated value	A	15
● at 110 V / rated value	A	15
● with 1 current path / at DC-3 / at DC-5		
● at 24 V / rated value	A	15
● at 110 V / rated value	A	0.1
● with 2 current paths in series / at DC-3 / at DC-5		
● at 24 V / rated value	A	15
● at 110 V / rated value	A	0.25
● with 3 current paths in series / at DC-3 / at DC-5		
● at 24 V / rated value	A	15
● at 110 V / rated value	A	15
Service power		
● at AC-2 / at 400 V / rated value	kW	3
● at AC-3 / at 400 V / rated value	kW	3
● at AC-4 / at 400 V / rated value	W	3,000
Control circuit:		
Type of voltage / of the controlled supply voltage		DC
Operating range factor control supply voltage rated value / of the magnet coil		
● for DC		0.85...1.1
Pull-in power / of the solenoid / for DC		W 3.3
Holding power / of the solenoid / for DC		W 3.3
Auxiliary circuit:		
Contact reliability / of the auxiliary contacts		1 faulty switching per 100 million (17 V, 1 mA)
Number of NC contacts / for auxiliary contacts / instantaneous switching		0
Number of NO contacts / for auxiliary contacts / instantaneous switching		1
Short-circuit:		
Design of the fuse link		
● for short-circuit protection of the auxiliary switch / required		fuse gL/gG: 10 A
● for short-circuit protection of the main circuit		
● with type of assignment 1 / required		fuse gL/gG: 35 A
● at type of coordination 2 / required		fuse gL/gG: 20 A
Installation/mounting/dimensions:		
Type of mounting		screw and snap-on mounting onto 35 mm standard mounting rail according to DIN EN 50022
series installation		Yes
Width	mm	45
Height	mm	57.5
Depth	mm	72
Distance, to be maintained, to earthed part / sideways	mm	6
Connection type:		
Design of the electrical connection		
● for main current circuit		screw-type terminals
● for auxiliary and control current circuit		screw-type terminals
Type of the connectable conductor cross-section		
● for main contacts		

- | | |
|--|--|
| <ul style="list-style-type: none"> ● solid | 2x (0.5 ... 1.5 mm ²), 2x (0.75 ... 2.5 mm ²), max. 2x (0.75 ... 4 mm ²) |
| <ul style="list-style-type: none"> ● finely stranded <ul style="list-style-type: none"> ● with conductor end processing | 2x (0.5 ... 1.5 mm ²), 2x (0.75 ... 2.5 mm ²) |
| <ul style="list-style-type: none"> ● for AWG conductors / for main contacts | 2x (20 ... 16), 2x (18 ... 14), 1x 12 |
| <ul style="list-style-type: none"> ● for auxiliary contacts <ul style="list-style-type: none"> ● solid | 2x (0.5 ... 1.5 mm ²), 2x (0.75 ... 2.5 mm ²), max. 2x (0.75 ... 4 mm ²) |
| <ul style="list-style-type: none"> ● finely stranded <ul style="list-style-type: none"> ● with conductor end processing | 2x (0.5 ... 1.5 mm ²), 2x (0.75 ... 2.5 mm ²) |
| <ul style="list-style-type: none"> ● for AWG conductors / for auxiliary contacts | 2x (20 ... 16), 2x (18 ... 14), 1x 12 |

Certificates/approvals:

General Product Approval



CCC



CSA



GOST



KETI



UL



UR

Declaration of Conformity



EG-Konf.

Test Certificates

other

Special Test Certificate

Shipping Approval



ABS

BUREAU
VERITAS

DNV



GL



LRS



PRS

Shipping Approval



RINA



RMRS

other

Confirmation

other

Environmental
Confirmations

Further information:

Information- and Downloadcenter (Catalogs, Brochures,...)

<http://www.siemens.com/industrial-controls/catalogs>

Industry Mall (Online ordering system)

<http://www.siemens.com/industrial-controls/mall>

Cax online generator:

<http://www.siemens.com/cax>

Service&Support (Manuals, Certificates, Characteristics, FAQs,...)

<https://support.automation.siemens.com/WW/view/en/3RT1015-1BB41/all>

Image database (product images, 2D dimension drawings, 3D models, device circuit diagrams, ...)

https://www.automation.siemens.com/bilddb/cax_en.aspx?mlfb=3RT1015-1BB41

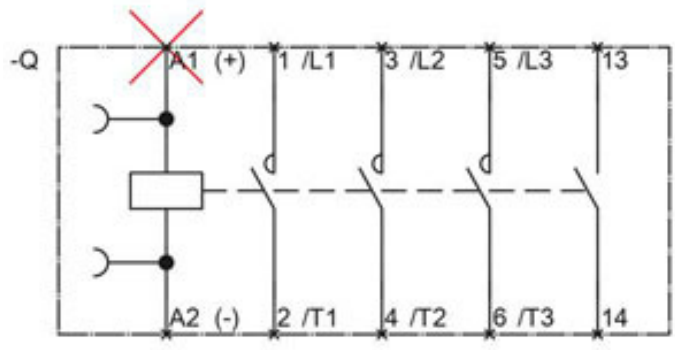
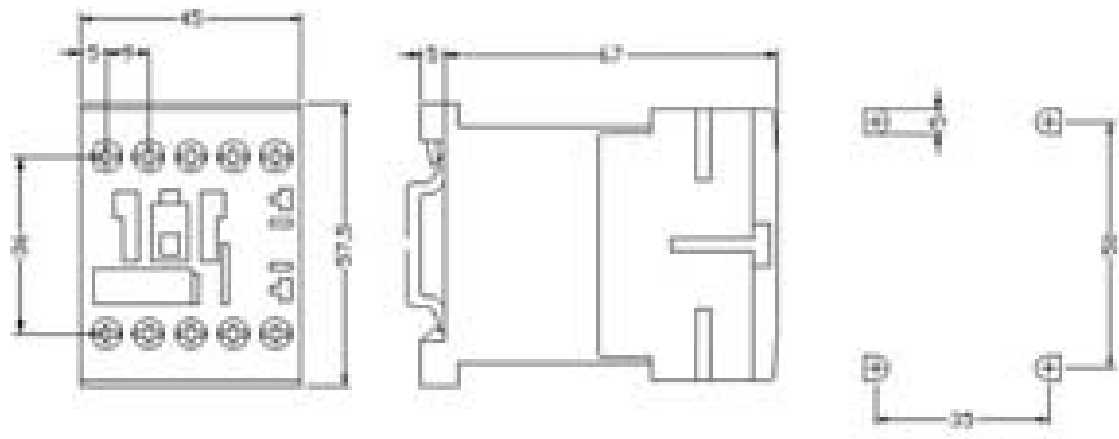

last change:

May 20, 2013

X-ON Electronics

Largest Supplier of Electrical and Electronic Components

Click to view similar products for [Solid State Relays - Industrial Mount](#) category:

Click to view products by [Siemens](#) manufacturer:

Other Similar products are found below :

[6225XXASRS-DC3](#) [D2440-C](#) [H10CA4890](#) [D4875C](#) [D53TP50DH-10](#) [1395831-1](#) [1616010-6](#) [BR312BY](#) [A-1326](#) [AQY210SXE01](#)
[AQY221N2SYD01](#) [AQY414SXE01](#) [26532764](#) [H10CA4850](#) [H12CA4890VL](#) [RA2410-D06](#) [D1202F](#) [D53TP50-10](#) [W230E-1-12](#) [W230T-3-](#)
[12](#) [W6125ASX-1](#) [W6225DSX-2](#) [W6240DSX-4](#) [W6240DTX-2](#) [1-1617030-3](#) [1-1617033-9](#) [1-1617033-7](#) [MS2-D2420](#) [MS2-D2430](#) [A-1440](#)
[4-1617080-0](#) [RJ1P60V50E](#) [RN1F48I50](#) [70.362.1028.0](#) [7-1393030-8](#) [Z5.509.0828.0](#) [W230E-2-5](#) [G3RV-SR700-D](#) [AC110](#) [G3RV-SR500-AL](#)
[AC100](#) [G3RV-SR500-D](#) [ACDC24](#) [G3RV-SR500-AL](#) [ACDC24](#) [G3RV-SR700-D](#) [ACDC24](#) [G3RV-SR700-AL](#) [ACDC24](#) [G3RV-SR500-D](#)
[DC12](#) [G3RV-SR700-A](#) [ACDC24](#) [G3RV-SR500-A](#) [ACDC24](#) [2912138](#) [2912141](#) [SSRDAC10](#) [1613353](#)