

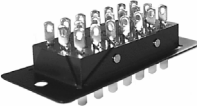





Panel Mount Plugs and Sockets

| | | |
|---|---|--------------------------|
|  | Angle Bracket, Angle Bracket Tapped, Without Angle Bracket | |
| | 38330, 38336 | p. 2-3 |
| | 38540 | p. 16-17 |
|  | Shallow Bracket | |
| | 38330 | p. 4-5 |
| | 38542 | p. 18-19 |
|  | Deep Bracket | |
| | 38330, 38336 | p. 6-7 |
| | 38540 | p. 20-21 |

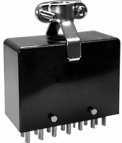
Cable Mount Plugs and Sockets

| | | |
|---|---|--------------------------|
|  | Cable Clamp End | |
| | 38331, 38336 | p. 8-9 |
| | 38541 | p. 22-23 |
|  | Cable Clamp Top, Cable Clamp Top with Keeper, Cable Clamp Top with Latch | |
| | 38330, 38331, 38336 | p. 10-11 |
| | 38541 | p. 24-25 |
|  | Flared Hole End | |
| | 38330, 38336 | p. 12-13 |
| | 38540 | p. 26-27 |
|  | Flared Hole Top | |
| | 38330, 38331, 38336 | p. 14-15 |
| | 38540 | p. 28-29 |



FEATURES AND SPECIFICATIONS

Features and Benefits

- Sizes 2 to 33 circuits
- Robust blade contacts resist damage from improper mating
- Large surface area of dual wipe female contact produces maximum current capacity
- No de-rating required. All circuits rated for full current load
- Extra long pre-grounding contact engages before any other contacts for greater safety.

Electrical

Voltage: 250V
Maximum Current: 10 Amp

Mechanical

Operating Temperature: 150°C

Physical

Base Insulator: High-grade phenolic, black
Plug Contact: Brass
Plug Contact Plating: Tin
Socket Contact: Phosphor bronze
Socket Contact Plating: Tin
Pre-grounding Contact: Heavy-duty plated brass

Reference Information

UL : File E34763
CSA: File 22156

Beau™ Power Connectors Panel Mount Plugs and Sockets

38330, 38336

Angled Bracket (AB) Angle Bracket Tapped (ABT) Less Angle Bracket (LAB)



SUGGESTED PANEL MOUNTING DIMENSIONS

CONTACT TAILS

Molex offers a wide selection of contact tails. Consult factory for availability and part numbers of other styles

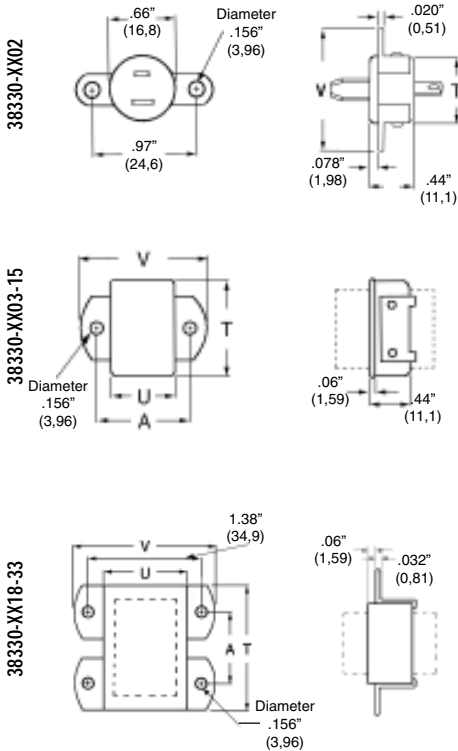

Fig. D

Fig. E

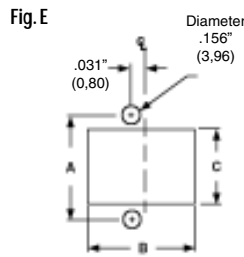
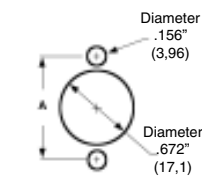
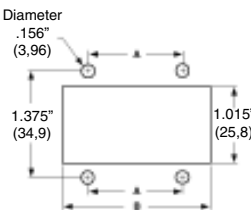
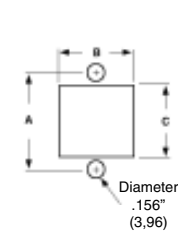
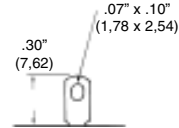

Fig. F

Fig. G



P Solder Eye (Standard)



P₁ Printed Circuit and Wire Wrap, Short

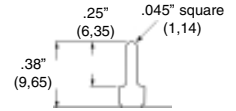

S₁ Quick Connect

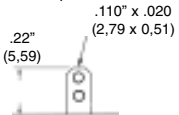

P₁ Quick Connect

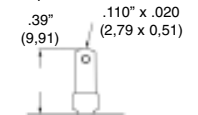

S Solder Eye (Standard)

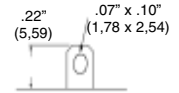

S₁ Printed Circuit

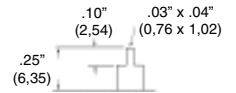

P₁ Wire Wrap, Long

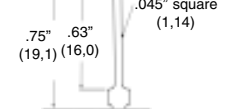

Contact Orientation

The polarization arrangement numbers shown below are for sockets, as viewed from the wiring side. Plug numbering is the opposite. A heavy-duty polarizing/grounding contact is in position 14 for Nos. 3324, 3327, 3330 and in position 17 for No. 3333. * Indicates location of pre-grounding contact. † Pregrounding contact is standard.



38330-XX02



38330-XX03



38330-XX04

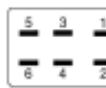

38330-XX06



38336-8XXX

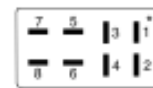

38330-XX08

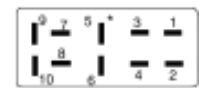

38330-XX10



38330-XX12



38330-XX15 to 38330-XX21



38330-XX24 to 38330-XX30

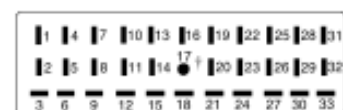

38330-XX33

ORDERING INFORMATION AND DIMENSIONS



**Beau™ Power Connectors
Panel Mount Plugs and Sockets**

38330, 38336

| Part# | T | | U | | V | |
|--------|------|------|------|------|------|------|
| | in | mm | in | mm | in | mm |
| 3302* | 0.66 | 16,7 | -- | -- | 1.27 | 32,1 |
| 3303 | 1.00 | 25,4 | .44 | 11,1 | 1.06 | 27,0 |
| 3304 | 0.75 | 19,1 | .69 | 17,5 | 1.31 | 33,3 |
| 3306 | 1.00 | 25,4 | .69 | 17,5 | 1.31 | 33,3 |
| 3306-8 | 1.00 | 25,4 | .69 | 17,5 | 1.31 | 33,3 |
| 3308 | 1.25 | 31,8 | .69 | 17,5 | 1.31 | 33,3 |
| 3310 | 1.56 | 39,7 | .69 | 17,5 | 1.31 | 33,3 |
| 3312 | 1.25 | 31,8 | .94 | 23,8 | 1.56 | 39,7 |
| 3315 | 1.63 | 41,3 | 1.00 | 25,4 | 1.69 | 42,9 |
| 3318 | 1.94 | 49,2 | 1.00 | 25,4 | 1.69 | 42,9 |
| 3321 | 2.25 | 57,2 | 1.00 | 25,4 | 1.69 | 42,9 |
| 3324 | 2.56 | 65,1 | 1.00 | 25,4 | 1.69 | 42,9 |
| 3327 | 2.88 | 73,0 | 1.00 | 25,4 | 1.69 | 42,9 |
| 3330 | 3.19 | 81,0 | 1.00 | 25,4 | 1.69 | 42,9 |
| 3333 | 3.50 | 88,9 | 1.00 | 25,4 | 1.69 | 42,9 |

| Part # | Fig.# | A | | B | | C | |
|--------|-------|-------|------|-------|------|-------|------|
| | | in | mm | in | mm | in | mm |
| 3302* | D | .969 | 24,6 | -- | -- | -- | -- |
| 3303 | E | .750 | 19,1 | 1.016 | 25,8 | .453 | 11,5 |
| 3304 | F | 1.000 | 25,4 | .781 | 19,8 | .719 | 18,3 |
| 3306 | E | 1.000 | 25,4 | 1.031 | 26,2 | .719 | 18,3 |
| 3306-8 | E | 1.000 | 25,4 | 1.031 | 26,2 | .719 | 18,3 |
| 3308 | F | 1.000 | 25,4 | 1.281 | 32,5 | .719 | 18,3 |
| 3310 | F | 1.000 | 25,4 | 1.578 | 40,1 | .719 | 18,3 |
| 3312 | F | 1.250 | 31,8 | 1.266 | 32,2 | .953 | 24,2 |
| 3315 | F | 1.375 | 34,9 | 1.640 | 41,7 | 1.016 | 25,8 |
| 3318 | G | 1.250 | 31,8 | 1.953 | 49,6 | -- | -- |
| 3321 | G | .938 | 23,8 | 2.265 | 57,5 | -- | -- |
| 3324 | G | 1.250 | 31,8 | 2.578 | 65,5 | -- | -- |
| 3327 | G | 1.562 | 39,7 | 2.890 | 73,4 | -- | -- |
| 3330 | G | 1.875 | 47,6 | 3.203 | 81,4 | -- | -- |
| 3333 | G | 2.188 | 55,6 | 3.515 | 89,3 | -- | -- |

PLUGS

| Angle Bracket (-AB) | | Angle Bracket Tapped (-ABT) | | Less Angle Bracket (-LAB) | |
|---------------------|---------------|-----------------------------|---------------|---------------------------|---------------|
| Order # | Engineering # | Order # | Engineering # | Order # | Engineering # |
| 38330-0102 | P-3302-AB | 38330-1502 | P-3302-ABT | 38330-2202 | P-3302-LAB |
| 38330-0103 | P-3303-AB | 38330-1503 | P-3303-ABT | 38330-2203 | P-3303-LAB |
| 38330-0104 | P-3304-AB | 38330-1504 | P-3304-ABT | 38330-2204 | P-3304-LAB |
| 38330-0106 | P-3306-AB | 38330-1506 | P-3306-ABT | 38330-2206 | P-3306-LAB |
| 38336-8001 | P-3306-8-AB | 38336-8015 | P-3306-8-ABT | 38336-8022 | P-3306-8-LAB |
| 38330-0108 | P-3308-AB | 38330-1508 | P-3308-ABT | 38330-2208 | P-3308-LAB |
| 38330-0110 | P-3310-AB | 38330-1510 | P-3310-ABT | 38330-2210 | P-3310-LAB |
| 38330-0112 | P-3312-AB | 38330-1512 | P-3312-ABT | 38330-2212 | P-3312-LAB |
| 38330-0115 | P-3315-AB | 38330-1515 | P-3315-ABT | 38330-2215 | P-3315-LAB |
| 38330-0118 | P-3318-AB | 38330-1518 | P-3318-ABT | 38330-2218 | P-3318-LAB |
| 38330-0121 | P-3321-AB | 38330-1521 | P-3321-ABT | 38330-2221 | P-3321-LAB |
| 38330-0124 | P-3324-AB | 38330-1524 | P-3324-ABT | 38330-2224 | P-3324-LAB |
| 38330-0127 | P-3327-AB | 38330-1527 | P-3327-ABT | 38330-2227 | P-3327-LAB |
| 38330-0130 | P-3330-AB | 38330-1530 | P-3330-ABT | 38330-2230 | P-3330-LAB |
| 38330-0133 | P-3333-AB | 38330-1533 | P-3333-ABT | 38330-2233 | P-3333-LAB |

SOCKETS

| Angle Bracket (-AB) | | Angle Bracket Tapped (-ABT) | | Less Angle Bracket (-LAB) | |
|---------------------|---------------|-----------------------------|---------------|---------------------------|---------------|
| Order # | Engineering # | Order # | Engineering # | Order # | Engineering # |
| 38330-0502 | S-3302-AB | 38330-1902 | S-3302-ABT | 38330-2602 | S-3302-LAB |
| 38330-0503 | S-3303-AB | 38330-1903 | S-3303-ABT | 38330-2603 | S-3303-LAB |
| 38330-0504 | S-3304-AB | 38330-1904 | S-3304-ABT | 38330-2604 | S-3304-LAB |
| 38330-0506 | S-3306-AB | 38330-1906 | S-3306-ABT | 38330-2606 | S-3306-LAB |
| 38336-8005 | S-3306-8-AB | 38336-8019 | S-3306-8-ABT | 38336-8026 | S-3306-8-LAB |
| 38330-0508 | S-3308-AB | 38330-1908 | S-3308-ABT | 38330-2608 | S-3308-LAB |
| 38330-0510 | S-3310-AB | 38330-1910 | S-3310-ABT | 38330-2610 | S-3310-LAB |
| 38330-0512 | S-3312-AB | 38330-1912 | S-3312-ABT | 38330-2612 | S-3312-LAB |
| 38330-0515 | S-3315-AB | 38330-1915 | S-3315-ABT | 38330-2615 | S-3315-LAB |
| 38330-0518 | S-3318-AB | 38330-1918 | S-3318-ABT | 38330-2618 | S-3318-LAB |
| 38330-0521 | S-3321-AB | 38330-1921 | S-3321-ABT | 38330-2621 | S-3321-LAB |
| 38330-0524 | S-3324-AB | 38330-1924 | S-3324-ABT | 38330-2624 | S-3324-LAB |
| 38330-0527 | S-3327-AB | 38330-1927 | S-3327-ABT | 38330-2627 | S-3327-LAB |
| 38330-0530 | S-3330-AB | 38330-1930 | S-3330-ABT | 38330-2630 | S-3330-LAB |
| 38330-0533 | S-3333-AB | 38330-1933 | S-3333-ABT | 38330-2633 | S-3333-LAB |



Beau™ Power Connectors Panel Mount Plugs and Sockets

FEATURES AND SPECIFICATIONS

Features and Benefits

- Sizes 15 to 33 circuits
- Robust blade contacts resist damage from improper mating
- Large surface area of dual wipe female contact produces maximum current capacity
- No de-rating required. All circuits rated for full current load
- Extra long pre-grounding contact engages before any other contacts for greater safety.

Reference Information

UL: File E34763
CSA: File 22156

Electrical

Voltage: 250V
Maximum Current: 10 Amp

Mechanical

Operating Temperature: 150°C

Physical

Base Insulator: High-grade phenolic, black
Plug Contact: Brass
Plug Contact Plating: Tin
Socket Contact: Phosphor bronze
Socket Contact Plating: Tin
Pre-grounding Contact: Heavy-duty plated brass

38330 Shallow Bracket (SB)

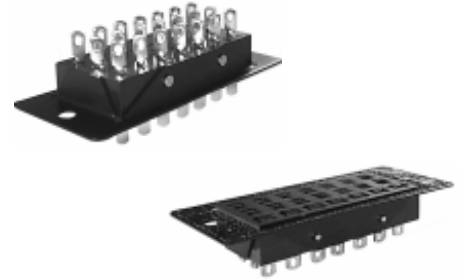

SUGGESTED PANEL MOUNTING DIMENSIONS

CONTACT TAILS

Molex offers a wide selection of contact tails. Consult factory for availability and part numbers of other styles

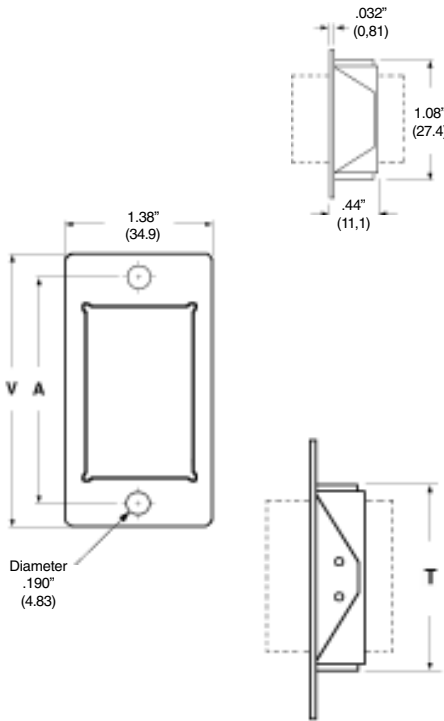
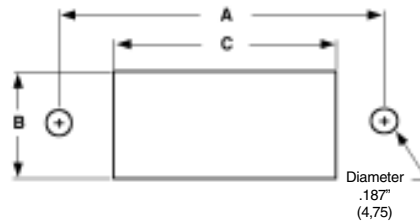
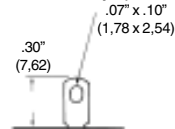

Fig. K



P Solder Eye (Standard)



P₂ Printed Circuit and Wire Wrap, Short

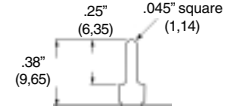

S₁ Quick Connect

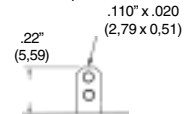

P₁ Quick Connect

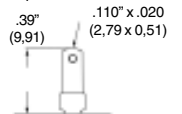

S Solder Eye (Standard)

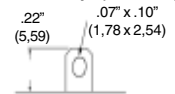

S₆ Printed Circuit

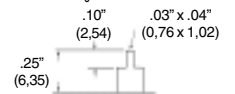

P₄ Wire Wrap, Long

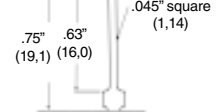

Contact Orientation

The polarization arrangement numbers shown below are for sockets, as viewed from the wiring side. Plug numbering is the opposite. A heavy-duty polarizing/ground contact is in position 14 for Nos. 3324, 3327, 3330 and in position 17 for No. 3333.



38330-XX15 to 38330-XX21



38330-XX24 to 38330-XX30

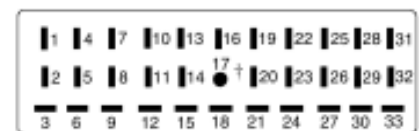

38330-XX33

• Indicates location of pre-grounding contact. † Pre-grounding contact is standard

ORDERING INFORMATION AND DIMENSIONS



**Beau™ Power Connectors
Panel Mount Plugs and Sockets**

38330

| Part# | T | | V | |
|-------|------|------|------|------|
| | in | mm | in | mm |
| 3315 | 1.69 | 42.9 | 2.55 | 58.7 |
| 3318 | 2.00 | 50.8 | 2.86 | 66.7 |
| 3321 | 2.31 | 58.7 | 3.17 | 74.6 |
| 3324 | 2.63 | 66.7 | 3.48 | 82.6 |
| 3327 | 2.94 | 74.6 | 3.80 | 90.5 |
| 3330 | 3.25 | 82.6 | 4.11 | 98.4 |
| 3333 | 3.56 | 90.5 | 4.42 | 106 |

| Part # | Fig. # | A | | B | | C | |
|--------|--------|-------|------|-------|------|-------|------|
| | | in | mm | in | mm | in | mm |
| 3315 | K | 2.125 | 54,0 | 1.156 | 29,4 | 1.750 | 44,5 |
| 3318 | K | 2.437 | 61,9 | 1.156 | 29,4 | 2.062 | 52,4 |
| 3321 | K | 2.750 | 69,9 | 1.156 | 29,4 | 2.375 | 60,3 |
| 3324 | K | 3.062 | 77,8 | 1.156 | 29,4 | 2.687 | 68,2 |
| 3327 | K | 3.375 | 85,7 | 1.156 | 29,4 | 3.000 | 76,2 |
| 3330 | K | 3.687 | 93,6 | 1.156 | 29,4 | 3.312 | 84,1 |
| 3333 | K | 4.000 | 102 | 1.156 | 29,4 | 3.625 | 92,1 |

| PLUGS | | SOCKETS | |
|-----------------------|---------------|-----------------------|---------------|
| Shallow Bracket (-SB) | | Shallow Bracket (-SB) | |
| Order # | Engineering # | Order # | Engineering # |
| 38330-6415 | P-3315-SB | 38330-6815 | S-3315-SB |
| 38330-6418 | P-3318-SB | 38330-6818 | S-3318-SB |
| 38330-6421 | P-3321-SB | 38330-6821 | S-3321-SB |
| 38330-6424 | P-3324-SB | 38330-6824 | S-3324-SB |
| 38330-6427 | P-3327-SB | 38330-6827 | S-3327-SB |
| 38330-6430 | P-3330-SB | 38330-6830 | S-3330-SB |
| 38330-6433 | P-3333-SB | 38330-6833 | S-3333-SB |



Beau™ Power Connectors Panel Mount Plugs and Sockets

FEATURES AND SPECIFICATIONS

Features and Benefits

- Sizes 2 to 33 circuits
- Robust blade contacts resist damage from improper mating
- Large surface area of dual wipe female contact produces maximum current capacity
- No de-rating required. All circuits rated for full current load
- Extra long pre-grounding contact engages before any other contacts for greater safety.

Reference Information

UL : File E34763
CSA : File 22156

Electrical

Voltage: 250V
Maximum Current: 10 Amp

Mechanical

Operating Temperature: 150°C

Physical

Base Insulator: High-grade phenolic, black
Plug Contact: Brass
Plug Contact Plating: Tin
Socket Contact: Phosphor bronze
Socket Contact Plating: Tin
Pre-grounding Contact: Heavy-duty plated brass

38330, 38336
Deep Bracket



SUGGESTED PANEL MOUNTING DIMENSIONS

CONTACT TAILS

Molex offers a wide selection of contact tails. Consult factory for availability and part numbers of other styles

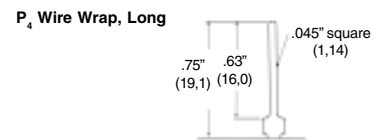
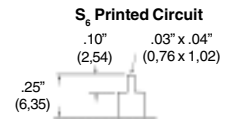
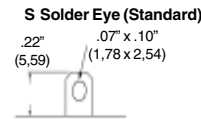
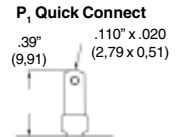
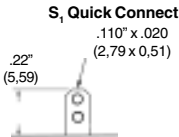
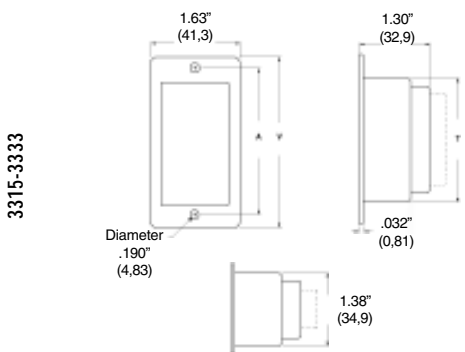
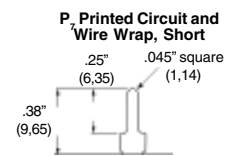
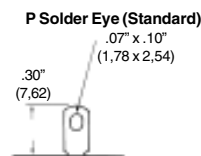
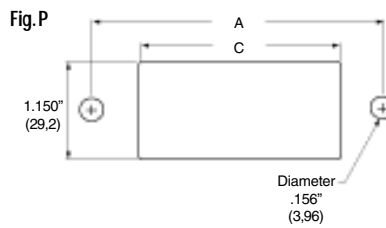
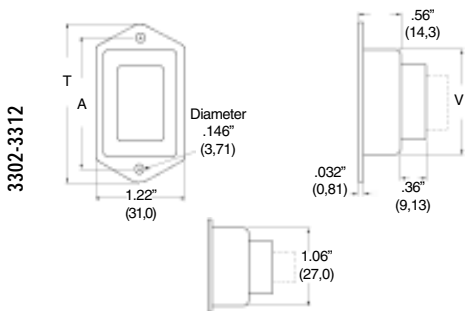

Contact Orientation

The polarization arrangement numbers shown below are for sockets, as viewed from the wiring side. Plug numbering is the opposite. A heavy-duty polarizing/ground contact is in position 14 for Nos. 3324, 3327, 3330 and in position 17 for No. 3333.

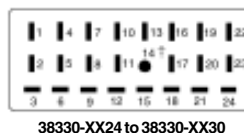
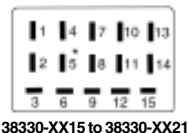
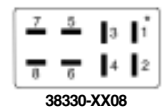
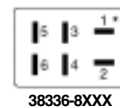

* Indicates location of pre-grounding contact. † Pre-grounding contact is standard

ORDERING INFORMATION AND DIMENSIONS



**Beau™ Power Connectors
Panel Mount Plugs and Sockets**

38330, 38336

| Part# | T | | V | |
|--------|------|------|------|------|
| | in | mm | in | mm |
| 3302* | 1.38 | 34.9 | 2.11 | 53.6 |
| 3303 | 1.38 | 34.9 | 2.11 | 53.6 |
| 3304 | 1.38 | 34.9 | 2.11 | 53.6 |
| 3306 | 1.38 | 34.9 | 2.11 | 53.6 |
| 3306-8 | 1.38 | 34.9 | 2.11 | 53.6 |
| 3308 | 1.38 | 34.9 | 2.11 | 53.6 |
| 3312 | 1.38 | 34.9 | 2.11 | 53.6 |
| 3315 | 2.00 | 50.8 | 2.81 | 71.4 |
| 3318 | 2.31 | 58.7 | 3.13 | 79.4 |
| 3321 | 2.63 | 66.7 | 3.44 | 87.3 |
| 3324 | 2.94 | 74.6 | 3.75 | 95.3 |
| 3327 | 3.25 | 82.6 | 4.06 | 103 |
| 3330 | 3.56 | 90.5 | 4.38 | 111 |
| 3333 | 3.88 | 98.4 | 4.69 | 119 |

| Part # | Fig. # | A | | C | |
|--------|--------|-------|------|-------|------|
| | | in | mm | in | mm |
| 3302* | P | 1.750 | 44.5 | 1.500 | 38.1 |
| 3303 | P | 1.750 | 44.5 | 1.500 | 38.1 |
| 3304 | P | 1.750 | 44.5 | 1.500 | 38.1 |
| 3306 | P | 1.750 | 44.5 | 1.500 | 38.1 |
| 3306-8 | P | 1.750 | 44.5 | 1.500 | 38.1 |
| 3308 | P | 1.750 | 44.5 | 1.500 | 38.1 |
| 3312 | P | 1.750 | 44.5 | 1.500 | 38.1 |
| 3315 | Q | 2.375 | 60.3 | 2.000 | 50.8 |
| 3318 | Q | 2.687 | 68.2 | 2.312 | 58.7 |
| 3321 | Q | 3.000 | 76.2 | 2.625 | 66.7 |
| 3324 | Q | 3.312 | 84.1 | 2.937 | 74.6 |
| 3327 | Q | 3.625 | 92.1 | 3.250 | 82.6 |
| 3330 | Q | 3.937 | 100 | 3.562 | 90.5 |
| 3333 | Q | 4.250 | 108 | 3.875 | 98.4 |

| PLUGS | | SOCKETS | |
|--------------------|---------------|--------------------|---------------|
| Deep Bracket (-DB) | | Deep Bracket (-DB) | |
| Order # | Engineering # | Order # | Engineering # |
| 38330-5702 | P-3302-DB | 38330-6102 | S-3302-DB |
| 38330-5703 | P-3303-DB | 38330-6103 | S-3303-DB |
| 38330-5704 | P-3304-DB | 38330-6104 | S-3304-DB |
| 38330-5706 | P-3306-DB | 38330-6106 | S-3306-DB |
| 38336-8057 | P-3306-8-DB | 38336-8061 | S-3306-8-DB |
| 38330-5708 | P-3308-DB | 38330-6108 | S-3308-DB |
| 38330-5712 | P-3312-DB | 38330-6112 | S-3312-DB |
| 38330-5715 | P-3315-DB | 38330-6115 | S-3315-DB |
| 38330-5718 | P-3318-DB | 38330-6118 | S-3318-DB |
| 38330-5721 | P-3321-DB | 38330-6121 | S-3321-DB |
| 38330-5724 | P-3324-DB | 38330-6124 | S-3324-DB |
| 38330-5727 | P-3327-DB | 38330-6127 | S-3327-DB |
| 38330-5730 | P-3330-DB | 38330-6130 | S-3330-DB |
| 38330-5733 | P-3333-DB | 38330-6133 | S-3333-DB |



Beau™ Power Connectors Cable Mount Plugs and Sockets

FEATURES AND SPECIFICATIONS

Features and Benefits

- Sizes 3 to 33 circuits
- Robust blade contacts resist damage from improper mating
- Large surface area of dual wipe female contact produces maximum current capacity
- No de-rating required. All circuits rated for full current load
- Extra long pre-grounding contact engages before any other contacts for greater safety.
- Strain relief cable clamps, used with round or flat cable

Electrical

Voltage: 250V
Maximum Current: 10 Amp

Mechanical

Operating Temperature: 110°C

Physical

Base Insulator: High-grade phenolic, black
Plug Contact: Brass
Plug Contact Plating: Tin
Socket Contact: Phosphor bronze
Socket Contact Plating: Tin

38331, 38336 Cable Clamp End (CCE)



Reference Information

UL: File E34763 CSA: File 22156

CONTACT TAILS

Molex offers a wide selection of contact tails. Consult factory for availability and part numbers of other styles

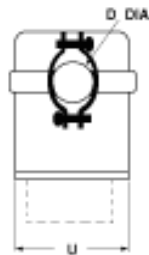
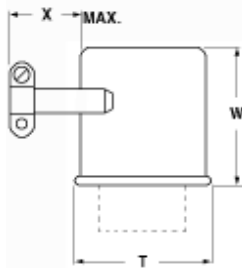

P Solder Eye (Standard)

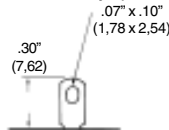

P₁ Printed Circuit and Wire Wrap, Short

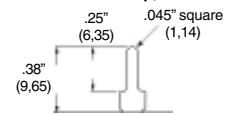

S, Quick Connect

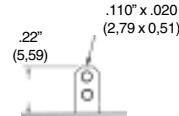

P₁ Quick Connect

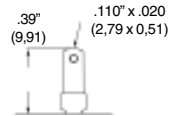

S Solder Eye (Standard)

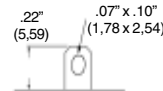

S₂ Printed Circuit

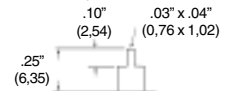

P₄ Wire Wrap, Long

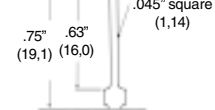

Contact Orientation

The polarization arrangement numbers shown below are for sockets, as viewed from the wiring side. Plug numbering is the opposite. A heavy-duty polarizing/ground contact is in position 14 for Nos. 3324, 3327, 3330 and in position 17 for No. 3333.



38330-XX03



38330-XX04

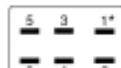

38330-XX06

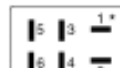

38336-8XXX

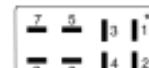

38330-XX08

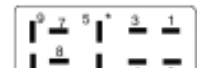

38330-XX10

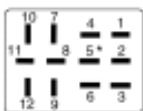

38330-XX12

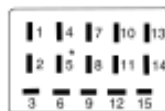

38330-XX15 to 38330-XX21



38330-XX24 to 38330-XX30



38330-XX33

* Indicates location of pre-grounding contact. † Pre-grounding contact is standard

ORDERING INFORMATION AND DIMENSIONS



Beau™ Power Connectors Cable Mount Plugs and Sockets

38330, 38336

| Part# | D | | T | | U | | W | | X | |
|--------|-----|------|------|------|------|------|------|------|-----|------|
| | in | mm | in | mm | in | mm | in | mm | in | mm |
| 3303 | .31 | 7.9 | 1.00 | 25.4 | .44 | 11.1 | .97 | 24.6 | .50 | 12.7 |
| 3304 | .38 | 9.5 | .75 | 25.4 | .69 | 17.5 | .97 | 24.6 | .50 | 12.7 |
| 3306 | .44 | 11.1 | 1.00 | 25.4 | .69 | 17.5 | 1.06 | 27.0 | .50 | 12.7 |
| 3306-8 | .44 | 11.1 | 1.00 | 25.4 | .69 | 17.5 | 1.06 | 27.0 | .50 | 12.7 |
| 3308 | .50 | 12.7 | 1.25 | 31.8 | .69 | 17.5 | 1.06 | 27.0 | .50 | 12.7 |
| 3310 | .50 | 12.7 | 1.56 | 39.7 | .69 | 17.5 | 1.19 | 30.2 | .50 | 12.7 |
| 3312 | .56 | 14.3 | 1.25 | 31.8 | .94 | 23.8 | 1.19 | 30.2 | .50 | 12.7 |
| 3315 | .56 | 14.3 | 1.78 | 45.2 | 1.16 | 29.4 | 1.75 | 44.5 | .75 | 19.1 |
| 3318 | .56 | 14.3 | 2.08 | 52.8 | 1.16 | 29.4 | 1.75 | 44.5 | .75 | 19.1 |
| 3321 | .63 | 15.9 | 2.34 | 59.5 | 1.16 | 29.4 | 1.75 | 44.5 | .75 | 19.1 |
| 3324 | .63 | 15.9 | 2.78 | 70.6 | 1.16 | 29.4 | 1.75 | 44.5 | .75 | 19.1 |
| 3327 | .63 | 15.9 | 3.00 | 76.2 | 1.16 | 29.4 | 1.75 | 44.5 | .75 | 19.1 |
| 3330 | .75 | 19.0 | 3.34 | 84.9 | 1.16 | 29.4 | 1.75 | 44.5 | .75 | 19.1 |
| 3333 | .75 | 19.0 | 3.66 | 92.9 | 1.16 | 29.4 | 1.75 | 44.5 | .75 | 19.1 |

| For Connector size | Clamp opening dia., in. (mm) | | Clamp Number |
|--|------------------------------|-------------|--------------|
| | min | max | |
| Standard Clamps Sizes | | | |
| 3833X-XX02 | .13" (3,3) | .38" (9,7) | - |
| 3833X-XX03 | .13" (3,3) | .38" (9,7) | - |
| 3833X-XX04 thru 3833X-XX12 | .22" (5,6) | .50" (12,7) | - |
| 3833X-XX15 thru 3833X-XX18 | .38" (9,7) | .72" (18,3) | - |
| 3833X-XX21 thru 3833X-XX33 | .38" (9,7) | .84" (21,3) | - |
| Clamp Options | | | |
| 3833X-XX15 thru 3833X-XX33 | .45" (11,4) | .91" (23,1) | 78 |
| 3833X-XX15 thru 3833X-XX33 for Mating with Deep Bracket (DB) | .38" (9,7) | .72" (18,3) | 47 |

| PLUGS | | SOCKETS | |
|-----------------------|---------------|-----------------------|---------------|
| Cable Clamp End (CCE) | | Cable Clamp End (CCE) | |
| Order # | Engineering # | Order # | Engineering # |
| 38331-1403 | P-3303-CCE | 38331-3803 | S-3303-CCE |
| 38331-1404 | P-3304-CCE | 38331-3804 | S-3304-CCE |
| 38331-1406 | P-3306-CCE | 38331-3806 | S-3306-CCE |
| 38336-8114 | P-3306-8-CCE | 38336-8138 | S-3306-8-CCE |
| 38331-1408 | P-3308-CCE | 38331-3808 | S-3308-CCE |
| 38331-1410 | P-3310-CCE | 38331-3810 | S-3310-CCE |
| 38331-1412 | P-3312-CCE | 38331-3812 | S-3312-CCE |
| 38331-1415 | P-3315-CCE | 38331-3815 | S-3315-CCE |
| 38331-1418 | P-3318-CCE | 38331-3818 | S-3318-CCE |
| 38331-1421 | P-3321-CCE | 38331-3821 | S-3321-CCE |
| 38331-1424 | P-3324-CCE | 38331-3824 | S-3324-CCE |
| 38331-1427 | P-3327-CCE | 38331-3827 | S-3327-CCE |
| 38331-1430 | P-3330-CCE | 38331-3830 | S-3330-CCE |
| 38331-1433 | P-3333-CCE | 38331-3833 | S-3333-CCE |



Beau™ Power Connectors Cable Mount Plugs and Sockets

FEATURES AND SPECIFICATIONS

Features and Benefits

- Sizes 2 to 33 circuits
- Robust blade contacts resist damage from improper mating
- Large surface area of dual wipe female contact produces maximum current capacity
- No de-rating required. All circuits rated for full current load
- Extra long pre-grounding contact engages before any other contacts for greater safety.

Electrical

Voltage: 250V
Maximum Current: 10 Amp

Mechanical

Operating Temperature: 110°C

Physical

Base Insulator: High-grade phenolic, black
Plug Contact: Brass
Plug Contact Plating: Tin
Socket Contact: Phosphor bronze
Socket Contact Plating: Tin
Pre-grounding Contact: Heavy-duty plated brass

38330, 38331, 38336

Cable Clamp Top (CCT)
Cable Clamp Top w/ Keeper (CCT-K)
Cable Clamp Top w/ Latch (CCT-L)



Reference Information

UL: File E34763

CSA: File 22156

OPTIONS

CONTACT TAILS

For connecting two cable-mounted connectors, plug and socket can be equipped with either a latch (-L) or keeper (-K)

Molex offers a wide selection of contact tails. Consult factory for availability and part numbers of other styles

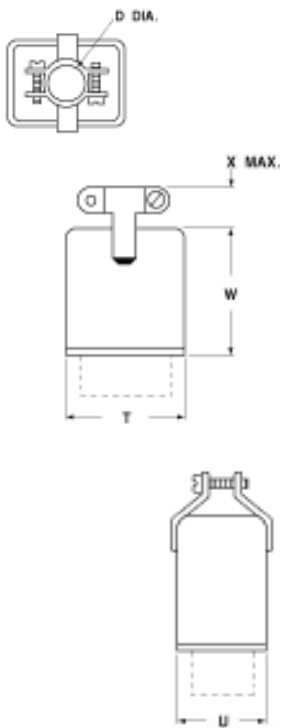

Keeper (-K)



Latch (-L)

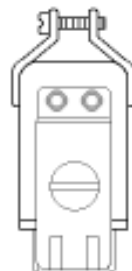

P Solder Eye (Standard)

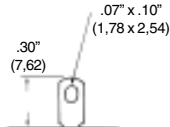

P₂ Printed Circuit and Wire Wrap, Short

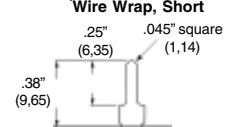

S₁ Quick Connect

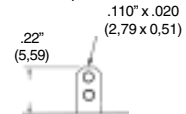

P₁ Quick Connect

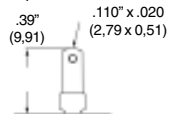

S Solder Eye (Standard)

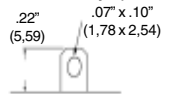

S₆ Printed Circuit

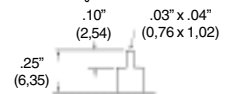

P₄ Wire Wrap, Long

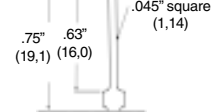

Contact Orientation

The polarization arrangement numbers shown below are for sockets, as viewed from the wiring side. Plug numbering is the opposite. A heavy-duty polarizing/ground contact is in position 14 for Nos. 3324, 3327, 3330 and in position 17 for No. 3333.



38330-XX02



38330-XX03



38330-XX04



38330-XX06



38336-8XXX

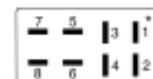

38330-XX08



38330-XX10

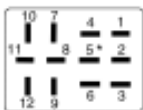

38330-XX12



38330-XX15 to 38330-XX21

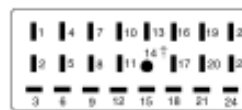

38330-XX24 to 38330-XX30



38330-XX33

* Indicates location of pre-grounding contact. † Pre-grounding contact is standard

ORDERING INFORMATION AND DIMENSIONS



**Beau™ Power Connectors
Cable Mount Plugs and Sockets**

38330, 38336, 38336

| Part# | D | | T | | U | | W | | X | |
|--------|-----|------|------|------|------|------|------|------|-----|------|
| | in | mm | in | mm | in | mm | in | mm | in | mm |
| 3302 | .38 | 9.5 | .66 | 16.7 | — | — | .97 | 24.6 | .50 | 12.7 |
| 3303 | .31 | 7.9 | 1.00 | 25.4 | .44 | 11.1 | .97 | 24.6 | .50 | 12.7 |
| 3304 | .38 | 9.5 | .75 | 25.4 | .69 | 17.5 | .97 | 24.6 | .50 | 12.7 |
| 3306 | .44 | 11.1 | 1.00 | 25.4 | .69 | 17.5 | 1.06 | 27.0 | .50 | 12.7 |
| 3306-8 | .44 | 11.1 | 1.00 | 25.4 | .69 | 17.5 | 1.06 | 27.0 | .50 | 12.7 |
| 3308 | .50 | 12.7 | 1.25 | 31.8 | .69 | 17.5 | 1.06 | 27.0 | .50 | 12.7 |
| 3310 | .50 | 12.7 | 1.56 | 39.7 | .69 | 17.5 | 1.19 | 30.2 | .50 | 12.7 |
| 3312 | .56 | 14.3 | 1.25 | 31.8 | .94 | 23.8 | 1.19 | 30.2 | .50 | 12.7 |
| 3315 | .56 | 14.3 | 1.78 | 45.2 | 1.16 | 29.4 | 1.75 | 44.5 | .75 | 19.1 |
| 3318 | .56 | 14.3 | 2.08 | 52.8 | 1.16 | 29.4 | 1.75 | 44.5 | .75 | 19.1 |
| 3321 | .63 | 15.9 | 2.34 | 59.5 | 1.16 | 29.4 | 1.75 | 44.5 | .75 | 19.1 |
| 3324 | .63 | 15.9 | 2.78 | 70.6 | 1.16 | 29.4 | 1.75 | 44.5 | .75 | 19.1 |
| 3327 | .63 | 15.9 | 3.00 | 76.2 | 1.16 | 29.4 | 1.75 | 44.5 | .75 | 19.1 |
| 3330 | .75 | 19.0 | 3.34 | 84.9 | 1.16 | 29.4 | 1.75 | 44.5 | .75 | 19.1 |
| 3333 | .75 | 19.0 | 3.66 | 92.9 | 1.16 | 29.4 | 1.75 | 44.5 | .75 | 19.1 |

| For Connector size | Clamp opening dia., in. (mm) | | Clamp Number |
|----------------------------|------------------------------|-------------|--------------|
| | min | max | |
| Standard Clamps Sizes | | | |
| 3833X-XX02 | .13" (3,3) | .38" (9,7) | - |
| 3833X-XX03 | .13" (3,3) | .38" (9,7) | - |
| 3833X-XX04 thru 3833X-XX12 | .22" (5,6) | .50" (12,7) | - |
| 3833X-XX15 thru 3833X-XX18 | .38" (9,7) | .72" (18,3) | - |
| 3833X-XX21 thru 3833X-XX33 | .38" (9,7) | .84" (21,3) | - |
| Clamp Option | | | |
| 3833X-XX15 thru 3833X-XX33 | .45" (11,4) | .91" (23,1) | 78 |

PLUGS

| Cable Clamp Top (-CCT) | | Cable Clamp Top w/Keeper (-CCT-K) | | Cable Clamp Top w/Latch (-CCT-L) | |
|------------------------|---------------|-----------------------------------|----------------|----------------------------------|----------------|
| Order # | Engineering # | Order # | Engineering # | Order # | Engineering # |
| 38331-5602 | P-3302-CCT | 38331-6002 | P-3302-CCT-K | 38331-5802 | P-3302-CCT-L |
| 38331-5603 | P-3303-CCT | 38331-6003 | P-3303-CCT-K | 38331-5803 | P-3303-CCT-L |
| 38331-5604 | P-3304-CCT | 38331-6004 | P-3304-CCT-K | 38331-5804 | P-3304-CCT-L |
| 38331-5606 | P-3306-CCT | 38331-6006 | P-3306-CCT-K | 38331-5806 | P-3306-CCT-L |
| 38336-8156 | P-3306-8-CCT | 38336-8160 | P-3306-8-CCT-K | 38336-8158 | P-3306-8-CCT-L |
| 38331-5608 | P-3308-CCT | 38331-6008 | P-3308-CCT-K | 38331-5808 | P-3308-CCT-L |
| 38331-5610 | P-3310-CCT | 38331-6010 | P-3310-CCT-K | 38331-5810 | P-3310-CCT-L |
| 38331-5612 | P-3312-CCT | 38331-6012 | P-3312-CCT-K | 38331-5812 | P-3312-CCT-L |
| 38331-5615 | P-3315-CCT | 38331-6015 | P-3315-CCT-K | 38331-5815 | P-3315-CCT-L |
| 38331-5618 | P-3318-CCT | 38331-6018 | P-3318-CCT-K | 38331-5818 | P-3318-CCT-L |
| 38331-5621 | P-3321-CCT | 38331-6021 | P-3321-CCT-K | 38331-5821 | P-3321-CCT-L |
| 38331-5624 | P-3324-CCT | 38331-6024 | P-3324-CCT-K | 38331-5824 | P-3324-CCT-L |
| 38331-5627 | P-3327-CCT | 38331-6027 | P-3327-CCT-K | 38331-5827 | P-3327-CCT-L |
| 38331-5630 | P-3330-CCT | 38331-6030 | P-3330-CCT-K | 38331-5830 | P-3330-CCT-L |
| 38331-5633 | P-3333-CCT | 38331-6033 | P-3333-CCT-K | 38331-5833 | P-3333-CCT-L |

SOCKETS

| Cable Clamp Top (-CCT) | | Cable Clamp Top w/Keeper (-CCT-K) | | Cable Clamp Top w/Latch (-CCT-L) | |
|------------------------|---------------|-----------------------------------|----------------|----------------------------------|----------------|
| Order # | Engineering # | Order # | Engineering # | Order # | Engineering # |
| 38331-8002 | S-3302-CCT | 38331-8402 | S-3302-CCT-K | 38331-8202 | S-3302-CCT-L |
| 38331-8003 | S-3303-CCT | 38331-8403 | S-3303-CCT-K | 38331-8203 | S-3303-CCT-L |
| 38331-8004 | S-3304-CCT | 38331-8404 | S-3304-CCT-K | 38331-8204 | S-3304-CCT-L |
| 38331-8006 | S-3306-CCT | 38331-8406 | S-3306-CCT-K | 38331-8206 | S-3306-CCT-L |
| 38336-8180 | S-3306-8-CCT | 38336-8184 | S-3306-8-CCT-K | 38336-8182 | S-3306-8-CCT-L |
| 38331-8008 | S-3308-CCT | 38331-8408 | S-3308-CCT-K | 38331-8208 | S-3308-CCT-L |
| 38331-8010 | S-3310-CCT | 38331-8410 | S-3310-CCT-K | 38331-8210 | S-3310-CCT-L |
| 38331-8012 | S-3312-CCT | 38331-8412 | S-3312-CCT-K | 38331-8212 | S-3312-CCT-L |
| 38331-8015 | S-3315-CCT | 38331-8415 | S-3315-CCT-K | 38331-8215 | S-3315-CCT-L |
| 38331-8018 | S-3318-CCT | 38331-8418 | S-3318-CCT-K | 38331-8218 | S-3318-CCT-L |
| 38331-8021 | S-3321-CCT | 38331-8421 | S-3321-CCT-K | 38331-8221 | S-3321-CCT-L |
| 38331-8024 | S-3324-CCT | 38331-8424 | S-3324-CCT-K | 38331-8224 | S-3324-CCT-L |
| 38331-8027 | S-3327-CCT | 38331-8427 | S-3327-CCT-K | 38331-8227 | S-3327-CCT-L |
| 38331-8030 | S-3330-CCT | 38331-8430 | S-3330-CCT-K | 38331-8230 | S-3330-CCT-L |
| 38331-8033 | S-3333-CCT | 38331-8433 | S-3333-CCT-K | 38331-8233 | S-3333-CCT-L |



Beau™ Power Connectors Cable Mount Plugs and Sockets

FEATURES AND SPECIFICATIONS

Features and Benefits

- Sizes 3 to 33 circuits
- Robust blade contacts resist damage from improper mating
- Large surface area of dual wipe female contact produces maximum current capacity
- No de-rating required. All circuits rated for full current load
- Extra long pre-grounding contact engages before any other contacts for greater safety.

Electrical

Voltage: 250V
Maximum Current: 10 Amp

Mechanical

Operating Temperature: 110°C

Physical

Base Insulator: High-grade phenolic, black
Plug Contact: Brass
Plug Contact Plating: Tin
Socket Contact: Phosphor bronze
Socket Contact Plating: Tin
Pre-grounding Contact: Heavy-duty plated brass

38330, 38336

Flared Hole End (FHE)



Reference Information

UL: File E34763
CSA: File 22156

CONTACT TAILS

Molex offers a wide selection of contact tails. Consult factory for availability and part numbers of other styles

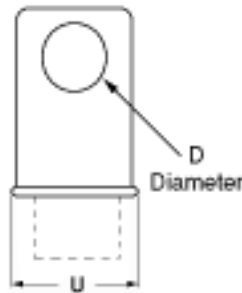
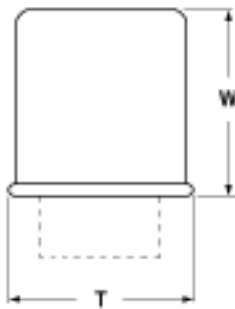

P Solder Eye (Standard)

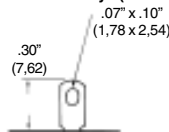

P₁ Printed Circuit and Wire Wrap, Short



S₁ Quick Connect

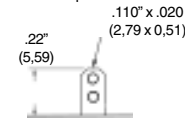

P₁ Quick Connect

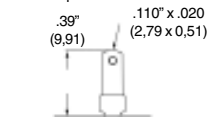

S Solder Eye (Standard)

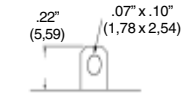

S₂ Printed Circuit

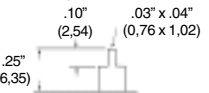

P₁ Wire Wrap, Long

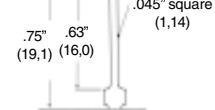

Contact Orientation

The polarization arrangement numbers shown below are for sockets, as viewed from the wiring side. Plug numbering is the opposite. A heavy-duty polarizing/ground contact is in position 14 for Nos. 3324, 3327, 3330 and in position 17 for No. 3333.



38330-XX03



38330-XX04



38330-XX06



38336-8XX0

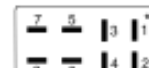

38330-XX08

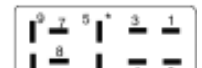

38330-XX10

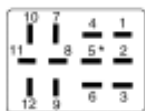

38330-XX12

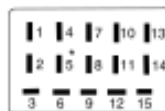

38330-XX15 to 38330-XX21



38330-XX24 to 38330-XX30



38330-XX33

* Indicates location of pre-grounding contact. † Pre-grounding contact is standard

ORDERING INFORMATION AND DIMENSIONS



**Beau™ Power Connectors
Cable Mount Plugs and Sockets**

38330, 38336

| Part# | D | | T | | U | | W | | X | |
|--------|-----|------|------|------|------|------|------|------|-----|-------|
| | in | mm | in | mm | in | mm | in | mm | in | mm |
| 3303 | .31 | 7.9 | 1.00 | 25.4 | .44 | 11.1 | .97 | 24,6 | .50 | 12.7 |
| 3304 | .38 | 9.5 | .75 | 25.4 | .69 | 17.5 | .97 | 24,6 | .50 | 12.7 |
| 3306 | .44 | 11.1 | 1.00 | 25.4 | .69 | 17.5 | 1.06 | 27,0 | .50 | 12.7- |
| 3306-8 | .44 | 11.1 | 1.00 | 25.4 | .69 | 17.5 | 1.06 | 27,0 | .50 | 12.7 |
| 3308 | .50 | 12.7 | 1.25 | 31.8 | .69 | 17.5 | 1.06 | 27,0 | .50 | 12.7 |
| 3310 | .50 | 12.7 | 1.56 | 39.7 | .69 | 17.5 | 1.19 | 30,2 | .50 | 12.7 |
| 3312 | .56 | 14.3 | 1.25 | 31.8 | .94 | 23.8 | 1.19 | 30,2 | .50 | 12.7 |
| 3315 | .56 | 14.3 | 1.78 | 45.2 | 1.16 | 29.4 | 1.75 | 44,5 | .75 | 19.1 |
| 3318 | .56 | 14.3 | 2.08 | 52.8 | 1.16 | 29.4 | 1.75 | 44,5 | .75 | 19.1 |
| 3321 | .63 | 15.9 | 2.34 | 59.5 | 1.16 | 29.4 | 1.75 | 44,5 | .75 | 19.1 |
| 3324 | .63 | 15.9 | 2.78 | 70.6 | 1.16 | 29.4 | 1.75 | 44,5 | .75 | 19.1 |
| 3327 | .63 | 15.9 | 3.00 | 76.2 | 1.16 | 29.4 | 1.75 | 44,5 | .75 | 19.1 |
| 3330 | .75 | 19.0 | 3.34 | 84.9 | 1.16 | 29.4 | 1.75 | 44,5 | .75 | 19.1 |
| 3333 | .75 | 19.0 | 3.66 | 92.9 | 1.16 | 29.4 | 1.75 | 44,5 | .75 | 19.1 |

| PLUGS | | SOCKETS | |
|-----------------------|---------------|-----------------------|---------------|
| Flared Hole End (FHE) | | Flared End Hole (FHE) | |
| Order # | Engineering # | Order # | Engineering # |
| 38330-8503 | P-3303-FHE | 38330-9303 | S-3303-FHE |
| 38330-8504 | P-3304-FHE | 38330-9304 | S-3304-FHE |
| 38330-8506 | P-3306-FHE | 38330-9306 | S-3306-FHE |
| 38336-8085 | P-3306-8-FHE | 38336-8093 | S-3306-8-FHE |
| 38330-8508 | P-3308-FHE | 38330-9308 | S-3308-FHE |
| 38330-8510 | P-3310-FHE | 38330-9310 | S-3310-FHE |
| 38330-8512 | P-3312-FHE | 38330-9312 | S-3312-FHE |
| 38330-8515 | P-3315-FHE | 38330-9315 | S-3315-FHE |
| 38330-8518 | P-3318-FHE | 38330-9318 | S-3318-FHE |
| 38330-8521 | P-3321-FHE | 38330-9321 | S-3321-FHE |
| 38330-8524 | P-3324-FHE | 38330-9324 | S-3324-FHE |
| 38330-8527 | P-3327-FHE | 38330-9327 | S-3327-FHE |
| 38330-8530 | P-3330-FHE | 38330-9330 | S-3330-FHE |
| 38330-8533 | P-3333-FHE | 38330-9333 | S-3333-FHE |



Beau™ Power Connectors Cable Mount Plugs and Sockets

FEATURES AND SPECIFICATIONS

Features and Benefits

- Sizes 2 to 33 circuits
- Robust blade contacts resist damage from improper mating
- Large surface area of dual wipe female contact produces maximum current capacity
- No de-rating required. All circuits rated for full current load
- Extra long pre-grounding contact engages before any other contacts for greater safety.

Electrical

Voltage: 250V
Maximum Current: 10 Amp

Mechanical

Operating Temperature: 110°C

Physical

Base Insulator: High-grade phenolic, black
Plug Contact: Brass
Plug Contact Plating: Tin
Socket Contact: Phosphor bronze
Socket Contact Plating: Tin
Pre-grounding Contact: Heavy-duty plated brass

38330, 38331, 38336
Flared Hole Top (FHT)



Reference Information

UL: File E34763
CSA: File 22156

CONTACT TAILS

Molex offers a wide selection of contact tails. Consult factory for availability and part numbers of other styles

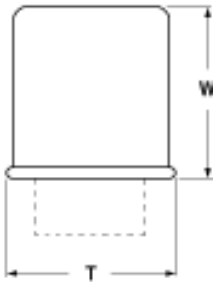
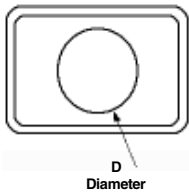

P Solder Eye (Standard)

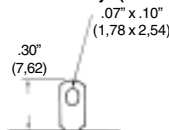

P₁ Printed Circuit and Wire Wrap, Short

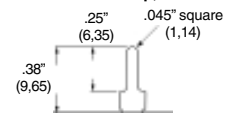

S₁ Quick Connect

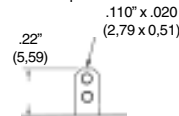

P₁ Quick Connect

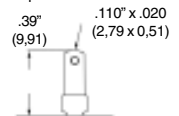

S Solder Eye (Standard)

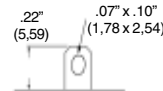

S₂ Printed Circuit

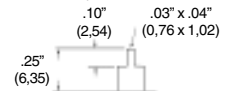

P₁ Wire Wrap, Long

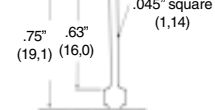

Contact Orientation

The polarization arrangement numbers shown below are for sockets, as viewed from the wiring side. Plug numbering is the opposite. A heavy-duty polarizing/ground contact is in position 14 for Nos. 3324, 3327, 3330 and in position 17 for No. 3333.



38330-XX03



38330-XX04



38330-XX06



38336-8XX0

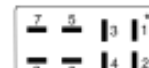

38330-XX08

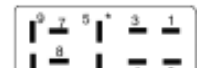

38330-XX10

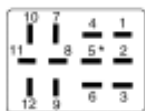

38330-XX12

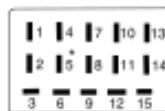

38330-XX15 to 38330-XX21

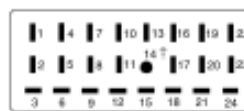

38330-XX24 to 38330-XX30



38330-XX33

* Indicates location of pre-grounding contact. † Pre-grounding contact is standard

ORDERING INFORMATION AND DIMENSIONS



**Beau™ Power Connectors
Cable Mount Plugs and Sockets**

38330, 38331, 38336

| Part# | D | | T | | U | | W | |
|--------|-----|------|------|------|------|------|------|------|
| | in | mm | in | mm | in | mm | in | mm |
| 3302* | .38 | 9.5 | .66 | 16.7 | – | – | .97 | 24.6 |
| 3303 | .31 | 7.9 | 1.00 | 25.4 | .44 | 11.1 | .97 | 24.6 |
| 3304 | .38 | 9.5 | .75 | 25.4 | .69 | 17.5 | .97 | 24.6 |
| 3306 | .44 | 11.1 | 1.00 | 25.4 | .69 | 17.5 | 1.06 | 27.0 |
| 3306-8 | .44 | 11.1 | 1.00 | 25.4 | .69 | 17.5 | 1.06 | 27.0 |
| 3308 | .50 | 12.7 | 1.25 | 31.8 | .69 | 17.5 | 1.06 | 27.0 |
| 3310 | .50 | 12.7 | 1.56 | 39.7 | .69 | 17.5 | 1.19 | 30.2 |
| 3312 | .56 | 14.3 | 1.25 | 31.8 | .94 | 23.8 | 1.19 | 30.2 |
| 3315 | .56 | 14.3 | 1.78 | 45.2 | 1.16 | 29.4 | 1.75 | 44.5 |
| 3318 | .56 | 14.3 | 2.08 | 52.8 | 1.16 | 29.4 | 1.75 | 44.5 |
| 3321 | .63 | 15.9 | 2.34 | 59.5 | 1.16 | 29.4 | 1.75 | 44.5 |
| 3324 | .63 | 15.9 | 2.78 | 70.6 | 1.16 | 29.4 | 1.75 | 44.5 |
| 3327 | .63 | 15.9 | 3.00 | 76.2 | 1.16 | 29.4 | 1.75 | 44.5 |
| 3330 | .75 | 19.0 | 3.34 | 84.9 | 1.16 | 29.4 | 1.75 | 44.5 |
| 3333 | .75 | 19.0 | 3.66 | 92.9 | 1.16 | 29.4 | 1.75 | 44.5 |

| PLUGS | | SOCKETS | |
|-----------------------|---------------|-----------------------|---------------|
| Flared Hole Top (FHT) | | Flared Hole Top (FHT) | |
| Order # | Engineering # | Order # | Engineering # |
| 38330-9902 | P-3302-FHT | 38331-0802 | S-3302-FHT |
| 38330-9903 | P-3303-FHT | 38331-0803 | S-3303-FHT |
| 38330-9904 | P-3304-FH | 38331-0804 | S-3304-FHT |
| 38330-9906 | P-3306-FHT | 38331-0806 | S-3306-FHT |
| 38336-8099 | P-3306-8-FHT | 38336-8108 | S-3306-8-FHT |
| 38330-9908 | P-3308-FHT | 38331-0808 | S-3308-FHT |
| 38330-9910 | P-3310-FHT | 38331-0810 | S-3310-FHT |
| 38330-9912 | P-3312-FHT | 38331-0812 | S-3312-FHT |
| 38330-9915 | P-3315-FHT | 38331-0815 | S-3315-FHT |
| 38330-9918 | P-3318-FHT | 38331-0818 | S-3318-FHT |
| 38330-9921 | P-3321-FHT | 38331-0821 | S-3321-FHT |
| 38330-9924 | P-3324-FHT | 38331-0824 | S-3324-FHT |
| 38330-9927 | P-3327-FHT | 38331-0827 | S-3327-FHT |
| 38330-9930 | P-3330-FHT | 38331-0830 | S-3330-FHT |
| 38330-9933 | P-3333-FHT | 38331-0833 | S-3333-FHT |



Beau™ Power Connectors Panel Mount Plugs and Sockets

FEATURES AND SPECIFICATIONS

Features and Benefits

- Sizes 4 to 16 circuits
- Robust blade contacts resist damage from improper mating
- Large surface area of dual wipe female contact produces maximum current capacity
- No de-rating required. All circuits rated for full current load
- Extra long pre-grounding contact engages before any other contacts for greater safety.

Electrical

Voltage: 250V
Maximum Current: 15 Amp

Mechanical

Operating Temperature: 150°C

Physical

Base Insulator: High-grade phenolic, black
Plug Contact: Brass
Plug Contact Plating: Tin
Socket Contact: Phosphor bronze
Socket Contact Plating: Tin
Pre-grounding Contact: Heavy-duty plated brass

38540

**Angle Bracket (AB)
Angle Bracket Tapped (ABT)
Less Angle Bracket (LAB)**



Reference Information

UL : File E34763
CSA: File 22156

SUGGESTED PANEL MOUNTING DIMENSIONS

CONTACT TAILS

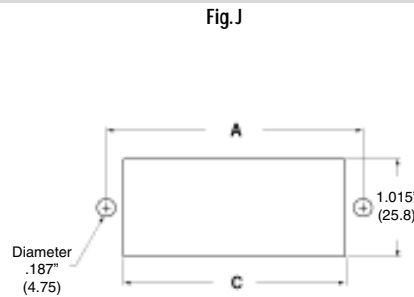
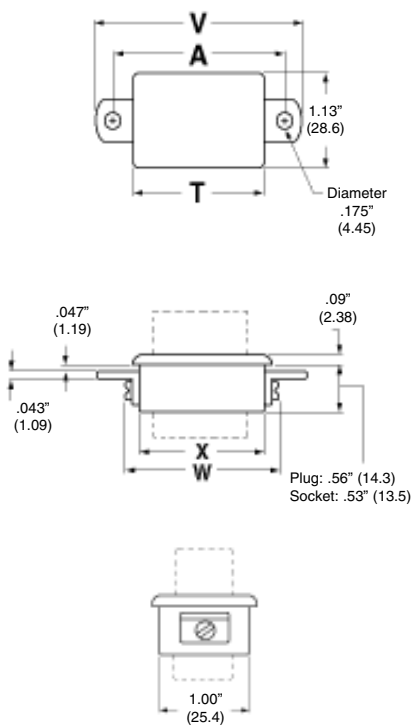

Molex offers a wide selection of contact tails. Consult factory for availability and part numbers of other styles

P Solder Hook (Standard)



P₃ Solder Eye, large

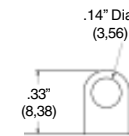

S₃ Solder Eye, large

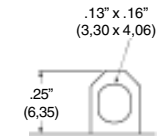

P₁ Quick Connect

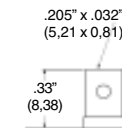

P₆ Printed Circuit

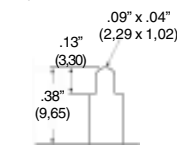

S₆ Printed Circuit

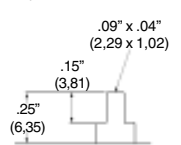

P₂ Quick Connect

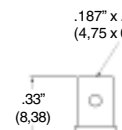

S₁ Solder Eye & Quick Connect (Standard)

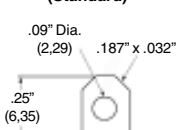

S₅ Solder Eye, extra large & quick connect

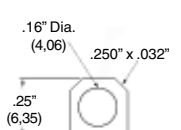

Contact Orientation

The polarization arrangement numbers shown below are for sockets, as viewed from the wiring side. Plug numbering is the opposite.

○ Polarizing position

◐ Combination pre-grounding/polarizing position

● Polarizing position - Current carrying contacts



38540-XX04



38540-XX05

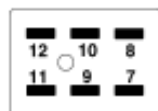

38540-XX06

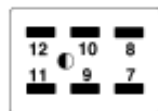

38540-XX07

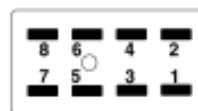

38540-XX08

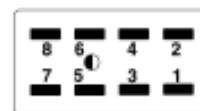

38540-XX09

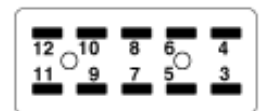

38540-XX10

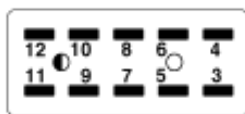

38540-XX011



38540-XX012



38540-XX008

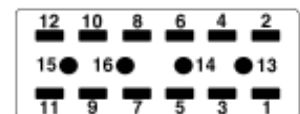

38540-XX014, 38540-XX015, 38540-XX016



38540

| Part# | T | | V | | W | | X | |
|---------|------|------|------|------|------|------|------|------|
| | in | mm | in | mm | in | mm | in | mm |
| 5404/05 | 1.13 | 28.6 | 2.02 | 51.2 | 1.23 | 31.4 | 1.00 | 25.4 |
| 5406/07 | 1.56 | 39.7 | 2.45 | 62.3 | 1.67 | 42.5 | 1.44 | 36.5 |
| 5408/09 | 2.00 | 50.8 | 2.89 | 73.4 | 2.11 | 53.6 | 1.88 | 47.6 |
| 5410/11 | 2.44 | 61.9 | 3.33 | 84.5 | 2.55 | 64.7 | 2.31 | 58.7 |
| 5412/13 | 2.88 | 73.0 | 3.77 | 95.6 | 2.98 | 75.8 | 2.75 | 69.9 |
| 5414 | 2.88 | 73.0 | 3.77 | 95.6 | 2.98 | 75.8 | 2.75 | 69.9 |
| 5415 | 2.88 | 73.0 | 3.77 | 95.6 | 2.98 | 75.8 | 2.75 | 69.9 |
| 5416 | 2.88 | 73.0 | 3.77 | 95.6 | 2.98 | 75.8 | 2.75 | 69.9 |

| Part # | Fig.# | A | | C | |
|---------|-------|-------|------|-------|------|
| | | in | mm | in | mm |
| 5404/05 | J | 1.594 | 40.5 | 1.015 | 25.8 |
| 5406/07 | J | 2.031 | 51.6 | 1.453 | 36.9 |
| 5408/09 | J | 2.468 | 62.7 | 1.891 | 48.0 |
| 5410/11 | J | 2.906 | 73.8 | 2.328 | 59.1 |
| 5412/13 | J | 3.344 | 84.9 | 2.766 | 70.3 |
| 5414 | J | 3.344 | 84.9 | 2.766 | 70.3 |
| 5415 | J | 3.344 | 84.9 | 2.766 | 70.3 |
| 5416 | J | 3.344 | 84.9 | 2.766 | 70.3 |

| PLUGS | | | | | |
|---------------------|---------------|-----------------------------|---------------|---------------------------|---------------|
| Angle Bracket (-AB) | | Angle Bracket Tapped (-ABT) | | Less Angle Bracket (-LAB) | |
| Order # | Engineering # | Order # | Engineering # | Order # | Engineering # |
| 38540-0104 | P-5404-AB | 38540-1004 | P-5404-ABT | 38540-1904 | P-5404-LAB |
| 38540-0105 | P-5405-AB | 38540-1005 | P-5405-ABT | 38540-1905 | P-5405-LAB |
| 38540-0106 | P-5406-AB | 38540-1006 | P-5406-ABT | 38540-1906 | P-5406-LAB |
| 38540-0107 | P-5407-AB | 38540-1007 | P-5407-ABT | 38540-1907 | P-5407-LAB |
| 38540-0108 | P-5408-AB | 38540-1008 | P-5408-ABT | 38540-1908 | P-5408-LAB |
| 38540-0109 | P-5409-AB | 38540-1009 | P-5409-ABT | 38540-1909 | P-5409-LAB |
| 38540-0110 | P-5410-AB | 38540-1010 | P-5410-ABT | 38540-1910 | P-5410-LAB |
| 38540-0111 | P-5411-AB | 38540-1011 | P-5411-ABT | 38540-1911 | P-5411-LAB |
| 38540-0112 | P-5412-AB | 38540-1012 | P-5412-ABT | 38540-1912 | P-5412-LAB |
| 38540-0113 | P-5413-AB | 38540-1013 | P-5413-ABT | 38540-1913 | P-5413-LAB |
| 38540-0114 | P-5414-AB | 38540-1014 | P-5414-ABT | 38540-1914 | P-5414-LAB |
| 38540-0115 | P-5415-AB | 38540-1015 | P-5415-ABT | 38540-1915 | P-5415-LAB |
| 38540-0116 | P-5416-AB | 38540-1016 | P-5416-ABT | 38540-1916 | P-5416-LAB |
| SOCKETS | | | | | |
| Angle Bracket (-AB) | | Angle Bracket Tapped (-ABT) | | Less Angle Bracket (-LAB) | |
| Order # | Engineering # | Order # | Engineering # | Order # | Engineering # |
| 38540-0604 | S-5404-AB | 38540-1504 | S-5404-ABT | 38540-2404 | S-5404-LAB |
| 38540-0605 | S-5405-AB | 38540-1505 | S-5405-ABT | 38540-2405 | S-5405-LAB |
| 38540-0606 | S-5406-AB | 38540-1506 | S-5406-ABT | 38540-2406 | S-5406-LAB |
| 38540-0607 | S-5407-AB | 38540-1507 | S-5407-ABT | 38540-2407 | S-5407-LAB |
| 38540-0608 | S-5408-AB | 38540-1508 | S-5408-ABT | 38540-2408 | S-5408-LAB |
| 38540-0609 | S-5409-AB | 38540-1509 | S-5409-ABT | 38540-2409 | S-5409-LAB |
| 38540-0610 | S-5410-AB | 38540-1510 | S-5410-ABT | 38540-2410 | S-5410-LAB |
| 38540-0611 | S-5411-AB | 38540-1511 | S-5411-ABT | 38540-2411 | S-5411-LAB |
| 38540-0612 | S-5412-AB | 38540-1512 | S-5412-ABT | 38540-2412 | S-5412-LAB |
| 38540-0613 | S-5413-AB | 38540-1513 | S-5413-ABT | 38540-2413 | S-5413-LAB |
| 38540-0614 | S-5414-AB | 38540-1514 | S-5414-ABT | 38540-2414 | S-5414-LAB |
| 38540-0615 | S-5415-AB | 38540-1515 | S-5415-ABT | 38540-2415 | S-5415-LAB |
| 38540-0616 | S-5416-AB | 38540-1516 | S-5416-ABT | 38540-2416 | S-5416-LAB |



Beau™ Power Connectors Panel Mount Plugs and Sockets

FEATURES AND SPECIFICATIONS

Features and Benefits

- Sizes 4 to 16 circuits
- Robust blade contacts resist damage from improper mating
- Large surface area of dual wipe female contact produces maximum current capacity
- No de-rating required. All circuits rated for full current load
- Extra long pre-grounding contact engages before any other contacts for greater safety.

Electrical

Voltage: 250V
Maximum Current: 15 Amp

Mechanical

Operating Temperature: 150°C

Physical

Base Insulator: High-grade phenolic, black
Plug Contact: Brass
Plug Contact Plating: Tin
Socket Contact: Phosphor bronze
Socket Contact Plating: Tin
Pre-grounding Contact: Heavy-duty plated brass

38542 Shallow Bracket (SB)



Reference Information

UL : File E34763
CSA: File 22156

SUGGESTED PANEL MOUNTING DIMENSIONS

CONTACT TAILS

Fig. L

Molex offers a wide selection of contact tails. Consult factory for availability and part numbers of other styles

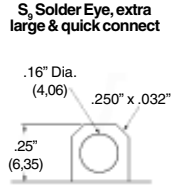
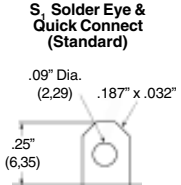
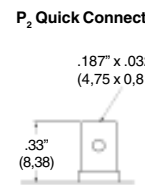
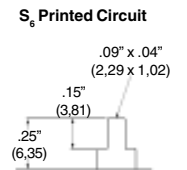
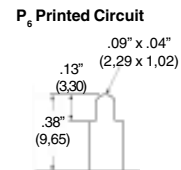
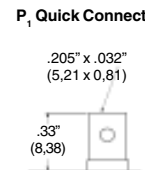
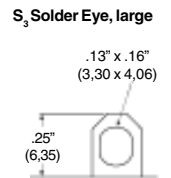
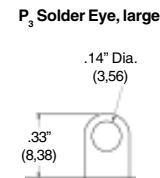
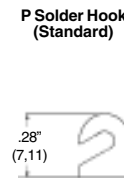
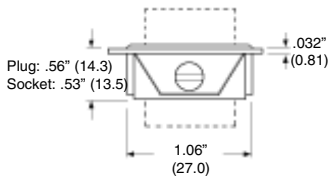
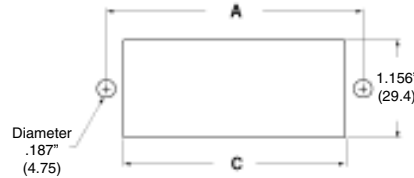
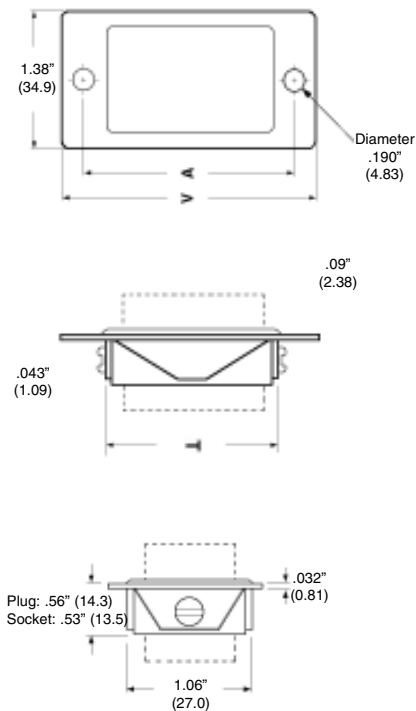

Contact Orientation

The polarization arrangement numbers shown below are for sockets, as viewed from the wiring side. Plug numbering is the opposite.

○ Polarizing position

◐ Combination pre-grounding/polarizing position

● Polarizing position - Current carrying contacts



38540-XX04



38540-XX05

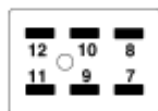

38540-XX06

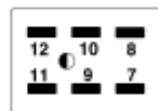

38540-XX07

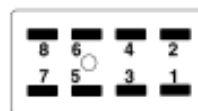

38540-XX08

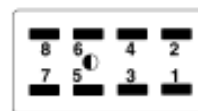

38540-XX09

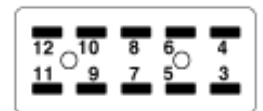

38540-XX10

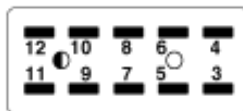

38540-XX011



38540-XX12



38540-XX08

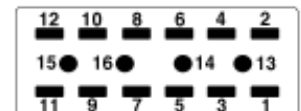

38540-XX14, 38540-XX15, 38540-XX16

ORDERING INFORMATION AND DIMENSIONS



**Beau™ Power Connectors
Panel Mount Plugs and Sockets**

38542

| Part# | V | | W | |
|---------|------|------|------|------|
| | in | mm | in | mm |
| 5404/05 | 1.92 | 48.8 | 1.16 | 29.4 |
| 5406/07 | 2.36 | 59.9 | 1.59 | 40.5 |
| 5408/09 | 2.80 | 71.0 | 2.03 | 51.6 |
| 5410/11 | 3.23 | 82.2 | 2.47 | 62.7 |
| 5412/13 | 3.67 | 93.3 | 2.91 | 73.8 |
| 5414 | 3.67 | 93.3 | 2.91 | 73.8 |
| 5415 | 3.67 | 93.3 | 2.91 | 73.8 |
| 5416 | 3.67 | 93.3 | 2.91 | 73.8 |

| Part # | Fig.# | A | | C | |
|---------|-------|-------|------|-------|------|
| | | in | mm | in | mm |
| 5404/05 | L | 1.500 | 38.1 | 1.250 | 31.8 |
| 5406/07 | L | 1.937 | 49.2 | 1.687 | 42.8 |
| 5408/09 | L | 2.375 | 60.3 | 2.125 | 54.0 |
| 5410/11 | L | 2.812 | 71.4 | 2.562 | 65.1 |
| 5412/13 | L | 3.250 | 82.6 | 3.000 | 76.2 |
| 5414 | L | 3.250 | 82.6 | 3.000 | 76.2 |
| 5415 | L | 3.250 | 82.6 | 3.000 | 76.2 |
| 5416 | L | 3.250 | 82.6 | 3.000 | 76.2 |

| PLUGS | | SOCKETS | |
|-----------------------|---------------|----------------------|---------------|
| Shallow Bracket (-SB) | | Shallow Bracket (SB) | |
| Order # | Engineering # | Order # | Engineering # |
| 38542-0804 | P-5404-SB | 38542-1304 | S-5404-SB |
| 38542-0805 | P-5405-SB | 38542-1305 | S-5405-SB |
| 38542-0806 | P-5406-SB | 38542-1306 | S-5406-SB |
| 38542-0807 | P-5407-SB | 38542-1307 | S-5407-SB |
| 38542-0808 | P-5408-SB | 38542-1308 | S-5408-SB |
| 38542-0809 | P-5409-SB | 38542-1309 | S-5409-SB |
| 38542-0810 | P-5410-SB | 38542-1310 | S-5410-SB |
| 38542-0811 | P-5411-SB | 38542-1311 | S-5411-SB |
| 38542-0812 | P-5412-SB | 38542-1312 | S-5412-SB |
| 38542-0813 | P-5413-SB | 38542-1313 | S-5413-SB |
| 38542-0814 | P-5414-SB | 38542-1314 | S-5414-SB |
| 38520-0815 | P-5415-SB | 38520-1315 | S-5415-SB |
| 38542-0816 | P-5416-SB | 38542-1316 | S-5416-SB |



Beau™ Power Connectors Panel Mount Plugs and Sockets

FEATURES AND SPECIFICATIONS

Features and Benefits

- Sizes 4 to 16 circuits
- Robust blade contacts resist damage from improper mating
- Large surface area of dual wipe female contact produces maximum current capacity
- No de-rating required. All circuits rated for full current load
- Extra long pre-grounding contact engages before any other contacts for greater safety.

Electrical

Voltage: 250V
Maximum Current: 15 Amp

Mechanical

Operating Temperature: 150°C

Physical

Base Insulator: High-grade phenolic, black
Plug Contact: Brass
Plug Contact Plating: Tin
Socket Contact: Phosphor bronze
Socket Contact Plating: Tin
Pre-grounding Contact: Heavy-duty plated brass

38540 Deep Bracket (DB)



Reference Information

UL : File E34763
CSA: File 22156

SUGGESTED PANEL MOUNTING DIMENSIONS

CONTACT TAILS

Fig. M

Molex offers a wide selection of contact tails. Consult factory for availability and part numbers of other styles

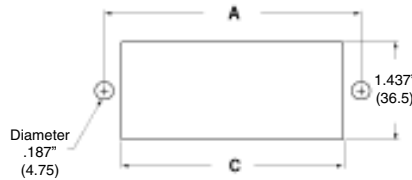
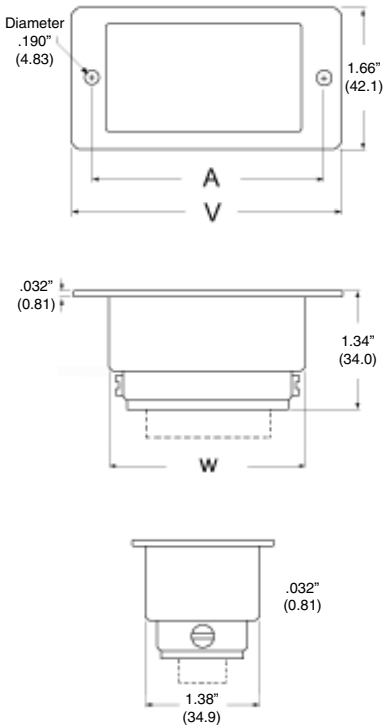

P Solder Hook (Standard)



P₃ Solder Eye, large

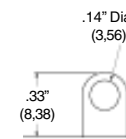

S₃ Solder Eye, large

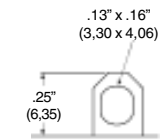

P₁ Quick Connect

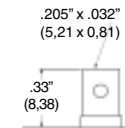

P₆ Printed Circuit

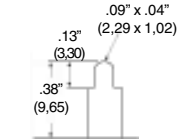

S₆ Printed Circuit

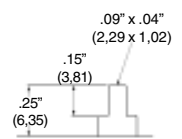

P₂ Quick Connect

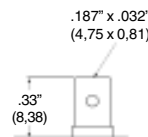

S₁ Solder Eye & Quick Connect (Standard)

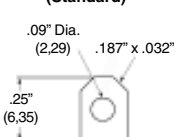

S₅ Solder Eye, extra large & quick connect

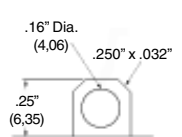

Contact Orientation

The polarization arrangement numbers shown below are for sockets, as viewed from the wiring side. Plug numbering is the opposite.

○ Polarizing position

◐ Combination pre-grounding/polarizing position

● Polarizing position - Current carrying contacts



38540-XX04



38540-XX05

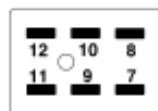

38540-XX06

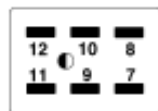

38540-XX07

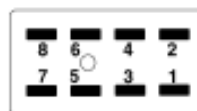

38540-XX08

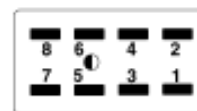

38540-XX09

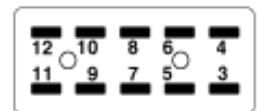

38540-XX10

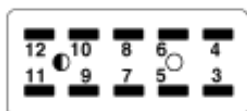

38540-XX011



38540-XX12



38540-XX08

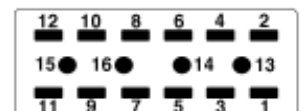

38540-XX14, 38540-XX15, 38540-XX16

ORDERING INFORMATION AND DIMENSIONS



**Beau™ Power Connectors
Panel Mount Plugs and Sockets**

38540

| Part# | V | | W | |
|---------|------|------|------|------|
| | in | mm | in | mm |
| 5404\05 | 2.19 | 55.6 | 1.38 | 34.9 |
| 5406\07 | 2.63 | 66.7 | 1.81 | 46.0 |
| 5408\09 | 3.06 | 77.8 | 2.25 | 57.2 |
| 5410\11 | 3.50 | 88.9 | 2.69 | 68.3 |
| 5412\13 | 3.94 | 100 | 3.13 | 79.4 |
| 5414 | 3.94 | 100 | 3.13 | 79.4 |
| 5415 | 3.94 | 100 | 3.13 | 79.4 |
| 5416 | 3.94 | 100 | 3.13 | 79.4 |

| Part # | Fig.# | A | | C | |
|---------|-------|-------|------|-------|------|
| | | in | mm | in | mm |
| 5404/05 | M | 1.750 | 44.5 | 1.437 | 36.5 |
| 5406/07 | M | 2.187 | 55.5 | 1.875 | 47.6 |
| 5408/09 | M | 2.625 | 66.7 | 2.312 | 58.7 |
| 5410/11 | M | 3.062 | 77.8 | 2.750 | 69.9 |
| 5412/13 | M | 3.500 | 88.9 | 3.187 | 80.9 |
| 5414 | M | 3.500 | 88.9 | 3.187 | 80.9 |
| 5415 | M | 3.500 | 88.9 | 3.187 | 80.9 |
| 5416 | M | 3.500 | 88.9 | 3.187 | 80.9 |

| PLUGS | | SOCKETS | |
|-------------------|---------------|-------------------|---------------|
| Deep Bracket (DB) | | Deep Bracket (DB) | |
| Order # | Engineering # | Order # | Engineering # |
| 38540-3704 | P-5404-DB | 38540-4204 | S-5404-DB |
| 38540-3705 | P-5405-DB | 38540-4205 | S-5405-DB |
| 38540-3706 | P-5406-DB | 38540-4206 | S-5406-DB |
| 38540-3707 | P-5407-DB | 38540-4207 | S-5407-DB |
| 38540-3708 | P-5408-DB | 38540-4208 | S-5408-DB |
| 38540-3709 | P-5409-DB | 38540-4209 | S-5409-DB |
| 38540-3710 | P-5410-DB | 38540-4210 | S-5410-DB |
| 38540-3711 | P-5411-DB | 38540-4211 | S-5411-DB |
| 38540-3712 | P-5412-DB | 38540-4212 | S-5412-DB |
| 38540-3713 | P-5413-DB | 38540-4213 | S-5413-DB |
| 38540-3714 | P-5414-DB | 38540-4214 | S-5414-DB |
| 38520-3715 | P-5415-DB | 38520-4215 | S-5415-DB |
| 38540-3716 | P-5416-DB | 38540-4216 | S-5416-DB |



Beau™ Power Connectors Cable Mount Plugs and Sockets

FEATURES AND SPECIFICATIONS

Features and Benefits

- Sizes 4 to 16 circuits
- Robust blade contacts resist damage from improper mating
- Large surface area of dual wipe female contact produces maximum current capacity
- No de-rating required. All circuits rated for full current load
- Extra long pre-grounding contact engages before any other contacts for greater safety.
- Strain relief cable clamps, used with round or flat cable

Electrical

Voltage: 250V
Maximum Current: 15 Amp

Mechanical

Operating Temperature: 110°C

Physical

Base Insulator: High-grade phenolic, black
Plug Contact: Brass
Plug Contact Plating: Tin
Socket Contact: Phosphor bronze
Socket Contact Plating: Tin/Lead
Pre-grounding Contact: Heavy-duty plated brass

38541 Cable Clamp End (CCE)



CONTACT TAILS

Molex offers a wide selection of contact tails. Consult factory for availability and part numbers of other styles

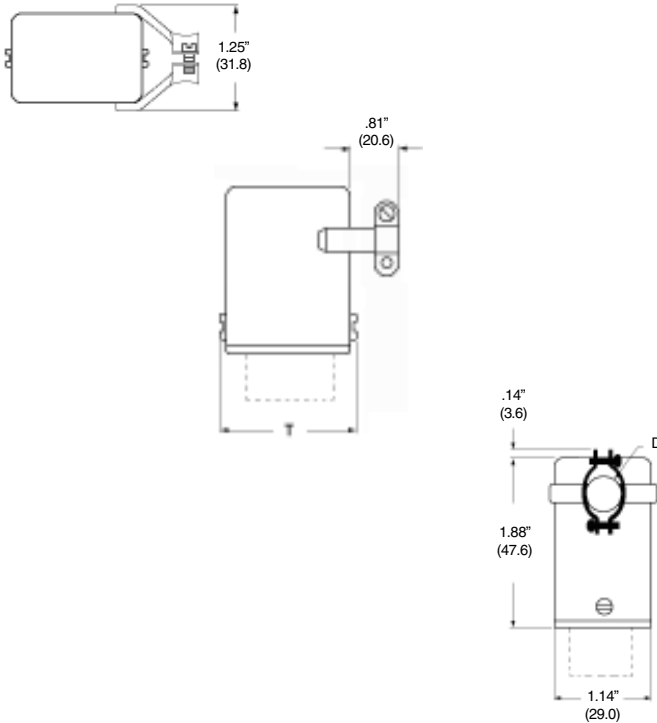

P Solder Hook (Standard)



P₃ Solder Eye, large

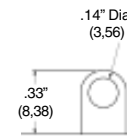

S₃ Solder Eye, large

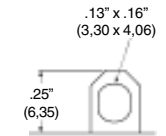

P₁ Quick Connect

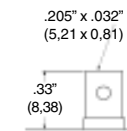

P₆ Printed Circuit

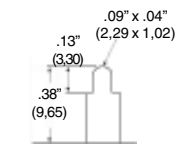

S₆ Printed Circuit

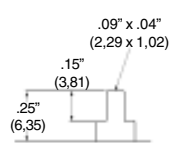

P₂ Quick Connect

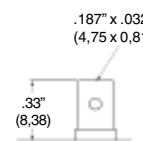

S₁ Solder Eye & Quick Connect (Standard)

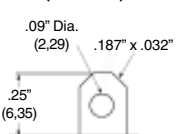

S₂ Solder Eye, extra large & quick connect

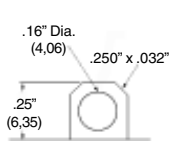

Contact Orientation

The polarization arrangement numbers shown below are for sockets, as viewed from the wiring side. Plug numbering is the opposite.

○ Polarizing position

◐ Combination pre-grounding/polarizing position

● Polarizing position - Current carrying contacts



38540-XX04



38540-XX05

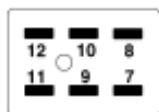

38540-XX06

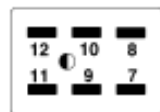

38540-XX07

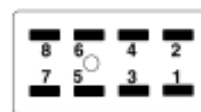

38540-XX08

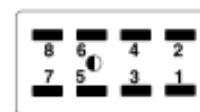

38540-XX09

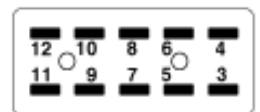

38540-XX10

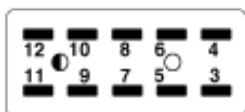

38540-XX011

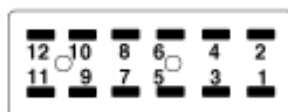

38540-XX12



38540-XX08

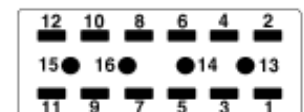

38540-XX14, 38540-XX15, 38540-XX16



38541

DIMENSIONS

| Part# | V | | W | |
|---------|-----|------|------|------|
| | in | mm | in | mm |
| 5404\05 | .44 | 11.1 | 1.23 | 31.4 |
| 5406\07 | .44 | 11.1 | 1.67 | 42.5 |
| 5408\09 | .56 | 14.3 | 2.11 | 53.6 |
| 5410\11 | .56 | 14.3 | 2.55 | 64.7 |
| 5412\13 | .63 | 15.9 | 2.98 | 75.8 |
| 5414 | .63 | 15.9 | 2.98 | 75.8 |
| 5415 | .63 | 15.9 | 2.98 | 75.8 |
| 5416 | .63 | 15.9 | 2.98 | 75.8 |

| For Connector size | Clamp opening dia., in. (mm) | | Clamp Number |
|--|------------------------------|-------------|--------------|
| | min | max | |
| Standard Clamps Sizes | | | |
| 38541-XX04 thru 38541-XX07 | .38" (9,7) | .72" (18,3) | - |
| 38541-XX08 thru 38541-XX16 | .38" (9,7) | .84" (21,3) | - |
| Clamp Options | | | |
| 38541-XX04 thru 38541-XX16 | .45" (11,4) | .91" (23,1) | 78 |
| 38541-XX04 thru 38541-XX16 for Mating with Deep Bracket (DB) | .38" (9,7) | .72" (18,3) | 47 |

| PLUGS | | SOCKETS | |
|-----------------------|---------------|-----------------------|---------------|
| Cable Clamp End (CCE) | | Cable Clamp End (CCE) | |
| Order # | Engineering # | Order # | Engineering # |
| 38541-0004 | P-5404-CCE | 38541-3004 | S-5404-CCE |
| 38541-0005 | P-5405-CCE | 38541-3005 | S-5405-CCE |
| 38541-0006 | P-5406-CCE | 38541-3006 | S-5406-CCE |
| 38541-0007 | P-5407-CCE | 38541-3007 | S-5407-CCE |
| 38541-0008 | P-5408-CCE | 38541-3008 | S-5408-CCE |
| 38541-0009 | P-5409-CCE | 38541-3009 | S-5409-CCE |
| 38541-0010 | P-5410-CCE | 38541-3010 | S-5410-CCE |
| 38541-0011 | P-5411-CCE | 38541-3011 | S-5411-CCE |
| 38541-0012 | P-5412-CCE | 38541-3012 | S-5412-CCE |
| 38541-0013 | P-5413-CCE | 38541-3013 | S-5413-CCE |
| 38541-0014 | P-5414-CCE | 38541-3014 | S-5414-CCE |
| 38521-0015 | P-5415-CCE | 38521-3015 | S-5415-CCE |
| 38541-0016 | P-5416-CCE | 38541-3016 | S-5416-CCE |



Beau™ Power Connectors Cable Mount Plugs and Sockets

FEATURES AND SPECIFICATIONS

Features and Benefits

- Sizes 4 to 16 circuits
- Robust blade contacts resist damage from improper mating
- Large surface area of dual wipe female contact produces maximum current capacity
- No de-rating required. All circuits rated for full current load
- Extra long pre-grounding contact engages before any other contacts for greater safety.

Electrical

Voltage: 250V
Maximum Current: 15 Amp

Mechanical

Operating Temperature: 110°C

Physical

Base Insulator: High-grade phenolic, black
Plug Contact: Brass
Plug Contact Plating: Tin
Socket Contact: Phosphor bronze
Socket Contact Plating: Tin
Pre-grounding Contact: Heavy-duty plated brass

38541

Cable Clamp Top (CCT)
Cable Clamp Top w/ Keeper (CCT-K)
Cable Clamp Top w/ Latch (CCT-L)



OPTIONS

CONTACT TAILS

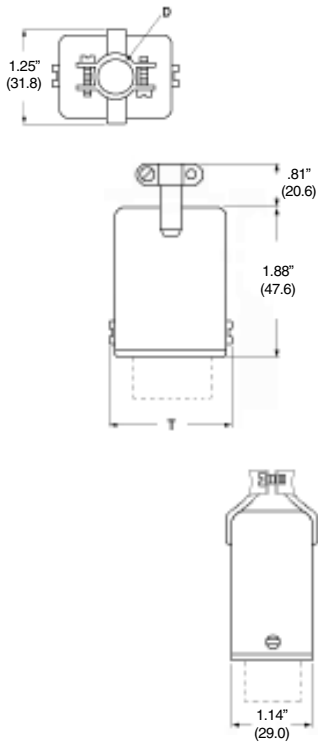

For connecting two cable-mounted connectors, plug and socket can be equipped with either a latch (-L) or keeper (-K)>

Keeper (-K)



Latch (-L)

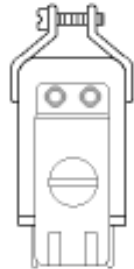

Molex offers a wide selection of contact tails. Consult factory for availability and part numbers of other styles

P Solder Hook (Standard)



P₃ Solder Eye, large

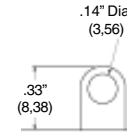

S₃ Solder Eye, large

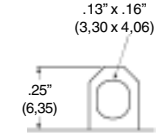

P₁ Quick Connect

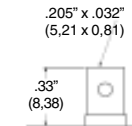

P₆ Printed Circuit

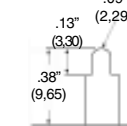

S₆ Printed Circuit

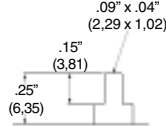

P₂ Quick Connect

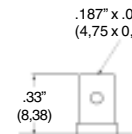

S Solder Eye & Quick Connect (Standard)

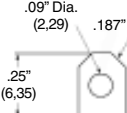

S₆ Solder Eye, extra large & quick connect

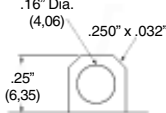

Contact Orientation

The polarization arrangement numbers shown below are for sockets, as viewed from the wiring side. Plug numbering is the opposite.

○ Polarizing position

◐ Combination pre-grounding/polarizing position

● Polarizing position - Current carrying contacts



38540-XX04



38540-XX05

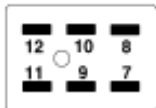

38540-XX06

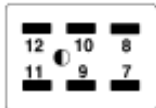

38540-XX07



38540-XX08

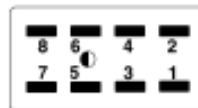

38540-XX09

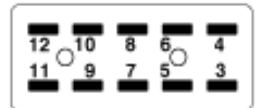

38540-XX10

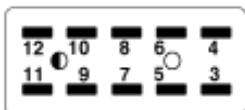

38540-XX011

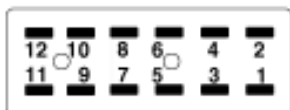

38540-XX12

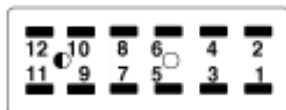

38540-XX08

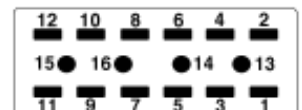

38540-XX14, 38540-XX15, 38540-XX16

ORDERING INFORMATION AND DIMENSIONS



**Beau™ Power Connectors
Cable Mount Plugs and Sockets**

38541

| Part# | V | | W | |
|---------|-----|------|------|------|
| | in | mm | in | mm |
| 5404\05 | .44 | 11.1 | 1.23 | 31.4 |
| 5406\07 | .44 | 11.1 | 1.67 | 42.5 |
| 5408\09 | .56 | 14.3 | 2.11 | 53.6 |
| 5410\11 | .56 | 14.3 | 2.55 | 64.7 |
| 5412\13 | .63 | 15.9 | 2.98 | 75.8 |
| 5414 | .63 | 15.9 | 2.98 | 75.8 |
| 5415 | .63 | 15.9 | 2.98 | 75.8 |
| 5416 | .63 | 15.9 | 2.98 | 75.8 |

| For Connector size | Clamp opening dia., in. (mm) | | Clamp Number |
|---|------------------------------|-------------|--------------|
| | min | max | |
| Standard Clamps Sizes | | | |
| 38541-XX04 thru 38541-XX07 | .38" (9,7) | .72" (18,3) | - |
| 38541-XX08 thru 38541-XX16 | .38" (9,7) | .84" (21,3) | - |
| Clamp Option | | | |
| 38541-XX04 thru 38541-XX16 | .45" (11,4) | .91" (23,1) | 78 |
| For non-standard backshell hole size, consult factory | | | |

PLUGS

| Cable Clamp Top (-CCT) | | Cable Clamp Top w/Keeper (-CCT-K) | | Cable Clamp Top w/Latch (-CCT-L) | |
|------------------------|---------------|-----------------------------------|---------------|----------------------------------|---------------|
| Order # | Engineering # | Order # | Engineering # | Order # | Engineering # |
| 38541-5404 | P-5404-CCT | 38541-5804 | P-5404-CCT-K | 38541-5604 | P-5404-CCT-L |
| 38541-5405 | P-5405-CCT | 38541-5805 | P-5405-CCT-K | 38541-5605 | P-5405-CCT-L |
| 38541-5406 | P-5406-CCT | 38541-5806 | P-5406-CCT-K | 38541-5606 | P-5406-CCT-L |
| 38541-5407 | P-5407-CCT | 38541-5807 | P-5407-CCT-K | 38541-5607 | P-5407-CCT-L |
| 38541-5408 | P-5408-CCT | 38541-5808 | P-5408-CCT-K | 38541-5608 | P-5408-CCT-L |
| 38541-5409 | P-5409-CCT | 38541-5809 | P-5409-CCT-K | 38541-5609 | P-5409-CCT-L |
| 38541-5410 | P-5410-CCT | 38541-5810 | P-5410-CCT-K | 38541-5610 | P-5410-CCT-L |
| 38541-5411 | P-5411-CCT | 38541-5811 | P-5411-CCT-K | 38541-5611 | P-5411-CCT-L |
| 38541-5412 | P-5412-CCT | 38541-5812 | P-5412-CCT-K | 38541-5612 | P-5412-CCT-L |
| 38541-5413 | P-5413-CCT | 38541-5813 | P-5413-CCT-K | 38541-5613 | P-5413-CCT-L |
| 38541-5414 | P-5414-CCT | 38541-5814 | P-5414-CCT-K | 38541-5614 | P-5414-CCT-L |
| 38521-5415 | P-5415-CCT | 38541-5815 | P-5415-CCT-K | 38541-5615 | P-5415-CCT-L |
| 38541-5416 | P-5416-CCT | 38541-5816 | P-5416-CCT-K | 38541-5616 | P-5416-CCT-L |

SOCKETS

| Cable Clamp Top (-CCT) | | Cable Clamp Top w/Keeper (-CCT-K) | | Cable Clamp Top w/Latch (-CCT-L) | |
|------------------------|---------------|-----------------------------------|---------------|----------------------------------|---------------|
| Order # | Engineering # | Order # | Engineering # | Order # | Engineering # |
| 38541-8404 | S-5404-CCT | 38541-8804 | S-5404-CCT-K | 38541-8604 | S-5404-CCT-L |
| 38541-8405 | S-5405-CCT | 38541-8805 | S-5405-CCT-K | 38541-8605 | S-5405-CCT-L |
| 38541-8406 | S-5406-CCT | 38541-8806 | S-5406-CCT-K | 38541-8606 | S-5406-CCT-L |
| 38541-8407 | S-5407-CCT | 38541-8807 | S-5407-CCT-K | 38541-8607 | S-5407-CCT-L |
| 38541-8408 | S-5408-CCT | 38541-8808 | S-5408-CCT-K | 38541-8608 | S-5408-CCT-L |
| 38541-8409 | S-5409-CCT | 38541-8809 | S-5409-CCT-K | 38541-8609 | S-5409-CCT-L |
| 38541-8410 | S-5410-CCT | 38541-8810 | S-5410-CCT-K | 38541-8610 | S-5410-CCT-L |
| 38541-8411 | S-5411-CCT | 38541-8811 | S-5411-CCT-K | 38541-8611 | S-5411-CCT-L |
| 38541-8412 | S-5412-CCT | 38541-8812 | S-5412-CCT-K | 38541-8612 | S-5412-CCT-L |
| 38541-8413 | S-5413-CCT | 38541-8813 | S-5413-CCT-K | 38541-8613 | S-5413-CCT-L |
| 38541-8414 | S-5414-CCT | 38541-8814 | S-5414-CCT-K | 38541-8614 | S-5414-CCT-L |
| 38521-8415 | S-5415-CCT | 38541-8815 | S-5415-CCT-K | 38541-8615 | S-5415-CCT-L |
| 38541-8416 | S-5416-CCT | 38541-8816 | S-5416-CCT-K | 38541-8616 | S-5416-CCT-L |



Beau™ Power Connectors Cable Mount Plugs and Sockets

FEATURES AND SPECIFICATIONS

Features and Benefits

- Sizes 4 to 16 circuits
- Robust blade contacts resist damage from improper mating
- Large surface area of dual wipe female contact produces maximum current capacity
- No de-rating required. All circuits rated for full current load
- Extra long pre-grounding contact engages before any other contacts for greater safety.

Electrical

Voltage: 250V
Maximum Current: 15 Amp

Mechanical

Operating Temperature: 110°C

Physical

Base Insulator: High-grade phenolic, black
Plug Contact: Brass
Plug Contact Plating: Tin
Socket Contact: Phosphor bronze
Socket Contact Plating: Tin
Pre-grounding Contact: Heavy-duty plated brass

38540 Flared Hole End (FHE)



CONTACT TAILS

Molex offers a wide selection of contact tails. Consult factory for availability and part numbers of other styles

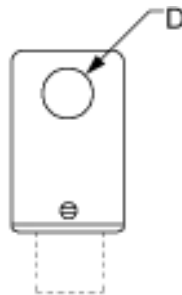
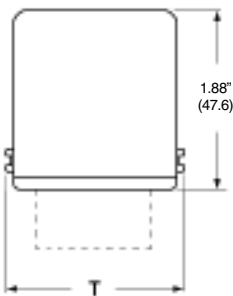

P Solder Hook (Standard)

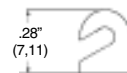

P₃ Solder Eye, large

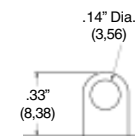

S₃ Solder Eye, large

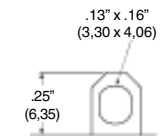

P₁ Quick Connect

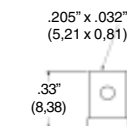

P₆ Printed Circuit

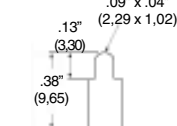

S₆ Printed Circuit

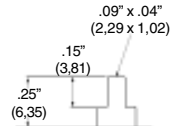

P₂ Quick Connect

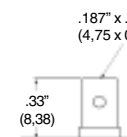

S₁ Solder Eye & Quick Connect (Standard)

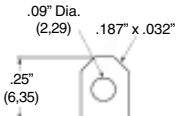

S₅ Solder Eye, extra large & quick connect

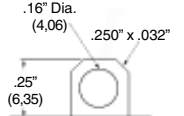

Contact Orientation

The polarization arrangement numbers shown below are for sockets, as viewed from the wiring side. Plug numbering is the opposite.

○ Polarizing position

◐ Combination pre-grounding/polarizing position

● Polarizing position - Current carrying contacts



38540-XX04



38540-XX05

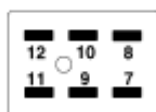

38540-XX06

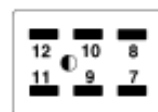

38540-XX07

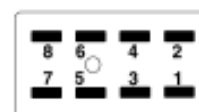

38540-XX08

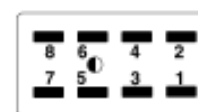

38540-XX09

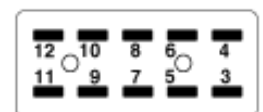

38540-XX10

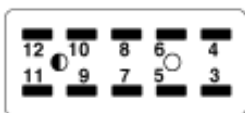

38540-XX011



38540-XX12



38540-XX08

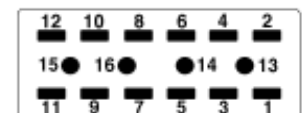

38540-XX14, 38540-XX15, 38540-XX16

ORDERING INFORMATION AND DIMENSIONS



**Beau™ Power Connectors
Cable Mount Plugs and Sockets**

38540

| Part# | D | | T | |
|---------|-----|------|------|------|
| | in | mm | in | mm |
| 5404/05 | .44 | 11.1 | 1.23 | 31.4 |
| 5406/07 | .44 | 11.1 | 1.67 | 42.5 |
| 5408/09 | .56 | 14.3 | 2.11 | 53.6 |
| 5410/11 | .56 | 14.3 | 2.55 | 64.7 |
| 5412 | .63 | 15.9 | 2.98 | 75.8 |

| PLUGS | | SOCKETS | |
|-----------------------|---------------|-----------------------|---------------|
| Flared Hole End (FHE) | | Flared End Hole (FHE) | |
| Order # | Engineering # | Order # | Engineering # |
| 38540-6404 | P-5404-FHE | 38540-7404 | S-5404-FHE |
| 38540-6405 | P-5405-FHE | 38540-7405 | S-5405-FHE |
| 38540-6406 | P-5406-FHE | 38540-7406 | S-5406-FHE |
| 38540-6407 | P-5407-FHE | 38540-7407 | S-5407-FHE |
| 38540-6408 | P-5408-FHE | 38540-7408 | S-5408-FHE |
| 38540-6409 | P-5409-FHE | 38540-7409 | S-5409-FHE |
| 38540-6410 | P-5410-FHE | 38540-7410 | S-5410-FHE |
| 38540-6411 | P-5411-FHE | 38540-7411 | S-5411-FHE |
| 38540-6412 | P-5412-FHE | 38540-7412 | S-5412-FHE |
| 38540-6413 | P-5413-FHE | 38540-7413 | S-5413-FHE |
| 38540-6414 | P-5414-FHE | 38540-7414 | S-5414-FHE |
| 38540-6415 | P-5415-FHE | 38540-7415 | S-5415-FHE |
| 38540-6416 | P-5416-FHE | 38540-7416 | S-5416-FHE |



Beau™ Power Connectors Cable Mount Plugs and Sockets

FEATURES AND SPECIFICATIONS

Features and Benefits

- Sizes 4 to 16 circuits
- Robust blade contacts resist damage from improper mating
- Large surface area of dual wipe female contact produces maximum current capacity
- No de-rating required. All circuits rated for full current load
- Extra long pre-grounding contact engages before any other contacts for greater safety.

Electrical

Voltage: 250V
Maximum Current: 15 Amp

Mechanical

Operating Temperature: 110°C

Physical

Base Insulator: High-grade phenolic, black
Plug Contact: Brass
Plug Contact Plating: Tin
Socket Contact: Phosphor bronze
Socket Contact Plating: Tin/Lead
Pre-grounding Contact: Heavy-duty plated brass

38540

Flared Hole Top (FHT)



CONTACT TAILS

Molex offers a wide selection of contact tails. Consult factory for availability and part numbers of other styles

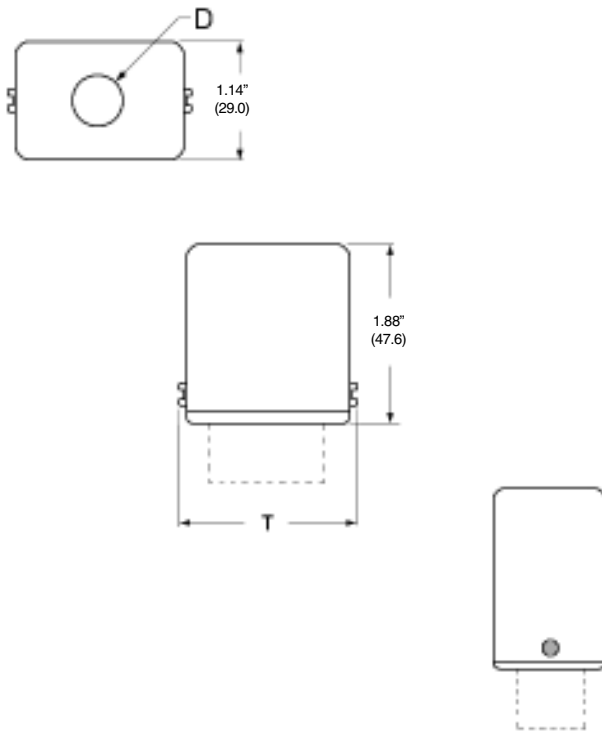

P Solder Hook (Standard)

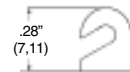

P₃ Solder Eye, large

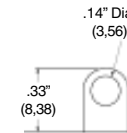

S₃ Solder Eye, large

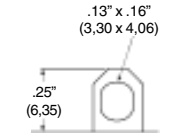

P₁ Quick Connect

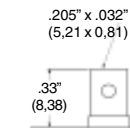

P₆ Printed Circuit

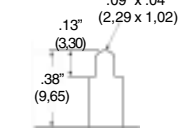

S₆ Printed Circuit

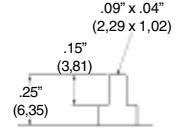

P₂ Quick Connect

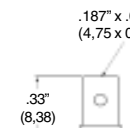

S₂ Solder Eye & Quick Connect (Standard)

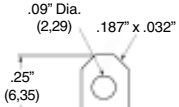

S₅ Solder Eye, extra large & quick connect

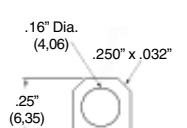

Contact Orientation

The polarization arrangement numbers shown below are for sockets, as viewed from the wiring side. Plug numbering is the opposite.

○ Polarizing position

◐ Combination pre-grounding/polarizing position

● Polarizing position - Current carrying contacts



38540-XX04



38540-XX05

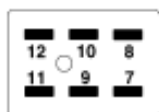

38540-XX06

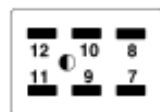

38540-XX07



38540-XX08

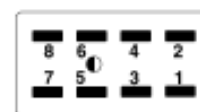

38540-XX09

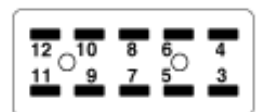

38540-XX10

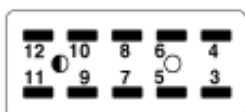

38540-XX011



38540-XX12



38540-XX08

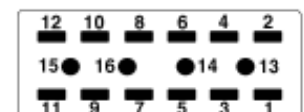

38540-XX14, 38540-XX15, 38540-XX16

ORDERING INFORMATION AND DIMENSIONS



**Beau™ Power Connectors
Cable Mount Plugs and Sockets**

38540

| Part# | D | | T | |
|---------|-----|------|------|------|
| | in | mm | in | mm |
| 5404/05 | .44 | 11.1 | 1.23 | 31.4 |
| 5406/07 | .44 | 11.1 | 1.67 | 42.5 |
| 5408/09 | .56 | 14.3 | 2.11 | 53.6 |
| 5410/11 | .56 | 14.3 | 2.55 | 64.7 |
| 5412 | .63 | 15.9 | 2.98 | 75.8 |

| PLUGS | | SOCKETS | |
|-----------------------|---------------|-----------------------|---------------|
| Flared Hole Top (FHT) | | Flared Hole Top (FHT) | |
| Order # | Engineering # | Order # | Engineering # |
| 38540-8204 | P-5404-FHT | 38540-9204 | S-5404-FHT |
| 38540-8205 | P-5405-FHT | 38540-9205 | S-5405-FHT |
| 38540-8206 | P-5406-FHT | 38540-9206 | S-5406-FHT |
| 38540-8207 | P-5407-FHT | 38540-9207 | S-5407-FHT |
| 38540-8208 | P-5408-FHT | 38540-9208 | S-5408-FHT |
| 38540-8209 | P-5409-FHT | 38540-9209 | S-5409-FHT |
| 38540-8210 | P-5410-FHT | 38540-9210 | S-5410-FHT |
| 38540-8211 | P-5411-FHT | 38540-9211 | S-5411-FHT |
| 38540-8212 | P-5412-FHT | 38540-9212 | S-5412-FHT |
| 38540-8213 | P-5413-FHT | 38540-9213 | S-5413-FHT |
| 38540-8214 | P-5414-FHT | 38540-9214 | S-5414-FHT |
| 38540-8215 | P-5415-FHT | 38540-9215 | S-5415-FHT |
| 38540-8216 | P-5416-FHT | 38540-9216 | S-5416-FHT |

X-ON Electronics

Largest Supplier of Electrical and Electronic Components

Click to view similar products for [Heavy Duty Power Connectors](#) category:

Click to view products by [Molex](#) manufacturer:

Other Similar products are found below :

[1424439](#) [1424438](#) [09330062652](#) [2-8675P1](#) [605601-1](#) [6340G1](#) [6341G1](#) [6360G1](#) [6373G1](#) [6374g2](#) [6396G1](#) [647757-1](#) [66394-4](#) [6643411-1](#)
[6646058-2](#) [6646137-1](#) [6646138-1](#) [6646348-1](#) [6646479-1](#) [6646608-1](#) [6646786-1](#) [6646940-1](#) [6651091-1](#) [6651525-1](#) [6651529-1](#) [6651778-1](#)
[6651788-1](#) [696465-1](#) [696475-1](#) [73000005059](#) [73000005349](#) [73000005642](#) [73080255059](#) [73080965046](#) [765-15-0080A](#) [765-16-0080B](#)
[789.700-44](#) [789.700-54](#) [80-1010](#) [80-9](#) [827381-1](#) [829992-1](#) [902-77-02113](#) [PL00U-301-10D10](#) [PM103MOOLOO](#) [PM16S1620S32-50](#)
[PM212MOOLOO](#) [PM309FOOLOO](#) [PM324FOOLCH](#) [PMHPAF11S03](#)