

Sta-Kon®

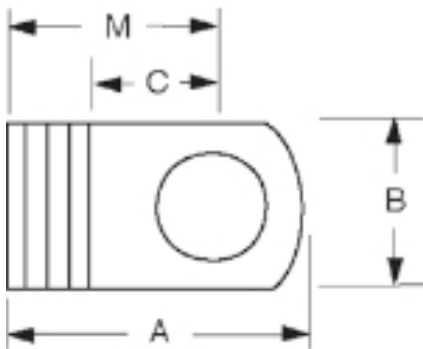

T&B Catalog Number: AB14-10A
UPC Number: 78621080312
Description: Non-Insulated Flag Terminal For Wire Range 22-14 Stud Size #10, Metallic

Status: Active



WEB_USE

-T&B Product Line	029
-US Cutsheet PDF Catalog Link	http://www-public.tnb.com/contractor/docs/stakon.pdf

Features

-	Flag terminals allow a 90 degree connection to the terminal block without bending the wire.
---	---

General

-Insulation Type	Non-Insulated
-Terminal Series	AB
-Material	Copper
-Finish	Electro -Tin Plated
-Color	Metallic
-Wire Range	22-14
-Stud Size	#10

Dimension Information

-Stock Thickness	.03
-A (inches)	.55
-B (inches)	.31
-C (inches)	.22
-M (inches)	.39

Specifications

-Temperature Rating	150°C
-Flammability Rating	UL 94 V-0

Tooling

-Tool Charts	Available on Website
-Application Tools	ERG4004
-Recommended Tool	ERG4004

Packaging

-T&B Order Multiple	100
-T&B Inner Pack	100
-Package in Units	500
-Package Type	Standard
-T&B Sold in UOM	Each
-T&B Weight Per UOM	0.3 lbs. per 100
-Alternate Package Qty	AB53

Application Support

-Overview	Available on Website
-Wire Guide Tables	Available on Website

Notes

-	Not available on Mylar Tape.
---	------------------------------

Certifications

-RoHS Compliance	Yes
------------------	-----

Certifications



File Nbr:
E9809

For further technical assistance, please contact us...

Thomas & Betts - USA
8155 T&B Blvd.
Memphis, TN 38125
www.tnb.com

T&B Technical Support
MS 3B-50
8155 T&B Blvd.
Memphis, TN 38125

Hours: 7AM - 6PM CDT
Monday-Friday
Phone: (888) 862-3289
Fax: (901) 252-1321
Email: techsupport@tnb.com

X-ON Electronics

Largest Supplier of Electrical and Electronic Components

Click to view similar products for [abb](#) manufacturer:

Other Similar products are found below :

[TV10-516R](#) [017667013](#) [RF727](#) [2CMA100178R1000](#) [2CMA100163R1000](#) [5SDD 92Z0401](#) [ESV14-BS](#) [EVS-21-250](#) [F204AC-40/0.03](#) [F362-25/0.03](#) [GJL1211201R8000](#) [GJL1211501R8000](#) [GJL1213001R0017](#) [GJL1213001R0101](#) [GJL1311001R0011](#) [GJL1311001R0101](#) [GJL1311001R8010](#) [GJL1311201R0001](#) [GJL1313001R0011](#) [GJL1313001R0101](#) [GJL1317201R0001](#) [A40-30-10-84](#) [AF09-30-01-11](#) [AF460-30-11-68](#) [1455](#) [B14-250](#) [EF45-30](#) [ERG297](#) [HSC2-20](#) [1SAM201904R1001](#) [1SAM350000R1003](#) [1SAZ721201R1009](#) [1SAZ721201R1014](#) [1SAZ721201R1025](#) [1SBL157001R1310](#) [1SBL277001R1300](#) [1SBL277001R4100](#) [1SBL367001R1300](#) [1SBL387001R4100](#) [1SBN010110R1001](#) [1SBN010110R1010](#) [1SBN010140R1022](#) [1SBN010140R1122](#) [1SDA057197R1](#) [1SFA611101R1002](#) [1SFA611130R1103](#) [1SFA611131R1101](#) [1SFA611143R1101](#) [1SFA611202R1108](#) [1SFA611203R1108](#)