

Microminiature Slide Switches

Specifications:

Contact rating:	12 V DC, 200 mA
Contact resistance:	< 50 mΩ
Insulation resistance:	> 100 MΩ at 500 V DC
Dielectric strength:	500 V, 50 Hz for the duration of 1 minute
Operating temperature:	- 10° to + 60° C
Mechanical life:	minimum 5000 operations
Contacts:	phosphor bronze, silver-plated
Terminals:	brass silver-plated
Contact timing:	non-shorting
Soldering conditions:	auto-soldering – max.: 3 sec ± 0,5 sec, 230° C ± 5° C

Models: Switching functions

MMP 121 on on

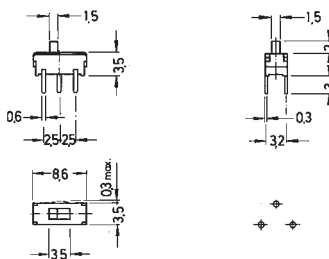

MMP 131 on on on

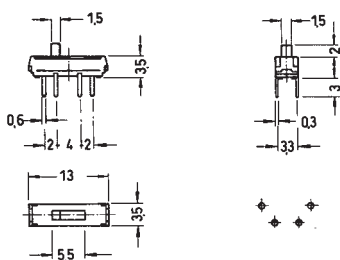

MMP 221 on on

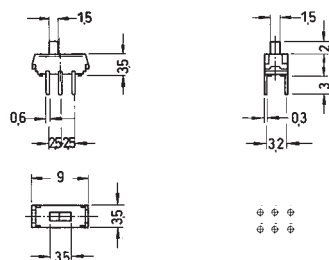

MMP 231 on on on

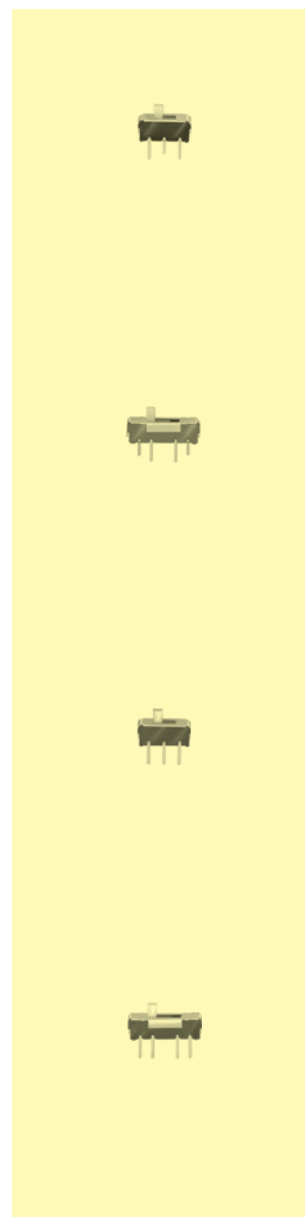
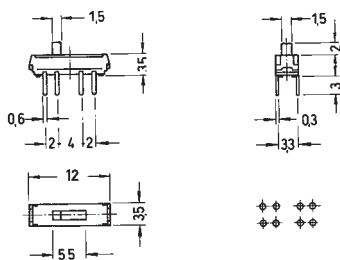



Microminiature Slide Switches

Models: Switching functions

MMP 121 – R on on

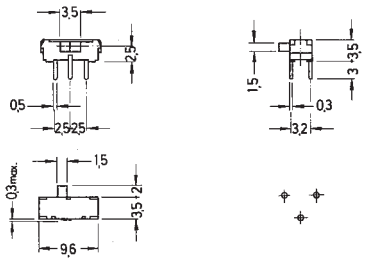

MMP 131 – R on on on

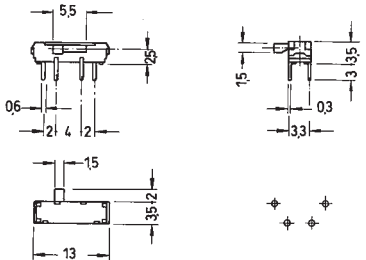

MMP 221 – R on on

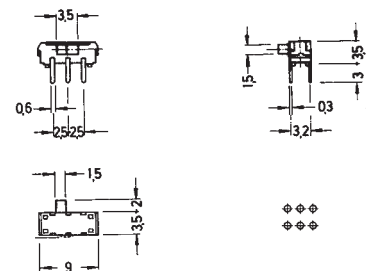

MMP 231 – R on on on

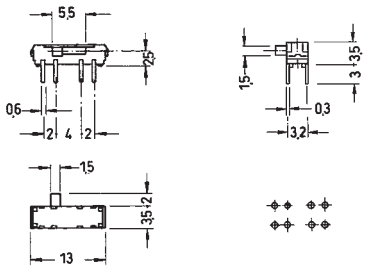

MMP 421 – R on on

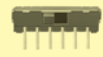
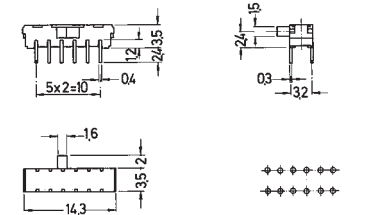



Microminiature Slide Switches for SMT

Specifications:

Contact rating:	12 V DC, 200 mA / 4 V DC, 300 mA
Contact resistance:	< 70 mΩ
Insulation resistance:	> 100 MΩ at 100 V DC
Dielectric strength:	500 V, 50 Hz for the duration of 1 minute
Operating temperature:	- 10° to + 60° C
Mechanical life:	minimum 10 000 operations
Contacts:	phosphor bronze, gold-plated
Terminals:	brass, gold-plated
Contact timing:	non-shorting

Models:

MMSP 132 on on on
with pushbutton function

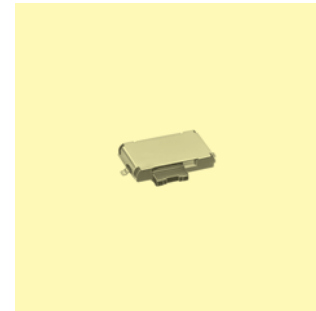
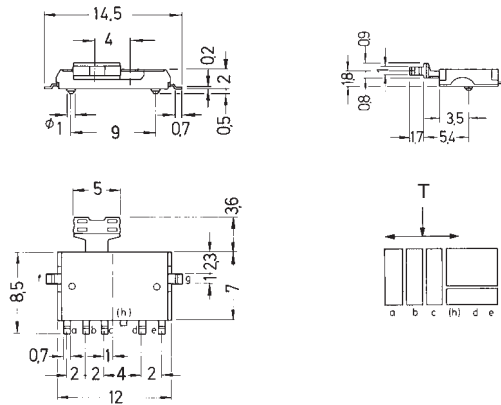

Packing:

1000 pcs/reel

Ø 330 mm

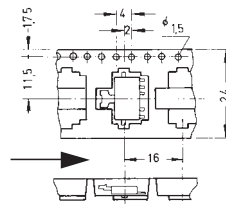

Soldering conditions:

reflow-soldering – max.: 60 sec, 260° C ± 2° C

Minimum quantity 1 reel

Microminiature Slide Switches for SMT



Specifications:

Contact rating:	12 V DC, 200 mA
Contact resistance:	< 50 mΩ
Insulation resistance:	> 100 MΩ at 500 V DC
Dielectric strength:	500 V, 50 Hz for the duration of 1 minute
Operating temperature:	- 10° to + 60° C
Storage temperature:	- 20° to + 70° C
Mechanical life:	minimum 5000 operations
Contacts:	phosphor bronze, silver-plated
Terminals:	brass, silver-plated
Contact timing:	non-shorting
Slide colour:	white

Models: Switching functions

MMS 124	on on			
MMS 134	on on on			
MMS 224	on on			



Soldering conditions: reflow-soldering – max.: 20 sec, 200° C
peak temperature: 250° C

Packing: cardboard boxes, on tapes on request

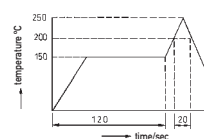

Microminiature Slide Switches

Specifications:

Contact rating:	0,2A, 24 V DC / 0,5A, 12 V DC
Contact resistance:	< 30 mΩ
Insulation resistance:	> 1000 MΩ at 500 V DC
Dielectric strength:	500 V, 50 Hz for the duration of 1 minute
Operating temperature:	- 40° to + 85° C
Mechanical life:	minimum 10 000 operations
Contacts:	phosphor bronze, gold-plated
Terminals:	brass, gold-plated
Contact timing:	non-shorting
Slide colour:	white
Soldering conditions:	auto-soldering – max.: 3 sec ± 0,5 sec, 260° C ± 5° C

Models: Switching functions

MMP 1010 D

on on

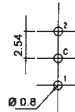
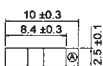
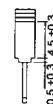
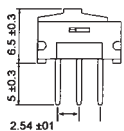

MMP 1010 D-RA

on on

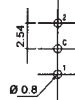
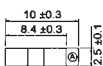
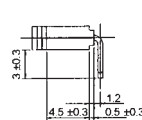
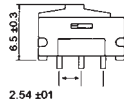

MMS 1010 D-R

on on

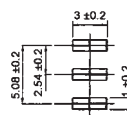
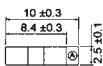
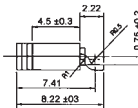
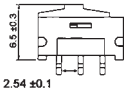

Soldering profile MMS 1010 D-R

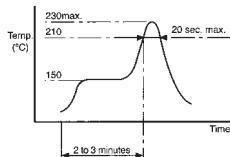



Microminiature Slide Switches

Specifications:

Contact rating:	24 V AC/DC, 0,3A / 12 V AC/DC, 0,5A
Contact resistance:	< 50 mΩ
Insulation resistance:	> 500 MΩ at 500 V DC
Dielectric strength:	500 V for the duration of 1 minute
Operating temperature:	- 25° to + 80° C
Mechanical life:	minimum 10 000 operations
Contacts:	brass, gold-plated
Terminals:	brass, gold-plated
Case:	PA
Soldering conditions:	auto-soldering – max.: 5 sec ± 0,5 sec, 270° C ± 5° C

Models

Switching functions

MMP 1010 D – 1

on on

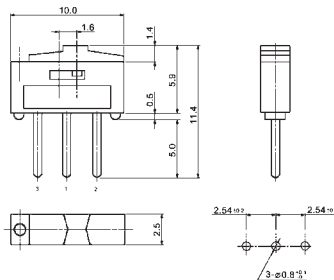

MMP 1010 D-RA – 1

on on

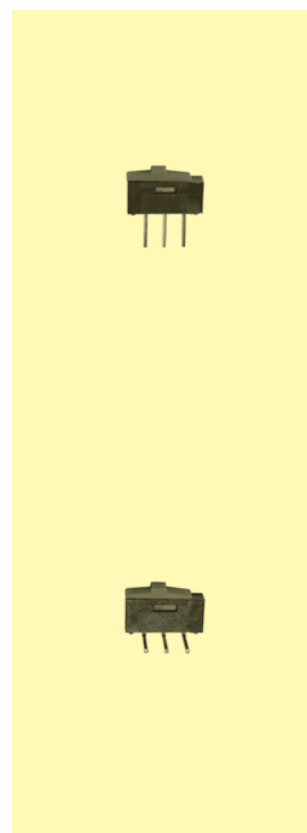
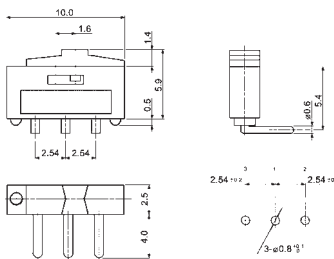

X-ON Electronics

Largest Supplier of Electrical and Electronic Components

Click to view similar products for [Slide Switches](#) category:

Click to view products by [Knitter-Switch](#) manufacturer:

Other Similar products are found below :

[6-1437581-1](#) [M43R](#) [MHS123K15D](#) [MHSS1104A](#) [MMD](#) [GH49S010001](#) [GH49WW00001](#) [1437576-8](#) [EPS1PC1](#) [1825074-1](#) [1825160-3](#)
[1825167-2](#) [25139NLDB](#) [25436NLDB](#) [25449NAH](#) [25536NA](#) [L101011ML04B](#) [SLB1240R45](#) [SLSA12004](#) [1825078-1](#) [1825080-4](#) [1825081-1](#)
[1825269-1](#) [1825270-2](#) [STS141RA04](#) [T2215BEN506](#) [GF-124-0204](#) [GH46P000001](#) [GH46W000001](#) [GH49P010001](#) [25339NA](#) [25436NLDH](#)
[CST91246FK](#) [TG36P000000](#) [TG36P000050](#) [47227LFE](#) [49331L](#) [MHSS1105A](#) [50208L](#) [HW4S-5LF22N3](#) [L202091MS02Q](#) [4-1437581-7](#)
[X2225CR-437W](#) [48BFSP3M2QT](#) [49329L](#) [1101M1S3ZB8E2](#) [1-1437581-1](#) [EG1218REDACTUATOR](#) [TG39W000000](#) [1825075-1](#)