

APPROVED: \_\_\_\_\_  
 DATE: \_\_\_\_\_ TITLE: \_\_\_\_\_

Rev	AWO #	Description	Date	Appr
-		RELEASED	11/15/04	
A		REDRAWN	07/05/12	

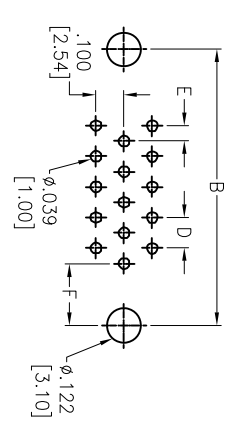

15 Position  
 RECOMMENDED PCB LAYOUT

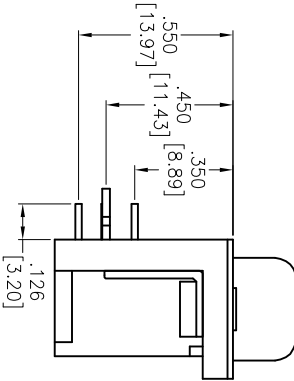
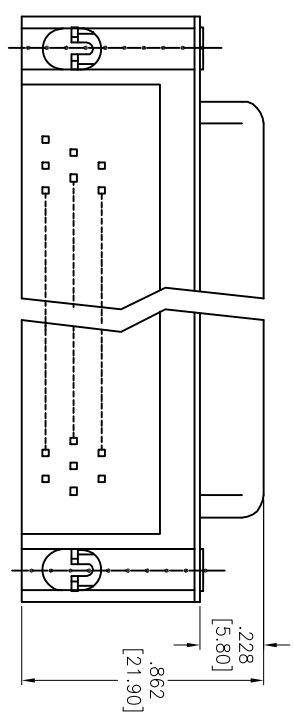
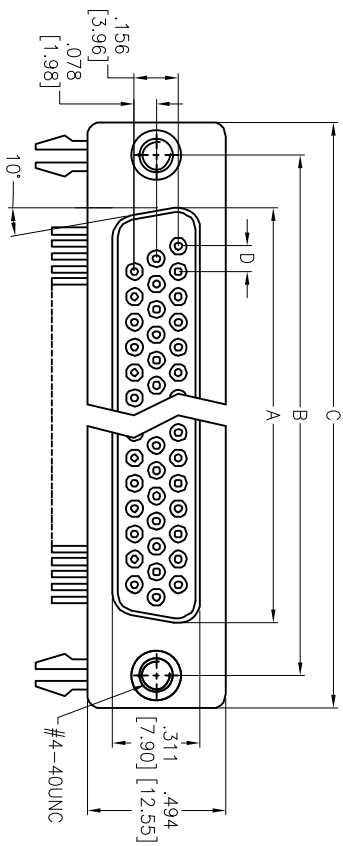
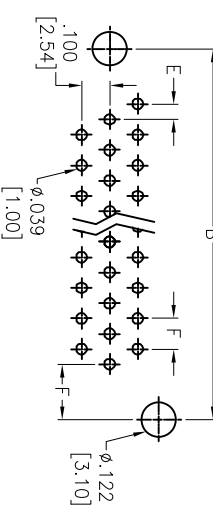

26, 44 & 62 Position  
 RECOMMENDED PCB LAYOUT

HDLXX	DIMENSIONS					
	A	B	C	D	E	F
15	.643 [16.33]	.984 [24.99]	1.213 [30.81]	.090 [2.29]	.045 [1.145]	.277 [7.04]
26	.971 [24.66]	1.312 [33.32]	1.541 [39.14]	.090 [2.29]	.045 [1.145]	.271 [6.88]
44	1.511 [38.38]	1.852 [47.04]	2.088 [53.04]	.090 [2.29]	.045 [1.145]	.271 [6.88]
62	2.159 [54.84]	2.500 [63.50]	2.729 [69.32]	.095 [2.41]	.047 [1.205]	.276 [7.00]

**ADAM TECH**

909 Railway Avenue, Union, NJ 07083  
 Phone: 908-687-5000 Fax: 908-687-5710

D-SUB, HIGH DENSITY, RIGHT ANGLE,  
 PCB

**SPECIFICATIONS:**  
 Material:  
 Insulator: PBT, glass reinforced, rated UL 94V-0  
 Insulator color: Black  
 Contacts: Phosphor Bronze  
 Shell: Steel, Zinc plated  
 Hardware: Brass, Nickel plated  
 Plating:  
 Gold Flash nom over Nickel underplate overall  
 Electrical:  
 Operating voltage: 250 VAC max  
 Current rating: 1 Amps max  
 Contact resistance: 20 mohms max  
 Insulation resistance: 5000 Mohms min @ 500 VDC  
 Dielectric withstanding voltage: 1000 VAC for 1 minute  
 Temperature Rating:  
 Operating temperature: -65°C to +125°C  
 Environmental:  
 Lead free, RoHS compliant. **RoHS**

UNLESS OTHERWISE SPECIFIED ALL DIMENSIONS ARE INCHES [MM] TOLERANCES: EXCEPT AS NOTED INCHES HOLE SIZES		DRAWN SS 11/15/04	
.X ± .10	ØXX ± .10	TITLE D-SUB, HIGH DENSITY, RIGHT ANGLE, PCB	
.XX ± .020	ØXXX ± .015	SIZE X	PART NO. HDLXX-SL-B
.XXX ± .015	ØXXXX ± .010	CHECKED	SCALE: NTS
APPROVALS	DATE	APPROVED	SHEET 1 OF 1
REF: S00087T			REV.

## X-ON Electronics

Largest Supplier of Electrical and Electronic Components

*Click to view similar products for [D-Sub High Density Connectors](#) category:*

*Click to view products by [Adam](#) manufacturer:*

Other Similar products are found below :

[1484349-1](#) [163A16769X](#) [163A16809X](#) [163A17089X](#) [164A17199X](#) [164A17209X](#) [164A17479X](#) [164A18209X](#) [17BH-044S-AA110](#) [K86X-AD-26S](#) [KF66X-A26P-NJ](#) [KF66X-E15P-N](#) [241A17320X](#) [242A18390X](#) [242A25740X](#) [L717HDB44POL2R210](#) [L717HDCH62POL2RM5](#) [L717HDEH15POL2](#) [L777HDE15P](#) [L77HDC62S](#) [L77HDE15SC309](#) [163A16779X](#) [163A16839X](#) [163A17049X](#) [163A17079X](#) [164A17309X](#) [164A17329X](#) [164A18219X](#) [241A16440X](#) [241A16550X](#) [241A16680X](#) [241A17390X](#) [241A20810X](#) [241A25740X](#) [CT25-44P](#) [K66X-E15S-N30](#) [K86X-BA-44S](#) [K86X-ED-15S-BR15](#) [K86X-ED-15SK](#) [L177HDE15SOL2RM23](#) [L177HRC62S](#) [L177HRC62SVFM](#) [L177HRCG62S](#) [L717HDBH44POL2RM5](#) [L717HDEG15POL2RM5](#) [L77HDA26SVF](#) [L77HDE15SD1CO](#) [L77HDEH15SOL2RM832](#) [DAMA-15S-WS](#)  
[443895-3](#)