

# ROHS COMPLIANT

**BACKSHELL MATERIAL:** DIE-CAST ZINC ALLOY  
**PLATING:** BLACK OXIDE  
**JACKSCREWS:** STEEL - BLACK OXIDE  
**M3 HOODSCREWS:** STEEL - BLACK OXIDE  
**JACKSCREWS:** STEEL - BLACK OXIDE  
**COMPRESSION INSERT:** ABS UL RECOGNIZED  
**OPERATING TEMP:** -40°C TO +120°C



**MH CONNECTORS LTD.**

DRAWING No		MHD1ZK-BK SERIES	
SCALE	NTS	SHEET	1
REV:	OF	DATE	03-14-12
APPROVED		D. CRDFT	
DATE	03-14-12		
DRAWN		P. JENKINS	
DATE	03-14-12		

THESE DRAWINGS AND SPECIFICATIONS ARE THE PROPERTY OF MH CONNECTORS LTD. AND SHALL NOT BE REPRODUCED, COPIED OR USED AS THE BASIS FOR WRITTEN PERMISSION. THE MANUFACTURE OR SALE OF APPARATUS WITHOUT

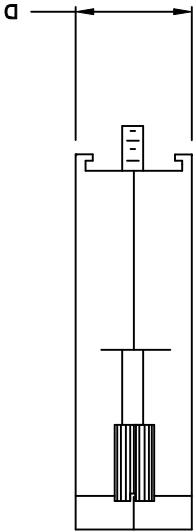
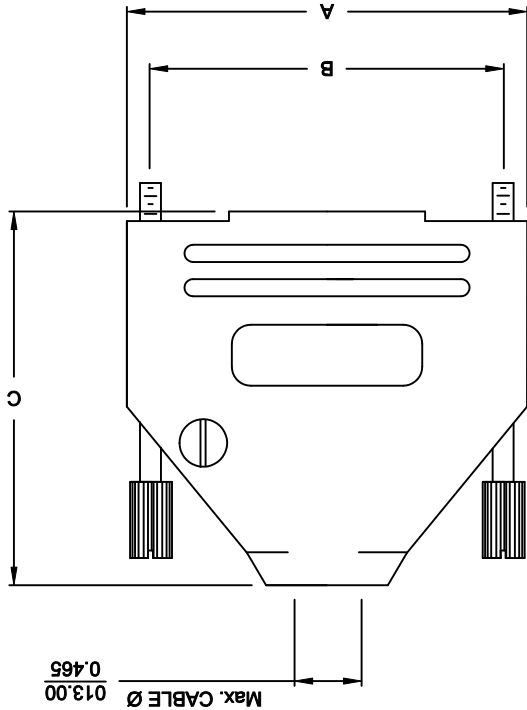

- BACKSHELL KIT INCLUDES:**
- (2) BACKSHELL HALVES
  - (2) 4-40 THUMBSCREWS
  - (2) HOUSING SCREWS
  - (1) SET OF COMPRESSION INSERTS - VARIOUS SIZES  
DIAMETERS 4mm (.157"), 5mm (.197"), 7mm (.276"), 9mm (.354")
  - (1) COMPRESSION SPRING

**ORDERING INFORMATION:**

SIZE	P/N - BULK	PRODUCT CODE:
37-WAY	6561-0815-04	MHD1ZK-37-BK
25-WAY	6561-0815-03	MHD1ZK-25-BK
15-WAY	6561-0815-02	MHD1ZK-15-BK
9-WAY	6561-0815-01	MHD1ZK-9-BK

SIZE	P/N - KITTED	PRODUCT CODE:
37-WAY	6560-0815-04	MHD1ZK-37-BK-K
25-WAY	6560-0815-03	MHD1ZK-25-BK-K
15-WAY	6560-0815-02	MHD1ZK-15-BK-K
9-WAY	6560-0815-01	MHD1ZK-9-BK-K

SIZE	DIMENSIONS (mm/in)			
	A ±.25 ±0.10	B ±.13 ±.005	C ±.25 ±0.10	D ±.25 ±0.10
9	31.20	24.99	39.90	15.00
15	1.228	0.984	1.571	0.591
	39.50	33.32	41.50	15.00
25	1.555	1.312	1.634	0.591
	53.40	47.04	48.60	15.00
37	2.102	1.852	1.913	0.591
	69.70	63.50	53.60	15.00
	2.744	2.500	2.110	0.591

## X-ON Electronics

Largest Supplier of Electrical and Electronic Components

*Click to view similar products for [mh connectors manufacturer](#):*

Other Similar products are found below :

[MHDCMR37-ULP](#) [CCOV-37SC-BLACK](#) [C88E310000](#) [DSSKP15L-DB15S-K](#) [MHD45ZK25-DM25P-K](#) [MHHDS26-F-T-B-S](#) [MHDTZK25-DB25S-K](#) [MHCCOV-25SC-BK](#) [MHDTZK15-RA-K](#) [DSSKM15L-DB15S-K](#) [MDS37S](#) [MHDM25-DM25P-K](#) [BNC4MML1MRG58](#) [RJ45SRB-RET-O](#) [MHDPPK25-Y-K](#) [MHCCOV-9ME](#) [BNCL2.0MRG58](#) [MHDD15-F-T-B-M](#) [MHDTZK25-K](#) [MHRJ126P6CR](#) [RJ45SRB-LGREY](#) [MHED-DS25S](#) [BNCL1.0MRG58](#) [RG58SRB-G](#) [MHD45PK37-K](#) [MHDTPPK25-DB25SK](#) [MHDU45ZK09-K](#) [DA9-PMJ8-B-K](#) [MHDD25-M-T-B-S](#) [RG58SRB-R](#) [MHCCOV-50SC-MP](#) [MHDCMR09-ULP](#) [RJ45SRB-RED](#) [MHRJ116P4CR](#) [MHTRI-M-9-K](#) [MHDM35-9-K](#) [DSSKM25L-DB25P-K](#) [MHDPPK-M-37-K](#) [MHDTPPK37-K](#) [MHRJJ44NFV](#) [GA0909FFLGK-RC](#) [DA9-SMJ8-R-K](#) [RG58SRB-BE](#) [MHCCOV-15SN-LG](#) [MHDTZK9-RA-K](#) [MHDVSL25-K](#) [MHCCOV-25SC-LG](#) [DJF-14](#) [MHD45ZK9-DM9P-K](#) [MHDA25-SMJ8-K](#)