

Saturating chokes

RI Series

- 0.8 to 25A ratings
- single or dual choke configurations
- flying lead or PCB-mount versions
- Nennströme zwischen 0.8 und 25A
- Einfach- oder Doppel-Wicklungskonfigurationen
- Versionen für Leiterplattenmontage oder mit Anschlußdrähten
- courant de service entre 0,8 et 25A
- configurations avec un ou deux enroulements
- boîtiers pour montage sur carte électronique ou connexions par fils



Choke selection table Choose the choke **RI xxx** offering the required current rating and component configuration. Types with the letters PC in the name have pins for PCB mounting; others have flying lead wire connections.

Choke type	Nominal current A @ 40°C	Circuit symbol	R [†] m /path	Weight approx. g
RI 109 PC	2		280	65
RI 110 PC	3		148	120
RI 111 PC	6		42	170
RI 13	25		10	1320
RI 207 PC	0.8		1325	50
RI 209 PC	2		275	40
RI 229 PC	2		265	30
RI 230 PC	3		160	50
RI 210 PC	3		160	65
RI 231 PC	5		62	80

Choke type	Nominal current A @ 40°C	Circuit symbol	R [†] m	Weight approx. g
RI 211 PC	6		43	70
RI 221 PC	8		34	175
RI 401 PC	1.5		620	15
RI 403 PC	3		105	30
RI 406 PC	6		53	55
RI 410 PC	10		28	95
RI 222	15		21	330
RI 415	15		8	205
RI 425	25		3.5	325

Environmental ratings

Maximum operating voltage: 500V at 40°C
 High potential test voltage winding-to-winding at 25°C and/or winding-to-inserts: 2500VAC, 1 minute, guaranteed 2500V, 50Hz, 2 sec, factory test
 Surge current at 10msec: 20 x I_{nominal} at 25°C
 Power operating frequency: DC to 1kHz at 40°C
 Operating temperature: -25°C to +110°C
 Storage temperature: -25°C to +110°C
 Climatic class per IEC 68: 25/110/21
 Flammability: UL94V0

Test conditions

† Resistance: tolerance max. ±15% at 25°C; < 200m 100mA; > 200m 2 10mA
 Electrical characteristics at 25°C ± 2°C

Typical saturation characteristics

Inductance (typical value in %) vs. nominal current in %

RI series typical

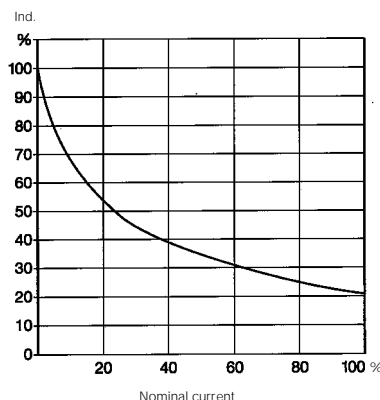

mechanical data
PCB Mounting

Choke	RI 109	RI 110	RI 111/ RI 221	RI 207/ RI 401	RI 209	RI 210	RI 211	RI 229/ RI 403	RI 230/ RI 406	RI 231	RI 410	Tol.* mm
A	32	40	49	19.5 ^{+0.55}	25	32	32	23.3	28.5	32.5 ^{+0.5}	33	± 0.3
B	24	30	35	19.5 ^{+0.55}	25	24	24	23.3	28.5	32.5 ^{+0.5}	33	± 0.3
C	30	35	34	15 ^{+0.6/15*0.3}	25	30	30	18	21.5	25	28	± 0.3
D	17	18	21				17					± 0.25
E	M3		M4				M3					-
F	25	30	40/20	12.5		15	25	15	20	17.5		± 0.2
G	10	12.5	20	7.5	12.5		17.5	10		15		± 0.2
H	0.6 x 0.88		1.15/1.13	0.6 x 0.88	1		1.13	0.8/0.9	0.6 x 0.88	0.75 x 1.1		± 0.1
J	4		6				4					+0.5
K	~6.5	~5.5	~15	~4	~15	~11	~15	~4/~6	~4/~4.5	~6		-

Dimensions in mm; 1 inch = 25.4mm

* Measurements share this common tolerance unless otherwise stated

SIDE

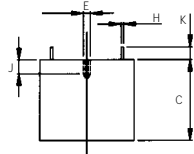

RI 109, 110, 111

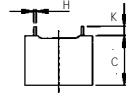

RI 207, 209, 229, 230,
401, 403, 406

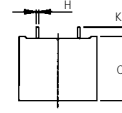

RI 231, 410

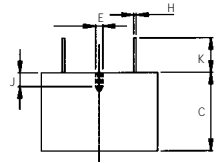

RI 210, 211, 221

BOTTOM

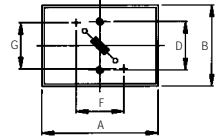
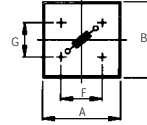
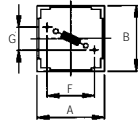
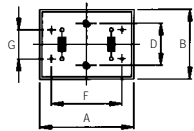

Flying lead types

Choke	RI 13	RI 222	RI 415	RI 425	Tol.* mm
A	95	48 ^{+0.3}	35 ^{+0.5}	48 ^{+0.3}	± 0.3
B	60 ^{+1.3}	48	49 ^{+0.5}	48	+1.3
C	65	43	34	43	± 0.3
D	37		30		± 0.25
E	M5		M4		-
F	-80	35	22	39	-
G	40	35	36	35	-
I			10		± 1
J	7 ^{+0.5}		6		+0.5
K			200		± 10

Dimensions in mm; 1 inch = 25.4mm

* Measurements share this common tolerance unless otherwise stated

SIDE

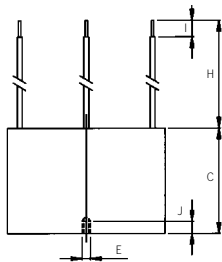

RI 13

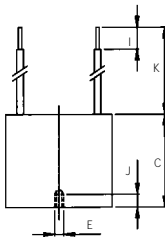

RI 222

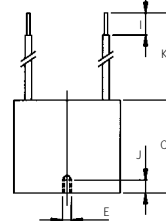

RI 415, 425

BOTTOM

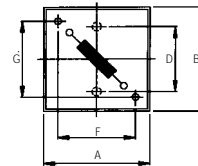
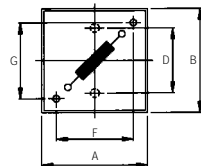
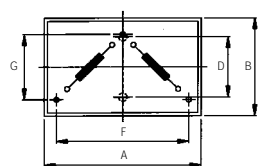

X-ON Electronics

Largest Supplier of Electrical and Electronic Components

Click to view similar products for [Multilayer Ceramic Capacitors MLCC - Leaded](#) category:

Click to view products by [Schaffner](#) manufacturer:

Other Similar products are found below :

[010-007220-002REV A](#) [M39014/01-1210V](#) [M39014/01-1281V](#) [M39014/01-1335V](#) [M39014/01-1571V](#) [M39014/01-1578V](#) [M39014/01-1593](#)
[M39014/02-1347](#) [M39014/02-1350](#) [M39014/22-0167](#) [M39014/22-0734](#) [87043-49](#) [Q52-DK](#) [C410C221K1G5TATR](#) [C420C102J1G5TATR](#)
[C430C104M1U5TATR](#) [SL155C222MAB](#) [CCR06CG183GRV](#) [CFB1/2C101J](#) [CFB1/2C102J](#) [CN20C102K](#) [M39014/01-1317](#) [M39014/01-](#)
[1572V](#) [M39014/01-1594V](#) [M39014/02-1236](#) [M39014/02-1321V](#) [M39014/02-1345V](#) [M39014/22-0351](#) [M39014/22-0695](#) [M39014/220767](#)
[M39014/220788](#) [M39014/22-1005](#) [MA405E334MAA](#) [MD015A103KAB](#) [SL301E105MAB](#) [KTD101B684M32A0B00](#) [CCR07CG473KR](#)
[CCR05CG820JP](#) [TKC-TMC1206-05-1501-J??](#) [TKC-TMC1206-05-1801-J](#) [TKC-TMC1206-05-20R0-F](#) [TKC-TMC1206-05-3901-J](#) [TKC-](#)
[TMC1206-05-44R2-F](#) [TKC-TMC1206-05-4703-J??](#) [TKC-TMC2512-05-1211-F](#) [100B5R1CT500X](#) [100B3R9CT500X](#) [M39014/22-0869](#)
[M39014/220556](#) [M39014/22-1045](#)